

# TOWER Wall-Mounted Shelf Round

PRODUCT NUMBER 01937:WH 01938:BK

**INSTRUCTIONS** Thank you for purchasing this item from Yamazaki Inc. Please refer to the following instructions before using the product. Please use it properly, and take good care of it.

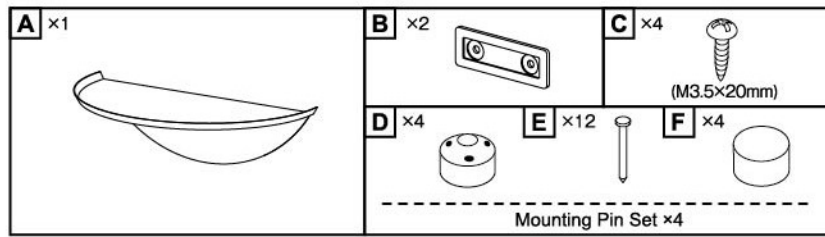

## How to attach pins to gypsum board

\*Please prepare fittings with flat surfaces such as coins.  
 \*Please be careful not to injure your fingers or hands when installing the product.

- Attach the Attachment Guide paper to the wall with a tape that will not leave any marks.  
 \*Attachment Guide paper should be attached vertically and horizontally.
- Press the mounting base against the wall in accordance with the Attachment Guide paper. With the mounting base(B) pressed against the wall, firmly fit the mounting piece(D) deep into the hole.  
 \*Please press and install one by one.

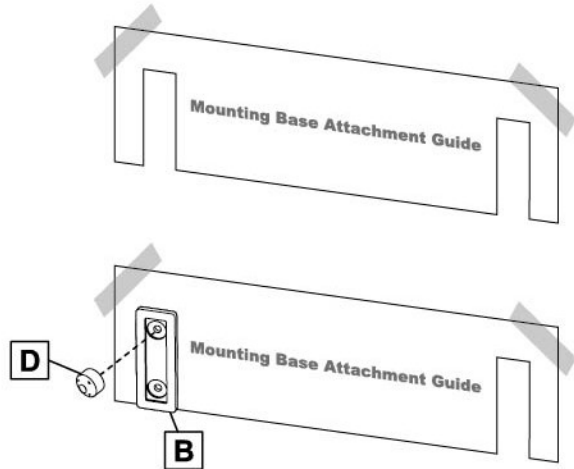

- Lightly insert the pins(E) into the holes of the mounting piece and use a coin or similar tool to push one by one toward the wall in a diagonal direction completely all the way to the end.  
 \*Please note that if you press the pins in the wrong direction, they will bend.  
 \*Please note that the product cannot be installed unless the mounting piece(D) is firmly attached to the wall.

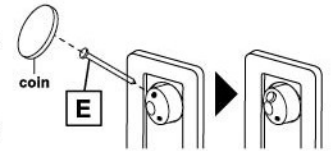

- After all three pins(E) are pushed in, fit the cap(F) from the top.

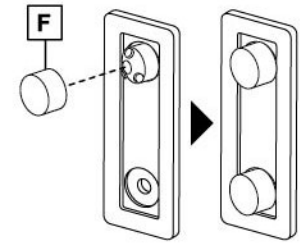

- Please install the mounting pin set(D)(E)(F) in the other hole following steps 2-4. Follow steps 1-4 to install the other mounting base(B), mounting piece(D), pins(E), cap(F) as well.

- Firmly insert the two mounting bases(B) into the back of the main frame(A) at the same time.

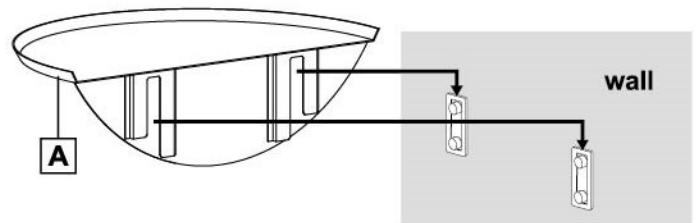

\*If it is difficult to insert the main frame into the mounting base, please check that the mounting piece, pins, and caps were firmly installed to the full depth in steps 2-4.

## Mountable wall types with screw

**Pillars, wooden siding (more than 1 cm thick), printed plywood (walls with a horizontal framing on the back side), walls with a pillar for nailing on the back side.**

\*Do not use on brittle walls such as gypsum board, plaster, mortar, etc., panels thinner than 1 cm, hard walls such as steel, concrete, block brick, etc., tiles, tiles joints, thin wooden walls, aluminum frames, or plastic frames.

## How to install with screws

\*Please prepare a Phillips-head screwdriver.

- Attach the Attachment Guide paper to the wall with a tape that will not leave any marks.  
 \*Attachment Guide paper should be attached vertically and horizontally.
- With the mounting base(B) pressed against the wall, drill two marked holes with a manual drill, etc., and then screw in the screws(C).

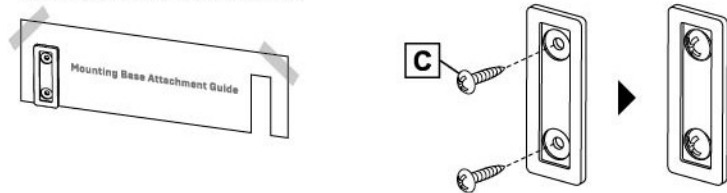

- Screw the screws(C) into the holes of the other mounting base as well, following steps 1-2.

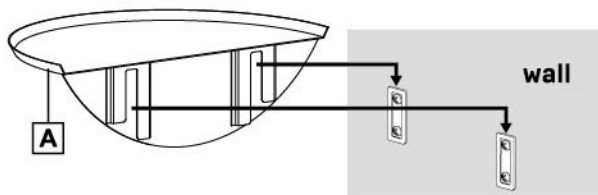

\*If the product wobbles or is unstable after wall mounting, adjust the tightness of the screws until the mounting base is firmly secured.  
 \*Check the strength of the mounting area and the tightness of the screws from time to time, and if it becomes loose, reinstall it in another location.

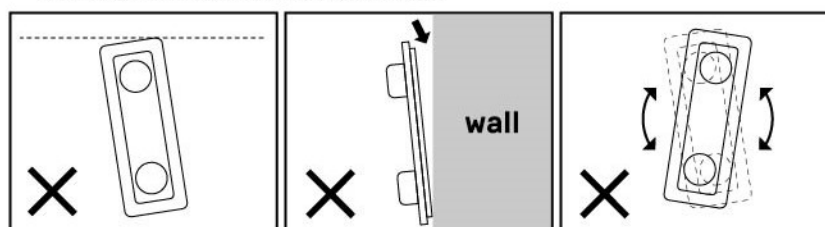

## Mountable wall types with mounting pin

**Wallpaper, fabric wallpaper, vog wall panels, thin veneer board.**

\*Pins are suitable for gypsum board 9.5 mm or larger and thin veneer 5 mm or larger.  
 \*Cannot be mounted on perforated gypsum board or rockwool acoustic board. Do not use on brittle walls, walls with panels thinner than 4 mm, steel frames, concrete, block bricks, or other hard walls, tiles, tile joints, etc.  
 \*Do not attach the product to any location that interferes with the base pillar (e.g., a pillar for nailing) or wiring.  
 \*Please use a hammer for wooden materials such as veneer.

## How to remove the mounting pin

To remove a pin, first remove the main frame and mounting cap, then pinch the head of the pin using pliers, and remove the pin by pulling it out in the diagonal direction in which it was pushed in. If the pin is removed forcibly, it may cause damage or a hole in the gypsum board.

## Precautions For Use

- Please do not use the product in a way other than its intended use.
- Do not store anything over the load capacity.
- The load capacity may slightly vary depending on the surface finish, material, condition, coating, strength, or environment.

## How To Clean

- Wipe the product clean with a dry cloth.
- If the product gets wet, use a clean, dry cloth to wipe off any moisture and dry it well. If the product is left wet for a long time, rust may occur.
- Do not use chemicals such as thinner or benzene as they may cause discoloration or deformation.

EN/	FR/	DE/	ES/	JP/
T Tower Wall-Mounted Side Table	Tower Table D'appoint Murale	Tower Beistelltisch Für Die Wandmontage	Tower Mesa Auxiliar De Pared	ウォールサイドテーブル タワー石こうボード壁対応
SIZE 15.7" w x 8.7" d x 4.6" h 40w x 22d x 11.7h cm	TAILLE 40w x 22d x 11.7h cm	GRÖSSE 40w x 22d x 11.7h cm	TAMAÑO 40w x 22d x 11.7h cm	SIZE 40w x 22d x 11.7h cm
MATERIAL Steel, ABS Resin	MATÉRIEL Acier, Résine ABS	MATERIAL Stahl, ABS Kunststoff	MATERIAL Acero, Resina ABS	MATERIAL 本体: スチール 表面加工: 粉体塗装 取り付けベース: ABS樹脂
ACCESSORIES Mounting pin set, Screws	ACCESSOIRES Jeu de clous de montage fins, Vis	ZUBEHÖR Montageset mit Nägeln, Schrauben	ACCESORIOS Juego de clavos de montaje, Tornillos	ACCESSORIES 石こうボードピンセット 木ネジ
MAXIMUM WEIGHT 2kg	POIDS MAXIMUM 2kg	MAXIMALGEWICHT 2kg	PESO MÁXIMO 2kg	MAXIMUM WEIGHT 2kg
Made in China. Designed in Japan.	Fabriqué en Chine. Conçu au Japon.	In China hergestellt. Entworfen in Japan.	Hecho en China. Diseñado en Japón.	Made in China. Designed in Japan.