

FINAL DRAWING

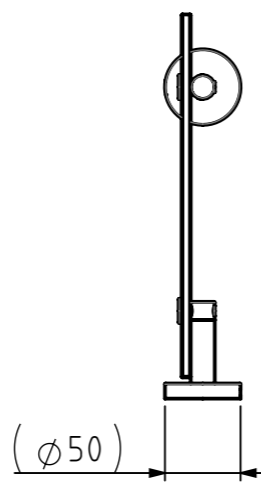
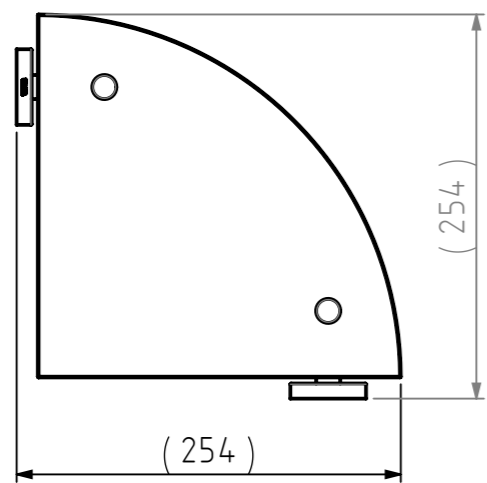
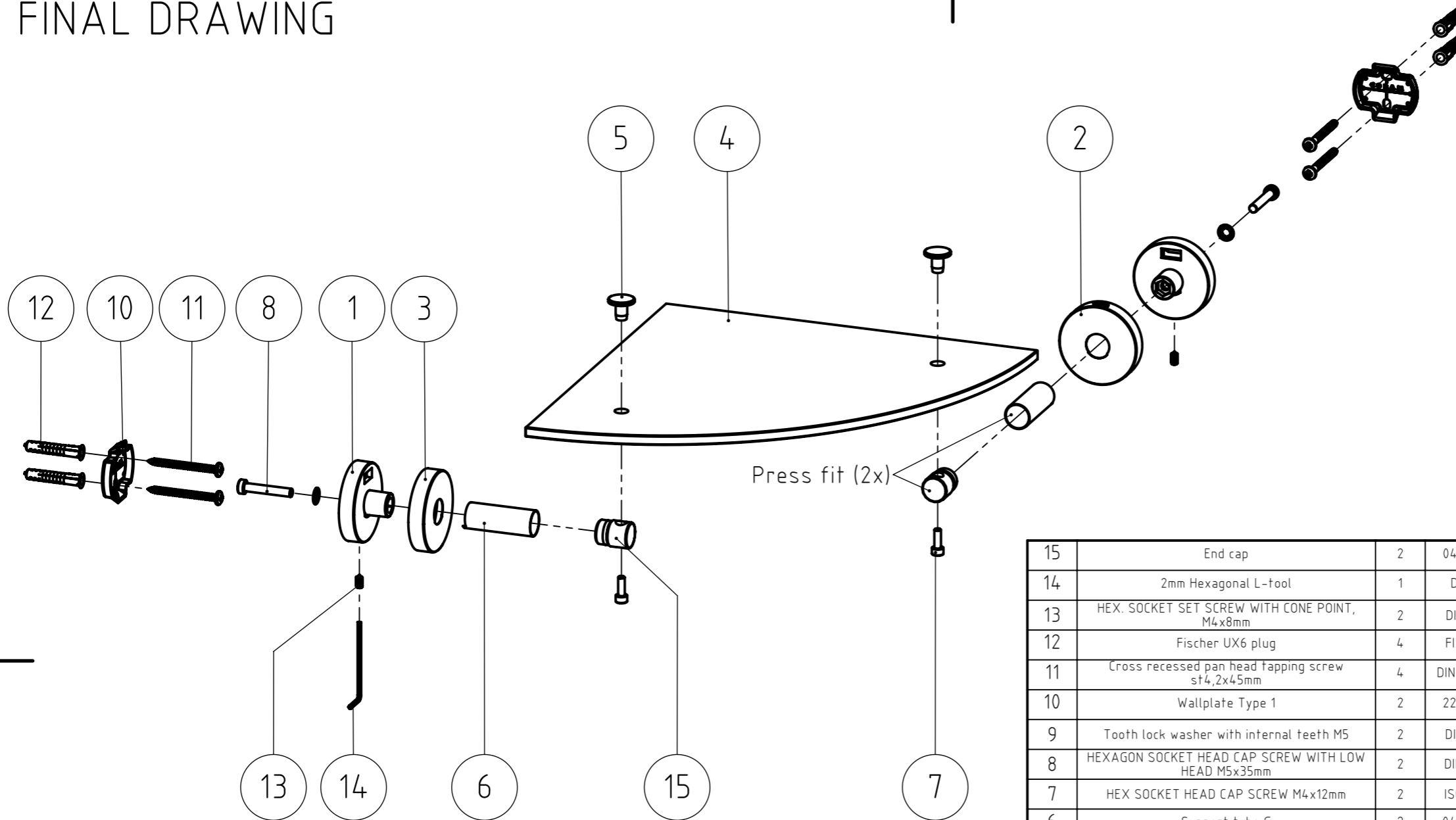

NR.	DESCRIPTION	QTY.	DRAW.NR.	MATERIAL	TREATMENT
15	End cap	2	040.14.05	Stainless steel AISI 304	Brushed
14	2mm Hexagonal L-tool	1	DIN.911	Tool steel	-
13	HEX. SOCKET SET SCREW WITH CONE POINT, M4x8mm	2	DIN.0914	Stainless steel A2	-
12	Fischer UX6 plug	4	FIX.0028	-	-
11	Cross recessed pan head tapping screw st4,2x45mm	4	DIN.7981 CZ	Stainless steel A2	-
10	Wallplate Type 1	2	226.03.02	Stainless steel AISI 304	Sand blasted
9	Tooth lock washer with internal teeth M5	2	DIN.6797	Stainless steel A2	-
8	HEXAGON SOCKET HEAD CAP SCREW WITH LOW HEAD M5x35mm	2	DIN 7984	Stainless steel A2	-
7	HEX SOCKET HEAD CAP SCREW M4x12mm	2	ISO 4762	STAINLESS STEEL A2	-
6	Support tube G	2	040.14.04	Stainless steel AISI 304	Brushed
5	Shelf holder	2	040.14.03	Stainless steel AISI 304	Brushed
4	Shelf	1	040.14.02	Tempered glass	Frosted
3	Cover (no logo)	1	040.01.03	Stainless steel AISI 304	Brushed
2	Cover	1	040.01.03	Stainless steel AISI 304	Brushed
1	Wall support	2	040.01.01	Zamac3	Chromium Plated

GENERAL DIMENSION UNLESS OTHERWISE STATED ACCORDING TO DIN 7168		DESCRIPTION:						
NOMINAL MEASUREMENTS (mm)		Corner tidy shelf						
CLASS								
	0.5 UNTIL 3	3 UNTIL 6	6 UNTIL 30	30 UNTIL 120	120 UNTIL 400	400 UNTIL 1000	1000 UNTIL 2000	2000 UNTIL 4000
M (MIDDLE)	±0.1	±0.1	±0.2	±0.3	±0.5	±0.8	±1.2	±2
PROJECTION:	GENERAL ANGLE:		EAN:		VERSION NAME:		ARTICLE NR.:	
	±0,5°		4008913082409		stainless steel		3082.3.09.46	
DRAWN BY:	EV		GENERAL ROUGHNESS:		PROJECT:		DRAWING NR.:	
CHECKED BY:	-		0,8/✓		040-Boston		TIGER	
DATE:	29-8-2006		UNITS:		DRAWING NR.:		Tiger Nederland b.v.	
STATUS:	Production		SCALE:		040.14.00.TS		Winde 3, PO box 11	
PRINT DATE:	18-2-2026		FORMAT:				5660 AA Geldrop	
INT.REV.NR.:	03		SHEET:				The Netherlands	
			2/2					

The reproduction, distribution and utilization of this document as well as the communication of its contents to others without express authorization is prohibited. Offenders will be held liable for the payment of damages. All rights reserved in the event of the grant of a patent, utility model or design. Copyright reserved.