

FINAL DRAWING

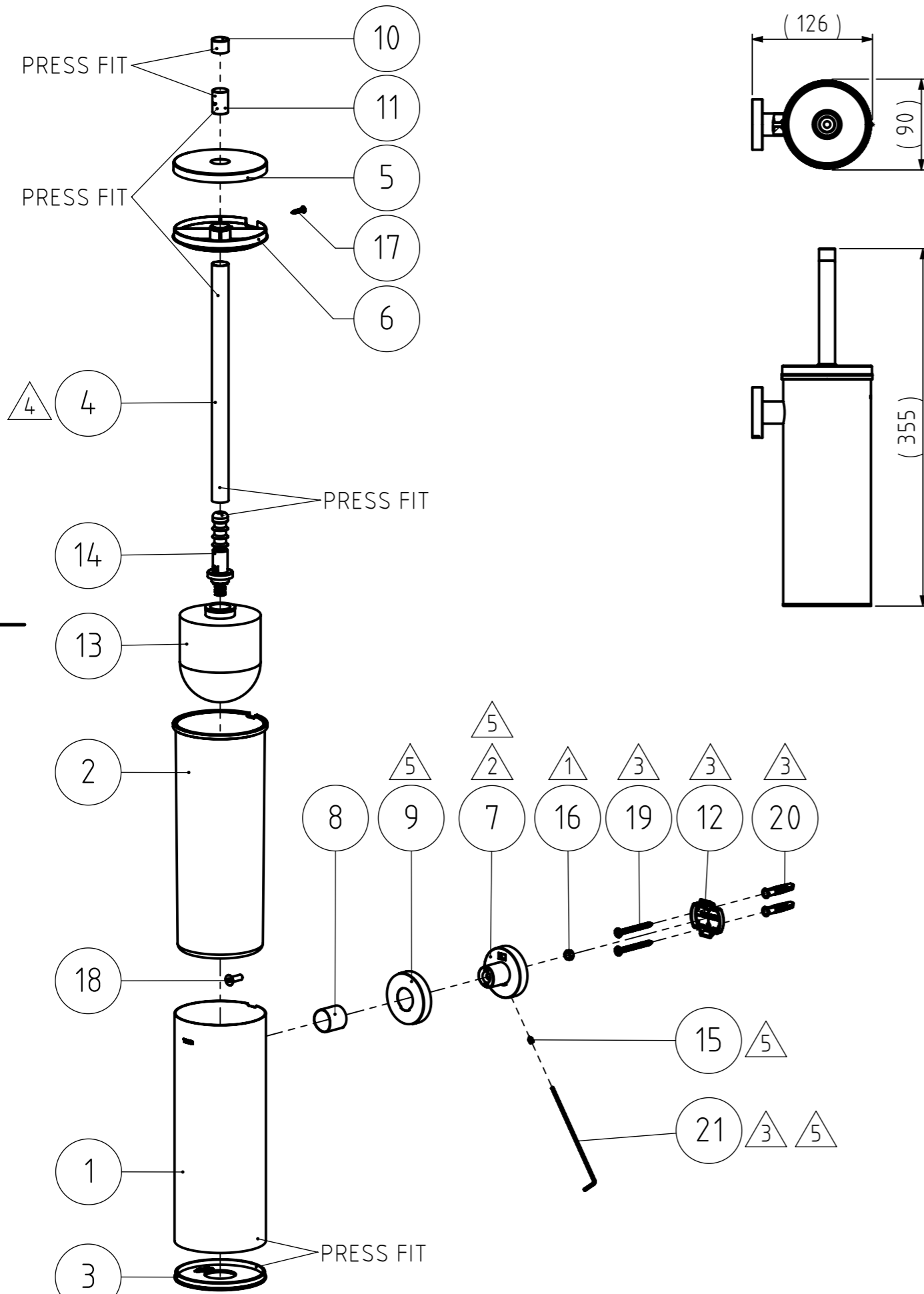

REVISIONS

REV.	DESCRIPTION	DATE	BY	APPROVED
1	SELF PREVAILING HEXAGONAL NUT ADDED.	29-9-2009	FH	-
2	HEX. SOCKET SREW SWAPPED TO LEFT SIDE.	1-10-2009	FH	-
3	- 040.01.02 Wall bracket 2 replaced by 226.01.01 Wallplate Type 1. - Screws, plugs and L-tool added to assembly drawing. - Black version created.	10-10-2017	MS	WW
4	- Height of handle changed.	26-2-2019	MS	MSm
5	Wallbracket and cover changed. Size of M4 screw changed, type and size of L-tool changed.	13-3-2019	MS	TvD

NR.	DESCRIPTION	QTY.	DRAW.NR.	MATERIAL	TREATMENT
21	2mm Hexagonal L-tool long arm ball end (extra long L=100mm)	1	DIN.911 L	Tool steel	-
20	Fischer UX6 plug	2	FIX.0028	-	-
19	Cross recessed pan head tapping screw st4,2x4,5mm	2	DIN.7981 CZ	Stainless steel A2	-
18	HEX. SOCKET COUNTERSUNK HEAD SCREW, M5x16mm	1	DIN.7991	Stainless steel A2	-
17	Cross recessed countersunk head tapping screw	1	DIN.7982 CZ	Stainless steel A2	-
16	SELF PREVAILING NUT, M5	1	DIN.0985	Stainless steel A2	-
15	HEX. SOCKET SET SCREW WITH CONE POINT, M4x6mm	1	DIN.0914	Stainless steel A2	-
14	Toilet brush connector	1	BUY.05.02	PP - Black RAL 9005	-
13	STANDARD TIGER BRUSH	1	099.01.02	various	-
12	Wallplate Type 1	1	226.03.02	Stainless steel AISI 304	Sand blasted
11	Arm holder	1	040.10.03	Zamac3	Chromium Plated
10	Arm cap	1	040.06.07	Stainless steel AISI 304	Polished - High gloss
9	Cover	1	130.07.10	Stainless steel AISI 304	Polished - High gloss
8	Tube	1	130.07.09	Stainless steel AISI 304	Polished - High gloss
7	Wall bracket	1	130.07.08	Zamac3	Chromium Plated
6	Inner cover	1	130.07.06	PP - Black RAL 9005, semi gloss	Texture VDI 3400 ref.30 (standard)
5	Brush cover	1	130.07.05	Stainless steel AISI 304	Polished - High gloss
4	Handle	1	130.07.04	Stainless steel AISI 304	Polished - High gloss
3	Bottom	1	130.07.03	PP - Black RAL 9005, semi gloss	Texture VDI 3400 ref.30 (standard)
2	Inner pot	1	130.07.02	PP - Black RAL 9005, semi gloss	Texture VDI 3400 ref.30 (standard)
1	Pot	1	130.07.01	Stainless steel AISI 304	Polished - High gloss

GENERAL DIMENSION UNLESS OTHERWISE STATED ACCORDING TO DIN 7168

CLASS	NOMINAL MEASUREMENTS (mm)							
	0.5 UNTIL 3	3 UNTIL 6	6 UNTIL 30	30 UNTIL 120	120 UNTIL 400	400 UNTIL 1000	1000 UNTIL 2000	2000 UNTIL 4000
M (MIDDLE)	±0.1	±0.1	±0.2	±0.3	±0.5	±0.8	±1.2	±2

DESCRIPTION: Toilet brush and holder

VERSION NAME: chrome

ARTICLE NR.: 3099.3.03.46

PROJECT: 130-Boston

DRAWING NR.: 130.07.00.TC

PROJECT: 130-Boston

DATE: 27-5-2009

UNITS: mm

SCALE: 1:5

FORMAT: A3

SHEET: 1/3

GENERAL ROUGHNESS: 0,8 ✓

PROJECTION:

GENERAL ANGLE: ±0,5°

EAN: 4008913099414

DRAWN BY: MS

CHECKED BY: RS

DATE: 27-5-2009

UNITS: mm

SCALE: 1:5

FORMAT: A3

SHEET: 1/3

INT.REV.NR.: 0000

TIGER
Tiger Products b.v.
Winde 3A, PO box 11
5660 AA Geldrop
The Netherlands

The reproduction, distribution and utilization of this document as well as the communication of its contents to others without express authorization is prohibited. Offenders will be held liable for the payment of damages. All rights reserved in the event of the grant of a patent, utility model or design. Copyright reserved.