

# FINAL DRAWING

REVISIONS				
REV.	DESCRIPTION	DATE	BY	APPROVED
-	See 205.18.00.TS	-	-	-

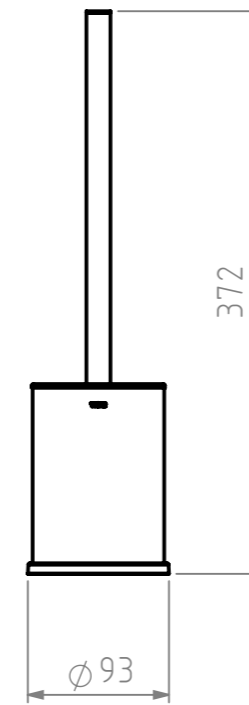
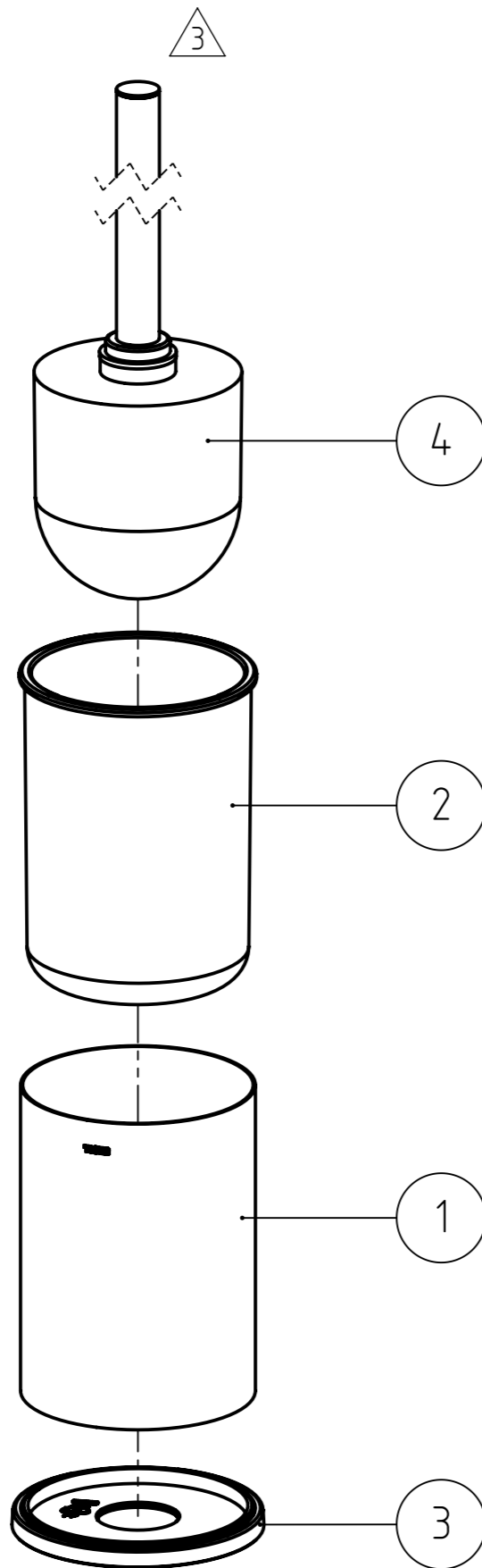

4	Toilet brush subassy - Flat head, black	1	BUY.05.00	Various	Powdercoated, Black RAL 9005
3	Bottom freestanding	1	130.08.01	PP - Black RAL 9005, semi gloss	Texture VDI 3400 ref.30 (standard)
2	Inner brush pot	1	205.17.02	PP - Black RAL 9005, semi gloss	Texture VDI 3400 ref.30 (standard)
1	Toilet brush holder (with logo)	1	205.17.01	Stainless steel AISI 430	Powder coated, texture VDI 3400 ref.30 - RAL 9005 (Jet black)
NR.	DESCRIPTION	QTY.	DRAW.NR.	MATERIAL	TREATMENT

GENERAL DIMENSION UNLESS OTHERWISE STATED ACCORDING TO DIN 7168							DESCRIPTION:	
CLASS	NOMINAL MEASUREMENTS (mm)						Toilet brush and holder freestanding	
	0.5 UNTIL 3	3 UNTIL 6	6 UNTIL 30	30 UNTIL 120	120 UNTIL 400	400 UNTIL 1000		
M (MIDDLE)	±0.1	±0.1	±0.2	±0.3	±0.5	±0.8	±1.2	±2
PROJECTION:	GENERAL ANGLE:		VERSION NAME:		ARTICLE NR. (packed product):			
	±0,5°		black		13149.3.07.46			
DRAWN BY: MS				GENERAL ROUGHNESS: 0,8		PROJECT: 205-Colar		
CHECKED BY: F.H.				UNITS: mm		DRAWING NR: 205.18.00.TB		
DATE: 18-1-2016				SCALE: 1:5		 Tiger Products b.v. Winde 3, PO box 11 5660 AA Geldrop The Netherlands		
STATUS: Production				FORMAT: A3				
PRINT DATE: 23-10-2024				SHEET: 3/3				
INT.REV.NR.: 03				VERSION NAME: black		ARTICLE NR. (packed product): 13149.3.07.46 (for packaging information see GDS)		

The reproduction, distribution and utilization of this document as well as the communication of its contents to others without express authorization is prohibited. Offenders will be held liable for the payment of damages. All rights reserved in the event of the grant of a patent, utility model or design. Copyright reserved.