

FINAL DRAWING

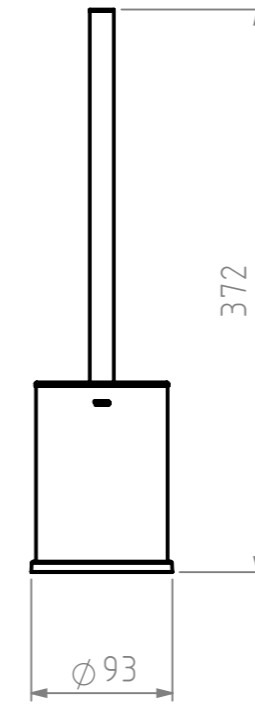
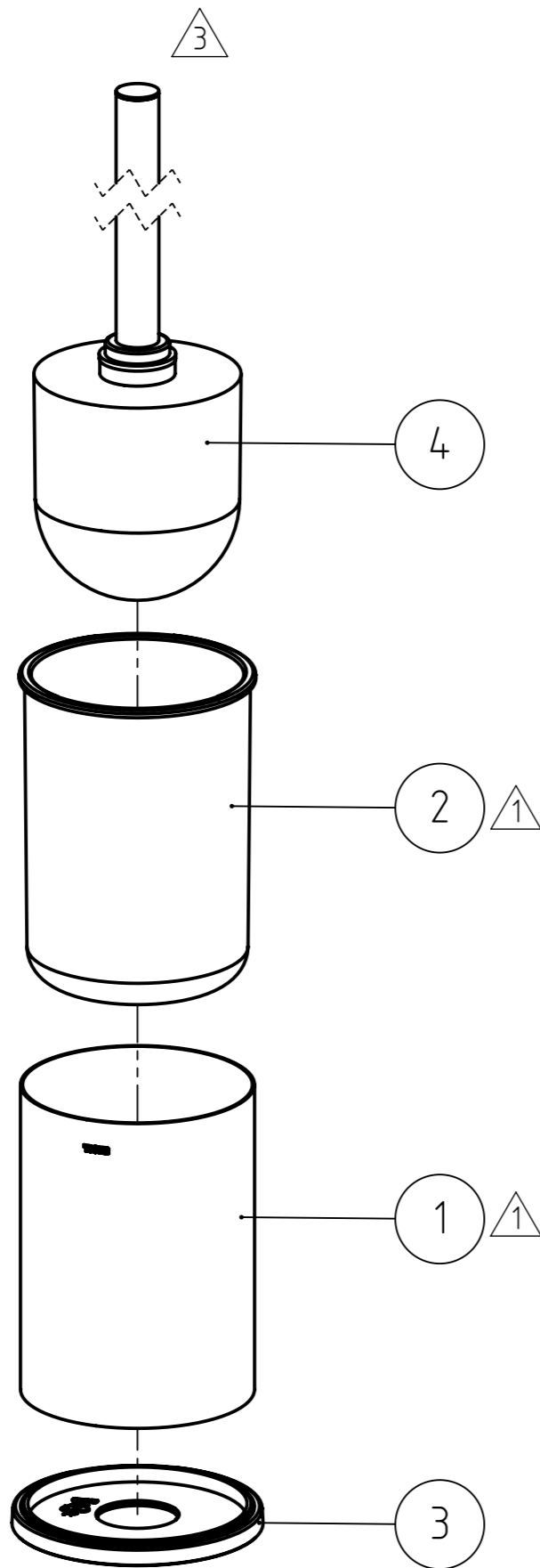

REVISIONS				
REV.	DESCRIPTION	DATE	BY	APPROVED
1	-003.13.02 Plastic brush pot has been replaced by 205.17.02 Inner brush pot - Height of 205.17.01 Toilet brush holder has changed	12-4-2016	MS	WW
2	Black version added.	27-7-2021	MS	FvP
3	Construction handle changed to welded end cover	22-10-2024		

NR.	DESCRIPTION	QTY.	DRAW.NR.	MATERIAL	TREATMENT
4	Toilet brush subassy - Flat head, stainless steel	1	BUY.05.00		Brushed
3	Bottom freestanding	1	130.08.01	PP - Black RAL 9005, semi gloss	Texture VDI 3400 ref.30 (standard)
2	Inner brush pot	1	205.17.02	PP - Black RAL 9005, semi gloss	Texture VDI 3400 ref.30 (standard)
1	Toilet brush holder (with logo)	1	205.17.01	Stainless steel 304	Brushed

GENERAL DIMENSION UNLESS OTHERWISE STATED ACCORDING TO DIN 7168		DESCRIPTION:	
CLASS		Toilet brush and holder freestanding	
NOMINAL MEASUREMENTS (mm)		ARTICLE NR. (packed product): 13149.3.09.46 (for packaging information see GDS)	
M (MIDDLE)		VERSION NAME: stainless steel	
PROJECTION:		GENERAL ANGLE: ±0,5°	
DRAWN BY: MS		PROJECT: 205-Colar	
CHECKED BY: F.H.		DRAWING NR.: 205.18.00.TS	
DATE: 18-1-2016		GENERAL ROUGHNESS: 0,8	
STATUS: Production		UNITS: mm	
PRINT DATE: 23-10-2024		SCALE: 1:5	
INT.REV.NR.: 03		FORMAT: A3	
		SHEET: 1/3	
		TIGER Tiger Products b.v. Winde 3, PO box 11 5660 AA Geldrop The Netherlands	

The reproduction, distribution and utilization of this document as well as the communication of its contents to others without express authorization is prohibited. Offenders will be held liable for the payment of damages. All rights reserved in the event of the grant of a patent, utility model or design. Copyright reserved.