

FINAL DRAWING

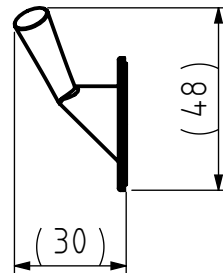
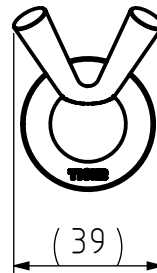
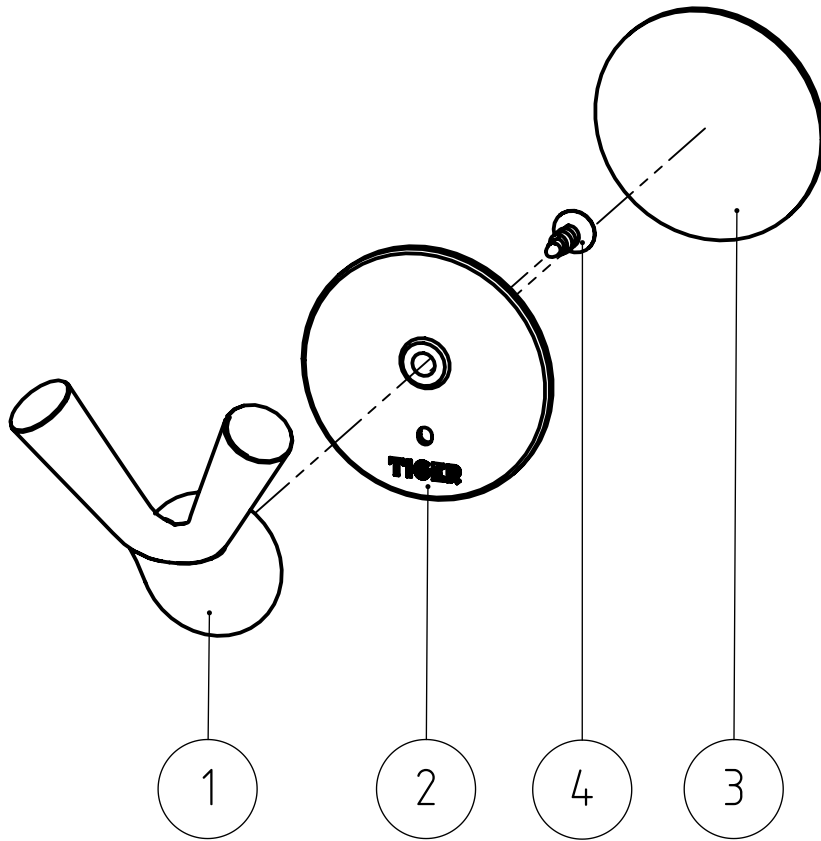

NR.	DESCRIPTION	QTY.	DRAW.NR.	MATERIAL	TREATMENT
4	Cross recessed countersunk head tapping screw	1	DIN.7982 CZ	Stainless steel A2	-
3	Tape pad	1	225.25.03	3M / NO.1600 / Foam tape 1,0 mm	-
2	Wallplate	1	225.25.02	ABS - White RAL 9003	Texture VDI 3400 ref.30 (standard)
1	Branch	1	225.25.01	ABS - White RAL 9003	Texture VDI 3400 ref.30 (standard)

GENERAL DIMENSION UNLESS OTHERWISE STATED ACCORDING TO DIN 7168		DESCRIPTION:							
CLASS	NOMINAL MEASUREMENTS (mm)								Branch
	0.5 UNTIL 3	3 UNTIL 6	6 UNTIL 30	30 UNTIL 120	120 UNTIL 400	400 UNTIL 1000	1000 UNTIL 2000	2000 UNTIL 4000	
M (MIDDLE)	±0.1	±0.1	±0.2	±0.3	±0.5	±0.8	±1.2	±2	
PROJECTION:	GENERAL ANGLE:	EAN:	VERSION NAME:		ARTICLE NR.:				
	±0,5°	4008911110456	white		11109.3.01.42				
DRAWN BY:	MS	GENERAL ROUGHNESS:	PROJECT:		Tiger Products b.v. Winde 3, PO box 11 5660 AA Geldrop The Netherlands				
CHECKED BY:	FVP		225-hooks 2016						
DATE:	13-1-2017	UNITS:	DRAWING NR.:						
STATUS:	Production	mm	225.25.00.TW						
PRINT DATE:	8-4-2026	SCALE:							
INT.REV.NR.:	00	FORMAT:							
		SHEET:							
		1/2							

The reproduction, distribution and utilization of this document as well as the communication of its contents to others without express authorization is prohibited. Offenders will be held liable for the payment of damages. All rights reserved in the event of the grant of a patent, utility model or design. Copyright reserved.