

FINAL DRAWING

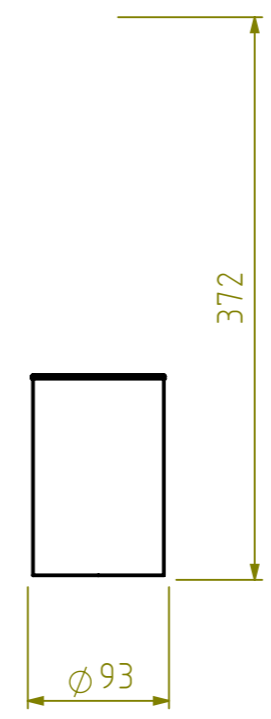
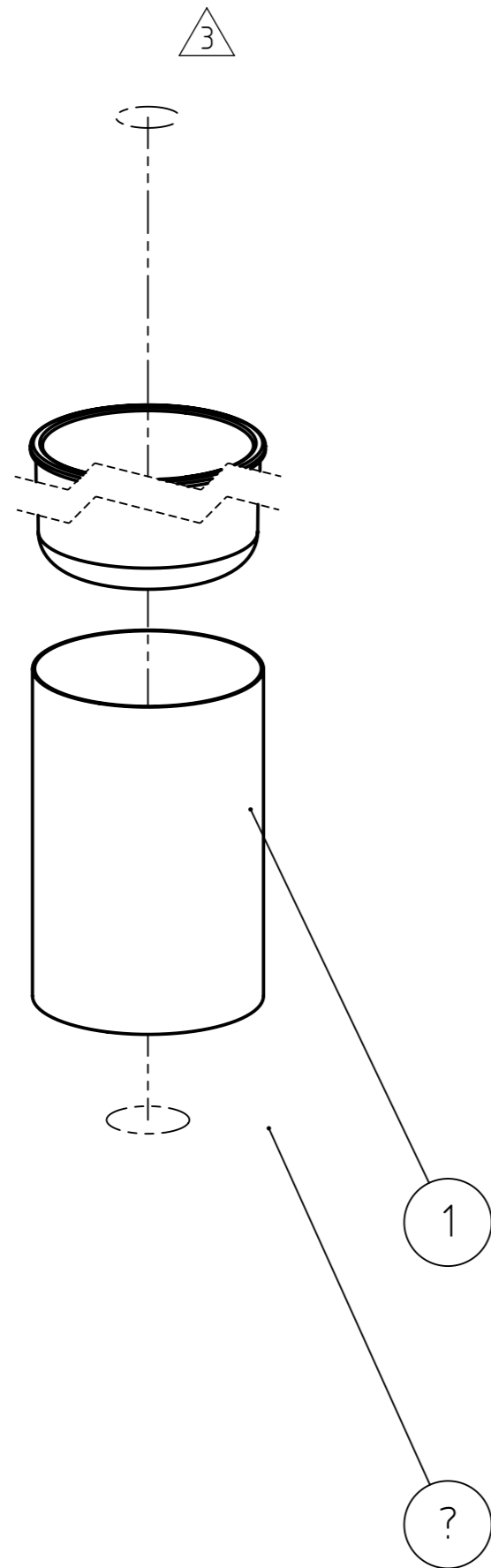

REVISIONS				
REV.	DESCRIPTION	DATE	BY	APPROVED
-	See 205.18.00.TS	-	-	-

2	Inner brush pot	1	205.17.02	PP - Black RAL 9005, semi gloss	Texture VDI 3400 ref.30 (standard)
1	Toilet brush holder (with logo)	1	205.17.01	Stainless steel AISI 430	Powder coated, texture VDI 3400 ref.30 - RAL 9005 (Jet black)
NR.	DESCRIPTION	QTY.	DRAW.NR.	MATERIAL	TREATMENT

GENERAL DIMENSION UNLESS OTHERWISE STATED ACCORDING TO DIN 7168								DESCRIPTION:	
CLASS	NOMINAL MEASUREMENTS (mm)							Toilet brush and holder freestanding	
	0.5 UNTIL 3	3 UNTIL 6	6 UNTIL 30	30 UNTIL 120	120 UNTIL 400	400 UNTIL 1000	1000 UNTIL 2000		
M (MIDDLE)	±0.1	±0.1	±0.2	±0.3	±0.5	±0.8	±1.2	±2	
PROJECTION:		GENERAL ANGLE:		VERSION NAME:		ARTICLE NR. (packed product):			
		±0,5°		black		1314930746		(for packaging information see GDS)	
DRAWN BY:		MS		GENERAL ROUGHNESS:		0,8		PROJECT:	
CHECKED BY:								205-Colar	
DATE:		18-1-2016		UNITS:		mm		DRAWING NR:	
STATUS:		Production		SCALE:		1:5		205.18.00.TB	
PRINT DATE:		14-4-2026		FORMAT:		A3		TIGER Tiger Products b.v. Winde 3, PO box 11 5660 AA Geldrop The Netherlands	
INT.REV.NR.:		03		SHEET:		3/3			

The reproduction, distribution and utilization of this document as well as the communication of its contents to others without express authorization is prohibited. Offenders will be held liable for the payment of damages. All rights reserved in the event of the grant of a patent, utility model or design. Copyright reserved.