

FINAL DRAWING

REVISIONS				
REV.	DESCRIPTION	DATE	BY	APPROVED
-	See 124.08.00.TC	-	-	-

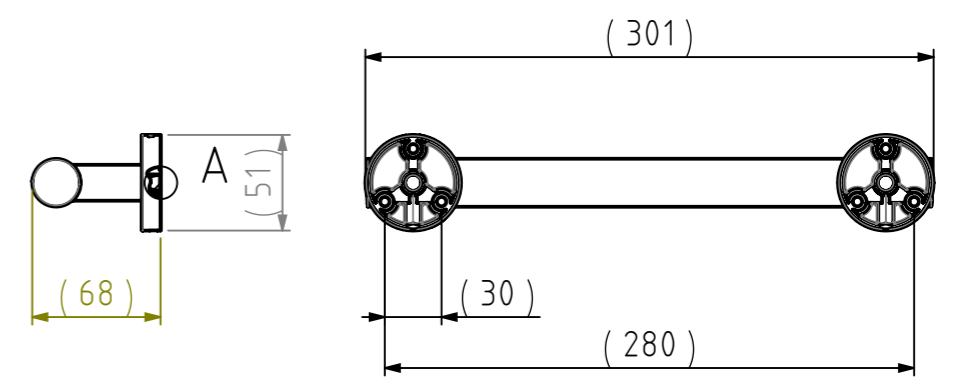
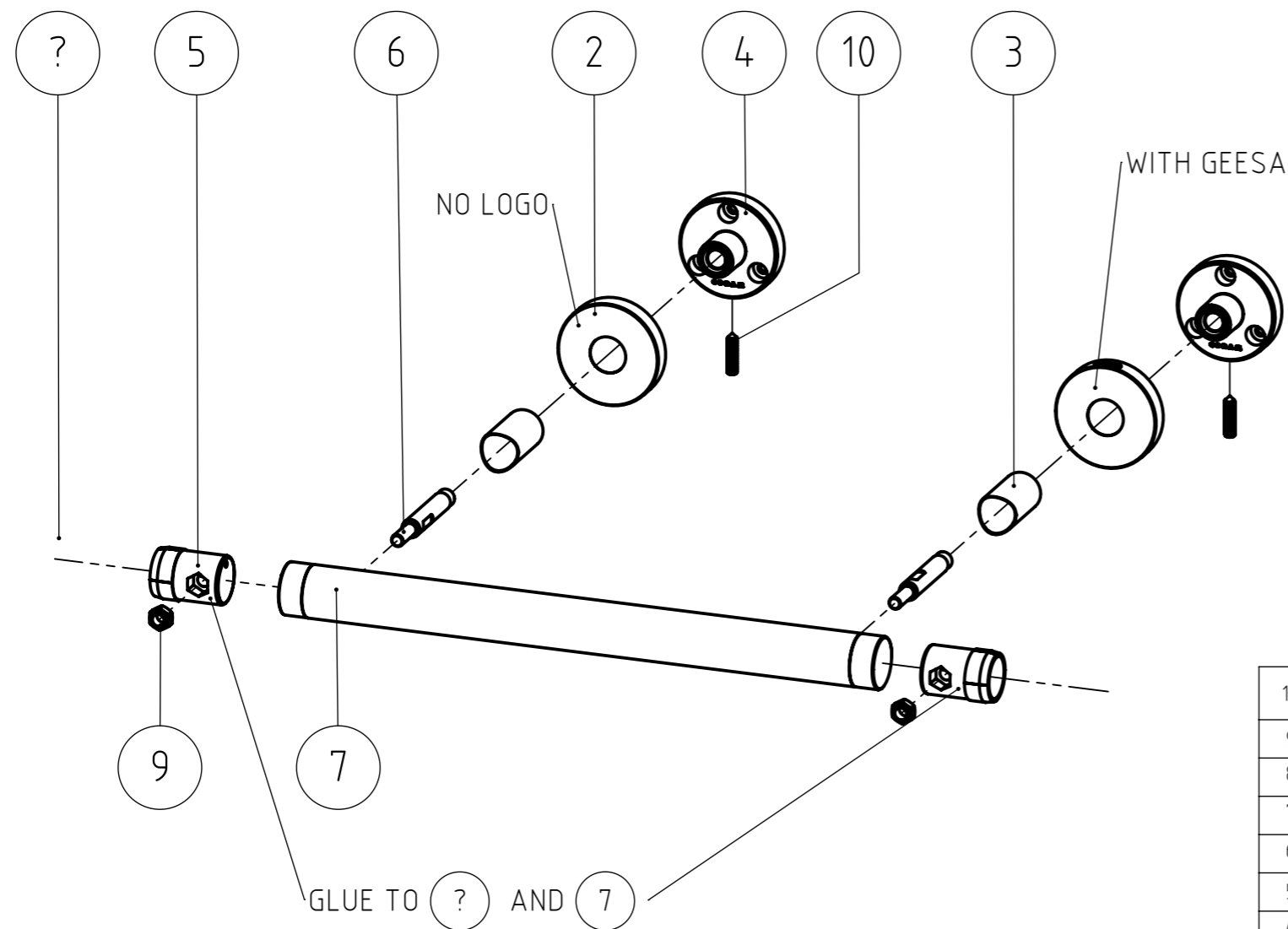

NR.	DESCRIPTION	QTY.	DRAW.NR.	MATERIAL	TREATMENT
10	HEX. SOCKET SET SCREW WITH CONE POINT, M5x20mm	2	DIN.0914	Stainless steel A2	-
9	SELF PREVAILING NUT, M6	2	DIN.0985	Stainless steel A2	-
8	Grip end cap	2	040.15.03	Stainless steel AISI 430	Chromium Plated
7	Grip	1	124.08.04	Stainless steel AISI 430	Chromium Plated
6	Assembly screw	2	124.08.03	Stainless steel 303 (CNC)	-
5	Tube connector	2	124.08.02	Zamac3	Chromium Plated
4	Wall bracket 3pt	2	124.08.01	Zamac5	Chromium Plated
3	Cover tube	2	124.02.05	Stainless steel AISI 430	Chromium Plated
2	Cover, no logo	1	124.02.04	Stainless steel AISI 430	Chromium Plated
1	Cover, logo	1	124.02.04	Stainless steel AISI 430	Chromium Plated

GENERAL DIMENSION UNLESS OTHERWISE STATED ACCORDING TO DIN 7168		DESCRIPTION:	
NOMINAL MEASUREMENTS (mm)		Grab rail	
CLASS	0.5 UNTIL 3	3 UNTIL 6	6 UNTIL 30
	30 UNTIL 120	120 UNTIL 400	400 UNTIL 1000
	1000 UNTIL 2000	2000 UNTIL 4000	
M (MIDDLE)	±0.1	±0.1	±0.2
	±0.3	±0.5	±0.8
	±1.2	±2	
PROJECTION:	GENERAL ANGLE:	EAN:	VERSION NAME:
	±0,5°	8712163192059	chrome plated
ARTICLE NR.:	915806-02	PROJECT:	124-Boston
DRAWN BY:	F.H.	GENERAL ROUGHNESS:	0,8/√
CHECKED BY:		DATE:	8-8-2006
STATUS:	Production	UNITS:	mm
PRINT DATE:	8-4-2026	SCALE:	1:3
INT.REV.NR.:	0601	FORMAT:	A3
		SHEET:	4/4
		DRAWING NR.:	124.08.00.TCP
		TIGER Tiger Nederland b.v. Winde 3, PO box 11 5660 AA Geldrop The Netherlands	

The reproduction, distribution and utilization of this document as well as the communication of its contents to others without express authorization is prohibited. Offenders will be held liable for the payment of damages. All rights reserved in the event of a patent, utility model or design. Copyright reserved.