

The reproduction, distribution and utilization of this document as well as the communication of its contents to others without express authorization is prohibited. Offenders will be held liable for the payment of damages. All rights reserved in the event of the grant of a patent, utility model or design. Copyright reserved.

1		2		3		4	
REVISIONS							
REV.	DESCRIPTION			DATE	BY	APPROVED	
1	Square ridge part added on the wall plate for fixing the tube			19-2-2013	FVP	FH	

FINAL DRAWING

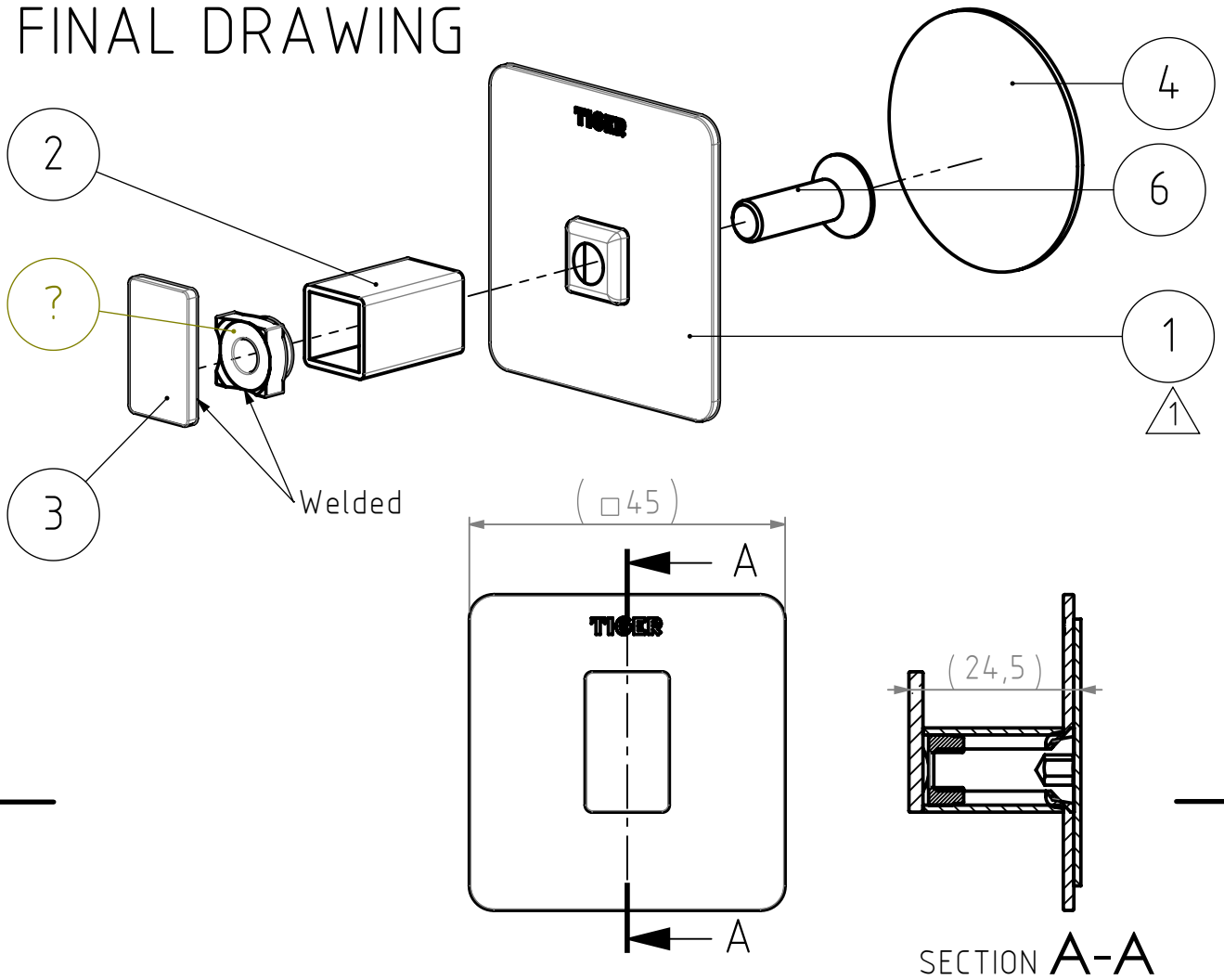

6	HEX. SOCKET COUNTERSUNK HEAD SCREW, M6x20mm	1	DIN 7991	Stainless steel A2	-
5	SQUARE WELD NUT, M6	1	DIN.928	STAINLESS STEEL	-
4	ADHESIVE FOAM	1	142.01.04	3M / NO.1600 / FOAM TAPE 1.0 MM	-
3	Hook pull	1	178.14.03	Stainless steel 430	Brushed
2	Tube	1	178.14.02	Stainless steel 430	Brushed
1	Wall plate	1	178.14.01	Stainless steel 430	Brushed
ART.NR.	DESCRIPTION	QTY.	DRAW.NR.	MATERIAL	TREATMENT

GENERAL DIMENSION UNLESS OTHERWISE STATED ACCORDING TO DIN 7168									DESCRIPTION: Hook pull square
CLASS	NOMINAL MEASUREMENTS (mm)								
	0.5 UNTIL 3	3 UNTIL 6	6 UNTIL 30	30 UNTIL 120	120 UNTIL 400	400 UNTIL 1000	1000 UNTIL 2000	2000 UNTIL 4000	
M (MIDDLE)	±0.1	±0.1	±0.2	±0.3	±0.5	±0.8	±1.2	±2	

PROJECTION: 	GENERAL ANGLE: ±0,5°	VERSION NAME: stainless steel	ARTICLE NR. (packed product): 11160.3.09.41 (for packaging information see GDS)
DRAWN BY: FVP	GENERAL ROUGHNESS: 0,8	PROJECT: 178-HOOKS	 Tiger Products b.v. Winde 3, PO box 11 5660 AA Geldrop The Netherlands
CHECKED BY: W.W.	UNITS: mm	DRAWING NR.:	
DATE: 14-8-2012	SCALE: 1:1	178.14.00.TS	
STATUS: Production	FORMAT: A4		
PRINT DATE: 7-4-2026	SHEET: 1/1		
INT.REV.NR.: 1			