

FINAL DRAWING

REVISIONS				
REV.	DESCRIPTION	DATE	BY	APPROVED
1	- Screws, plugs and L-tool added to assembly drawing. - Black version created.	9-10-2017	MS	WW
2	- Colour of "130.02.09 Sleeve A" changed to PMS 432C for Stainless steel and Chrome version.	26-2-2019	MS	MSm

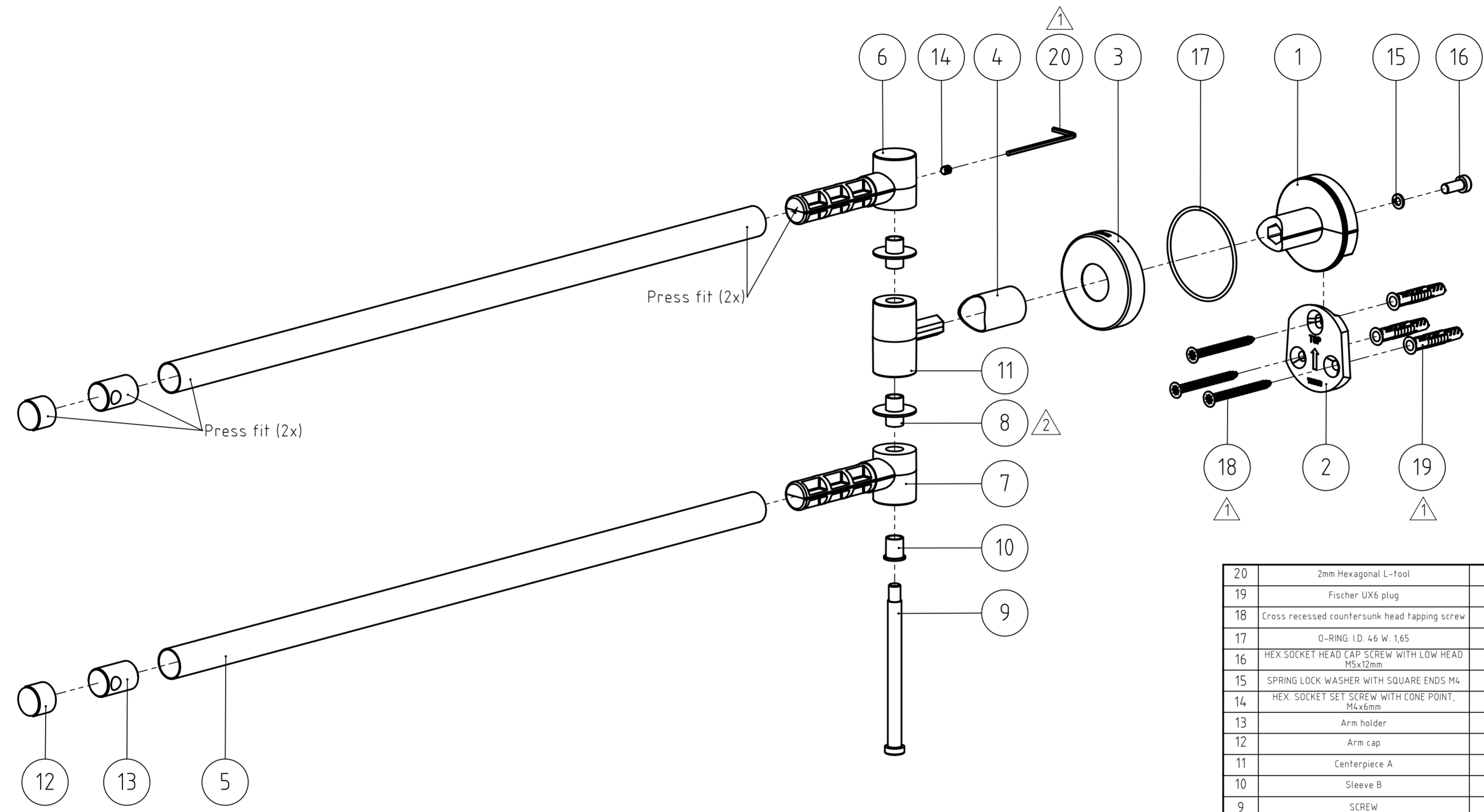

NR.	DESCRIPTION	QTY.	DRAW.NR.	MATERIAL	TREATMENT
20	2mm Hexagonal L-tool	1	DIN.911	Tool steel	-
19	Fischer UX6 plug	3	FIX.0028	-	-
18	Cross recessed countersunk head tapping screw	3	DIN.7982 CZ	Stainless steel A2	-
17	O-RING: I.D. 4.6 W. 1,65	1	BUY-IN	RUBBER, BLACK	Technical Smooth
16	HEX SOCKET HEAD CAP SCREW WITH LOW HEAD M5x12mm	1	DIN.6912	Stainless steel A2	-
15	SPRING LOCK WASHER WITH SQUARE ENDS M4	1	DIN.127 B	STAINLESS STEEL A2	-
14	HEX. SOCKET SET SCREW WITH CONE POINT, M4x6mm	1	DIN.0914	Stainless steel A2	-
13	Arm holder	2	04.0.10.03	Zamac3	Chromium Plated
12	Arm cap	2	04.0.06.07	Stainless steel AISI 304	Polished - High gloss
11	Centerpiece A	1	04.0.06.05	Zamac3	Chromium Plated
10	Sleeve B	1	130.02.11	PA 6 - transparent white RAL 9002	Technical Smooth
9	SCREW	1	130.02.10	STAINLESS STEEL A2	-
8	Sleeve A	2	130.02.09	PA 6 - Black RAL 9005, semi gloss	Technical Smooth
7	Lower arm holder	1	130.02.07	Zamac3	Chromium Plated
6	Upper arm holder	1	130.02.06	Zamac3	Chromium Plated
5	Arm	2	130.02.05	Stainless steel AISI 304	Polished - High gloss
4	Tube	1	130.02.04	Stainless steel AISI 304	Polished - High gloss
3	Cover	1	130.02.03	Stainless steel AISI 304	Polished - High gloss
2	Wall plate	1	130.02.02	Zamac3	Chromium Plated
1	Wall bracket	1	130.02.01	Zamac3	Chromium Plated

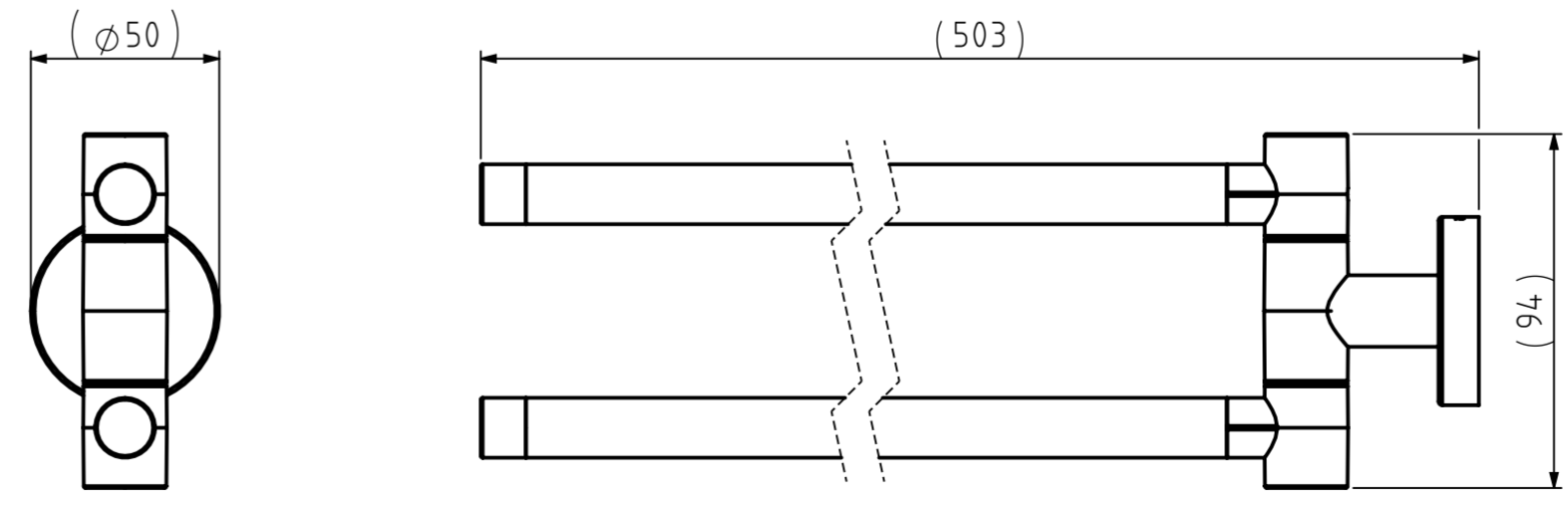

GENERAL DIMENSION UNLESS OTHERWISE STATED ACCORDING TO DIN 7168 NOMINAL MEASUREMENTS (mm)		DESCRIPTION:	
CLASS	0.5 UNTIL 3 3 UNTIL 6 6 UNTIL 30 30 UNTIL 120 120 UNTIL 400 400 UNTIL 1000 1000 UNTIL 2000 2000 UNTIL 4000	±0.1 ±0.1 ±0.2 ±0.3 ±0.5 ±0.8 ±1.2 ±2	Towel rail (2 arms)
PROJECTION:	GENERAL ANGLE: ±0.5°	EAN: 4008913087411	VERSION NAME: chrome
DRAWN BY:	MS	GENERAL ROUGHNESS: 0.8	PROJECT: 130-Boston
CHECKED BY:			DRAWING NR: 130.02.00.TC
DATE:	9-10-2017	UNITS: mm	<p>Tiger Products b.v. Winde 3, PO box 11 5660 AA Geldrop The Netherlands</p>
STATUS:	Production	SCALE: 1:2	
PRINT DATE:	25-9-2024	FORMAT: A2	
INT.REV.NR.:	0000	SHEET: 1/3	

The reproduction, distribution and utilization of this document as well as the communication of its contents to others without express authorization is prohibited. Offenders will be held liable for the payment of damages. All rights reserved in the event of the grant of a patent, utility model or design. Copyright reserved.