

# FINAL DRAWING

REVISIONS				
REV.	DESCRIPTION	DATE	BY	APPROVED
-	See 040.05.00.TC	-	-	-

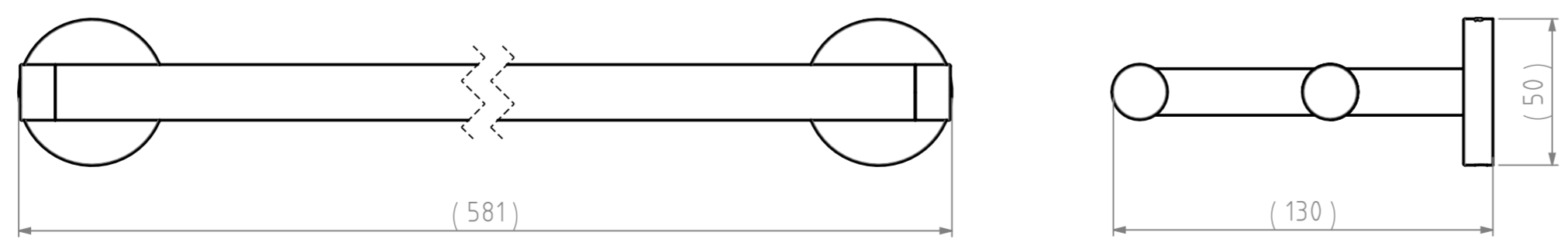
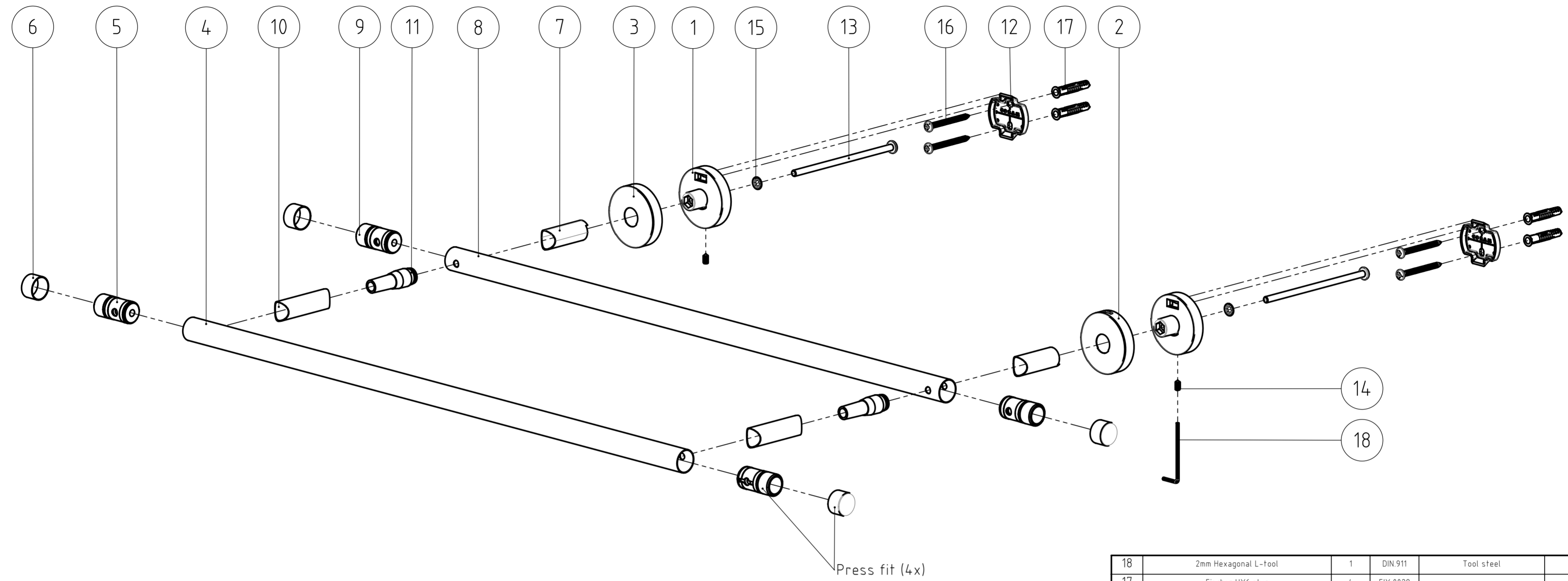

NR.	DESCRIPTION	QTY.	DRAW.NR.	MATERIAL	TREATMENT
18	2mm Hexagonal L-tool	1	DIN 911	Tool steel	-
17	Fischer UX6 plug	4	FIX.0028	-	-
16	Cross recessed pan head Tapping screw st14,2x45mm	4	DIN 7981 CZ	Stainless steel A2	-
15	Tooth lock washer with internal teeth M5	2	DIN 6797	Stainless steel A2	-
14	HEX. SOCKET SET SCREW WITH CONE POINT, M4x8mm	2	DIN 0914	Stainless steel A2	-
13	CROSS RECESSED RAISED CHEESE HEAD SCREW M5x110mm	2	ISO.7045	Stainless steel A2	-
12	Wallplate Type 1	2	226.03.02	Stainless steel AISI 304	Sand blasted
11	Spacer	2	040.05.06	Polypropylene (PP)	Technical Smooth
10	Support tube C	2	040.05.04	Stainless steel AISI 430	Powder coated, texture VDI 3400 ref.30 - RAL 9005 (Jet black)
9	Tube connector B	2	040.05.03	Zamac3	Chromium Plated
8	Second bar	1	040.05.02	Stainless steel AISI 430	Powder coated, texture VDI 3400 ref.30 - RAL 9005 (Jet black)
7	Support tube B	2	040.05.01	Stainless steel AISI 430	Powder coated, texture VDI 3400 ref.30 - RAL 9005 (Jet black)
6	End cap	4	040.03.07	Stainless steel AISI 430	Powder coated, texture VDI 3400 ref.30 - RAL 9005 (Jet black)
5	Tube connector A	2	040.03.03	Zamac3	Chromium Plated
4	Front bar	1	040.03.02	Stainless steel AISI 430	Powder coated, texture VDI 3400 ref.30 - RAL 9005 (Jet black)
3	Cover (no logo)	1	040.01.03	Stainless steel AISI 430	Powder coated, texture VDI 3400 ref.30 - RAL 9005 (Jet black)
2	Cover	1	040.01.03	Stainless steel AISI 430	Powder coated, texture VDI 3400 ref.30 - RAL 9005 (Jet black)
1	Wall support	2	040.01.01	Zamac3	Chromium Plated

GENERAL DIMENSION UNLESS OTHERWISE STATED ACCORDING TO DIN 7168		DESCRIPTION:	
CLASS	NOMINAL MEASUREMENTS (mm)	Double towel rack	
	0.5 UNTIL 3		
	3 UNTIL 6		
	6 UNTIL 30		
	30 UNTIL 120		
	120 UNTIL 400		
	400 UNTIL 1000		
	1000 UNTIL 2000		
	2000 UNTIL 4000		
M (MIDDLE)	±0.1	±0.1	±0.2
		±0.3	±0.5
		±0.8	±1.2
			±2
PROJECTION:	GENERAL ANGLE:	EAN:	VERSION NAME:
	±0.5°	4008913086421	black
DRAWN BY:	MS	GENERAL ROUGHNESS:	0.8
CHECKED BY:	FVP	UNITS:	mm
DATE:	26-7-2006	SCALE:	1:2
STATUS:	Production	FORMAT:	A2
PRINT DATE:	3-10-2024	SHEET:	3/3
INT.REV.NR.:	0100		
		PROJECT:	040-Boston
		DRAWING NR.:	040.05.00.TB
		ARTICLE NR.:	3086.3.07.46



The reproduction, distribution and utilization of this document as well as the communication of its contents to others without express authorization is prohibited. Offenders will be held liable for the payment of damages. All rights reserved in the event of a patent, utility model or design. Copyright reserved.