

Suction cup BL30-5 Silicone

Article number: 0121519



- High initial flow, with re-enforced bellows and long, thin lip
- Suitable for handling difficult-to-handle bags, e.g., bags filled with liquid, frozen food, and for heavy bags
- Suitable working temperature is -40–200 °C
- Suitable for level compensation

Technical data

| Description | Unit | Value |
|-------------------------|-----------------|----------------|
| Suction cup shape | - | Multibellows |
| Application | - | Bag handling |
| Suction cup design | - | Round |
| Characteristics | - | Bag handling |
| Material | - | Silicone (SIL) |
| Weight, min. | g | 14.5 |
| Suction cup model | - | BL-5 |
| Volume | cm ³ | 8.55 |
| Height | mm | 36.5 |
| Outer diameter, min. | mm | 30.5 |
| Fitting size | - | None |
| Fitting option | - | None |
| Fitting style | - | None |
| Fitting type | - | None |
| Suction cup model | - | BL30-5 |
| Movement, vertical max. | mm | 11 |
| Curve radius, min. | mm | 17 |

Performance - Lifting forces

| BL30-5 | Vertical (N) | Parallel (N) |
|---------|--------------|--------------|
| 20 -kPa | 8 | 3 |
| 60 -kPa | 9 | 5.5 |

Material

| | |
|------------------------|---------------------------|
| Name | Silicone, SIL 40° Shore A |
| Colour | Red |
| Temperature, min. °C | -40 |
| Temperature max. °C | 200 |
| Hardness °Shore A | 40 |

Material resistance

| | |
|--------------------|-----------|
| Alcohol | Good |
| Concentrated acids | Poor |
| Ethanol | n/a |
| Hydrolysis | Fair |
| Methanol | n/a |
| Oil | Poor |
| Oxidation | Excellent |
| Petrol | Poor |
| Wear resistance | Good |
| Weather and ozone | Excellent |

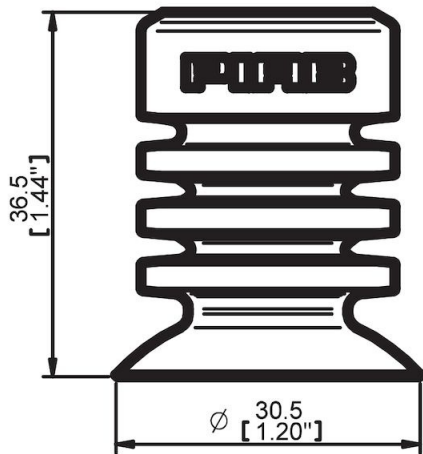

Values specified in this data sheet are tested at (unless otherwise stated):

- Room temperature (20°C [68°F] ± 3°C [5.5°F]).
- Standard atmosphere (101.3 [29.9 inHg] ± 1.0 kPa [0.3 inHg]).
- Relative humidity 20-70%.
- Compressed air quality, DIN ISO 8573-1 class 4.

Accessories

0118793 | Fitting G1/4" male, bag

0118794 | Fitting 1/4" NPT male, bag