

# Mounting bracket MB16L

Article number: 0200454

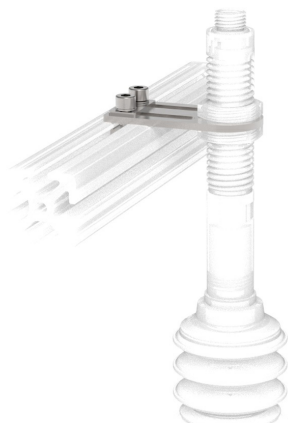

- Mounting brackets suitable for extruded profile systems.
- Level compensators and height adjusters with external thread in sizes M12, M16, M20 and M25 are ideal for clamping on the mounting brackets.
- Facilitates the installation of a suction cup and positioning in X-direction.
- Long and short versions available.

## Technical data

Description	Unit	Value
Material	-	Steel
Bending torque, max.	Nm	7
Load, torque, max.	Nm	7
Load, vertical, max.	N	200
Temperature, max.	°C	60
Temperature, min.	°C	-20
Weight, min.	g	65

## Dimensional drawings

