

# Suction cup F-OB 30x60 Silicone, G1/8"male SS, FCM

Article number: 0207047



- The silicone material complies with FDA 21 CFR 177.2600 and EU 1935/2004.
- Transparent color without pigment
- Long lasting high-end silicone material
- Excellent grip on oblong parts such as flow-packs and stick-packs
- Available with threaded and integrated stainless steel fittings.
- Easy to clean with hygienic design. No dust/dirt pockets.

## Technical data

| Description             | Unit            | Value   |
|-------------------------|-----------------|---|
| Suction cup shape       | -               | Bellows   |
| Application             | -               | Food contact materials (FDA & EU), non-detectable |
| Suction cup design      | -               | Oval  |
| Characteristics         | -               | Food contact materials (FDA & EU), non-detectable |
| Material                | -               | Silicone (SIL)                                    |
| Load, torque, max.      | Nm              | 13  |
| Weight, min.            | g               | 53.14   |
| Suction cup model       | -               | F-OB  |
| Volume                  | cm <sup>3</sup> | 17.5  |
| Height                  | mm              | 44.8  |
| Length                  | mm              | 62  |
| Fitting size            | -               | 1/8"  |
| Fitting option          | -               | None  |
| Fitting style           | -               | Male  |
| Fitting type            | -               | G-thread  |
| Width                   | mm              | 32  |
| Material                | -               | ASTM 316L   |
| Suction cup model       | -               | F-OB 30x60  |
| Movement, vertical max. | mm              | 10.9  |
| Curve radius, min.      | mm              | 11  |

## Performance - Lifting forces

| F-OB 30x60 | Vertical (N) | Parallel (N) |
|------------|--------------|--------------|
| 10 -kPa    | 8            | 8.1          |
| 20 -kPa    | 17.2         | 13.4         |
| 40 -kPa    | 31.1         | 27.5         |

## Material

|                        |                                   |
|------------------------|-----------------------------------|
| Name                   | Silicone (SIL non-detectable FCM) |
| Colour                 | Transparent                       |
| Temperature, min.   °C | -40                               |
| Temperature max.   °C  | 200                               |
| Hardness   °Shore A    | 40                                |

## Material resistance

|                    |           |
|--------------------|-----------|
| Alcohol            | Good      |
| Concentrated acids | Poor      |
| Ethanol            | n/a       |
| Hydrolysis         | Fair      |
| Methanol           | n/a       |
| Oil                | Poor      |
| Oxidation          | Excellent |
| Petrol             | Poor      |
| Wear resistance    | Good      |
| Weather and ozone  | Excellent |

## Dimensional drawings

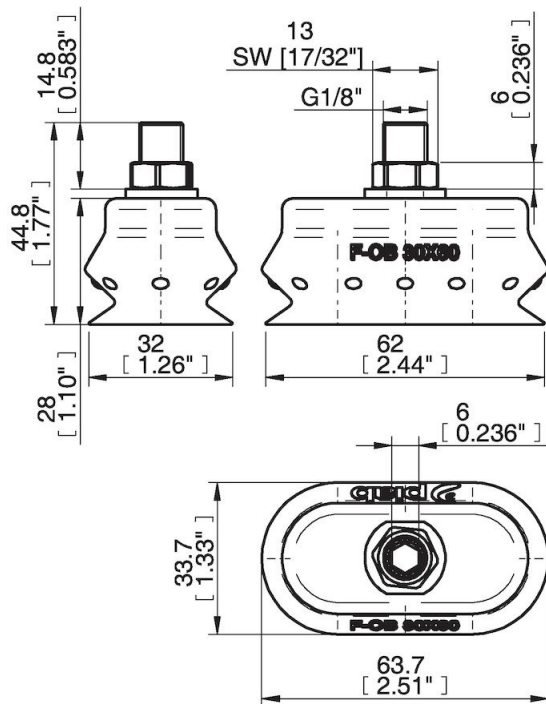

## Values specified in this data sheet are tested at (unless otherwise stated):

- Room temperature (20°C [68°F] ± 3°C [5.5°F]).
- Standard atmosphere (101.3 [29.9 inHg] ± 1.0 kPa [0.3 inHg]).
- Relative humidity 20-70%.
- Compressed air quality, DIN ISO 8573-1 class 4.