

# Suction cup BX75P Polyurethane 30/60 with filter, 3/8" NPSF female

Article number: 0108794

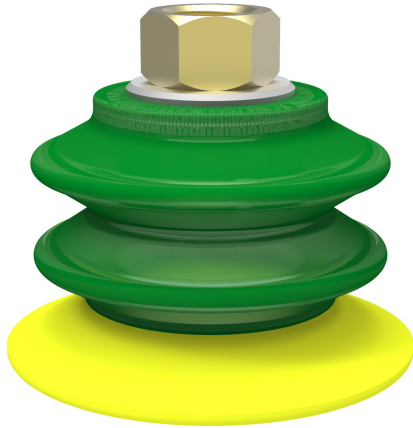

- Suitable for level adjustment and for uneven and porous surfaces such as cardboard, etc.
- In the two-coloured suction cup the bellows and the sealing lip are of different hardnesses, which makes the suction cup strong and stable and, at the same time, soft and flexible.
- DURAFLEX® suction cups manufactured in a specially developed material that features the elasticity of rubber and wear resistance of polyurethane.
- The material DURAFLEX® is mark free.

## Technical data

| Description             | Unit            | Value  |
|-------------------------|-----------------|--|
| Suction cup shape       | -               | Multibellows   |
| Application             | -               | Dry sheet metal, Corrugated / cardboard, Plastic injection molded parts, Mark Free |
| Suction cup design      | -               | Round  |
| Characteristics         | -               | Dry sheet metal, Corrugated / cardboard, Plastic injection molded parts, Mark free |
| Material                | -               | Polyurethane (PU)  |
| Weight, min.            | g               | 71   |
| Suction cup model       | -               | BX-P   |
| Volume                  | cm <sup>3</sup> | 80   |
| Height                  | mm              | 64.7   |
| Outer diameter, min.    | mm              | 77.5   |
| Fitting size            | -               | 3/8"   |
| Fitting option          | -               | None   |
| Fitting style           | -               | Female   |
| Fitting type            | -               | NPSF-thread  |
| Suction cup model       | -               | BX75P PU30 PU60  |
| Movement, vertical max. | mm              | 26   |
| Curve radius, min.      | mm              | 23   |

## Performance - Lifting forces

| BX75P PU30 PU60 | Vertical (N) | Parallel (N) |
|-----------------|--------------|--------------|
| 20 -kPa         | 62           | 39           |
| 60 -kPa         | 110          | 83           |
| 90 -kPa         | 141          | 116          |

| <b>Material</b>            |                     |                     |
|----------------------------|---------------------|---------------------|
| Name                       | Polyurethane (PU30) | Polyurethane (PU60) |
| Colour                     | Yellow              | Green transparent   |
| Temperature, min.   °C     | 10                  | 10                  |
| Temperature max.   °C      | 50                  | 50                  |
| Hardness   °Shore A        | 30                  | 60                  |
| <b>Material resistance</b> |                     |                     |
| Alcohol                    | n/a                 | n/a                 |
| Concentrated acids         | Fair                | Fair                |
| Ethanol                    | Fair                | Fair                |
| Hydrolysis                 | Fair                | Fair                |
| Methanol                   | Poor                | Poor                |
| Oil                        | Excellent           | Excellent           |
| Oxidation                  | Poor                | Poor                |
| Petrol                     | Fair                | Fair                |
| Wear resistance            | Excellent           | Excellent           |
| Weather and ozone          | Excellent           | Excellent           |

**Dimensional drawings**

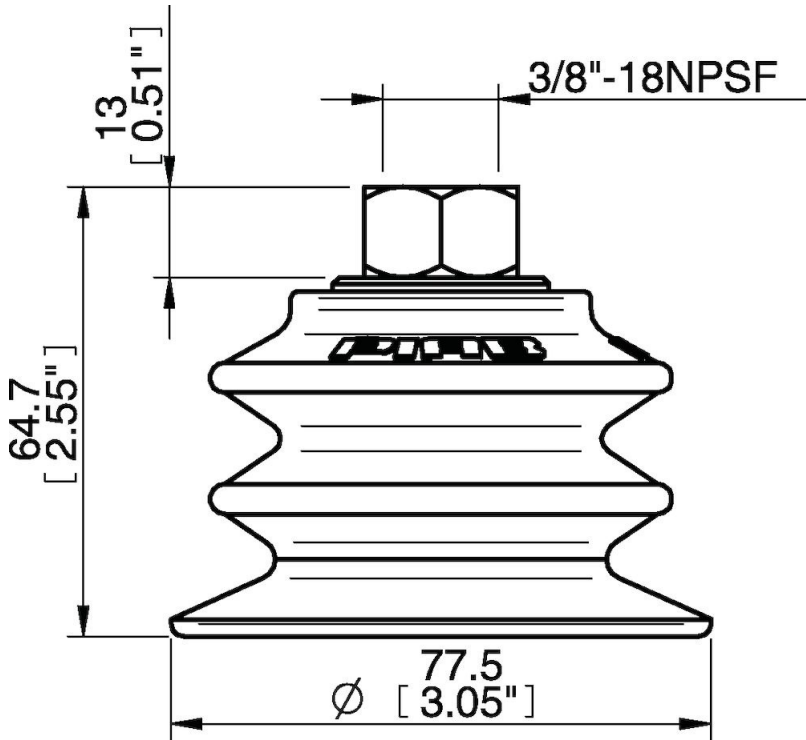

**Values specified in this data sheet are tested at (unless otherwise stated):**

- Room temperature (20°C [68°F] ± 3°C [5.5°F]).
- Standard atmosphere (101.3 [29.9 inHg] ± 1.0 kPa [0.3 inHg]).
- Relative humidity 20-70%.
- Compressed air quality, DIN ISO 8573-1 class 4.

**Accessories**

- 0106797 | Thread insert G3/8" male, with O-ring
- 0107150 | Suction cup BX75P Polyurethane 60 with filter, for thread insert
- 0200716 | Thread insert G1/8" male, with O-ring and mesh filter
- 0201077 | Thread insert G1/4" male, with O-ring and mesh filter

**Spare parts**

- 0107145 | Suction cup BX75P Polyurethane 30/60 with filter, for thread insert
- 0201003 | Suction cup filter BX75P, 10 pcs