

FIREMAT

Technical matting

FIRE RESISTANT

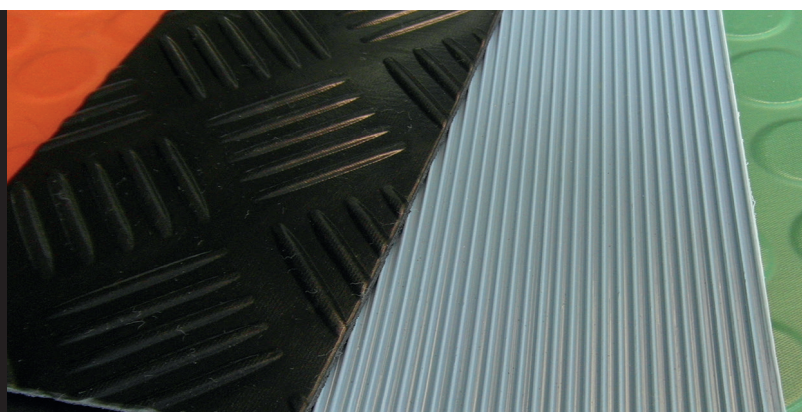

MECHANICAL, PHYSICAL AND CHEMICAL PROPERTIES

	Measured characteristics	Standard	Value	
MECHANICAL				
Rubber compound			synthetic	
Hardness		ASTM D2240	80 ±5	Shore A
Abrasion resistance (5N)		ISO 4649	≤200	mm³
Residual indentation		EN ISO 24343	≤0.15	mm
Dimensional stability		EN ISO 23999	±0.3	%
Sound insulation		ISO 10140-3	12	dB
CHEMICAL RESISTANCE				
Common cleaning products		EN 423	Good	

PROFILE

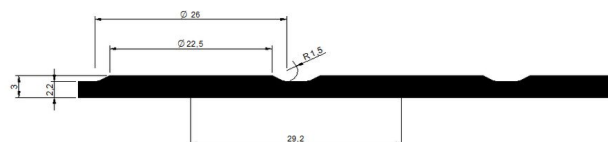

PATTERN



Circular studs (MC 2K1)

FEATURES

- Fire resistant and low, translucent, and non toxic smoke emission matting qualities
- Reaction to fire and smoke characteristics Bfl s1, following EN 13501-1
- Circular studs
- Backface: impression

ADVANTAGES

- Fire-retardant.
- Low reduced emission of smoke opacity, for easy finding of emergency exits
- Thermal and acoustic insulation
- Excellent walking and standing comfort
- Non-slippery
- Easy to clean and low maintenance
- Noise, vibration, and cold propagation reduction

APPLICATIONS

- Suitable for:
 - public or industrial area where fire protection is required (airports, supermarkets, swimming pools, sports halls, etc.)
 - mass transport (bus, railway, ships, underground, etc.)

MAINTENANCE RECOMENDATION

Always follow manufacturer warnings and instructions when using any cleaning product.

DIMENSIONS

Code	Stock sit.	Colour	Thickness (mm)		Width (mm)		Length (m)		Weight (kg/m ²)	Pattern	Back face	Dielectric strenght	Marking band	Inner carboard tube Ø mm
0030045	stock	●	3	±0.3	1200	±2%	10	±2%	4.4	MC	impression	-	-	80
0030046	no stock	●	3	±0.3	1200	±2%	10	±2%	4.4	MC	impression	-	-	80
MCD91400003002	no stock	●	3	±0.3	1000	±2%	10	±2%	4.4	MC	impression	-	-	80
0039173	no stock	●	3	±0.3	1000	±2%	10	±2%	4.4	MC	impression	-	-	80

PACKAGING

94/62/EC

Labelling	Self-adhesive label indicating product name, dimensions, area in m ² , nominal weight, and product code to allow product traceability.	LDPE4
Wrapping	Black polyethylene film.	LDPE4

Other colours are available under request.

Depending on the manufacturing process there could be differences in some tonalities of the roll colours.

Colours of the sample kits and catalogues has to be considered as indicative.

Unless typographical error, information and figures of our technical datasheet are based on our experience and laboratory tests according to international standards. This data is intended to be used as a guideline only. Material performance depends on the conditions of use and the final application.