

Retro Reflective Marker

RETRO-Reflective Marker

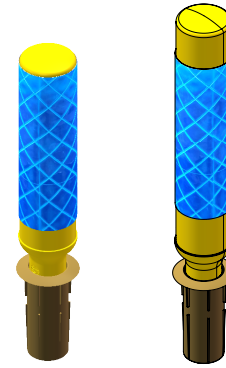

Standards

- ICAO Annex 14 - Aérodrome - §5.5.5
- FAA L-853, AC 150/5345-39

Uses

- Retro-reflective marking of taxiway and apron edges.

Features/Benefits

- Improved safety: reflective markers greatly reduce the “sea of blue” effect experienced by many pilots
- Cylindrical shape for full omnidirectional light reflection (360°)
- Corrosion-proof, aviation yellow HDPE body, withstanding UV rays
- Supplied with high intensity, blue retro-reflective sleeve. The blue colour strictly complies with ICAO, Annex 14, “Surface Marking Colours”
- Highly visible in all weather condition, day or night
- No electricity required: reflects aircraft landing and wing tip lights
- Frangible: if the marker is struck by an aircraft or vehicle, the plastic body causes no damage
- Easy installation by self-clamping fixing concept between post and in-ground base
- Easy mounting: it can be fixed directly into the ground or pavement. The optional ground mounting socket improves stability.
- Jet blast resistant
- Maintenance free
- Easy replacement by self-clamping fixing concept

Photometrics

- The blue colour strictly complies with ICAO, Annex 14, “Surface Marking Colours”

Electrical Supply

- No electricity required: reflects aircraft landing and wing tip lights

Ordering Codes

- Complete retro-reflective marker:
- **ADB20801006** - yellow pole with blue reflector
- **ADB20801016** - yellow pole with blue reflector SHORT version (complying with ICAO general recommendation for maximal height of 35cm)
- Spares
- **ADB20880001** - Yellow pole (without blue reflector & socket)
- **ADB20880011** - Yellow pole SHORT (without blue reflector & socket)
- **ADB46000083** - Blue reflector
- **ADB20880020** - Ground mounting socket

Installation

- The retro-reflective marker can be set directly into the ground or pavement, with or without optional ground mounting socket.
- The ground mounting socket improves stability and makes replacing the marker easier.

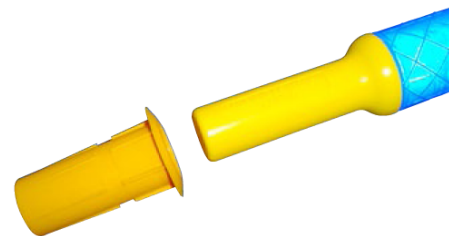

Dimensions/Packaging/Weight - Etc.

- Height: 555 mm (475mm - Short version)
- Diameter: 75 mm
- Sleeve height: 135 mm
- Weight complete marker: 313gr
- Weight ground mounting socket: 53gr
- All items come in packages of 10 units

(order by multiple of 10)

TAXIWAY LIGHTING

Retro Reflective Marker

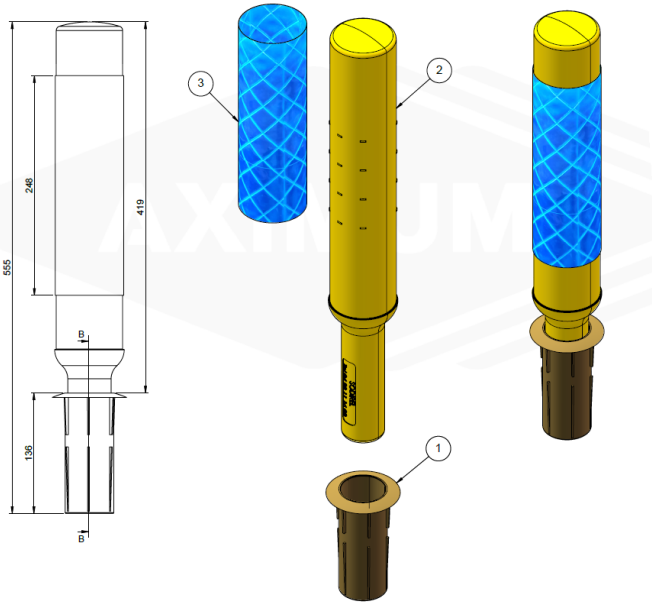

- Standard Marker

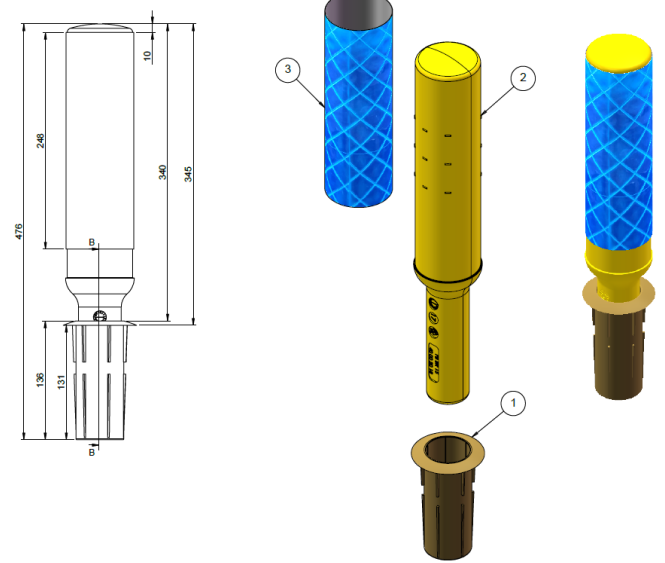

- Short Marker

Accessories

- Ground mounting socket: ADB20880020

www.adbsafegate.com

Product specifications may be subject to change, and specifications listed here are not binding. Confirm current specifications at time of order.