

**MX6**<sup>™</sup>  
**MX630**<sup>™</sup>  
**MX8**<sup>™</sup>  
**MX8**<sup>™</sup> **PRO**  
**MX9**<sup>™</sup>  
**MX930**<sup>™</sup>  
**MX10**<sup>™</sup>

**Instructions for installation and use - English**  
Hydraulic cleaner  
Translation of the original instructions in French

**EN**

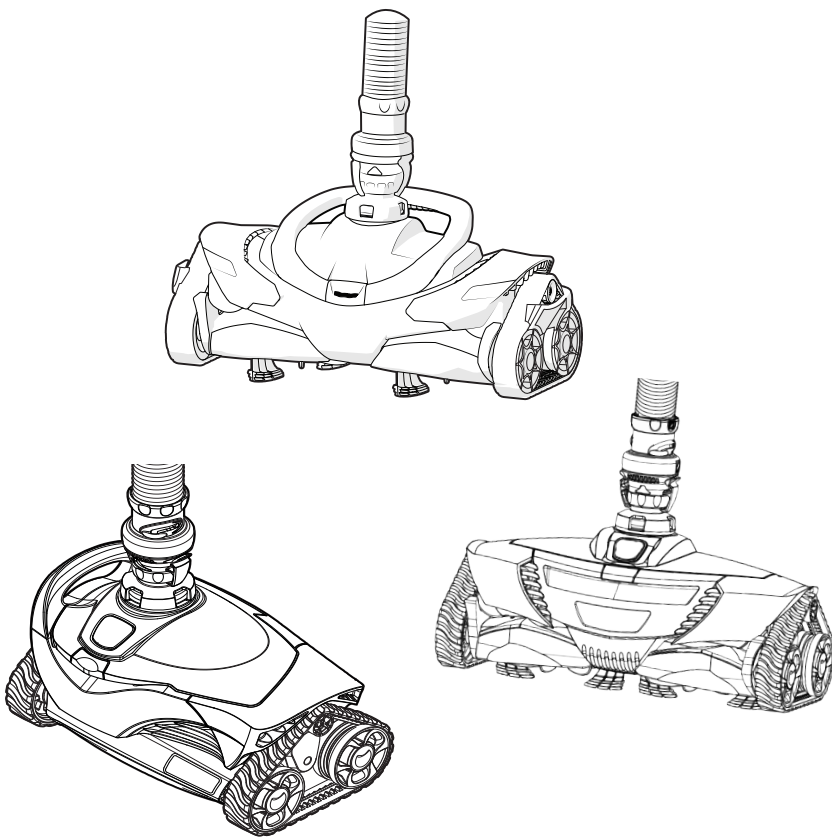

More documents on:  
[www.zodiac.com](http://www.zodiac.com)

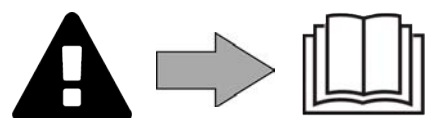

## WARNINGS

- Before handling the appliance, it is vital that you read this installation and user manual, as well as the "Warranties" booklet delivered with the appliance. Failure to do so may result in material damage or serious or fatal injury and will void the warranty.
- Keep and pass on these documents for reference during the appliance's service life.
- The distribution or modification of this document in any way is prohibited, without prior authorisation from the manufacturer.
- The manufacturer is constantly developing its products to improve their quality. The information contained herein may therefore be modified without notice.

### GENERAL WARNINGS

- Failure to respect the warnings may cause serious damage to the pool equipment or cause serious injury, even death.
- Only a person qualified in the technical fields concerned (electricity, hydraulics or refrigeration) is authorised to carry out maintenance or repair work on the appliance. The qualified technician working on the appliance must use/wear personal protective equipment (such as safety goggles and protective gloves, etc.) in order to reduce the risk of injury occurring when working on the appliance.
- The appliance is intended to be used for pools and spas for a specific purpose; it must not be used for any purpose other than that for which it was designed.
- This appliance is not intended for use by individuals (including children) with impaired physical, sensorial or mental abilities, or persons lacking in knowledge and experience, unless they receive supervision or prior instructions on using the appliance from a person responsible for their safety. Children must be supervised to ensure that they do not play with the appliance.
- The appliance must be installed according to the manufacturer's instructions and in compliance with local and national standards. The installer is responsible for installing the appliance and for compliance with national installation regulations. Under no circumstances may the manufacturer be held liable in the event of failure to comply with applicable local installation standards.
- For any work other than the simple user maintenance described in this manual, the product should be referred to a qualified professional.
- If the appliance suffers a malfunction, do not try to repair it yourself; instead contact a qualified technician.
- Refer to the warranty conditions for details of the permitted water balance values for operating the appliance.
- Deactivating, eliminating or by-passing any of the safety mechanisms integrated into the appliance shall automatically void the warranty, in addition to the use of spare parts manufactured by unauthorised third-party manufacturers.
- Do not spray insecticide or any other chemical (flammable or non-flammable) in the direction of the appliance, as this may damage the body and cause a fire.
- Do not touch the fan or moving parts and do not place objects or your fingers in the vicinity of the moving parts when the appliance is in operation. Moving parts can cause serious injury or even death.

**SPECIFIC FEATURES APPLICABLE TO "Pool cleaners"**

- The cleaner is designed to operate properly in pool water at a temperature of between 15°C and 35°C.
- To avoid possible injury or damage to the cleaner, do not operate the cleaner out of the water.
- In order to prevent possible injury, bathing is prohibited when your cleaner is in the pool.
- Do not use the cleaner during shock chlorination.
- Do not leave the cleaner unattended for an extended period.





**WARNING ON THE USE OF A CLEANER IN A POOL WITH A LINER:**

- Before installing the cleaner, carefully inspect the pool lining. If the liner is damaged in places, do not install the cleaner before a qualified professional repairs or replaces the liner. The manufacturer may not be held liable in any way for damage caused to the liner.
- The surface of certain patterned liners can wear away quickly: the patterns and/or colours can become deteriorated, faded or disappear on contact with certain objects. The cleaner manufacturer may not be held liable for wear to the liners or faded patterns, which are not covered by the limited warranty.

**WARNING ON THE USE OF A CLEANER IN A STAINLESS STEEL POOL:**

- Some stainless steel pools may have very fragile surfaces. The surface of these pools might get damaged by the basic friction of debris against the surface, for example caused by the wheels, tracks or brushes of cleaners, including electrical pool cleaner. The wear or scratching of stainless steel pools are not the liability of the manufacturer of the pool cleaner and are not covered by the limited warranty.

# CONTENTS

	<b>1 Specifications</b>	<b>4</b>
1.1   Description		4
1.2   Technical specifications and marking		5
	<b>2 Installation</b>	<b>6</b>
2.1   Setup		6
2.2   Hose section assembly		6
2.3   Hydraulic connections		7
	<b>3 Use</b>	<b>9</b>
3.1   Operating principle		9
3.2   Pool preparation		9
3.3   Operating		9
3.4   Adjusting the water flow		10
3.5   Choice of suction mode: small or large debris (according to model)		11
	<b>4 Maintenance</b>	<b>12</b>
4.1   Cleaning the filtration pump basket		12
4.2   Cleaning the "Cyclonic™" Leaf Catcher		12
4.3   Removing debris from the motor		13
4.4   Replacing the tracks		14
4.5   Storage and winterizing		14
	<b>5 Troubleshooting</b>	<b>15</b>
5.1   Device behaviour		15

EN



**Tip: to make it easier to contact your reseller**

Write down your reseller's contact details to help you find them more easily and fill in the "product" information on the back of the manual; your reseller will ask you for this information.



# 1 Specifications

## 1.1 I Description

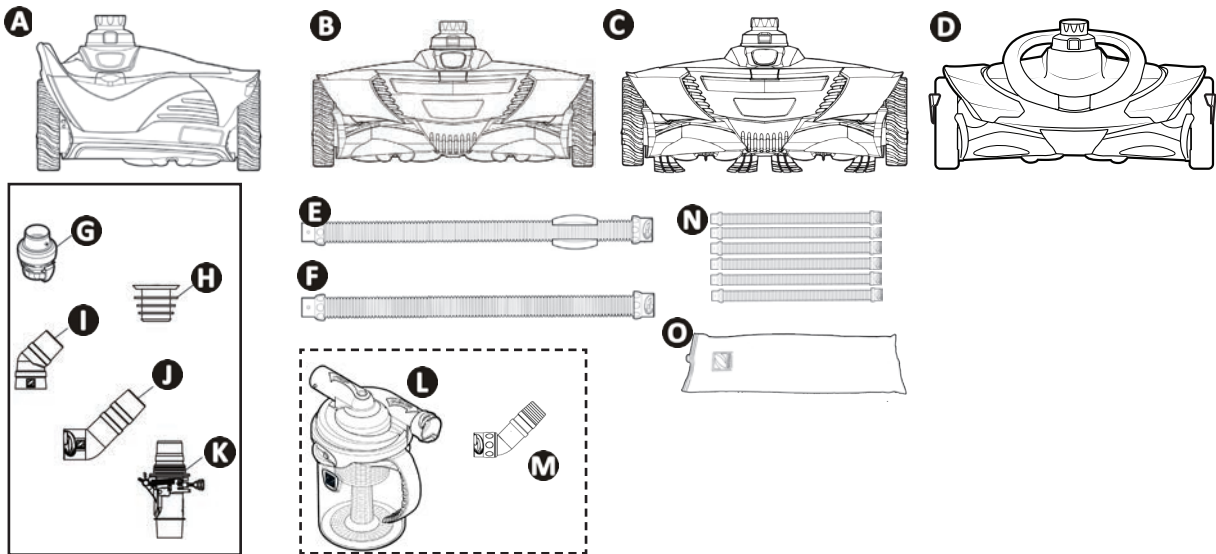

		MX™ 6 MX™ 630	MX™ 8	MX™ 8 PRO	MX™ 9 MX™ 930	MX™ 10
A	Cleaner	✓				
B			✓	✓		
C					✓	
D						✓
E	1 metre Twist Lock hose float section (x1)	✓	✓	✓	✓	✓
F	1 metre Twist Lock hose section	✓ (x9)	✓ (x11)	✓ (x11)	✓ (x11)	✓ (x11)
G	Flow regulator valve	✓	✓	✓	✓	✓
H	In-ground valve cuff	✓	✓	✓	✓	✓
I	45° flexible elbow	✓	✓	✓	✓	✓
J	Flowkeeper valve	✓	✓	✓	✓	✓
K	45° Twist Lock elbow extended	✓	✓		✓	✓
L	“Cyclonic™” Leaf Catcher	+	+	✓	+	+
M	Rotating 45° extended elbow	+	+	✓	+	+
N	Set of 6 1-metre Twist Lock hose sections	+	+	+	+	+
O	Wintering bag for hoses	+	+	+	+	+

✓: Supplied

+: Available as an option

## ➤ 1.2 I Technical specifications and marking

### 1.2.1 Technical specifications

	MX™ 6 MX™ 630	MX™ 8	MX™ 8 PRO	MX™ 9 MX™ 930	MX™ 10
Cleaner size (L x W x h)	31 x 19 x 22 cm	41 x 19 x 22 cm			
Package size (L x W x h)	102 x 23 x 37 cm				
Cleaner weight	2.5 kg	3.2 kg		3.4kg	
Packaged weight	8.2 kg	9.5 kg	10.5 kg	9.5 kg	
Theoretical cleaning width	25 cm	36 cm			
Filtration capacity	Pool filtering circuit				
Minimum powered required for the filtering pump.	3/4 HP				
Movement speed	8 m/ min				

EN

### 1.2.2 Marking

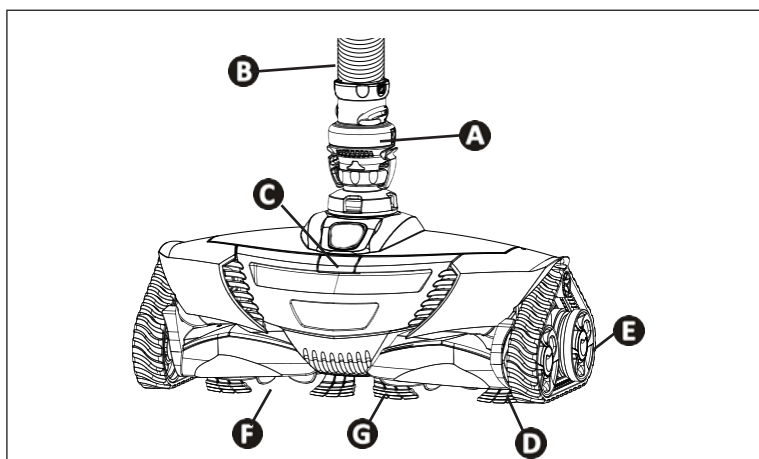

- A**: Flow regulator valve
- B**: Hose section
- C**: Cover opening button
- D**: Tracks
- E**: Wheels
- F**: Turbines
- G**: Brushes (according to model)



## 2 Installation

### 2.1 I Setup

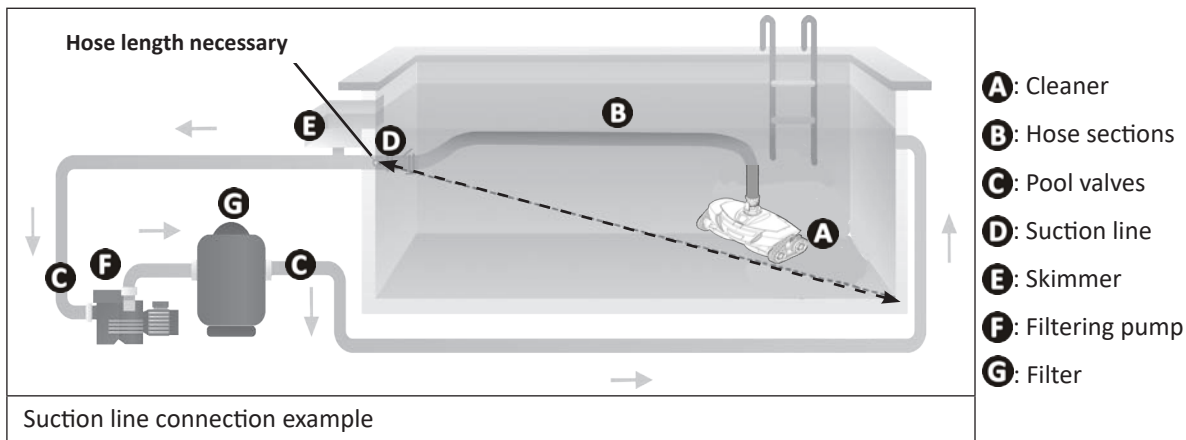

### 2.2 I Hose section assembly

#### 2.2.1 Determine the number of sections you need

- Measure the length between the suction line or the skimmer and the furthest away point of the pool.
- Add an extra 1 metre to the length measured.
- If total length is over 10 metres (MX™6 - MX™630) or 12 metres (MX™8 - MX™8 PRO - MX™9 - MX™930 - MX™10), contact your reseller to purchase any additional hose sections required for your pool.

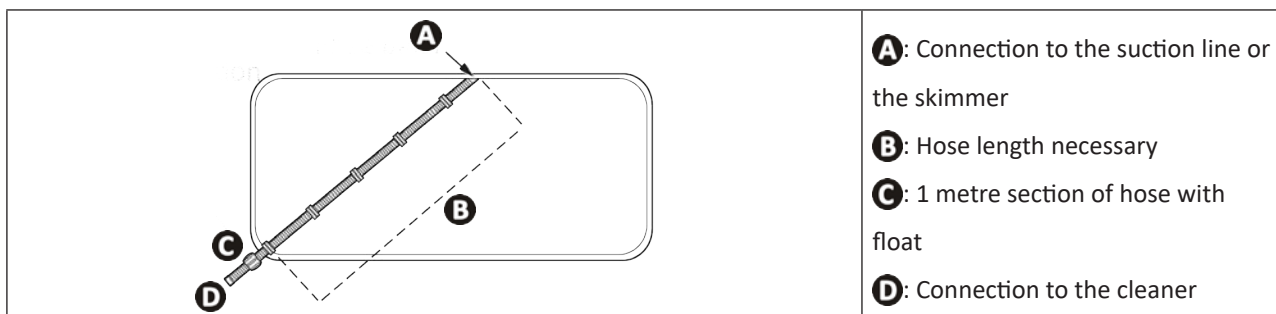

#### **Tip: assemble the "right" quantity of hose sections**

Assembling more hose sections than the length necessary to cover the whole pool is not recommended. Hoses that are too long may limit the cleaner's performance.

#### 2.2.2 Twist Lock Hose section assembly

- To easily assemble the two pipe sections using the Twist Lock system, connect them then twist until the connectors are in complete abutment, in one of the 3 notches providing the seal (see image **1**).
- The section of Twist Lock hose with the hose float attached will be connected to the cleaner (see image **2**). The Twist Lock hose float must be located **20-23 cm away from the cleaner** (see image **2**).

**1**

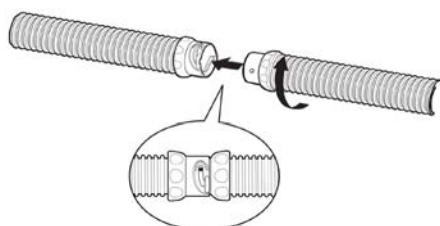

**2**

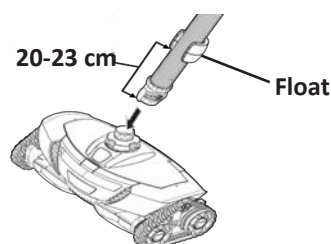

## 2.3 I Hydraulic connections



- Turn off the filtration pump.
- Clean the skimmer basket, the filtration pump filter basket and the filter if necessary.

### 2.3.1 Connection to the suction line

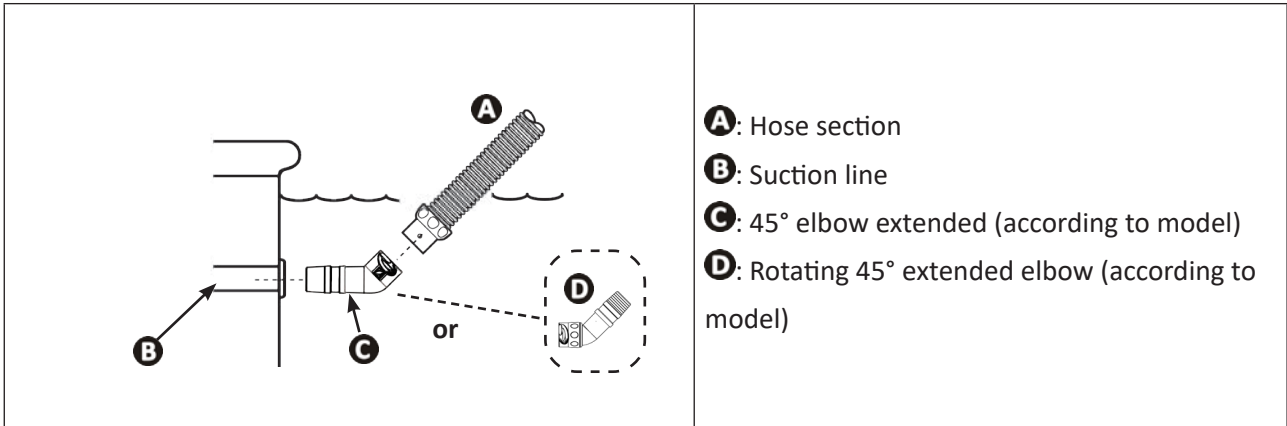

EN

### 2.3.2 Connection to the skimmer

- If the pool has more than one skimmer, connect the pipe to the one which is the closest to the filtration pump.

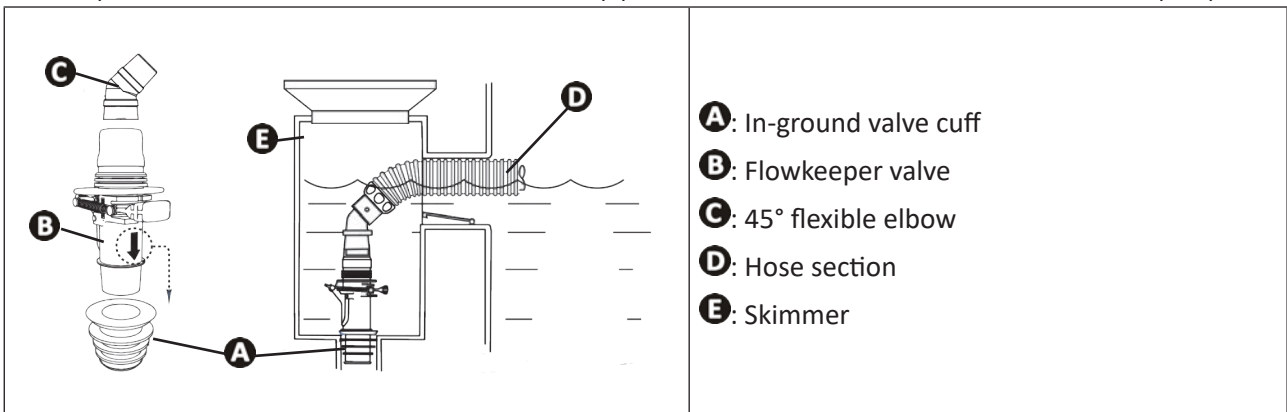

**Tip: Protect the filtration system by connecting the flowkeeper valve**

This valve is used to adjust the flow to optimise the cleaner's performance; it is also very useful for retaining any debris that may be sucked in and damage the filtration equipment.



### 2.3.3 "Cyclonic™ Leaf Catcher" connection (according to model)

- Connect the Cyclonic™ Leaf Catcher to the hose assembly which is closest to the suction line or the skimmer (see image **1** or **2**).
- Tilt the Cyclonic™ Leaf Catcher by following the indications: "PUMP" = filtration pump side / "CLEANER" = cleaner side (see image **3**).
- For the bet operation, position the Cyclonic™ Leaf Catcher vertically to the water surface (see image **4**).

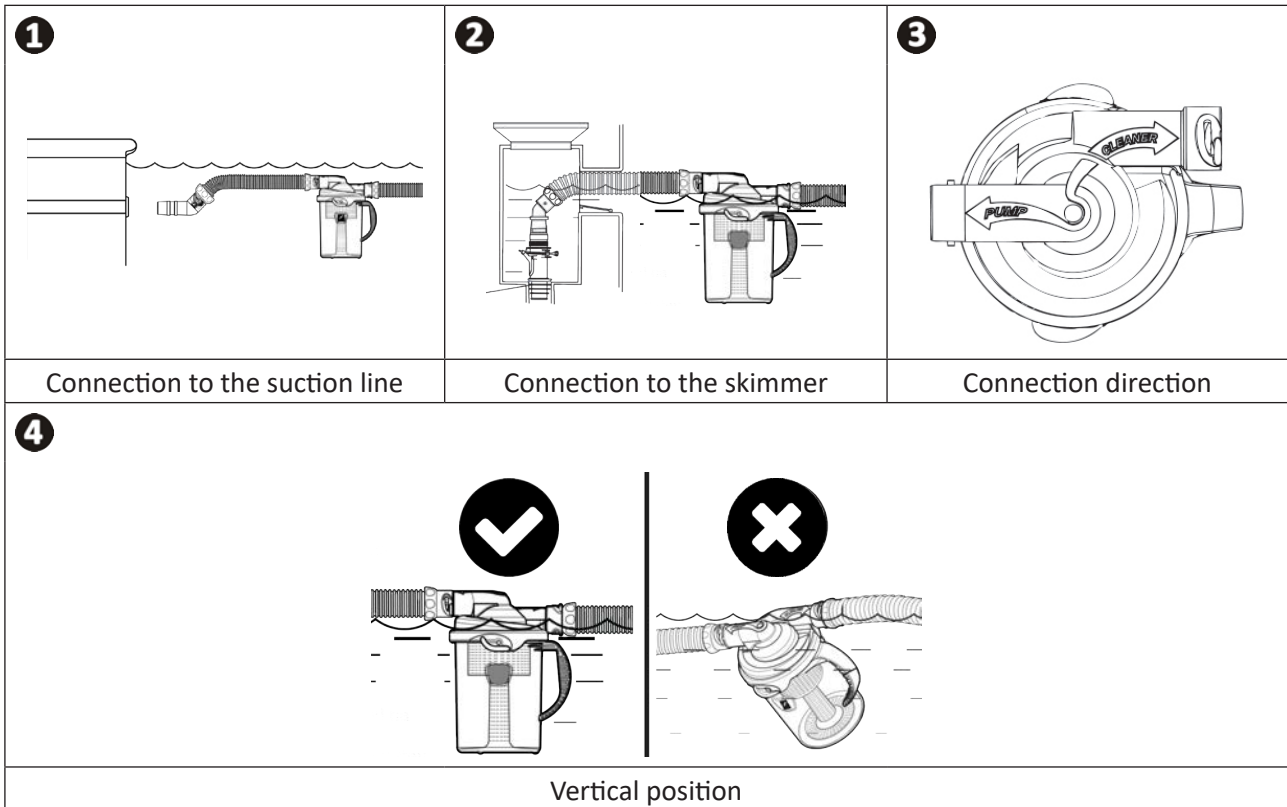

**Tip: Protect the filtration system by connecting the Cyclonic™ Leaf Catcher**

The Cyclonic™ Leaf Catcher is used to retain the debris before it is sucked into the filtration system as this may cause long-term damage to the equipment. It also enables the debris to be removed more easily than in the pump filter basket and has the advantage that it is transparent so you can see when it needs to be cleaned.



## 3 Use

### 3.1 | Operating principle

The hydraulic cleaners connect to the filtration system (either to a suction line or a skimmer); they use the filtration pump's energy to move around the pool. The wall climbing capacity varies according to the shape of the pool and the available water flow.

The debris is sucked in by the cleaner and captured in the filtration pump's filter basket or in the Cyclonic™ Leaf Catcher (accessory included or available as an option depending on the model).

### 3.2 | Pool preparation



- This product is intended to be used in pools which are permanently installed. Do not use it in pools which may be dismantled. A permanent pool is built into the ground or on the ground and cannot be easily dismantled and stored.

- The device must operate in pool water with the following quality:

Water temperature	Between 15°C and 35°C
pH	Between 6.8 and 7.6
Chlorine	< 3 mg/l

- When the pool is dirty, especially when first installing your cleaner, remove the largest debris using a telescopic pole and net prior to installing the cleaner.
- Remove any thermometers, toys and other objects that might damage the device.
- After adding chemical products to the water, wait at least 4 hours before putting the cleaner into the water.
- Make sure that the filtration and the skimmer baskets are clean.
- Aim the pool return lines downward if adjustable.
- Close the pool's main drain line.
- Turn off the filtration pump off.

### 3.3 | Operating



- To avoid serious injury, make sure the filtration pump is turned off.
- Do not expose your hair, loose clothing, jewellery, etc. to the open end of the hose.

#### 3.3.1 Connecting the flow regulator valve and immersing the cleaner

- Connect the flow regulator valve to the hose (see image ①).
- Immerse the cleaner so that it fills up with water.
- When there are no more air bubbles escaping from the cleaner, connect the hose by inserting the flow regulator valve onto the cleaner (see image ②).
- Let the cleaner descends to the bottom of the pool.

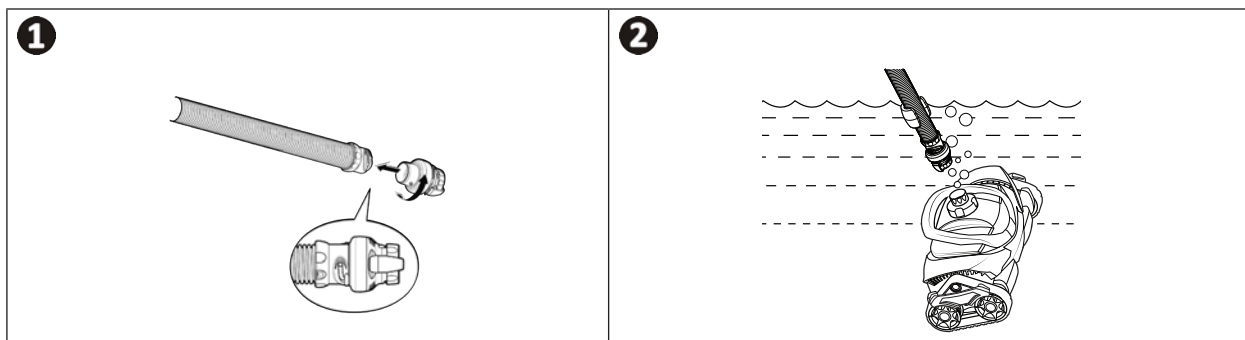

#### 3.3.2 Filling the hose assembly

- Disconnect the hose assembly from the suction line or skimmer temporarily.
- Turn on the filtration pump.
- Fill the Hose assembly with water by placing the open end in front of a pool return line until it is filled.
- Turn off the filtration pump and connect the Hose assembly to the dedicated suction line or skimmer.
- Turn on the filtration pump on to activate the pool cleaner.

### 3.4 I Adjusting the water flow

- The filtration pump must be operating.
- Check the water flow regularly to ensure the best possible cleaning performance and to make it easier for the cleaner to climb the sides.
- The cleaner is equipped with a flow regulator valve which automatically adjusts the water flow through the cleaner. It indicates whether the water flow is ok or excessive: **YELLOW** = flow ok / **RED** = flow excessive



#### 3.4.1 Checking the wheel rotation speed

- The filtration pump must be operating.
- Switch on the filtration pump (have a stopwatch ready).
- Raise the cleaner to below the surface of the water, keeping it submerged.
- Note the yellow indicator on the rear right wheel (see image 1).
- For MX8 - MX8 PRO - MX9 - MX930 - MX10: Wait until the wheels change direction and log the time until the wheels have performed 10 turns (see image 1).
- Adjust the water flow according to the time logged (see image 2).

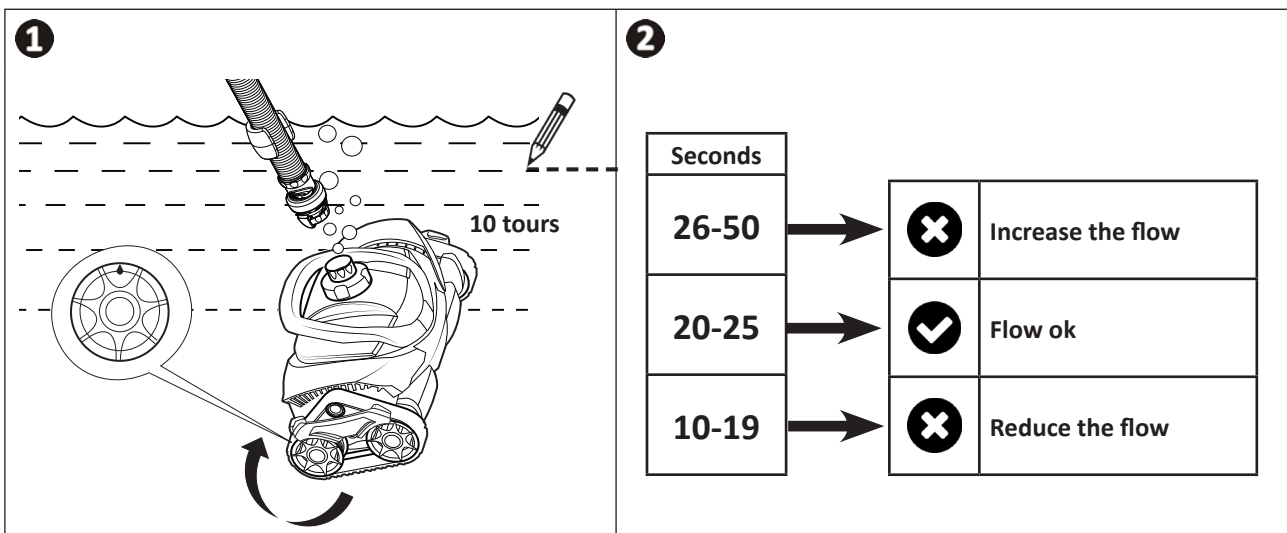

#### 3.4.2 Adjusting the water flow

- Adjust the water flow using the flowkeeper valve provided with the device (see image 1), or from the pool valves.

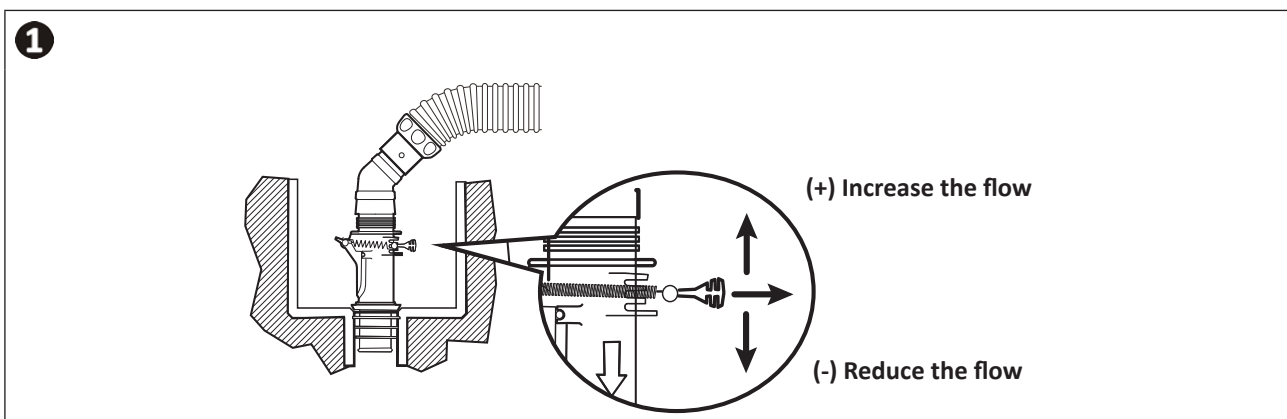

### ➤ 3.5 I Choice of suction mode: small or large debris (according to model)



Before starting this operation and to avoid serious injury:

- Turn off the filtration pump.
- Disconnect the cleaner from the Twist Lock hose assembly.

- The cleaner has a suction adaptor ( **A** ); it is located under the cleaner.
- The adaptor enables the suction to be adjusted according to the type of debris to be dealt with: **"small debris" mode** (small or heavy debris such as sand, silt and stones), **"large debris" mode** (leaves).
- **To switch to "large debris" mode ( **B** ):**
  - Locate slot on underside of cleaner. Insert a flat tool into the inlet adapter.
  - Lift up the inlet adapter and then pull it out of the vacuum inlet.
- **To return to "small debris" mode ( **C** ):**
  - Place the modular inlet adapter in the vacuum inlet of the pool cleaner.
  - Push down on the modular inlet adapter until it clicks into place.

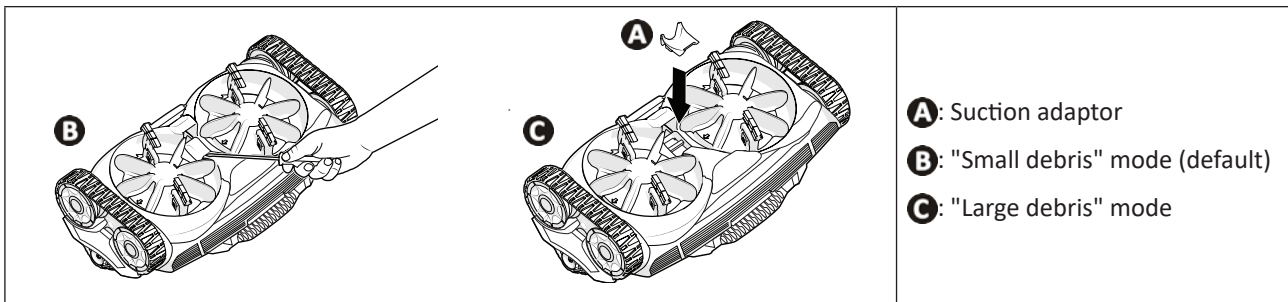

**Tip: It is best to use "small debris" mode during the bathing season**

When the pool is cleaned regularly, we recommend that you leave the suction adaptor in place to be in "small debris" mode.



## 4 Maintenance

- The device must be cleaned regularly using clean or slightly soapy water. Do not use any solvents.
- Rinse the device generously using clean water.
- Never store the cleaner in direct sunlight. Store the hoses laying flat and not coiled to prevent unwanted hose memory.

### 4.1 I Cleaning the filtration pump basket



- Always remove the cleaner from the pool before cleaning or bleeding the filtration system.
- Before cleaning (and before you put the cleaner back into the water), start the filtration pump for at least 5 minutes before you bleed the circuit.

- For maximum cleaner performance it is recommended the filtration pump basket be kept clean by removing debris as needed.
- Use of the Cyclonic™ Leaf Catcher (accessory included or optional depending on the model) is recommended to collect large debris before it reaches the skimmer and the pump basket.

### 4.2 I Cleaning the "Cyclonic™" Leaf Catcher

- Turn off the filtration pump.
- Keep the Cyclonic™ Leaf Catcher under the water and take hold of it by the handle. Using the handle, turn the transparent canister until it detaches (see image 1).
- Remove the transparent canister from the water and leave the lid and the hoses under the water (see image 2).
- Remove the filter using the top handle (see image 3).
- Remove the debris and rinse the transparent canister in clean water (see image 4).
- Put the filter back in place and immerse the Cyclonic™ Leaf Catcher again (see image 5).
- Position the transparent canister correctly on the lid notches then turn it sharply to push the 2 parts in (see image 6).

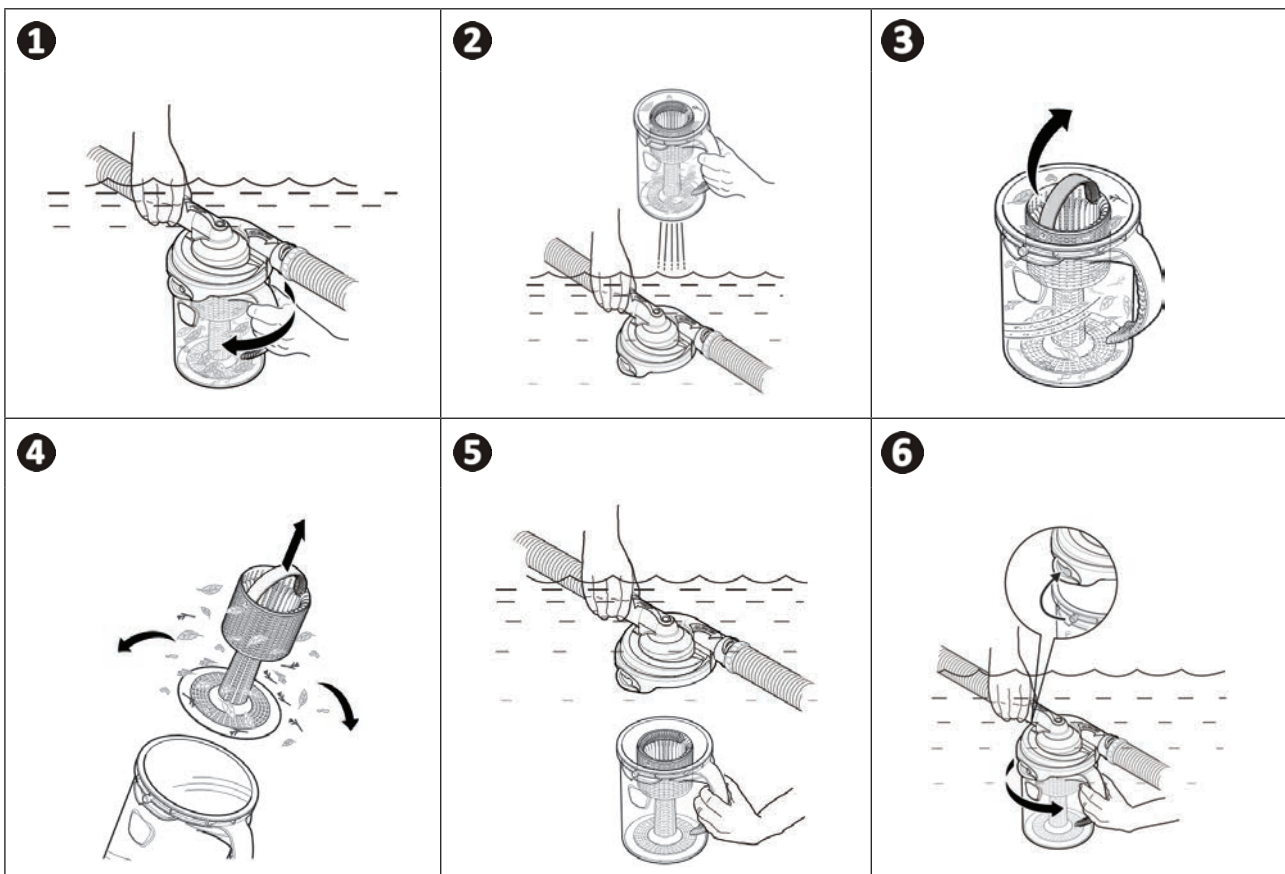

### ➤ 4.3 I Removing debris from the motor



Before starting this operation and to avoid serious injury:

- Turn off the filtration pump.
- Disconnect the cleaner from the Twist Lock hose assembly.

- Press the button on the top to open the lid (see image ①).
- **MX6 - 630 - 8 - 8 PRO - 9 - 930** : Remove the debris inside (see image ② A). If necessary, gently push the motor blades forward and backward to reveal any trapped debris and remove it. When you move the blades, make sure that the cleaner's tracks turn freely and that they are correctly synchronised with the movement of the blades under the cleaner.
- **MX10** : Remove the debris inside. If necessary, remove the motor (see image ② B) to reveal any trapped debris and remove it. Make sure that the cleaner's tracks turn freely and that they are correctly synchronised with the movement of the blades under the cleaner when putting the motor back.
- Remove any debris which may be caught in the suction inlet, under the cleaner.
- Close the lid and make sure it locks.

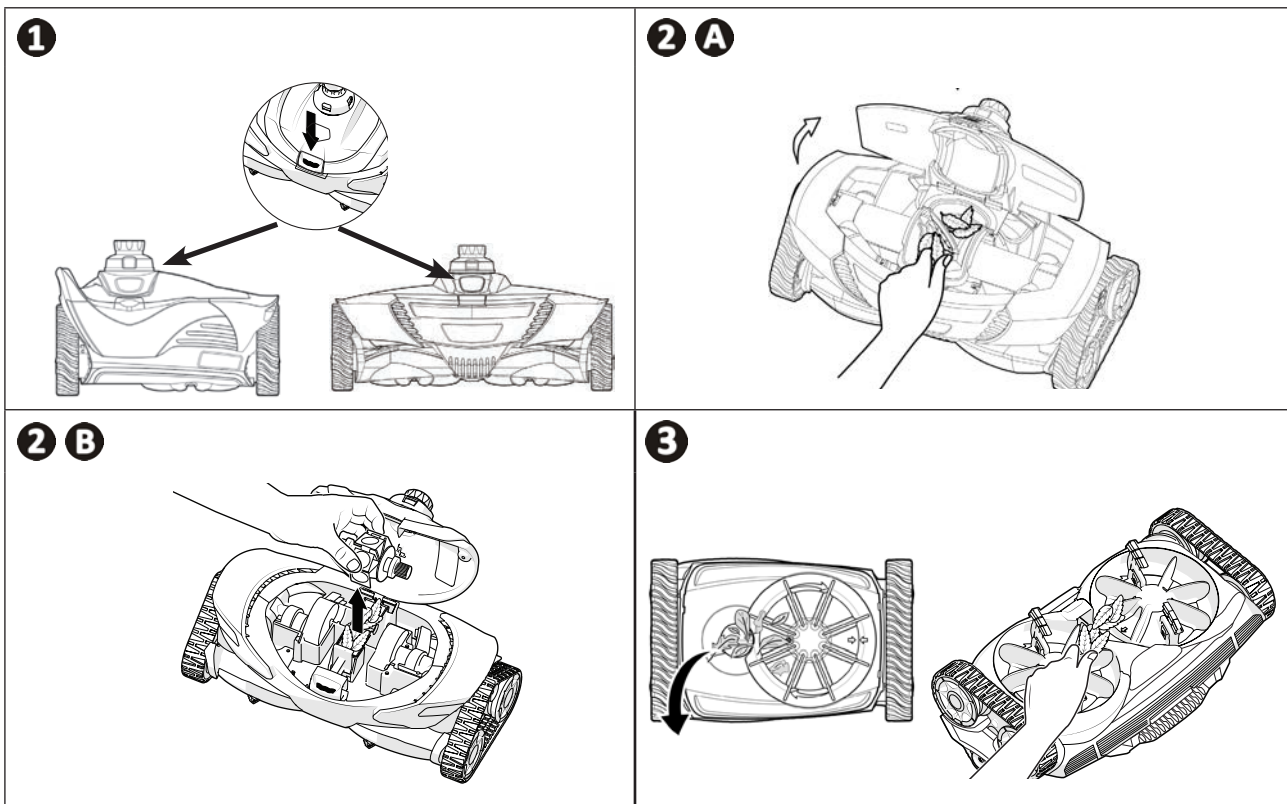

## ➤ 4.4 I Replacing the tracks

- Lay the cleaner on one side.
- Starting with one of the wheels, pull the inside of the track to separate it from the wheel (see image **1**). Then remove the track from the cleaner.
- To install the new track, position the inside of the track on the small wheel's grooves and on one of the large wheels.
- Stretch the track around the second wheel, (see image **2**). Press down on the track to position it correctly on the wheel grooves. Make sure that the track passes under the guide.

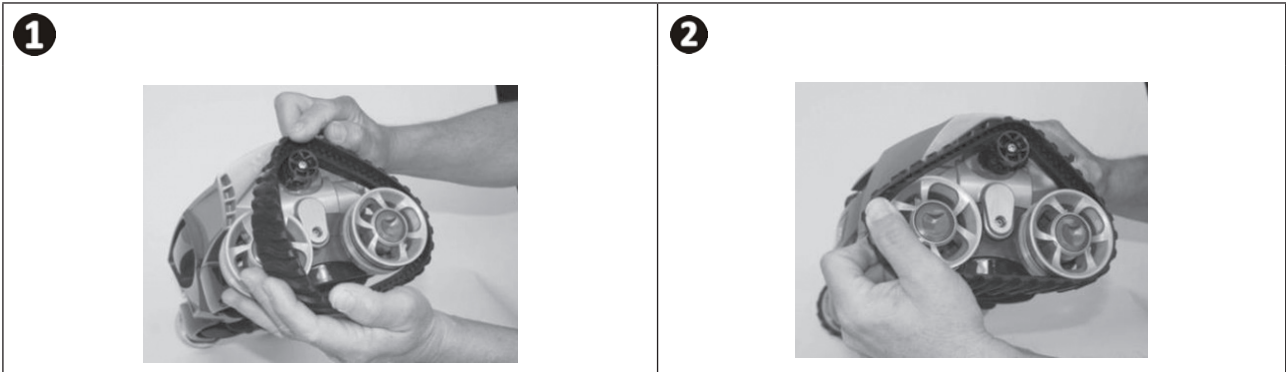

## ➤ 4.5 I Storage and winterizing

- For winterizing, drain off all the water from the cleaner (damage caused by frost is not covered by the warranty).
- Clean the whole device and the hoses in clean water then leave to dry.
- Store the device in a dry place which is protected from freezing conditions. Store the cleaner on its side or back to avoid damage to turbine (voir image **1**).
- Remove all the connectors and adaptors from the suction line or the skimmer.

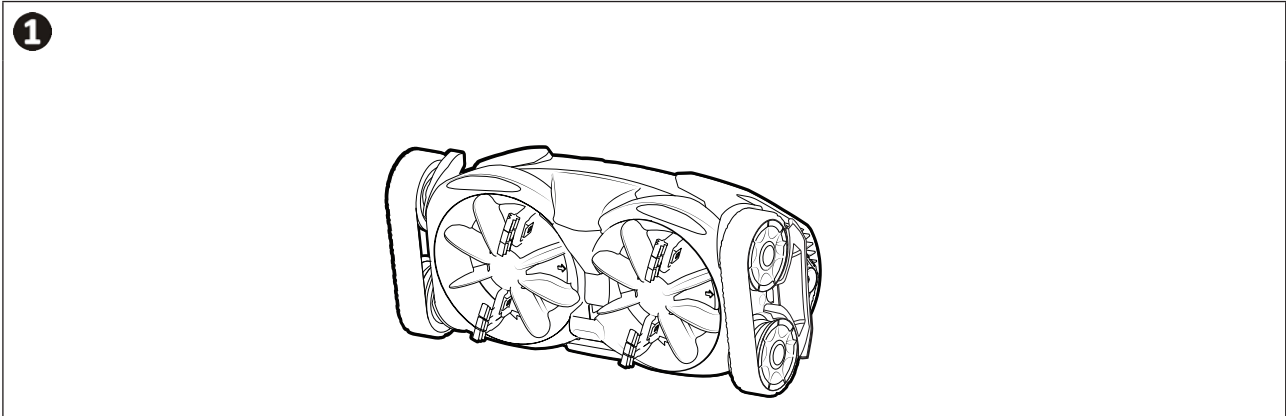

**Tip: Preserve the condition of the hoses during storage**

When the cleaner is stored away, even for short periods, avoid rolling the hoses: they may take on a shape which may harm the cleaner's performances.





## 5 Troubleshooting



- Before you contact your reseller, please carry out these few simple checks using the following tables if a problem occurs.
- If the problem continues contact your reseller.

### 5.1 I Device behaviour

EN

<p>The cleaner is immobile or very slow.</p>	<ul style="list-style-type: none"> <li>• Close the main drain line.</li> <li>• Clean and empty the skimmer and filtration pump baskets.</li> <li>• Inspect the motor area and remove any visible debris. (see “<b>4.3 I Removing debris from the motor</b>”)</li> <li>• Remove the suction adaptor under the cleaner (see “<b>3.5 I Choice of suction mode: small or large debris (according to model)</b>”).</li> <li>• Check the flow (see “<b>3.4 I Adjusting the water flow</b>”).</li> <li>• Turn on the filtration pump to verify there is no air in the system. If the filtration pump basket is filled with air bubbles and, or the water level is low this indicates there is air present in the circulation system. If air is in the system it will be seen as water flows out the pool return lines. Air can be drawn into the circulation system through components on the suction side of the filtration pump. This includes holes or cracks in the cleaners hose sections.</li> <li>• Verify the pool surface is not covered with algae as this slippery surface will not allow the cleaner to gain traction and climb. If it is, carry out shock chlorination and slightly reduce the pH.</li> </ul>
<p>The cleaner does not cover the entire pool.</p>	<ul style="list-style-type: none"> <li>• Check the flow (see “<b>3.4 I Adjusting the water flow</b>”).</li> <li>• Aim the return line fittings in the pool downward if adjustable.</li> <li>• Check the hose sections for coils. If a memory has formed turn off the cleaner and remove the affected hose sections. Lie the pipe sections having formed loops flat in the sun until these sections recover their normal shape. Re-install the hose sections on the cleaner.</li> <li>• Check the hose assembly is long enough (see “<b>2.2 I Hose section assembly</b>”). If it is not, add hose sections.</li> <li>• Check the position of the hose float on the leader hose section (see “<b>2.2 I Hose section assembly</b>”).</li> <li>• Monitor the cleaner for more than five minutes and check that each track changes direction regularly.</li> </ul>
<p>The cleaner is stopped on the steps.</p>	<ul style="list-style-type: none"> <li>• Check the top cover swivel turns freely.</li> <li>• Test the flow by checking the wheel rotation speed (see “<b>3.4.1 Checking the wheel rotation speed</b>”).</li> <li>• Check that the pipe is not too long (see “<b>2.2 I Hose section assembly</b>”). If it is, shorten the hose length by removing sections.</li> </ul>
<p>The cleaner does not climb the pool walls.</p>	<ul style="list-style-type: none"> <li>• Check the flow (see “<b>3.4.1 Checking the wheel rotation speed</b>”) and increase it if necessary (see “<b>3.4.2 Adjusting the water flow</b>”).</li> <li>• Check that the hose float is positioned correctly on the leader hose (see “<b>2.2 I Hose section assembly</b>”).</li> <li>• Check that the pool walls are free of algae and not slippery.</li> </ul>
<p>The cleaner climbs above the water line.</p>	<ul style="list-style-type: none"> <li>• Reduce the flow (see “<b>3.4.2 Adjusting the water flow</b>”).</li> <li>• Check that the hose float is positioned correctly on the leader hose (see “<b>2.2 I Hose section assembly</b>”).</li> </ul>
<p>The cleaner lays on its side.</p>	<ul style="list-style-type: none"> <li>• Check that the hose float is positioned correctly on the leader hose (see “<b>2.2 I Hose section assembly</b>”).</li> </ul>



Votre revendeur  
*Your retailer*

Modèle appareil  
*Appliance model*

Numéro de série  
*Serial number*

Pour plus d'informations, enregistrement produit et support client :  
*For more information, product registration and customer support:*

**[www.zodiac.com](http://www.zodiac.com)**

