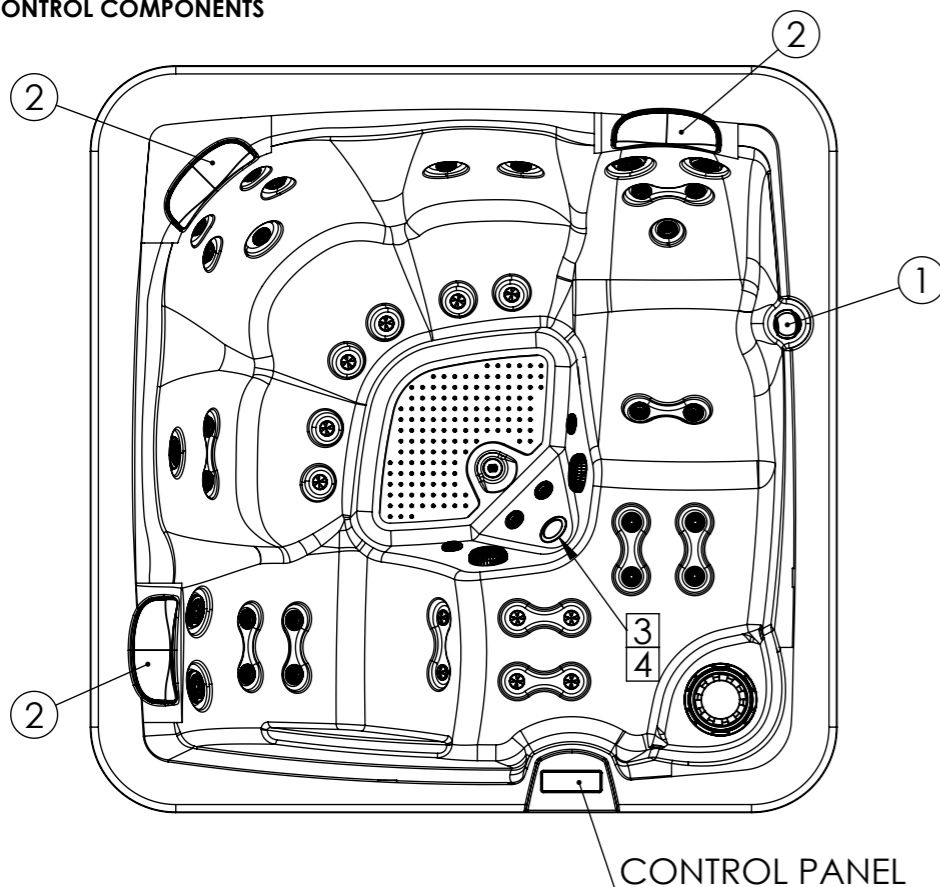

| | | |
|----------|------------|-----------|
| Revision | Date | Name |
| 00 | 01/01/2023 | I. Rica |
| Drawn | 01/01/2023 | X. Codina |
| Checked | | |

According to our policy of continuous improvement, dimensions, features or components of this product can be partially or completely changed without prior notice. It's Customer responsibility to verify that this is the last version of the drawing

Property of IBERSPA S.L. Avda. Pla d'Urgell 2-8 25200 Cervera, Spain. Don't use without permission. Keep this information confidential and use it solely for the permitted purpose.

CONTROL COMPONENTS

PILLOWS

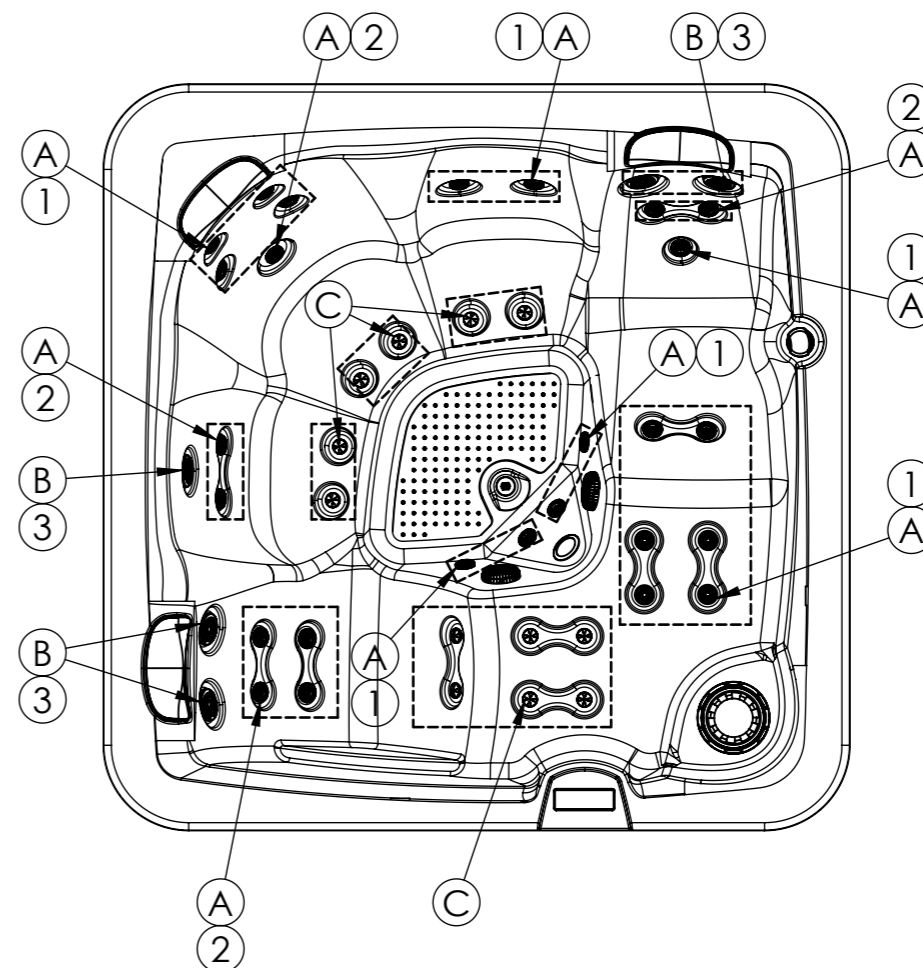

CONTROL PANEL

MASSAGE COMPONENTS

LIGHT COMPONENTS

CONTROL PANELS

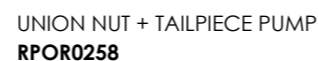
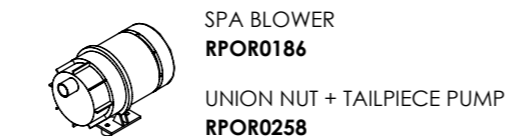
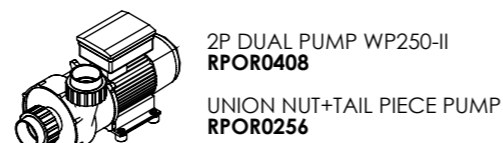
HEATER

RPOR0449-A: DIGITAL PANEL BP200G3
RPOR0449-B: EXPANDER BOARD
RPOR0449-C: HEATER 2KW BP200
RPOR0449-D: TEMPERATURE PROBES BP20 14 IN
RPOR0449-E: TEMPERATURE PROBES BP20 24 IN

PUMPS

COVER

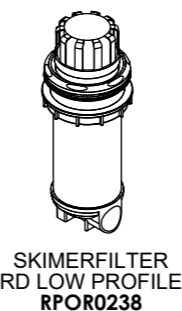
76986

FILTRATION

DESINFECTATION

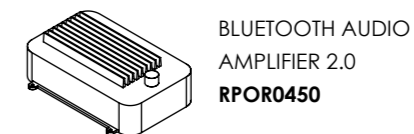
AUDIO

Option 2.0

OTHER COMPONENTS
