

Vortex™

Installation and user manual - English
Electric cleaner
Original instructions

EN

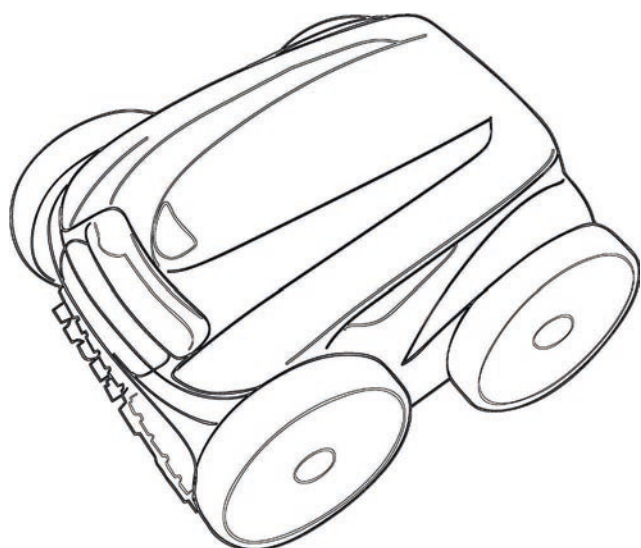

More documents on:
www.zodiac.com

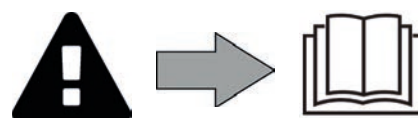

WARNINGS

- Before handling the appliance, it is vital that you read this installation and user manual, as well as the "Warranties" booklet delivered with the appliance. Failure to do so may result in material damage or serious or fatal injury and will void the warranty.
- Keep and pass on these documents for reference during the appliance's service life.
- The distribution or modification of this document in any way is prohibited, without prior authorisation from the manufacturer.
- The manufacturer is constantly developing its products to improve their quality. The information contained herein may therefore be modified without notice.

EN

GENERAL WARNINGS

- Failure to respect the warnings may cause serious damage to the pool equipment or cause serious injury, even death.
- Only a person qualified in the technical fields concerned (electricity, hydraulics or refrigeration) is authorised to carry out maintenance or repair work on the appliance. The qualified technician working on the appliance must use/wear personal protective equipment (such as safety goggles and protective gloves, etc.) in order to reduce the risk of injury occurring when working on the appliance.  
- Before handling the appliance, check that it is switched off and isolated.
- The appliance is intended to be used for pools and spas for a specific purpose; it must not be used for any purpose other than that for which it was designed.
- This appliance is not intended for use by individuals (including children) with impaired physical, sensorial or mental abilities, or persons lacking in knowledge and experience, unless they receive supervision or prior instructions on using the appliance from a person responsible for their safety. Children must be supervised to ensure that they do not play with the appliance.
- This appliance can be used by children under 8 and adults with impaired physical, sensory or mental capabilities, or who lack experience and knowledge, if they are correctly supervised or have been instructed in how to use the appliance safely and understand the hazards involved. User cleaning and maintenance operations must not be carried out by children without supervision.
- The appliance must be installed according to the manufacturer's instructions and in compliance with local and national standards. The installer is responsible for installing the appliance and for compliance with national installation regulations. Under no circumstances may the manufacturer be held liable in the event of failure to comply with applicable local installation standards.
- For any work other than the simple user maintenance described in this manual, the product should be referred to a qualified professional.
- If the appliance suffers a malfunction, do not try to repair it yourself; instead contact a qualified technician.
- Refer to the warranty conditions for details of the permitted water balance values for operating the appliance.
- Deactivating, eliminating or by-passing any of the safety mechanisms integrated into the appliance shall automatically void the warranty, in addition to the use of spare parts manufactured by unauthorised third-party manufacturers.
- Do not spray insecticide or any other chemical (flammable or non-flammable) in the direction of the appliance, as this may damage the body and cause a fire.
- Do not touch the fan or moving parts and do not place objects or your fingers in the vicinity of the moving parts when the appliance is in operation. Moving parts can cause serious injury or even death.

WARNINGS ASSOCIATED WITH ELECTRICAL APPLIANCES

- The power supply to the appliance must be protected by a dedicated 30 mA Residual Current Device (RCD), complying with the standards and regulations in force in the country in which it is installed.
- Do not use any extension lead when connecting the appliance; connect the appliance directly to a suitable power supply.
- Before carrying out any operations, check that:
 - The required input voltage indicated on the appliance information plate corresponds to the mains voltage;
 - The mains supply is compatible with the appliance's electricity needs and is correctly grounded.
- In the event of abnormal operation or the release of odours from the appliance, turn it off immediately, unplug it from its power supply and contact a professional.
- Before servicing or performing maintenance on the appliance, check that it is powered off and completely disconnected from the power supply and that all other equipment or accessories connected to the appliance are also disconnected from the power circuit.
- Do not disconnect and reconnect the appliance to the power supply when in operation.
- Do not pull on the power cord to disconnect it from the power supply.
- If the power cord is damaged, it must be replaced by the manufacturer, an authorised representative or a repair facility only.
- Do not perform maintenance or servicing operations on the appliance with wet hands or if the appliance is wet.
- Before connecting the appliance to the power supply, check that the connection unit or socket to which the appliance will be connected is in good condition and shows no signs of damage or rust.
- In stormy weather, disconnect the appliance from the power supply to prevent it from suffering lightning damage.

SPECIFIC FEATURES APPLICABLE TO "Pool cleaners"

- The cleaner is designed to operate properly in pool water at a temperature of between 15°C and 35°C.
- To avoid possible injury or damage to the cleaner, do not operate the cleaner out of the water.
- In order to prevent possible injury, bathing is prohibited when your cleaner is in the pool.
- Do not use the cleaner during shock chlorination.
- Do not leave the cleaner unattended for an extended period.

WARNING ON THE USE OF A CLEANER IN A POOL WITH A LINER:

- Before installing the cleaner, carefully inspect the pool lining. If the liner is damaged in places, do not install the cleaner before a qualified professional repairs or replaces the liner. The manufacturer may not be held liable in any way for damage caused to the liner.
- The surface of certain patterned liners can wear away quickly: the patterns and/or colours can become deteriorated, faded or disappear on contact with certain objects. The cleaner manufacturer may not be held liable for wear to the liners or faded patterns, which are not covered by the limited warranty.

CONTENTS



1 Information before use

5

1.1 | Package contents

5

1.2 | Technical specifications and parts list

6

1.3 | Operating principle

7

1.4 | Pool preparation

7



2 Use

8

2.1 | Immersing the cleaner in the pool

8

2.2 | Attachment to the base (depending on model)

8

2.3 | Electricity supply connection

9

2.4 | Control box functions

10

2.5 | Starting a cleaning cycle

11

2.6 | Setting the time and programming the cleaning cycles (depending on the model)

12

2.7 | The remote control (depending on the model)

14

2.8 | Removing the cleaner from the water

15

2.9 | Good practices after each cleaning operation

16



3 Maintenance

17

3.1 | Cleaning the cleaner

17

3.2 | Clean the filter as soon as the appliance is out of the pool

17

3.3 | Cleaning the propeller

18

3.4 | Replacing the brushes

19

3.5 | Changing the tyres

20



4 Troubleshooting

21

4.1 | Appliance behaviour

21

4.2 | User alerts

22

4.3 | Pre-diagnostic menu (depending on the model)

23

EN



Tip: to make it easier to contact the retailer

Write down the retailer's contact details to help you find them more easily and fill in the "product" information on the back of the manual: the retailer will ask for this information.



1 Information before use

1.1 I Package contents

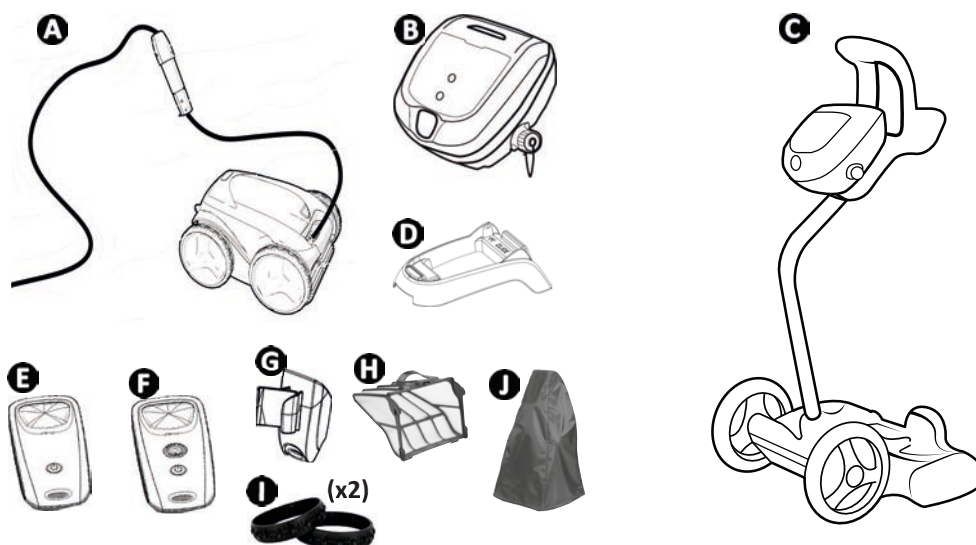

		GV 33xx OV 33xx RV 42xx Vortex™ PS2 Vortex™ 205	AV 34xx GV 34xx J 34xx OV 34xx RV 43xx RV 44xx Vortex™ 3 PLUS	AV 35xx GV 35xx OV 35xx Vortex™ 4 PLUS Vortex 305	RV 45xx	BV 52xx J 52xx GV 52xx OV 53xx OV 54xx RV 53xx RV 54xx RV AQ54 RV CAxx Vortex™ PS 400	RV 55xx RV 56xx
A	Cleaner + floating cable	✓	✓	✓	✓	✓	✓
	Front driving wheels (2WD)	✓	✓	✓	✓		
	Front/rear driving wheels (4WD)					✓	✓
B	Control box	✓	✓	✓	✓	✓	✓
C	Caddy kit	+	✓	✓	✓	✓	✓
D	Base for control box	✓					
E	Kinetic remote control			✓			
F	Kinetic remote control "Remove from pool mode"				✓		✓
G	Remote control support			✓	✓		✓
H	100µ fine debris filter	✓	✓	✓	✓	✓	✓
	200µ large debris filter	+	+	+	+	+	+
	60µ very fine debris filter						
I	Front "tiling" tyres	+ / ✓ (GV 3320, GV 3420, GV 3520, Vortex PS 200, Vortex 205, Vortex 305, OV 3310, OV 3480, OV 3505, OV 3510, AV 348 50, AV 350 50)					
J	Protective cover	+ / ✓ (RV 4460)					

✓: Supplied +: Available as an option

1.2 I Technical specifications and parts list

1.2.1 Technical specifications

	GV 3320 OV 33xx RV 4200 Vortex™ 205 Vortex™ PS 200	AV 348 50 - AV 350 50 - BV 5200 - J 3485 - J 5200 - GV 3420 - GV 3520 - GV 5220 - OV 3400 - OV 34xx - OV 35xx - OV 5200 - OV 53xx - OV 54xx - RV AQ54 - RV CAxx - RV 43xx - RV 44xx - RV 53xx - RV 54xx - Vortex™ 3 PLUS - Vortex™ 4 PLUS - Vortex™ 305 - Vortex™ PS 400	RV 45xx RV 5500	RV 5600
Control box power supply	220-240 VAC, 50 Hz			
Cleaner power supply voltage	30 VDC			
Maximum power input	150 W			
Cable length	15 m	18 m	21 m	25 m
Cleaner weight (without cable)	10.2 kg			
Suction width	270 mm			
Maximum operating depth	4 m			
Power supply protection rating	IPX5			
Cleaner protection rating	IPX8			

EN

1.2.2 Marking

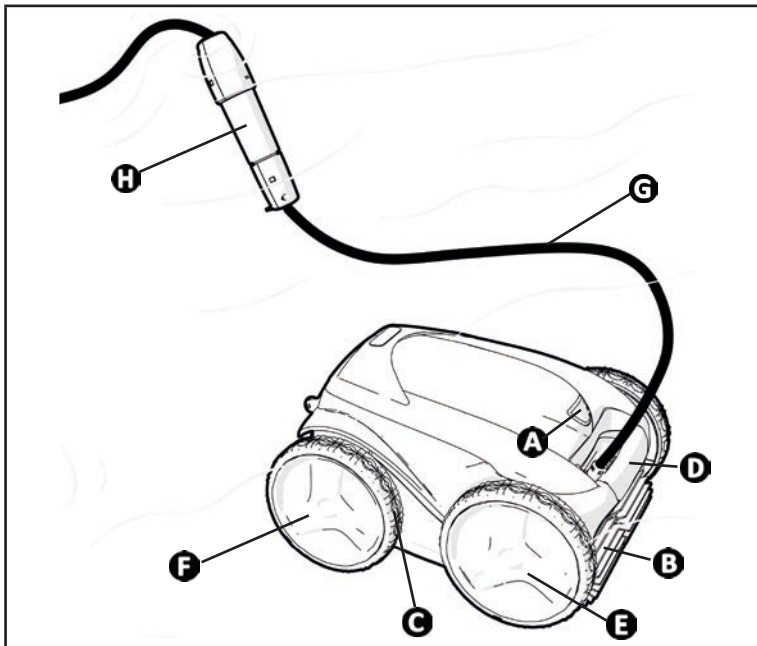

- A**: Filter access hatch lock
- B**: Brushes
- C**: Tyres
- D**: Transport and remove-from-pool handle
- E**: Front driving wheels
- F**: Rear driving wheels (depending on the model)
- G**: Floating cable
- H**: Swivel (depending on the model)

➤ 1.3 | Operating principle

The cleaner is separate from the filtration system and can function independently. It just simply needs to be connected to the mains power supply.

It finds the best route to move around and clean the areas of the pool for which it has been designed (depending on the model: bottom, walls, water line). Debris is sucked in and stored in the cleaner's filter.

The control box enables the cleaning operations to be started, selected and programmed (depending on the model).

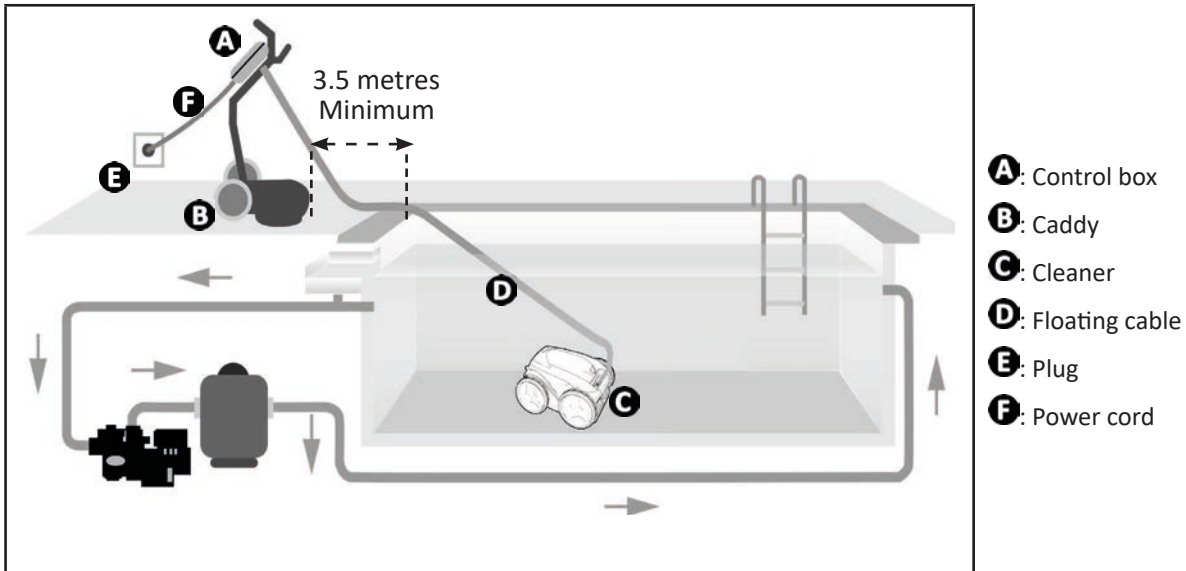

➤ 1.4 | Pool preparation



- This product is intended to be used in pools which are permanently installed. Do not use it in pools which may be dismantled. A permanent pool is built into the ground or on the ground and cannot be easily dismantled and stored.

- The appliance must operate in pool water with the following properties:

Water temperature	Between 15°C and 35°C
pH	Between 6.8 and 7.6
Free chlorine	< 3 mg/l

- When the pool is dirty, especially when commissioning, remove the largest debris using a net in order to optimise the appliance's performances.
- Remove any thermometers, toys and other objects that might damage the appliance.



2 Use

2.1 I Immersing the cleaner in the pool

- Roll out the full length of the cable alongside the pool to avoid the cable becoming entangled during immersion (see image **1**).
- Position yourself halfway along the length of the pool before immersing the cleaner (see image **2**). This will optimise the cleaner's movements and reduce tangling in the cable.
- Place the cleaner vertically into the water (see image **3**).
- Move it slightly in all directions so that the air contained in the cleaner escapes (see figure **4**).
- It is essential that the appliance sinks on its own and settles on the pool bottom. While it is immersed, the cleaner draws the length of cable it needs into the pool (see figure **5**).

EN

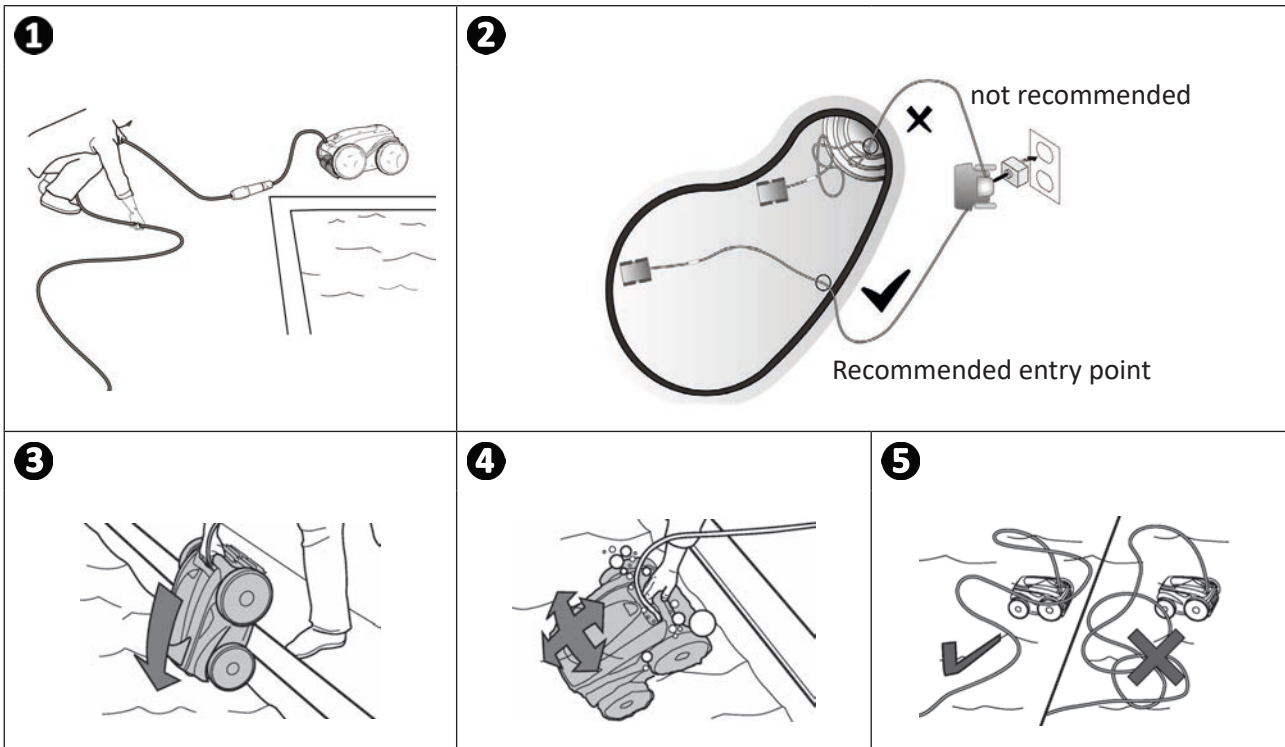

2.2 I Attachment to the base (depending on model)

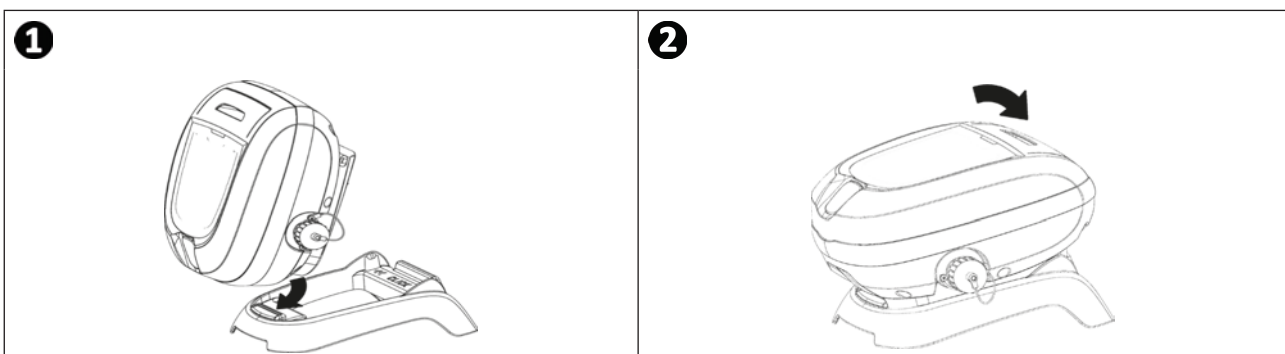

2.3 I Electricity supply connection

In order to avoid any risk of electrocution, fire or serious injury, please follow the instructions below:



- Use of an electrical extension is prohibited when connecting the control box.
- Make sure that the socket can be easily accessed at all times and is protected from rain or splashes.
- The control box is splash-proof, but must not be immersed in the water or any other liquid. It must not be installed in a floodable area; keep it at least 3.5 metres away from the edge of the pool and avoid exposing it to direct sunlight.
- Place the control box near the socket.

- Unscrew the protective cap (see figure 1).
- Connect the floating cable to the control box and lock it into place by turning it clockwise (to avoid damaging the floating cable) (see image 2).
- Make sure that the connector is fully pushed in so that no water can get in (see image 3).
- Connect the power cord (see figure 4). Only connect the control box to a power outlet protected by a 30 mA maximum residual current device (if in doubt contact a qualified technician).

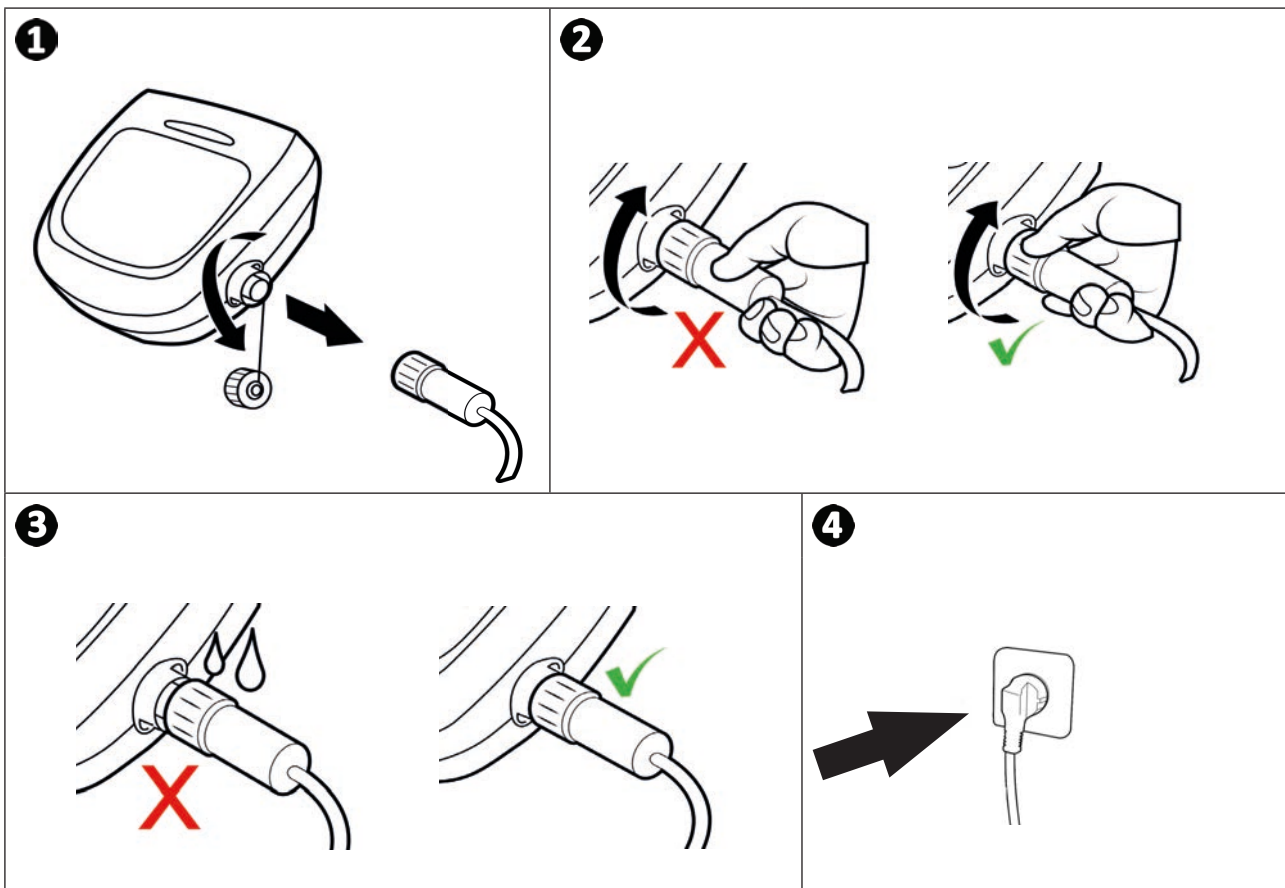

2.4 I Control box functions

Symbol	Description	GV 3320 OV 3300 OV 3310 OV 3400 Vortex™ PS 200 RV 4200 RV 4310 Vortex™ 205	AV 348 50 GV 3420 OV 3410 J 3485 OV 3450 OV 3480 RV 4390 Vortex™ 3 PLUS	AV 350 50 GV 3520 OV 3500 OV 3505 OV 3510 Vortex™ 4 PLUS Vortex™ 305	RV 4400 RV 4430 RV 4460	RV 4550	RV 4560	BV 5200 GV 5220 J 5200 OV 5200 OV 5300 OV 5330 OV 5345 OV 5390 RV CA52 RV 5300	OV 5410 OV 5430 OV 5460 RV 5380 RV 5450 RV AQ54 RV CA54 Vortex™ PS 400	RV 5400 RV 5470	RV 5500 RV 5600
	Start/ Stop the appliance	✓	✓	✓	✓	✓	✓	✓	✓	✓	✓
	"Control" indicator	✓	✓		✓			✓			
	"Clean filter" indicator				✓	✓	✓	✓	✓	✓	✓
	Remove from pool mode				✓	✓	✓		✓	✓	✓
	Surface to be cleaned		✓	✓	✓	✓	✓	✓	✓	✓	✓
	Bottom only		✓	✓	✓	✓	✓	✓	✓	✓	✓
	Bottom + walls + water line		✓	✓	✓	✓	✓	✓	✓	✓	✓
	Water line only										✓
	Pool shape										✓
	Flat bottomed rectangular										✓
	Other shapes, other bottoms										✓
	Cleaning intensity										✓
	Low intensity										✓
	Intensive										✓
	Cleaning cycle programming 						✓			✓	✓
	Increase or reduce the cleaning time 			✓		✓					
	Switch on/off the remote control			✓		✓	✓				✓

EN

✓: Available

2.5 I Starting a cleaning cycle









In order to avoid any risk of injury or material damage, please follow the instructions below:

- Bathing is prohibited when the appliance is in the pool.
- Do not use the appliance during a shock chlorination. Wait until the chlorine level has reached the recommended value before immersing the cleaner.
- Do not use the appliance if the roller shutter is closed.

- When the control box is powered up, the following symbols light up to indicate:
 - The action in progress
 - The cleaning mode selected
 - Maintenance required
- The control box switches to standby after 10 minutes, the screen and the LEDs are switched off. Press any key to exit standby mode. Standby mode does not stop the appliance if it is in a cleaning cycle.

2.5.1 Cleaning mode selection (depending on model)

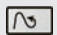
- A cleaning cycle is already configured by default: the symbols are on and the cleaning time appears on the screen, for example: **0:45** (depending on the model).
- The cleaning cycle can be selected at any time, before the appliance starts or while it is operating. The new cycle will be launched instantly and the remaining time countdown will be reinitialised.
- The cleaner adapts its movement strategy depending on the choice in order to optimise coverage.

Surface to be cleaned	Pool shape	Cleaning intensity
 Bottom only	 Other shapes, other bottoms	 Low intensity
 Bottom + walls + water line	 Flat bottomed rectangular	 Intensive
 Water line only		



- Press  to start the cleaning cycle.



Tip to improve cleaning performance

At the start of the bathing season, launch several cleaning cycles in bottom only mode (after removing the large debris with a net). Regular use of the cleaner (without exceeding 3 cycles per week) means that your pool will always be clean and the filter less clogged.

2.5.2 Adjusting the cleaning time (depending on model)

- You may reduce or increase the time for the cleaning cycle selected or in progress:
 - : Reduce by 30 minutes.
 - : Increase by 30 minutes.
- Press  to confirm.

2.6 I Setting the time and programming the cleaning cycles (depending on the model)



- Do not disconnect the power cable once the time has been programmed or you will lose it. The time setting will be saved for approximately 2 minutes if the power supply is disconnected.

2.6.1 Setting the time

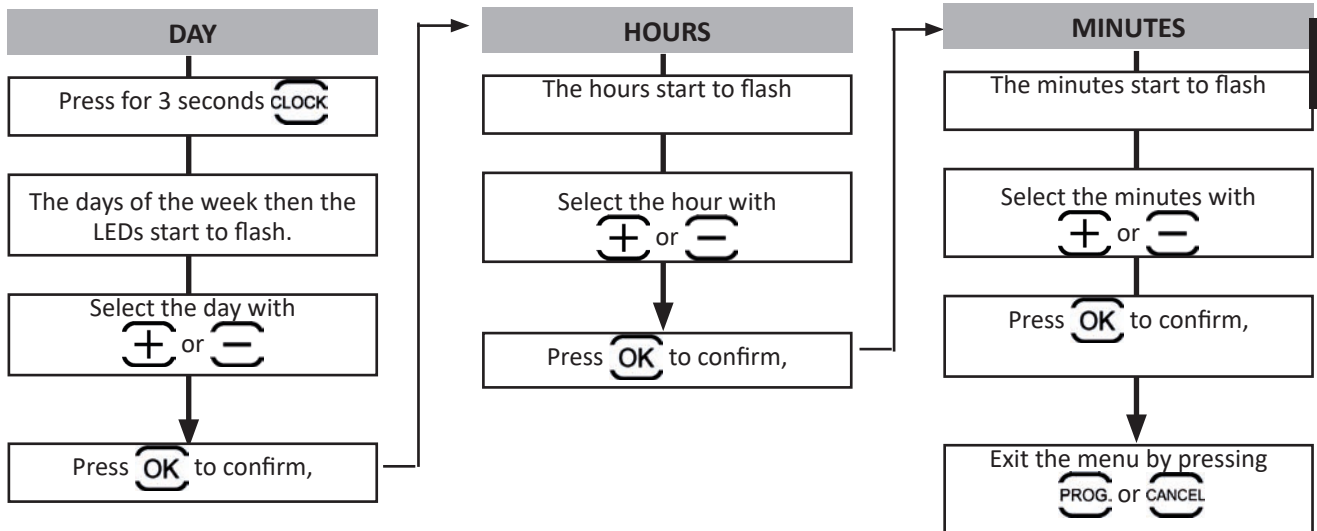

EN

2.6.2 Programming cleaning cycles

Program **up to 7 cleaning cycles** (for example, 2 days per week: Wednesdays and Saturdays over 4 weeks).

- You must set the time before you program the cleaning cycles, see § « 2.6.1 Setting the time ».
- Start by selecting the cleaning cycle on the control box, see § « 2.5.1 Cleaning mode selection (depending on model) ».
- Then program the days, hours and minutes.

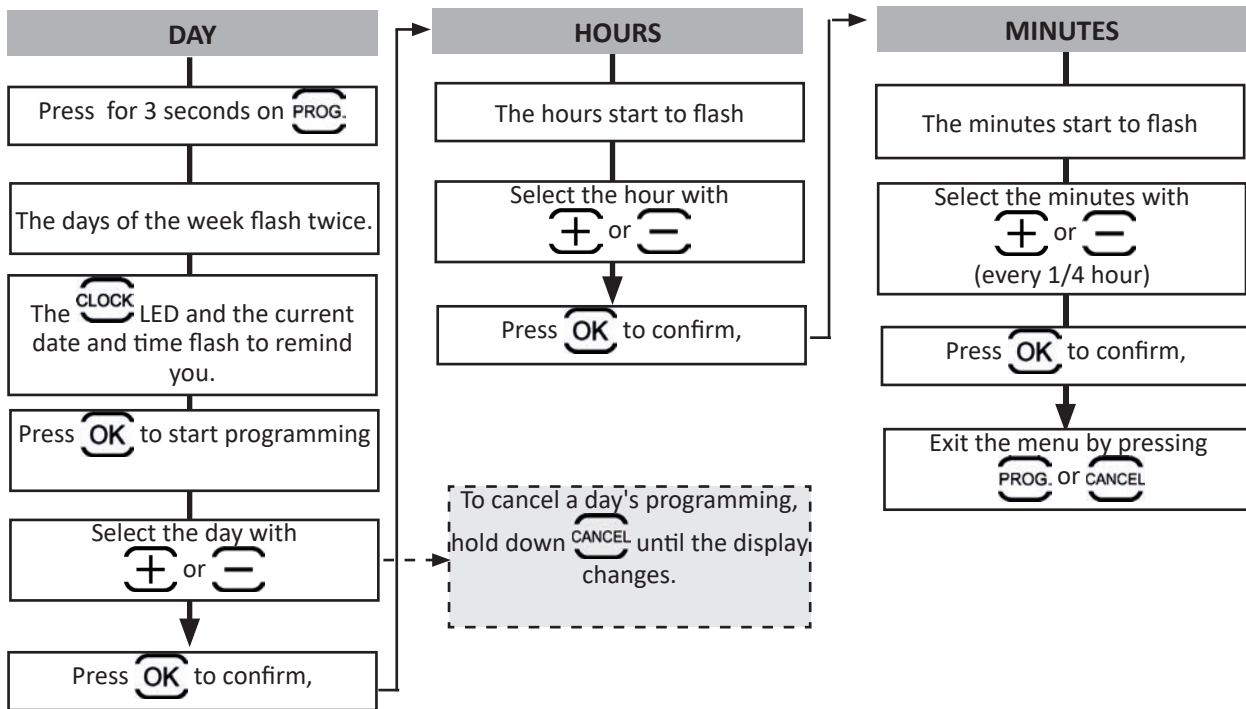

- The programming stops automatically at the end of the 7th cleaning cycle and the LED **PROG.** switches off.
- To cancel ALL the programming, exit the menu **PROG.** and hold down **CANCEL** until the display changes.



Tip: check the programming



Press **PROG.** Each programming is displayed for 3 seconds.

2.7 | The remote control (depending on the model)



- Respect the battery polarity.
- Do not recharge the battery, dismantle it or throw it onto a fire.
- Do not expose it to high temperatures or direct sunlight.

2.7.1 Switching the remote control on and off

- To switch on: press .
- To switch off: press and hold .



Tip: improve the remote control reception.

The frequency of the flashing of the led located on the remote control indicates the reception quality. If the LED flashes quickly, reception quality is OK.

For the best communication between the control box and the remote control:

- Position the control box on the caddy.
- Turn the control box towards the pool
- Removal all large obstacles between the control box and the pool.

EN

2.7.2 Piloting the cleaner

- The remote control is equipped with movement sensors to direct the cleaner:

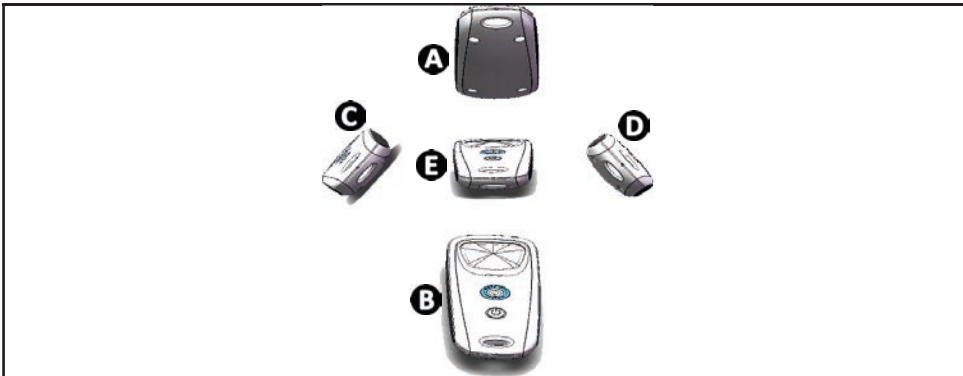



- A**: Forwards
- B**: Backwards
- C**: Left turn
- D**: Right turn
- E**: Stop

2.7.3 Removing the cleaner from the water (depending on the model)

- Press . The cleaner moves toward the wall and climbs up to the waterline.

2.7.4 Synchronising the remote control with the control box

By default, the remote control is already synchronised with the control box. If replacing the remote control/control box or if a synchronisation problem occurs, follow the steps below:

- Place the remote control a **maximum of 50 cm** away from the control box.
- Connect the control box, check that the display shows the operating time, and that no cleaning cycle is running.
- Switch on the remote control by pressing .
- Before the remote control switches to standby (around 45 seconds) press the  and  buttons simultaneously for 6 seconds.
- Check that synchronisation was successful by observing the display and the remote LED:

Display on the control box	Remote LED	Result
Good → 0:45 2 seconds	Flashing	<ul style="list-style-type: none"> • Synchronisation successful.
FAIL	On steady	<ul style="list-style-type: none"> • Check that the distance between the control box and the remote control is 50 cm maximum. • Check the remote control batteries. Replace them if necessary. If the problem is not resolved, contact your retailer.



2.8 I Removing the cleaner from the water



- To prevent damaging the equipment, use only the handle to remove the appliance from the pool.

2.8.1 "LIFT SYSTEM" automated mode

The "Lift System" function was designed to facilitate removing the cleaner from the water. It may be activated at any time, during or at the end of a cleaning cycle.

- If necessary, press and hold the button  to direct the cleaner towards the required wall, the cleaner pivots. When facing the right wall, release the button. The cleaner moves towards the wall (see image **1**).
- Or just briefly press the button  to move it towards the opposite wall (see image **1**).
- The cleaner climbs the wall and stays at the waterline (see image **2**).
- Use the handle to take it out of the water. The cleaner expels water through a rear jet to make it lighter (see image **3**).

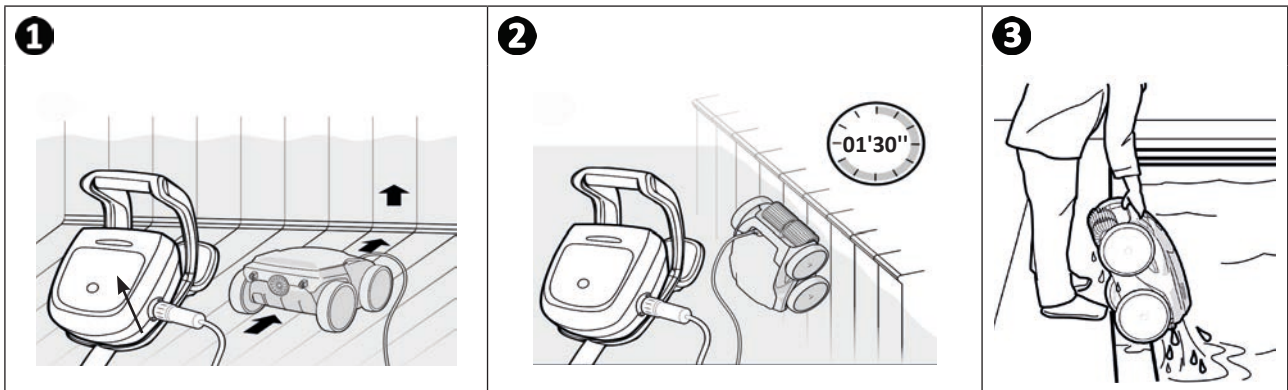

2.8.2 Manually



- Switch off the appliance by pressing .
- Bring the cleaner to the edge of the pool by gently pulling on the floating cable.
- When possible, pick up the cleaner by the handle and lift it gently out of the pool so that the water it contains drains into the pool (see image **1** and **2**).

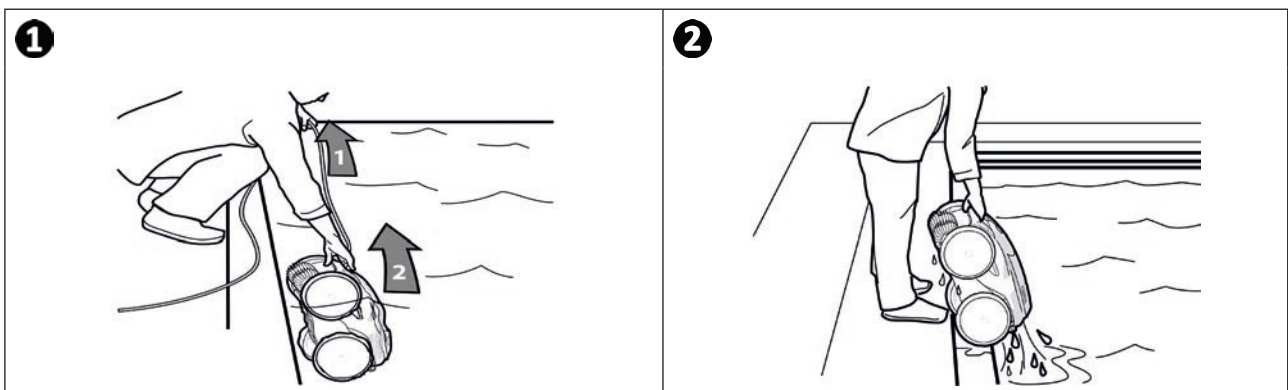

2.9 I Good practices after each cleaning operation

2.9.1 Clean the filter as soon as the appliance is out of the pool



- The cleaner's performance may be reduced if the filter is full or dirty.
- Clean the filter in clean water as soon as the appliance is removed from the pool after each cleaning cycle. Do not wait for the debris to dry.

- After each cleaning cycle, follow the steps for cleaning the filter, voir § « 3.2 I Clean the filter as soon as the appliance is out of the pool ».

2.9.2 Lay out the cable to reduce tangling

The appliance's behaviour is strongly impacted by the tangling of the cable. A cable that is correctly untangled will guarantee better coverage of the pool.

- Untangle the cable and lay it out in the sun so that it returns to its original shape.

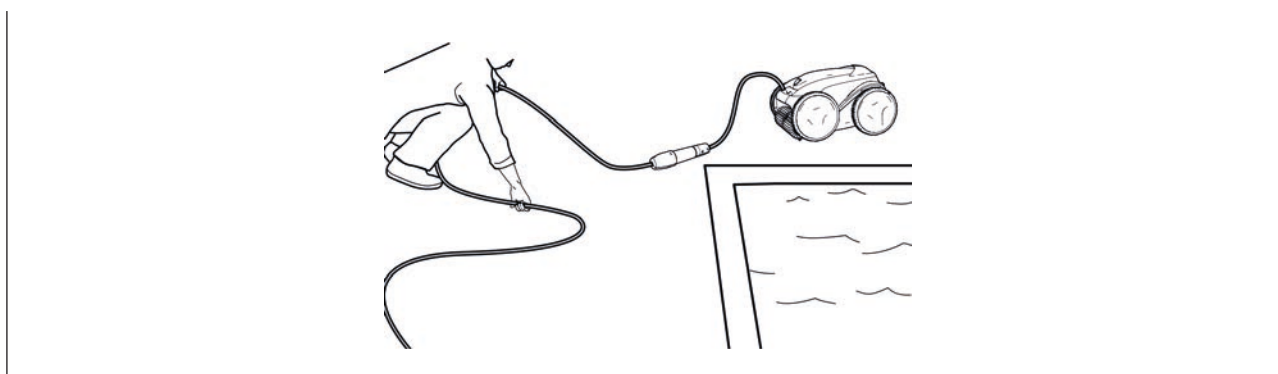

2.9.3 Storing the cleaner and cable

- Screw the protective cap back on if you unplug the control box power cord.
- Place the cleaner vertically at the location provided on the caddy for it to dry out quickly. Roll up the cable carefully and place it on the caddy handle (see image 1).
- Store all elements away from direct sunlight, humidity, and the elements, as well as any splashes. A protective cover is available as an option (see image 2).

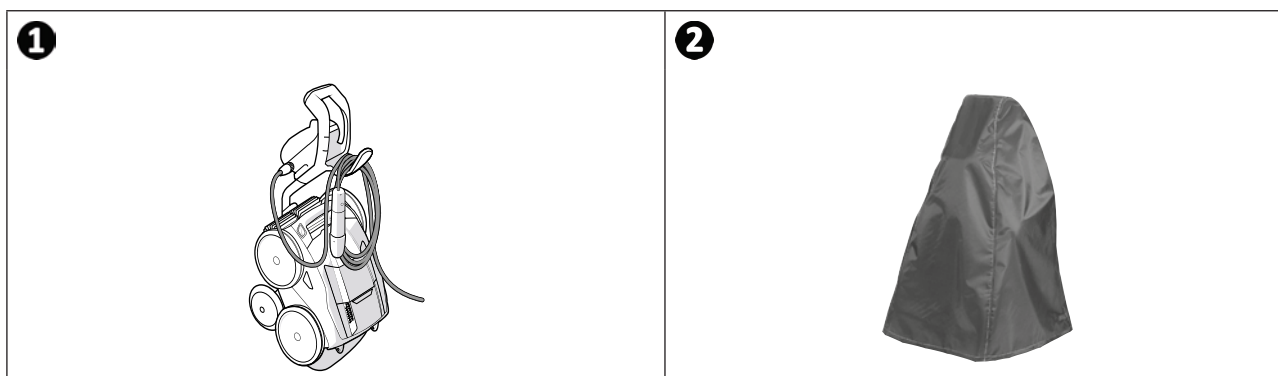



3 Maintenance



To avoid serious injury:

- Disconnect the cleaner from the power supply.

3.1 I Cleaning the cleaner

- The appliance must be cleaned regularly using clean or slightly soapy water. Do not use solvents.
- Rinse the appliance thoroughly with clean water.
- Do not let your appliance dry in the sun by the pool.



Tip: replace the filter and brushes every 2 years

You are encouraged to change the filter and the brushes every 2 years to preserve the integrity of the appliance and guarantee optimum performance.

3.2 I Clean the filter as soon as the appliance is out of the pool

- If the filter is blocked, clean it with an acid solution (spirit vinegar, for example). It is recommended that you do this at least once a year, since the filter will clog if not used for several months (winterising period).

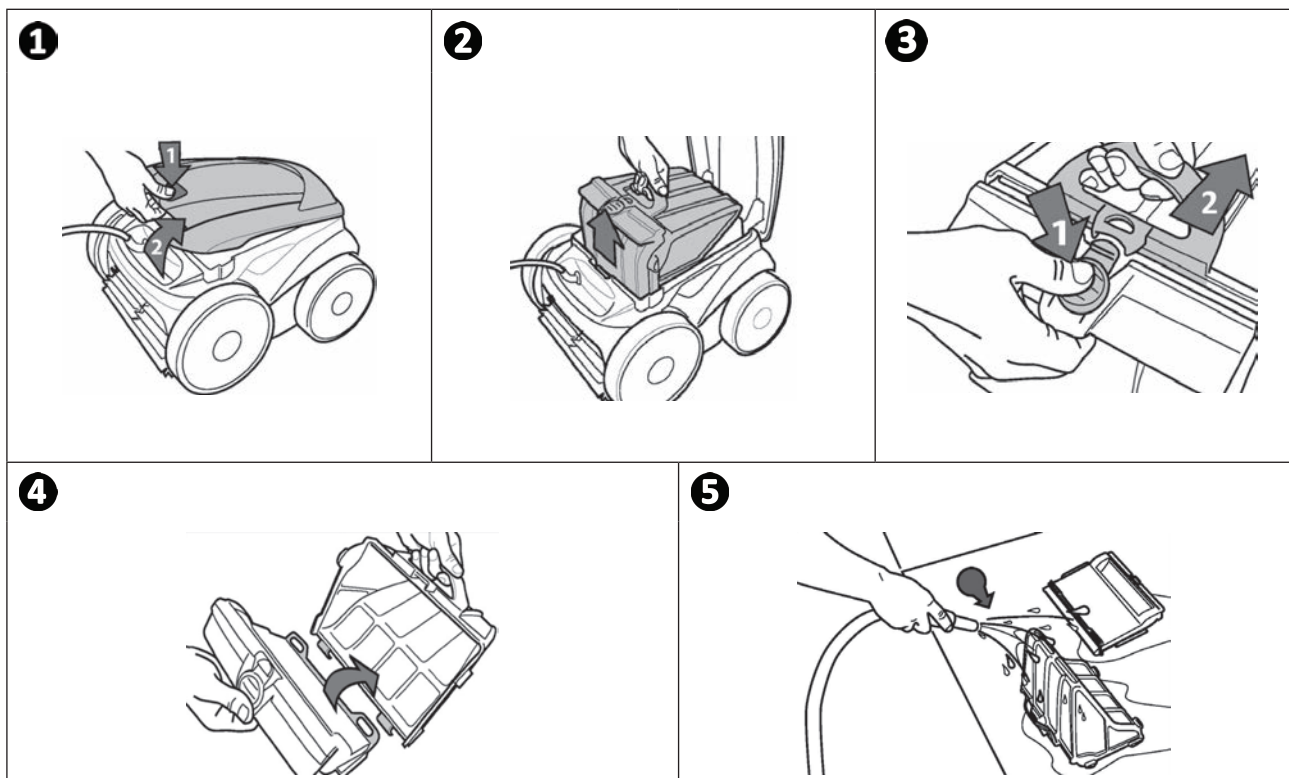

Tip: Check the status of the "filter cleaning" indicator

When the LED is lit, it is strongly recommended that you clean the filter.

3.3 I Cleaning the propeller

To avoid serious injury:



- Disconnect the cleaner from the power supply.

- Wear gloves when maintaining the propeller



- Loosen the screw on the grid (see figure 1).
- Remove the grid (see figure 2).
- Remove the flow guide carefully (see figure 3).
- To remove the propeller, wear gloves and hold the end of the propeller carefully when pushing it (see figure 4).
- Remove all debris (hair, leaves, stones, etc.) which may be blocking the propeller.

EN

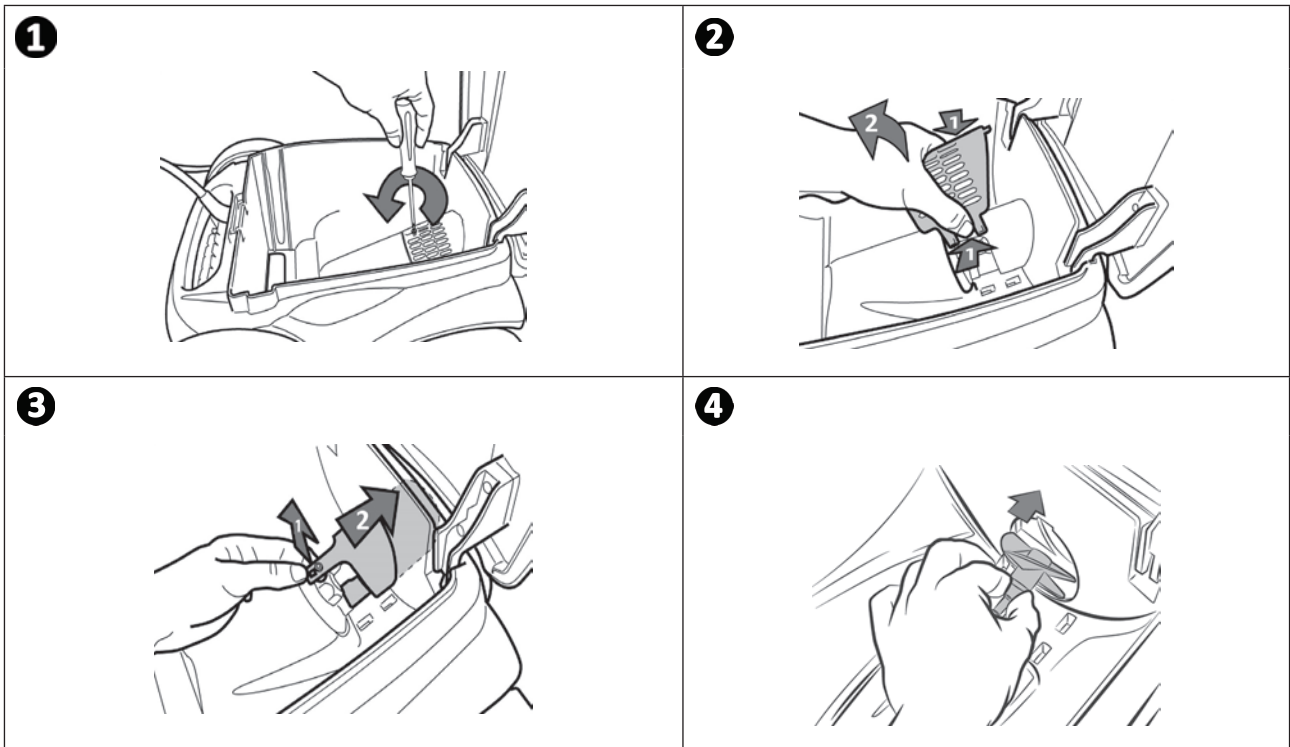

➤ 3.4 I Replacing the brushes

Are the brushes worn?

- Replace the brushes if the wear indicators are similar to example **B**:

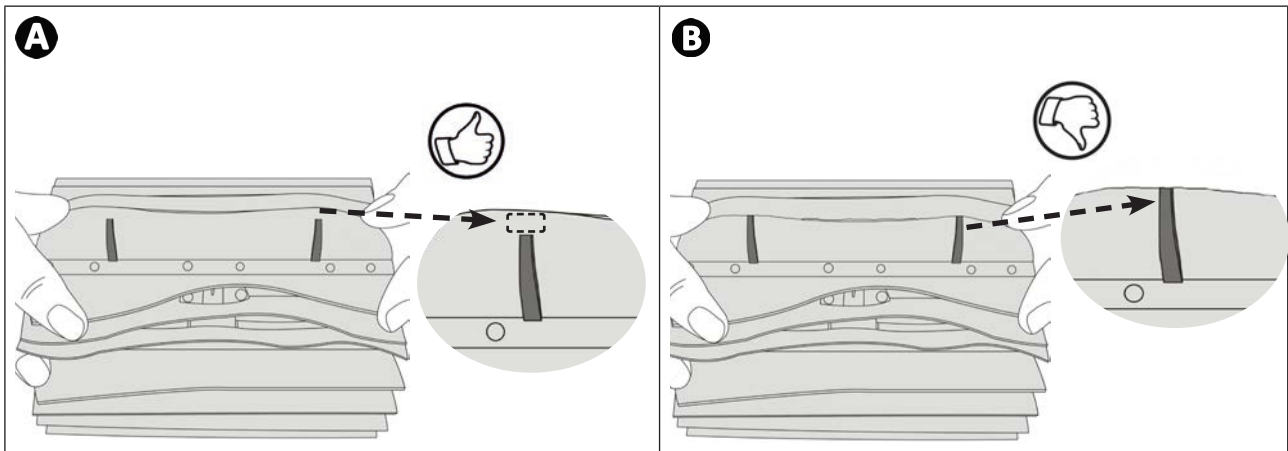

Remove the worn brushes

- Remove the tabs from the holes inside which they are fastened, then remove the brushes.

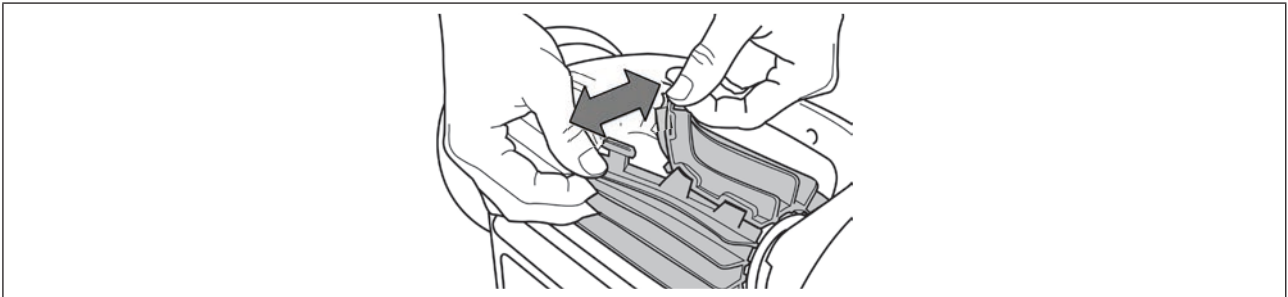

Position the new brushes.

- Fit the side without tabs under the brush holder (see image **1**).
- Roll the brush around its support, slide the tabs into the attachment holes and pull on the end of each tab until its edge passes through the slit (see figure **2**).
- Cut the tabs using a pair of scissors for them to be level with the other blades (see figure **3**).

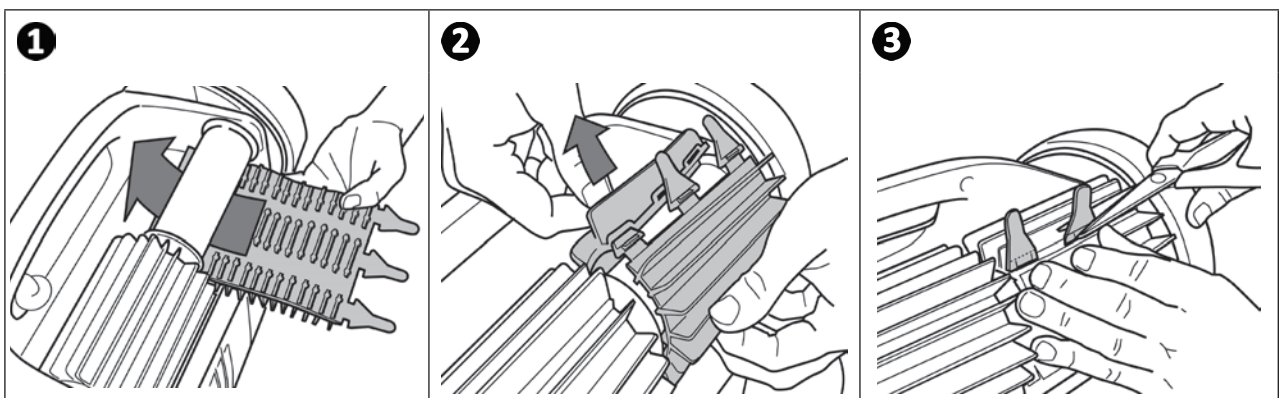

▶ 3.5 | Changing the tyres

Remove the worn tyres

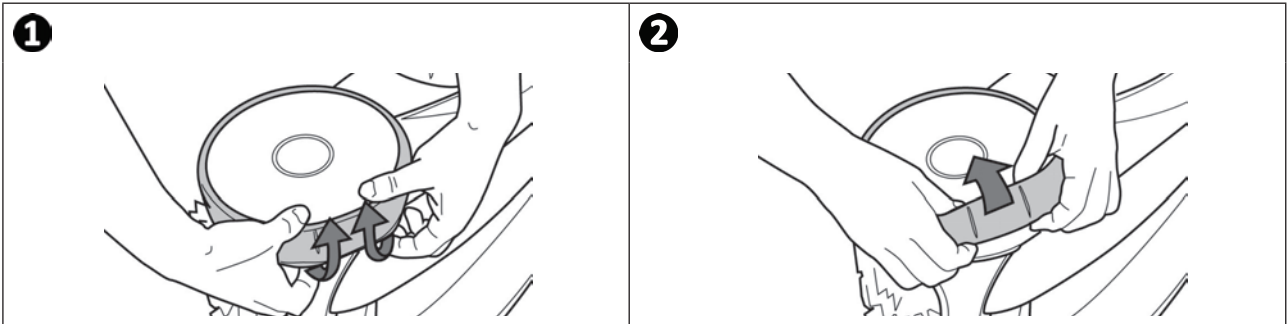

EN

Position the new tyres

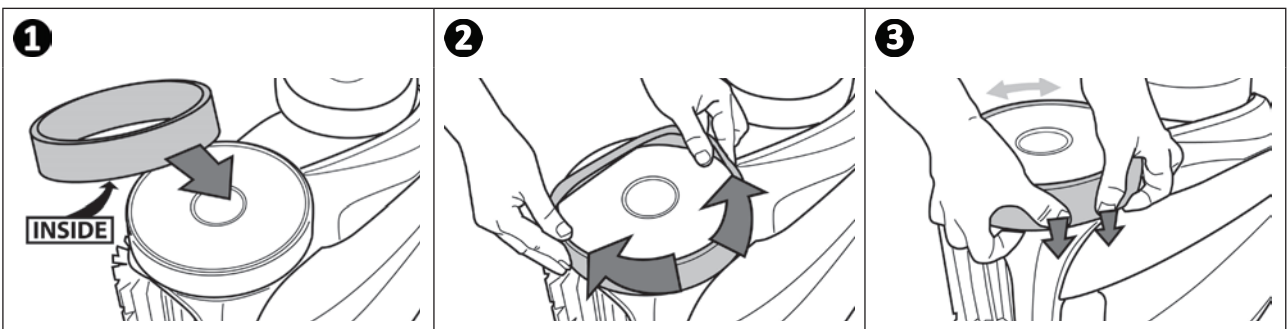





4 Troubleshooting



- If a problem occurs, before you contact your retailer, please carry out these few simple checks using the following tables.
- If the problem is not resolved, contact your retailer.
- : Actions to be performed by a qualified technician only.



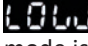

4.1 I Appliance behaviour

Part of the pool is not correctly cleaned	<ul style="list-style-type: none"> • Repeat the immersion steps (see § « 2.1 I Immersing the cleaner in the pool »), varying the immersion location until you find the right place in the pool.
The appliance does not stay firmly on the pool bottom	<ul style="list-style-type: none"> • There is still air in the appliance's casing. Repeat the immersion operations (see § « 2.1 I Immersing the cleaner in the pool »). • The filter is full or clogged: clean it with fresh water. If the filter is blocked, clean it with an acid solution (spirit vinegar, for example). Replace the filter if necessary. • The propeller is damaged: 
The appliance does not or no longer climbs the pool sides as it originally did. (Its electronic programme means that the appliance does not systematically climb the walls).	<ul style="list-style-type: none"> • The filter is full or clogged: clean it with fresh water. If the filter is blocked, clean it with an acid solution (spirit vinegar, for example). Replace the filter if necessary. • The tyres are worn: replace them. • Even though the water seems clear, microscopic algae are present in your pool. They are not visible to the naked eye, and they make the walls slippery and prevent the appliance from climbing. Carry out shock chlorination and slightly reduce the pH. Do not leave the appliance in the water during shock treatment. • The brushes are worn: check the wear indicators § « 3.4 I Replacing the brushes », then turn the brushes to check the rotations. Replace the brushes where necessary.
The appliance does not move on start-up.	<ul style="list-style-type: none"> • Check that the control box's power socket is receiving a power supply. • Check that a cleaning cycle has been launched and that the lights are on.
The cable gets tangled	<ul style="list-style-type: none"> • Do not unroll the entire length of the cable into the pool. • Place the required length of cable in the pool and spread the rest along the side of the pool.
The cleaner's discharge nozzles or bottom plug holes become blocked	<ul style="list-style-type: none"> • Stop the filter pump and begin a new cleaning cycle. • Place the control box halfway along the length of the pool, in accordance with the safety conditions, see § « 2.3 I Electricity supply connection ». If cleaning is not optimal, vary the location of the control box and the place at which the cleaner enters the pool.
The cleaner climbs the walls slowly and stops under the water line The cleaner climbs the walls quickly and goes past the water line, aspirating air	<ul style="list-style-type: none"> • The cleaner may behave differently depending on the lining of the pool. A parameter may require changing. To do this, contact your retailer 
The control box does not respond to any button presses.	<ul style="list-style-type: none"> • Unplug the power cord from the mains socket, wait 10 seconds and plug it back in again.

The screen displays the message  when the remote control mode is active	<ul style="list-style-type: none"> This means that the remote control batteries are too low: change them.
The remote control LED is flashing slowly or the LED is steadily lit.	<p>Remote control range problem:</p> <ul style="list-style-type: none"> Position the control box on the caddy at least 3.5 metres from the pool. Orient the control box towards the pool in order to improve the range of the remote control. Ensure there are no large obstacles between the control box and the pool.
The remote control LED is steadily lit.	<ul style="list-style-type: none"> Synchronisation problem: repeat the synchronisation steps (see § « 2.7.4 Synchronising the remote control with the control box »).

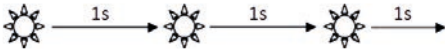

If the problem continues contact your retailer: 

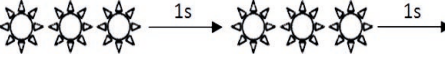
➤ **4.2 I User alerts**

User alerts (depending on the model)		Solutions
Flashing LED: 	Error code: 	
	Er: 10	<ul style="list-style-type: none"> Check that the cleaner is correctly connected to the control box. If necessary, unplug it and reconnect it following the appropriate procedure.
	Er: 02 Er: 03 Er: 05 Er: 06	<ul style="list-style-type: none"> Check that there is nothing preventing the brushes and wheels from turning. To do so, turn the wheels (1/4 turn) to release any debris that may be jammed.
	Er: 07 Er: 08	<ul style="list-style-type: none"> Cleaner operating outside the pool. Make sure you start the cleaner when it is in the water (see § « 2.1 I Immersing the cleaner in the pool »).
	Er: 01 Er: 04	<ul style="list-style-type: none"> Check that there are no stones or hair in the propeller. Clean or change the filter if necessary.



If the problem continues contact your retailer: 

Error codes

- Pressing a key deletes the error code and turns off the control box.
- The screen switches to standby after 10 minutes. To turn the screen back on, press any key.
- When an error is detected, the control box temporarily suspends the programme (the  LED is turned off).
- Press and hold the  key to re-confirm the current programming.

➤ 4.3 I Pre-diagnostic menu (depending on the model)

- Stopping the appliance if a cleaning cycle is in progress.
- To access the menu:

AV 350 50 - GV 3520 - OV 3500 - OV 3505 - OV 3510 - RV 4550 - RV 4560 - Vortex™ 305 - Vortex™ 4 PLUS	Press  for at least 5 seconds.
RV4560 - RV 5400 - RV 5470 - RV 5500 - RV 5600	Press  +  for at least 5 seconds.

- The appliance status information scrolls:

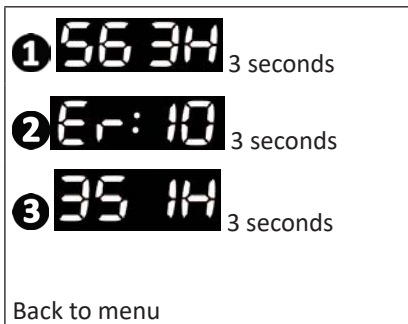

① 56 34 3 seconds

② Er: 10 3 seconds

③ 35 14 3 seconds

Back to menu

- ① The total operating time (in hours)
- ② The last error code (if the cleaner has had at least one error)
- ③ The operating time during the error (if the cleaner has had at least one error)



Tip: if you require assistance, inform the retailer about the appliance's condition



Recycling

This symbol is required by the European directive DEEE 2012/19/EU (directive on waste electrical and electronic equipment) and means that your appliance must not be thrown into a normal bin. It will be selectively collected for the purpose of reuse, recycling or creating value. If it contains any substances that may be harmful to the environment, these will be eliminated or neutralised. Contact your retailer for recycling information.

Votre revendeur
Your retailer

Modèle appareil
Appliance model

Numéro de série
Serial number

Pour plus d'informations, enregistrement produit et support client :
For more information, product registration and customer support:

www.zodiac.com

