

OV 3300 - OV 3400 - OV 3410
OV 3450 - OV 3500 - OV 3510
RV 4200 - RV 4310
RV 4400 - RV 4430 - RV 4460
RV 4550 - RV 4560
RV 5400 - RV 5470
RV 5500 - RV 5600
Vortex™ 3 PLUS - Vortex™ 4 PLUS

Instructions for installation and use
English

EN

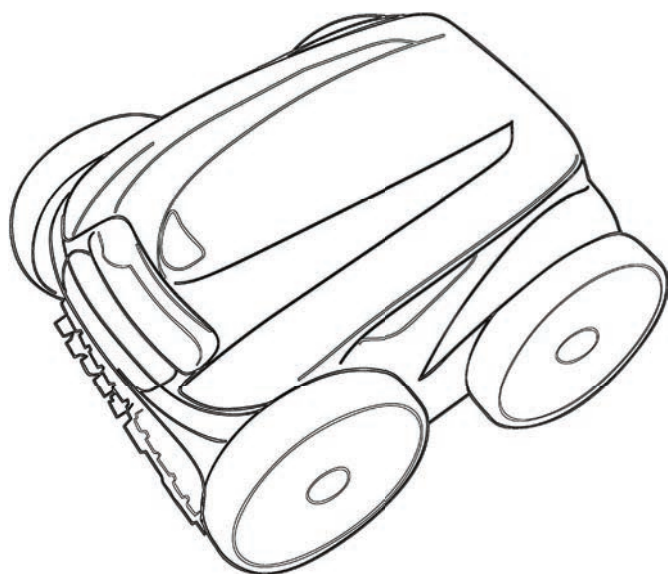

More documents on:
www.zodiac.com

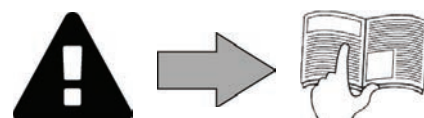



- Before you do anything with the device, it is vital that you read this installation and user manual, as well as the "warnings and warranty" booklet delivered with the device. Failure to do so may result in material damage or serious or fatal injury and will invalidate the warranty.
- Keep and pass on these documents for later consultation during the device's life time.
- It is prohibited to distribute or modify this document in any way without authorisation from Zodiac®.
- Zodiac® is constantly developing its products to improve their quality; therefore, the information contained in this document may be modified without notice.

CONTENTS



1 Specifications

2

1.1 | Description

2

1.2 | Technical specifications and marking

4



2 Installation

5

2.1 | Setup

5

2.2 | Attachment to the base or trolley assembly (depending on model)

5



3 Use

7

3.1 | Operating principle

7

3.2 | Pool preparation

7

3.3 | Immersing the cleaner

7

3.4 | Electricity supply connections

8

3.5 | Starting the cleaning cycle

9

3.6 | Ending the cleaning cycle

10

3.7 | Setting the time and programming the cleaning cycles (depending on the model)

11

3.8 | The remote control (depending on the model)

13



4 Maintenance

14

4.1 | Cleaning the filter

14

4.2 | Cleaning the propeller

15

4.3 | Replacing the brushes

16

4.4 | Changing the bandages

16



5 Troubleshooting

17

5.1 | Device behaviour

17

5.2 | User alerts

18

5.3 | Pre-diagnostic menu (depending on the model)

18



Tip: to make it easier to contact your reseller

Write down your reseller's contact details to help you find them more easily and fill in the "product" information on the back of the manual; your reseller will ask you for this information.



1 Specifications



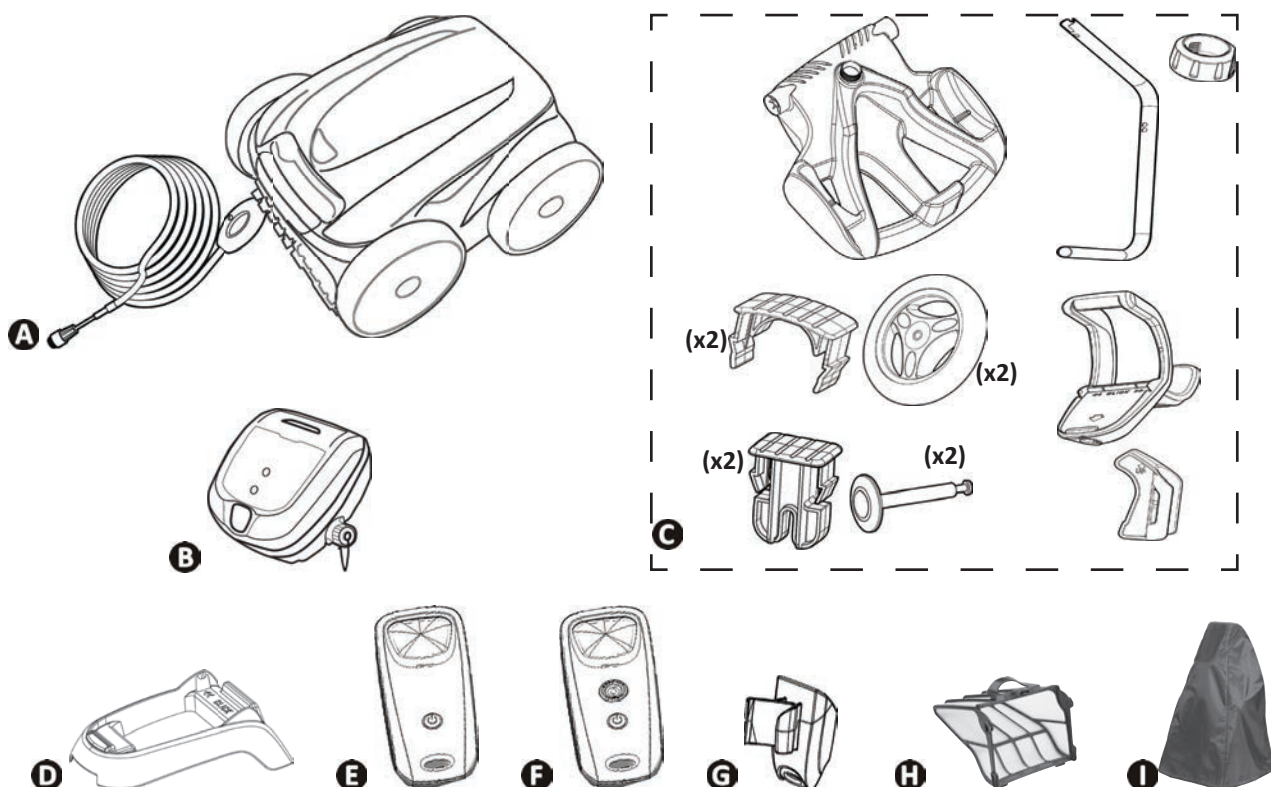









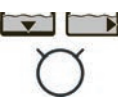

1.1 I Description

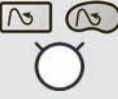
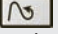

EN

	OV 3300 RV 4200	OV 3400 -OV 3410 OV 3450 -RV 4310 RV 4400 -RV 4430 Vortex™ 3 PLUS	RV 4460	OV 3500 OV 3510 Vortex™ 4 PLUS	RV 4550 RV 4560	RV 5400 RV 5470	RV 5500 RV 5600
A	✓	✓	✓	✓	✓	✓	✓
A	Front driving wheels (2WD)	✓	✓	✓	✓		
	Front/rear driving wheels (4WD)					✓	✓
B	✓	✓	✓	✓	✓	✓	✓
C	+	✓	✓	✓	✓	✓	✓
D	✓						
E				✓			
F					✓		✓
G				✓	✓		✓
H	100µ fine debris filter	✓	✓	✓	✓	✓	✓
	200µ large debris filter	+	+	+	+	+	+
	60µ very fine debris filter	+	+	+	+	+	+
I	+	+	✓	+	+	+	+

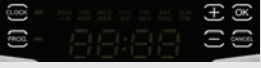
: Supplied
: Available as an option

Symbol	Designation	OV 3300 RV 4200 OV 3400 RV 4310	OV 3410 OV 3450 Vortex™ 3 PLUS	OV 3500 OV 3510 Vortex™ 4 PLUS	RV 4400 RV 4430 RV 4460	RV 4550	RV 4560	RV 5400 RV 5470	RV 5500 RV 5600
	Start/ Stop the device	✓	✓	✓	✓	✓	✓	✓	✓
	"Control" indicator	✓	✓		✓				
	"Clean filter" indicator				✓	✓	✓	✓	✓
	Removal from pool mode				✓	✓	✓	✓	✓
	Surface to clean		✓	✓	✓	✓	✓	✓	✓
	 Bottom only		✓	✓	✓	✓	✓	✓	✓
	 Bottom + sides + water line		✓	✓	✓	✓	✓	✓	✓
	 Waterline only								✓
	Pool shape								✓
	 Flat bottomed rectangular								✓
	 Other shapes, other bottoms								✓
	Cleaning intensity								✓
	 Low intensity								✓
	 Intensive								✓
	Cleaning cycle programming 						✓	✓	✓
	Increase or reduce the cleaning time 			✓		✓			
	Switch on / off the remote control			✓		✓	✓		✓

✓: Available

1.2 I Technical specifications and marking

1.2.1 Technical specifications

	OV 3300 RV 4200	OV 3400 - OV 3410 - OV3450 - OV 3500 - OV 3510 - RV 4310 - RV 4400 - RV 4430 - RV 4460 - RV 5400 - RV 5470 - Vortex™ 3 PLUS - Vortex™ 4 PLUS	RV 4550 RV 4560 RV 5500	RV 5600
Control box power supply voltage	220-240 VAC, 50 Hz			
Cleaner power supply voltage	30 VDC			
Maximum absorbed power	150 W			
Cable length	15 m	18 m	21 m	25 m
Cleaner size (L x W x h)	43 x 48 x 27 cm			
Package size (L x W x h)	69 x 43 x 46 cm	56 x 56 x 46 cm		
Cleaner weight	9.5 kg			
Packaged weight	14 kg	19 kg		
Theoretical cleaning width	270 mm			
Pump flow	16 m ³ /h			
Cycle duration	Depending on the selected cycle			

EN

1.2.2 Marking

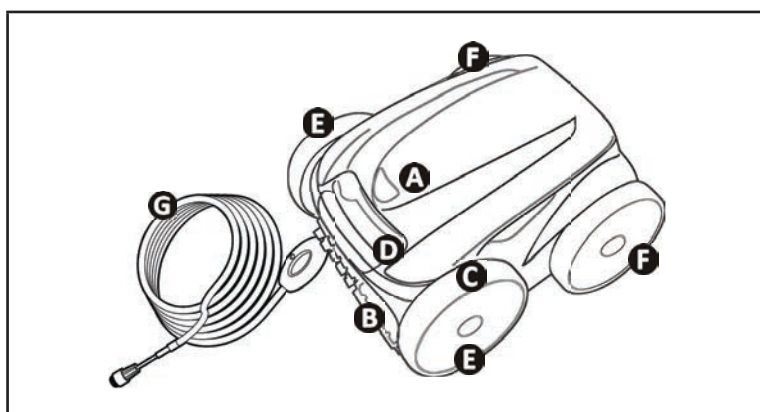

- A**: Filter access hatch lock
- B**: Brushes
- C**: Linings
- D**: Transport and removal from pool handle
- E**: Front driving wheels
- F**: Rear driving wheels (according to model)
- G**: Floating cable

1.2.3 Product conformity

This appliance has been designed and built according to the following standards:

Low voltage directive: 2006/95/EC

Electromagnetic compatibility directive: 2004/108/EC

EN 55014-1: 2000 +A1:2001 +A2:2002 ; EN 55014-2: 1997 +A1:2002

EN 60335-1: 2002 + A1:2004 + A2:2006 +A11:2004 + A12:2006 ; EN 60335-2-41: 2003 + A1:2004

Relative to which it is compliant. The product has been tested under the normal conditions of use.

SAFETY STANDARDS:

The cleaners are classified by the ETL as being compliant with the appropriate requirements of IEC 60335-2-41.





2 Installation

2.1 I Setup

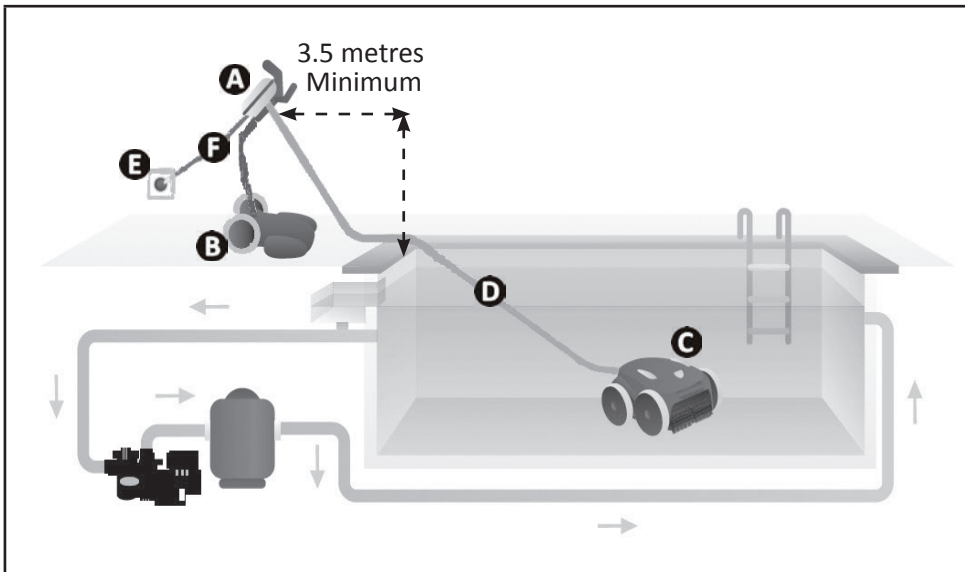

- A**: Control box
- B**: Trolley
- C**: Cleaner
- D**: Floating cable
- E**: Plug
- F**: Supply cable

2.2 I Attachment to the base or trolley assembly (depending on model)

2.2.1 Attachment to the base

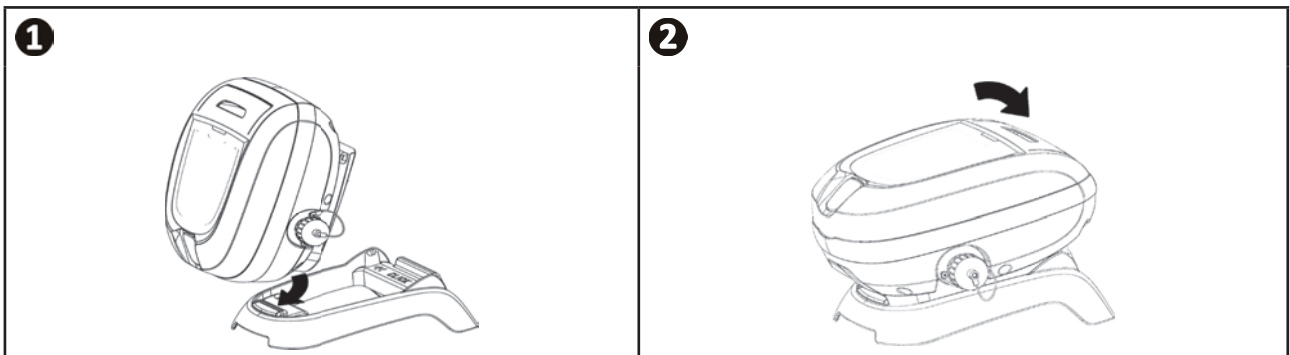

2.2.2 Trolley assembly



• Tool-free assembly

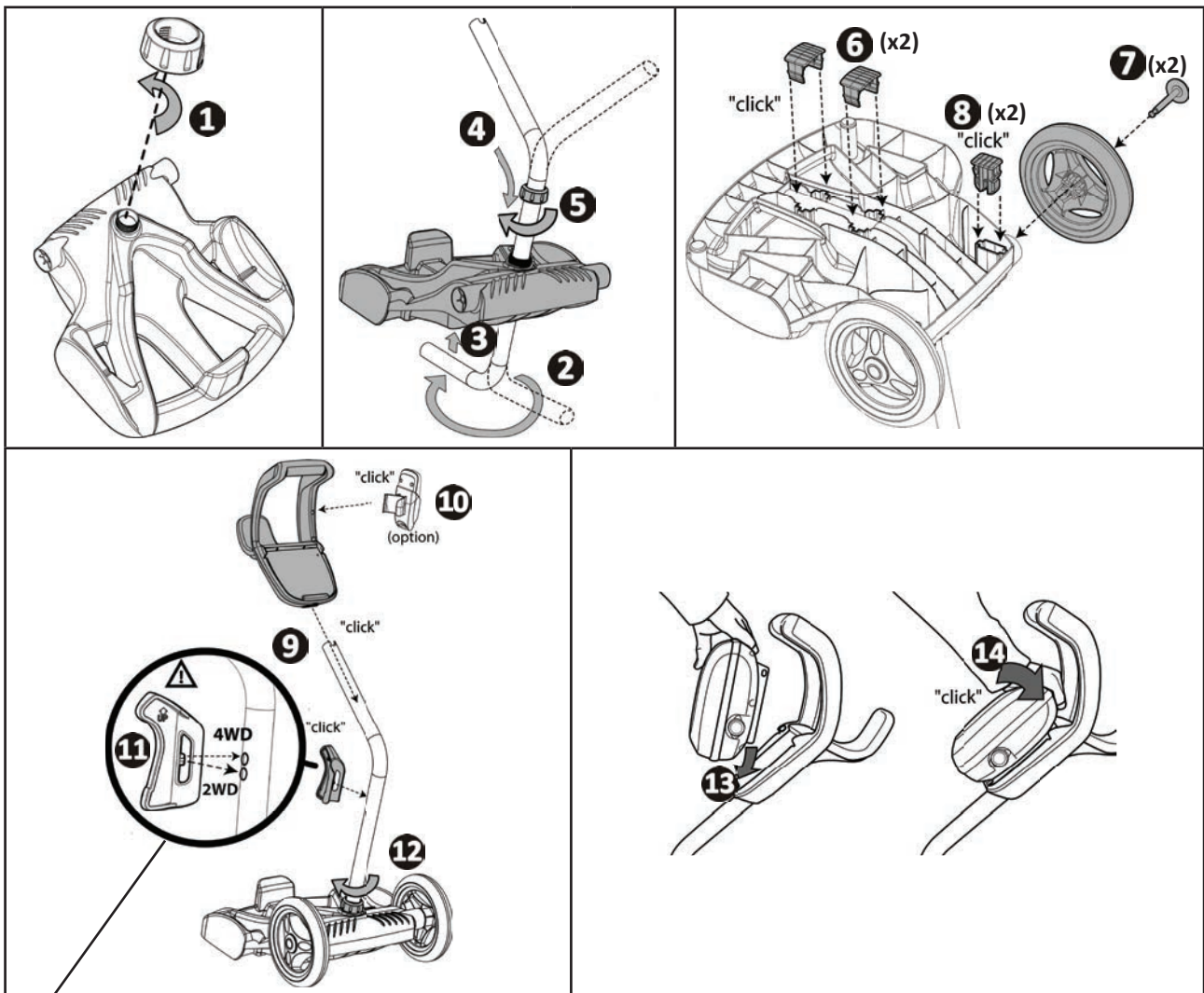

EN

11 For the number of driving wheels (2WD or 4WD), see: "1.1 | Description"



3 Use

3.1 | Operating principle

The cleaner is independent of the filtration system and simply connected to the mains and so can operate autonomously. It finds the best route to move around and clean the areas of the pool for which it has been designed (depending on the model: bottom, walls, water line). Debris is sucked in and stored in the cleaner's filter.

The control box enables the cleaning operations to be started, selected and programme (depending on the model).

3.2 | Pool preparation



- This product is intended to be used in pools which are permanently installed. Do not use it in pools which may be dismantled. A permanent pool is built into the ground or on the ground and cannot be easily dismantled and stored.

- The device must operate in pool water with the following quality:

Water temperature	Between 15°C and 35°C
pH	Between 6.8 and 7.6
Chlorine	< 3 mg/l

- When the pool is dirty, especially when commissioning, remove the largest debris using a net in order to optimise the device's performances.
- Remove any thermometers, toys and other objects that might damage the device.

3.3 | Immersing the cleaner

- Roll out the full length of the cable alongside the pool to avoid the cable becoming entangled during immersion (see image 1).
- Place the cleaner vertically into the water (see image 2).
- Move it slightly in all directions so that the air contained in the cleaner escapes (see image 3).
- It is essential that the device sinks on its own and settles on the pool bottom. While it is immersed, the cleaner draws the length of cable it needs into the pool (see image 4).

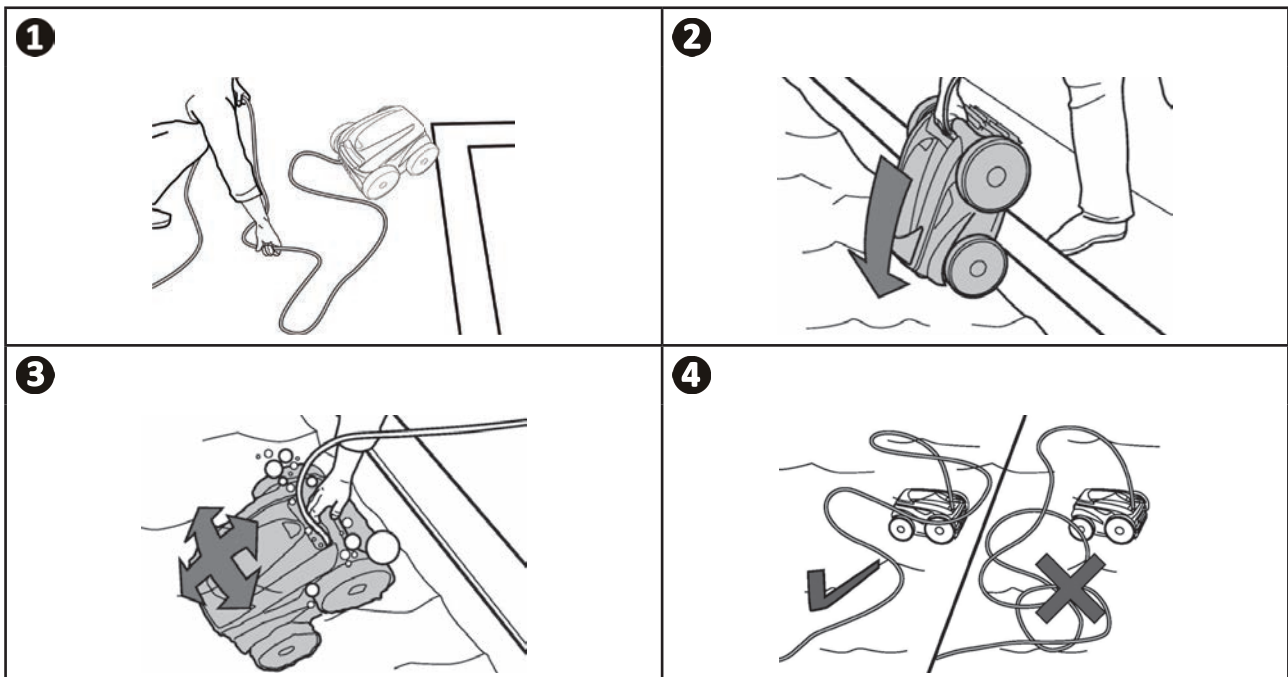

3.4 I Electricity supply connections



- Use of an electrical extension is prohibited when connecting the control box.
- Make sure that the socket can be easily accessed at all times and is kept out of rain or splashes.
- The box is splash-proof but must not be immersed. It must not be installed in a floodable area; keep it at least 3.5 metres away from the edge of the pool and avoid exposing it to direct sunlight.
- Place the control box near the socket.

- Unscrew the protection cap (see image 1).
- Connect the floating cable to the control box and lock it into place by turning it clockwise (to avoid damaging the floating cable) (see image 2, 3).
- Make sure that the connector is fully pushed in so that no water can get in (see image 4).
- Connect the supply cable (see image 5). Only connect the control box to a power outlet protected by a 30 mA maximum ground fault circuit breaker (if in doubt contact a qualified technician).

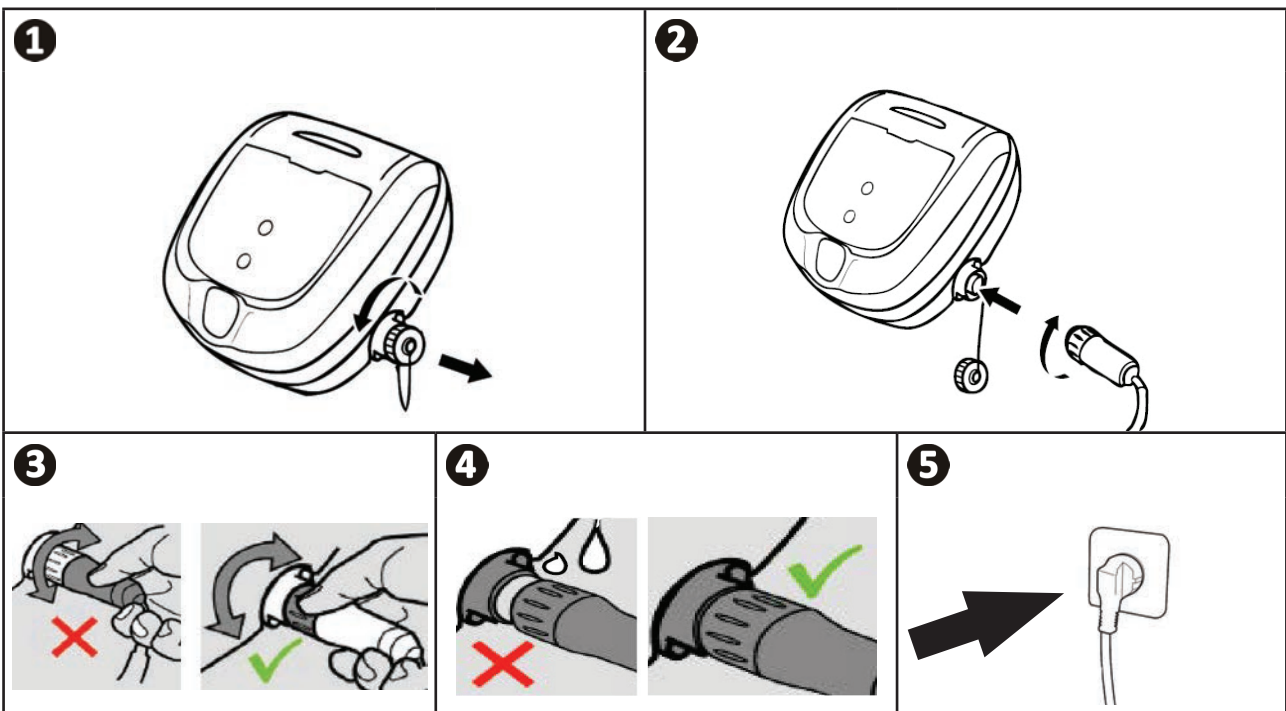

Tip: choose the location of the control box carefully to avoid the cable becoming entangled

Place the control box in the centre of the pool's length, following the safety conditions relating to electrical connection. This lets you limit the length of the floating cable to be put into the water to cover the pool, which reduces setup and storage operations.

3.5 I Starting the cleaning cycle



- Bathing is prohibited when the device is in the pool.
- Do not use the device during shock chlorination.
- Do not leave the device unattended for an extended period.

- When the control box is powered up, the following symbols light up to indicate:
 - The action in progress
 - The cleaning selected
 - Maintenance required
- The control box switches to standby after 10 minutes, and the screen switches off. Just press any key to exit standby mode. Standby mode does not stop the device if it is in a cleaning cycle.

3.5.1 Cleaning cycle selection (depending on model)

- A cleaning cycle is already configured by default: the symbols are on and the cleaning time appears on the screen, for example: **0:45** (depending on the model)
- The cleaning cycle can be selected at any time, before the device starts or while it is operating. The new cycle will be launched instantly and the remaining time countdown will be reinitialised.
- The cleaner adapts its movement strategy depending on the choice in order to optimise the coverage rate.

Surface to clean	Pool shape	Cleaning intensity
Bottom only	Other shapes, other bottoms	Low intensity
Bottom + sides + water line	Flat bottomed rectangular	Intensive
Waterline only		

3.5.2 Launching the cleaning cycle

- Press



Tip: to improve the cleaning performance

At the start of the bathing season, launch several cleaning cycles in bottom only mode (after removing the large debris with a net). Regular use of the cleaner (without exceeding 3 cycles per week) means that your pool will always be clean and the filter less clogged.

3.5.3 Adjusting the cleaning time (depending on model)

- You may reduce or increase the time for the cleaning cycle selected or in progress:
 - : Reduce by 30 minutes.
 - : Increase by 30 minutes.
- Press to confirm.

➤ 3.6 I Ending the cleaning cycle



- Do not pull on the cable to remove the device from the pool. Use the handle.
- Do not leave the device to dry out in sunlight after use.
- Store all the elements away from sunlight, dampness and bad weather.
- Screw the protective cap back on if you unplug the control box power cord.

- Switch off the device by pressing .
- When the cleaner is within arm's reach, pick it up by the handle and lift it gently out of the pool so that the water it contains drains into the pool (see image **1**).
- Place the cleaner vertically at the location provided on the trolley (depending on the model) for it to dry out quickly (see image **2**).
- Then store it with the command box away from sunlight and any splashing. A protective cover is available as an option (see image **3**).

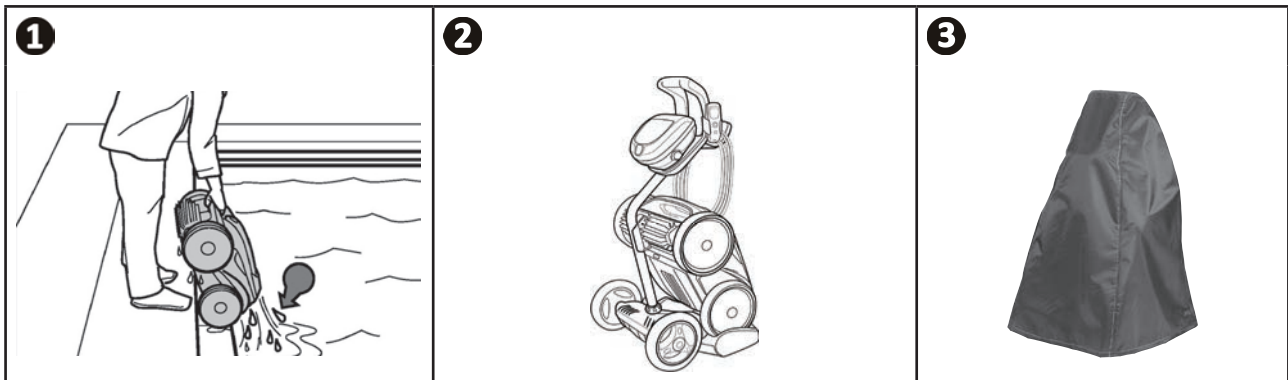

EN

3.6.1 "Out of water" mode (depending on the model)

This function enables the cleaner to be returned to an exact point at the edge of the pool. When it climbs the wall, the cleaner sprays a jet of water behind it to make it lighter as it exits the pool.

- Direct the cleaner towards the wall you want, then have it climb the waterline: hold down  to tilt it. The cleaner moves towards the wall when you release the button.



Tip: prevent the floating cable from becoming too entangled

The cleaner's behaviour is strongly impacted by the tangling of the cable. A cable which is correctly untangled will guarantee better coverage of the pool.

- Untangle the cable and lay it out in the sun so that it returns to its original shape.
- Then wind it up carefully and place it on the trolley handle (depending on the model) or on a fixed support.

3.7 I Setting the time and programming the cleaning cycles (depending on the model)



- Do not disconnect the power cable once the time has been programmed or you will lose it. The time setting will be saved for approximately 2 minutes if the power supply is disconnected.

3.7.1 Setting the time

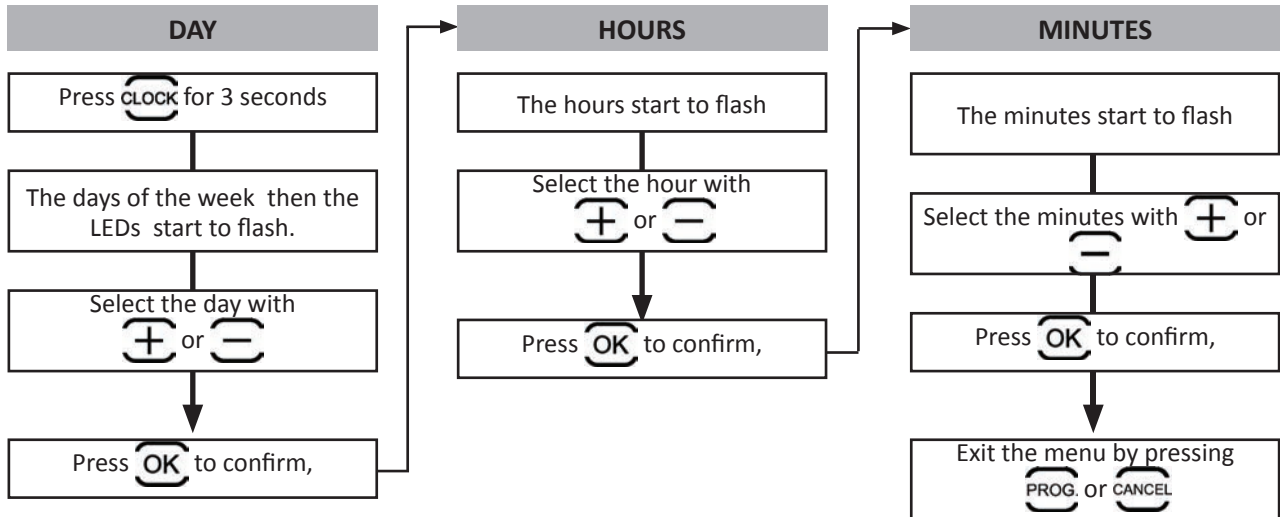

Tip: check the time setting

Stopping the device if a cleaning cycle is in progress. Press CLOCK. The time is displayed for 5 seconds.

3.7.2 Programming cleaning cycles

Program **up to 7 cleaning cycles** (for example, 2 days per week: Wednesdays and Saturdays over 4 weeks).

- You must set the time before you program the cleaning cycles, see § “3.7.1 Setting the time”.
- Start by selecting the cleaning cycle on the control box, see § “3.5.1 Cleaning cycle selection (depending on model)”.
- Then program the days, hours and minutes.

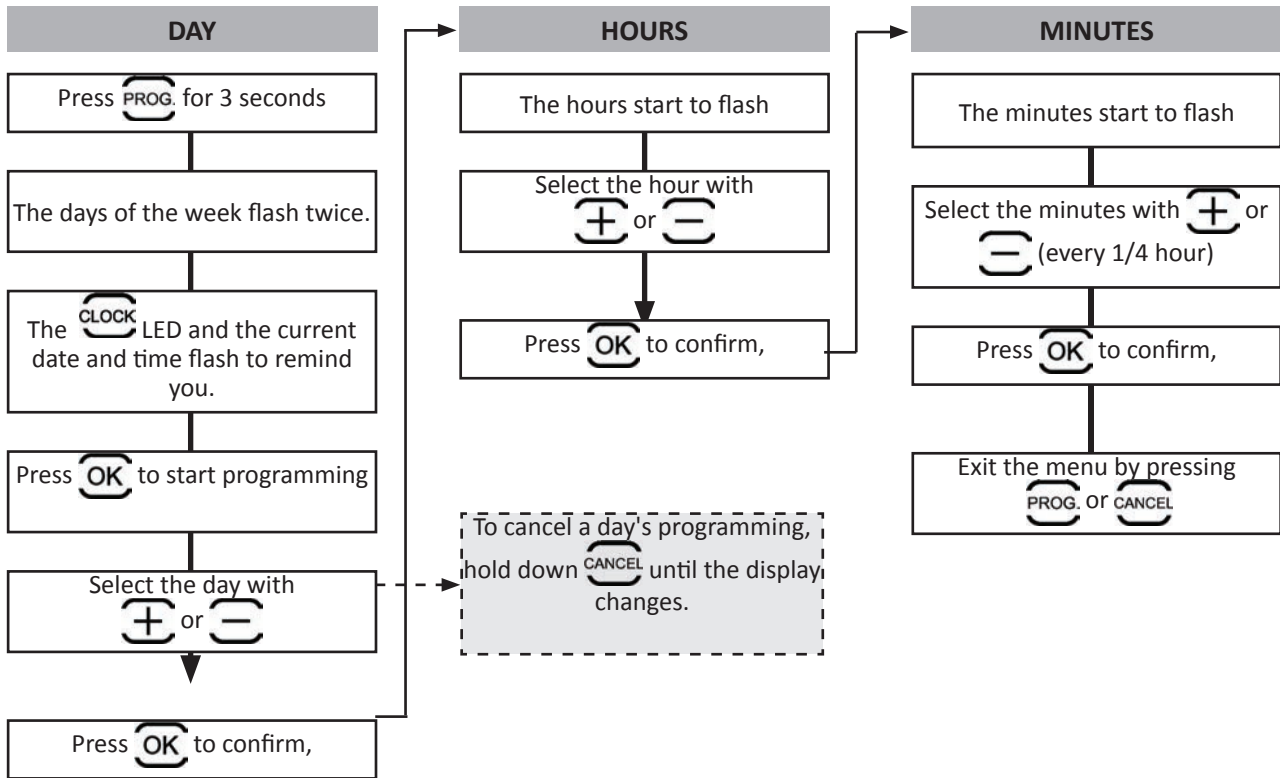

- The programming stops automatically at the end of the 7th cleaning cycle and the LED **PROG.** switches off.
- To cancel ALL the programming, exit the menu **PROG.** and hold down **CANCEL** until the display changes.



Tip: check the programming



Press **PROG.** Each programming is displayed for 3 seconds.

3.8 I The remote control (depending on the model)



- Respect the battery polarity.
- Do not recharge the battery, dismantle it or throw it onto a fire.
- Do not expose it to high temperatures or direct sunlight.

3.8.1 Switching the remote control on and off

- To switch on: press .
- To switch off: press and hold .



Tip: improve the remote control reception.

The frequency of the flashing of the led located on the remote control indicates the reception quality. If the LED flashes quickly, reception quality is OK.

For the best communication between the control box and the remote control:

- Position the control box on the trolley.
- Turn the control box towards the pool
- Removal all large obstacles between the control box and the pool.

3.8.2 Directing the cleaner

- The remote control is equipped with movement sensors to direct the cleaner:

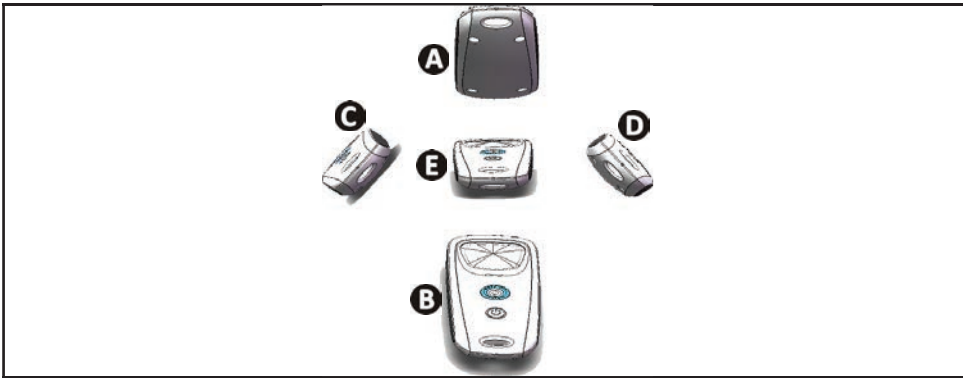



- A**: Forward
- B**: Backwards
- C**: Left turn
- D**: Right turn
- E**: Stop

3.8 Taking the cleaner out of the water (depending on the model)

- Press . The cleaner moves toward the wall and climbs up to the waterline.

3.8.4 Synchronising the remote control with the control box

By default, the remote control is already synchronised with the control box. If replacing the remote control/control box or if a synchronisation problem occurs, follow the steps below:

- Place the remote control a **maximum of 50 cm away** from the control box.
- Connect the control box, check that the display shows the operating time, and that no cleaning cycle is running.
- Switch on the remote by pressing .
- Before the remote control switches to standby (around 45 seconds) press the  and  buttons simultaneously for 6 seconds.
- Check that synchronisation was successful by observing the display and the remote LED:

Display on the control box	Remote LED	Result
Good → 0:45 for 2 seconds	Flashing	<ul style="list-style-type: none"> • Synchronisation successful.
FAIL	On steady	<ul style="list-style-type: none"> • Check the distance between the control box and the remote control is 50 cm maximum. • Check the remote control batteries. Replace them if necessary. If the problem continues contact your reseller.



4 Maintenance

- The device must be cleaned regularly using clean or slightly soapy water. Do not use any solvents.
- Rinse the device generously using clean water.
- Do not let your device dry in the sun by the pool.



Tip: replace the filter and the brushes every 2 years

You are recommended to change the filter and the brushes every 2 years to preserve the integrity of the device and guarantee optimum performance.

4.1 I Cleaning the filter



- The cleaner performance may be reduced if the filter is full or dirty.
- Clean the filter regularly with clean water for efficient pool cleaning.

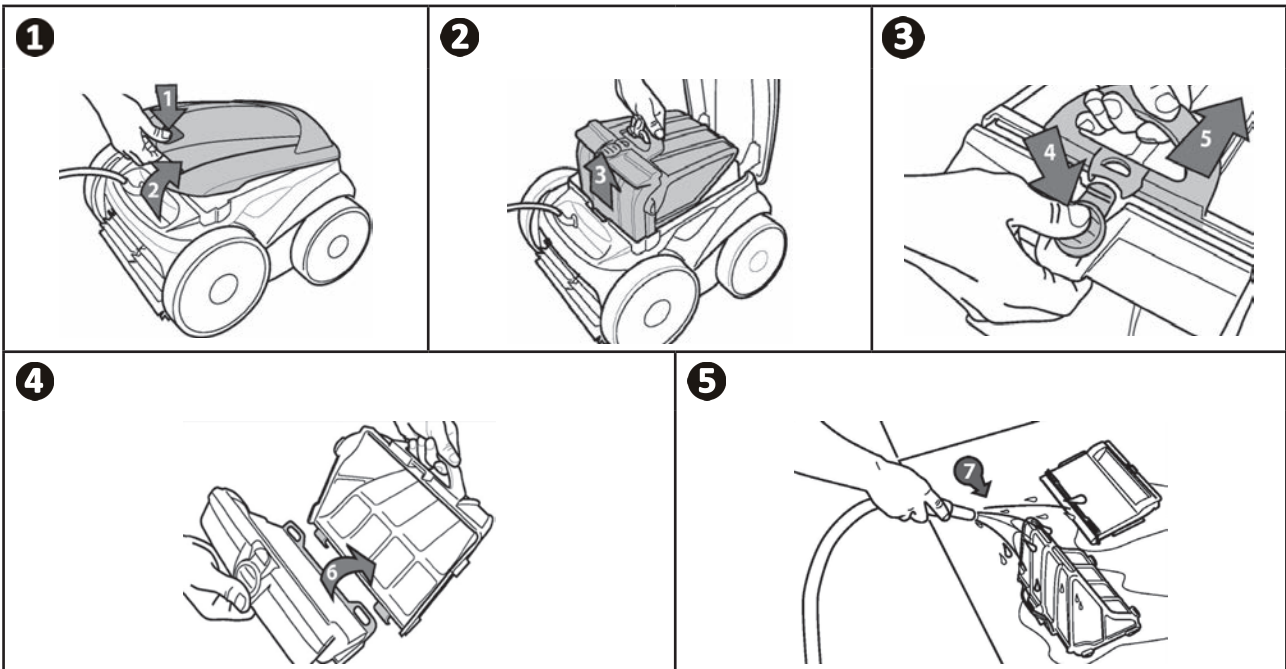

Tip: Check the status of the "filter cleaning" indicator  (depending on the model)

We recommend that you clean the filter as soon as the LEDs light up.

➤ 4.2 I Cleaning the propeller

To avoid serious injury:



- Disconnect the cleaner from the power.
- Wear gloves when maintaining the propeller.



- Loosen the screw on the grill (see image 1).
- Remove the grill (see image 2).
- Remove the flow guide carefully (see image 3).
- To remove the propeller, wear gloves then hold the end of the propeller carefully and push it (see image 4).
- Remove all debris (hair, leaves, stones, etc.) which may be blocking the propeller.

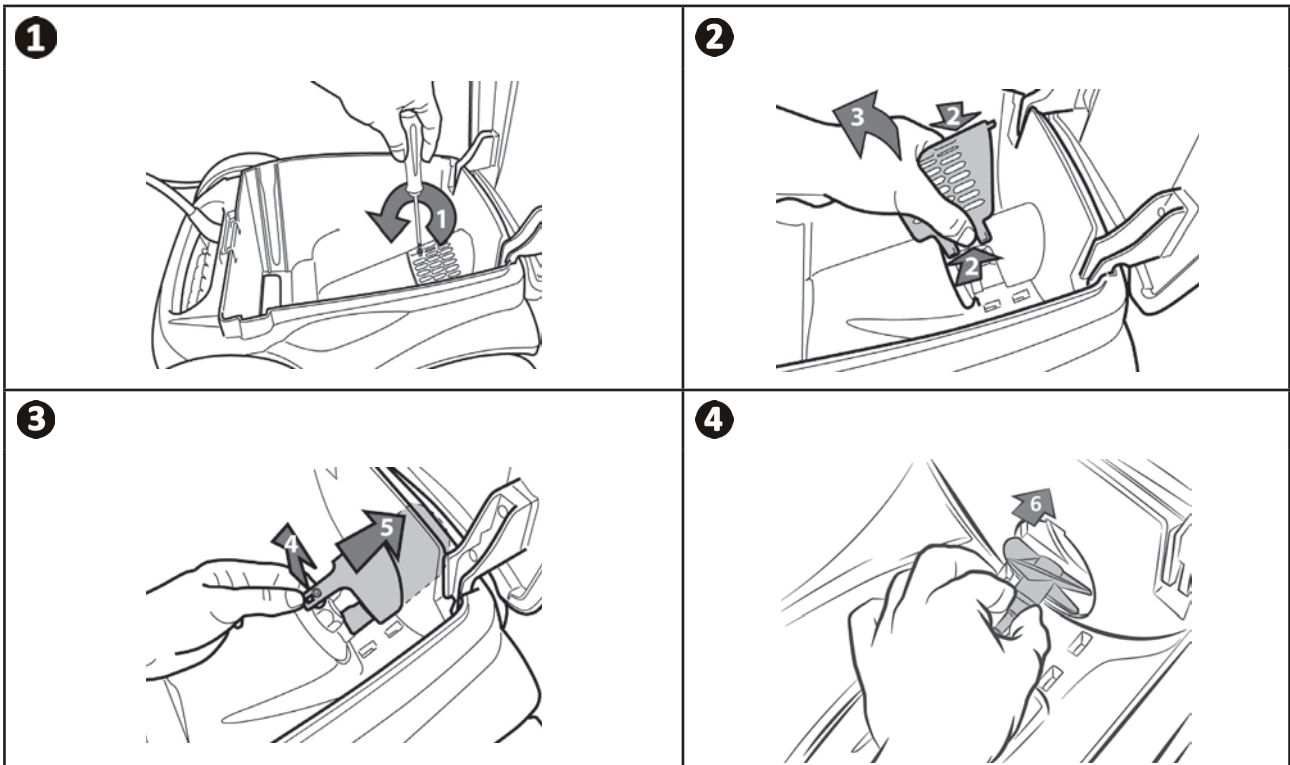

➤ 4.3 I Replacing the brushes

- The appliance is fitted with PVC brushes. They have wear indicators (see image ➊).
- To remove worn brushes, remove the tabs from the holes in which they are fixed (see image ➋).
- To fit new brushes, start by fitting the side without tabs under the brush holder (see image ➌).
- Roll the brush around its support, slide the tabs into the attachment holes and pull on the end of each tab until its edge passes through the slit (see image ➍).
- Cut the tabs using a pair of scissors for them to be level with the other blades (see image ➎).

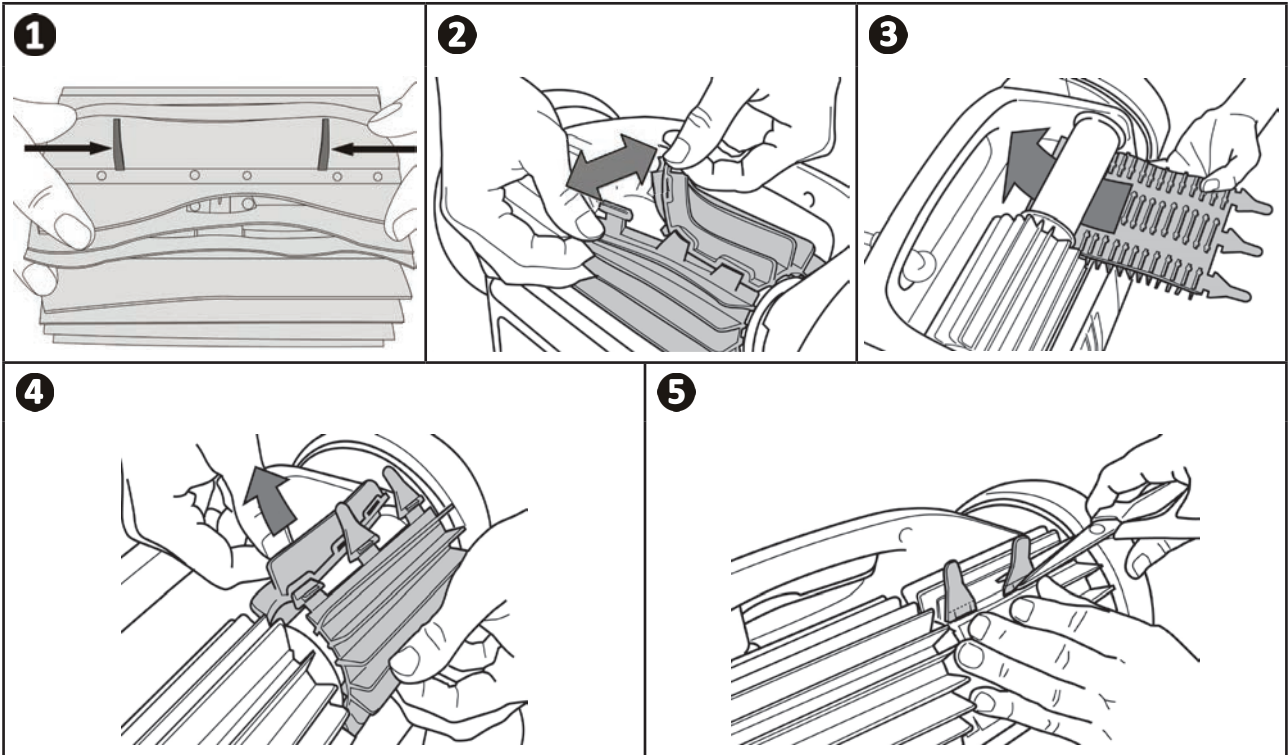

EN

➤ 4.4 I Changing the bandages

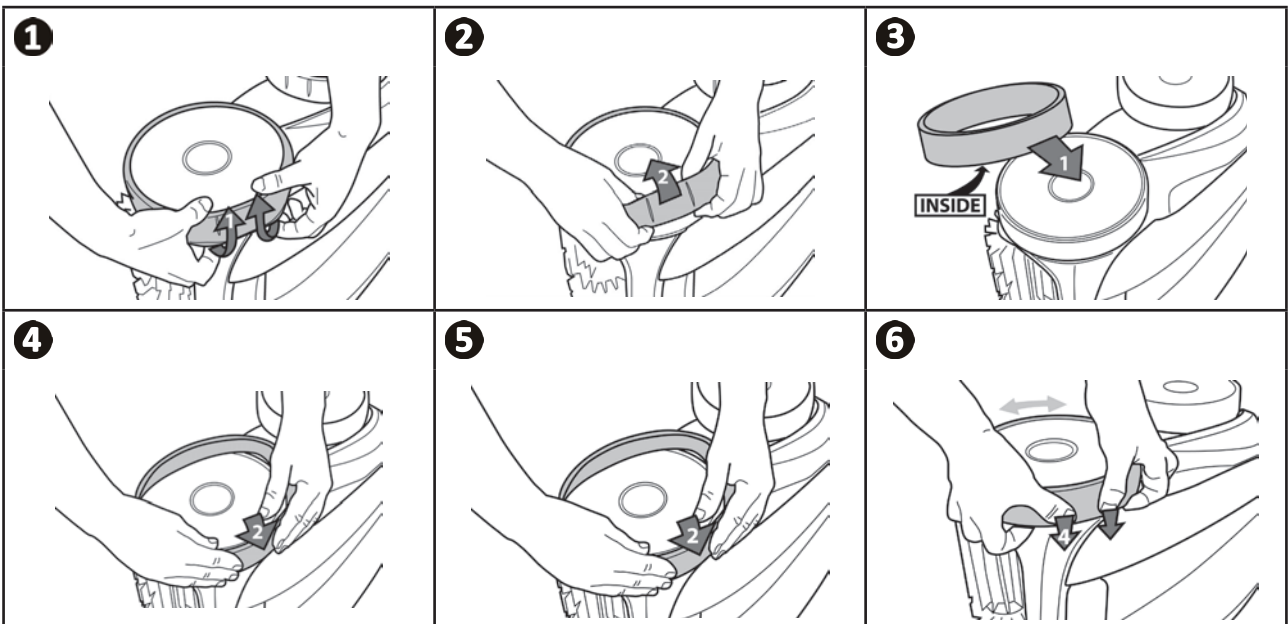



5 Troubleshooting





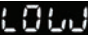

- Before you contact your reseller, please carry out these few simple checks using the following tables if a problem occurs.
- If the problem continues contact your reseller.
-  : Actions reserved for a qualified technician.

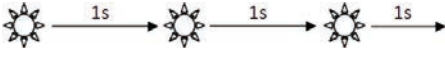

5.1 I Device behaviour

Part of the pool is not correctly cleaned.	<ul style="list-style-type: none"> • Repeat the immersion steps (see § “3.3 Immersing the cleaner”) varying the immersion location until you find the right place in the pool.
The appliance does not stay firmly on the pool bottom	<ul style="list-style-type: none"> • There is still air in the appliance's casing. Repeat the immersion operations (see § “3.3 Immersing the cleaner”). • The filter is full or dirty: clean it. • The filter is clogged: change it. • The propeller is damaged: 
The device does not or no longer climbs the pool sides as it originally did. (its electronic program means that the device does not systematically climb the walls).	<ul style="list-style-type: none"> • The filter is full or dirty: clean it. • The filter is clogged: change it. • Even though the water seems clear, microscopic algae are present in your pool, they are not visible to the naked eye, and they make the sides slippery and prevent the device from climbing. Carry out shock chlorination and slightly reduce the pH. Do not leave the device in the water during shock treatment.
The device does not perform any movements on start-up.	<ul style="list-style-type: none"> • Check that the control box's power socket is receiving a power supply. • Check that a cleaning cycle has been launched and that the lights are on.
The cable gets tangled	<ul style="list-style-type: none"> • Do not unroll the entire length of the cable into the pool. • Place the required length of cable in the pool and spread the rest along the side of the pool.
The control unit does not respond when you press the buttons	<ul style="list-style-type: none"> • Unplug the cable from the mains socket, wait 10 seconds and plug it back in again.
The screen displays the  message when the remote control mode is active.	<ul style="list-style-type: none"> • This means that the remote control batteries are too low: change them.
The remote control LED is flashing or the LED is on steady.	<p>Remote control range problem:</p> <ul style="list-style-type: none"> • Position the control box on the trolley at least 3.5 metres from the pool. • Orient the control box towards the pool in order to improve the range of the remote control. Ensure there are no large obstacles between the control box and the pool.
The remote control LED is on steady.	<ul style="list-style-type: none"> • Synchronisation problem: repeat the synchronisation steps (see § “3.8.4 Synchronising the remote control with the control box”).

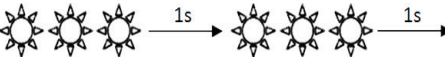
5.2 I User alerts

User alerts (depending on the model)		Solutions
Flashing LED: 	Error code: 	
	Er: 10	<ul style="list-style-type: none"> Check that the cleaner is correctly connected to the control box. If necessary, unplug it and reconnect it following the appropriate procedure.
	Er: 02 Er: 03 Er: 05 Er: 06	<ul style="list-style-type: none"> Check that there is nothing preventing the brushes and wheels from turning. To do so, turn the wheels (1/4 turn) to release any debris that may be jammed.
	Er: 07 Er: 08	<ul style="list-style-type: none"> Cleaner operating outside the pool. Make sure you start the cleaner when it is in the water (see § "3.3 Immersing the cleaner").
	Er: 01 Er: 04	<ul style="list-style-type: none"> Check that there are no stones or hair in the propeller. Clean or change the filter if necessary.

5.2.1 Error codes

- Pressing a key deletes the error code and turns off the control box.
- The screen switches to standby after 10 minutes. To turn the screen back on, just press any key.
- When an error is detected, the control box temporarily suspends the programme (the  LED is turned off).
- Press and hold the  key to revalidate the current programming.

5.3 I Pre-diagnostic menu (depending on the model)

- Stopping the device if a cleaning cycle is in progress.
- To access the menu:

OV 3500 - OV 3510 - RV 4550 - Vortex™ 4 PLUS

Press  for at least 5 seconds.

RV 4560 - RV 5400 - RV 5470 - RV 5500 - RV 5600

Press  +  for at least 5 seconds

- The device status information scrolls:

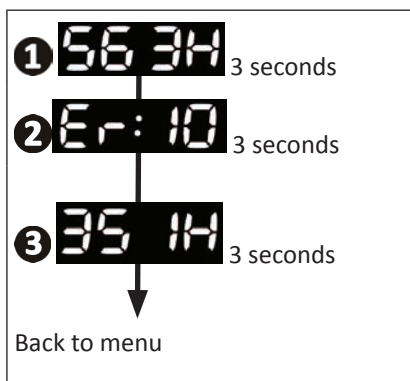

- The total operating time (in hours)
- The last error code (if the cleaner has had at least one error)
- The operating time during the error (if the cleaner has had at least one error)



Tip: if you require assistance, inform the reseller about the device's condition

Votre revendeur
Your retailer

Modèle appareil
Appliance model

Numéro de série
Serial number

Trouvez plus d'informations et enregistrez votre produit sur
More informations and register you product on

www.zodiac.com

