

# Vortex<sup>™</sup>

**Installation and user manual** - English  
Electric cleaner  
Translation of the original instructions in French

**EN**

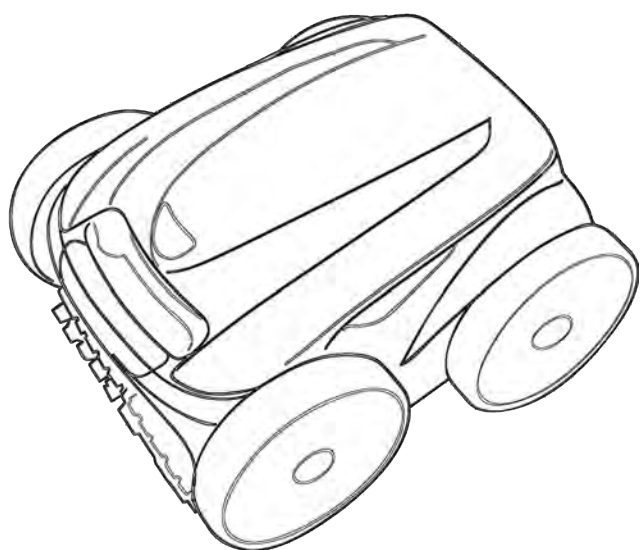

More documents on:  
[www.zodiac.com](http://www.zodiac.com)

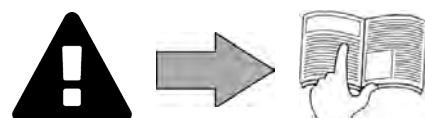



## WARNINGS

### GENERAL WARNINGS

- Failure to respect the warnings may cause serious damage to the pool equipment or cause serious injury, even death.
- Only a person qualified in the technical fields concerned (electricity, hydraulics or refrigeration) is authorised to carry out maintenance or repair work on the appliance. The qualified technician working on the appliance must use/wear personal protective equipment (such as safety goggles and protective gloves, etc.) in order to reduce the risk of injury occurring when working on the appliance.
- Before handling the machine, ensure that it is switched off and isolated.
- The appliance is intended to be used with pools for a specific purpose; it must not be used for any purpose other than that for which it was designed.
- This appliance is not intended for use by children.
- This appliance is not intended for use by individuals (including children, over the age of 8) lacking in experience or with impaired physical, sensory or mental capabilities, unless:
  - they receive supervision and are instructed on how to use the appliance by a person responsible for their safety; and
  - if they understand the hazards involved.
- Children must be supervised to ensure that they do not play with the appliance.
- Cleaning and maintenance operations must not be carried out by children without adult supervision.
- The appliance must be installed according to the manufacturer's instructions and in compliance with local standards in force. The installer is responsible for installing the appliance and for compliance with national installation regulations. Under no circumstances may the manufacturer be held liable in the event of failure to comply with applicable local installation standards.
- For any work other than the simple user maintenance described in this manual, the product should be referred to a qualified professional.
- Incorrect installation and/or use may cause serious damage to property or serious injuries (possibly causing death).
- All equipment, even postage and packing paid, travels at the risks and perils of the recipient. The latter shall issue reserves in writing on the carrier's delivery slip if damage is detected, caused during transport (confirmation to be sent to the carrier within 48 hours by registered letter). In the event that an appliance containing refrigerant has been turned on its side, mention your reservations in writing to the carrier.
- If the appliance suffers a malfunction, do not try to repair it yourself; instead contact a qualified technician.
- Refer to the warranty conditions for details of the permitted water balance values for operating the appliance.
- Deactivating, eliminating or by-passing any of the safety mechanisms integrated into the appliance shall automatically void the warranty, in addition to the use of spare parts manufactured by unauthorised third-party manufacturers.
- Do not spray insecticide or any other chemical (flammable or non-flammable) in the direction of the appliance, as this may damage the body and cause a fire.
- Do not touch the fan or moving parts and do not place a rod or your fingers in the vicinity of the moving parts during operation of the appliance. Moving parts can cause serious injury or even death.

## **WARNINGS ASSOCIATED WITH ELECTRICAL APPLIANCES**

- The power supply to the appliance must be protected by a dedicated 30 mA residual current device, complying with the standards and regulations in force in the country in which it is installed.
- Do not use any extension lead when connecting the appliance; connect the appliance directly to a suitable power supply.
- Before carrying out any operations, check that:
  - The required input voltage indicated on the appliance information plate corresponds to the mains voltage;
  - The mains supply is compatible with the appliance's electricity needs and is correctly grounded;
  - The plug (where applicable) is compatible with the socket.
- In the event of abnormal operation or the release of odours from the appliance, turn it off immediately, unplug it from its power supply and contact a professional.
- Before servicing or performing maintenance on the appliance, check that it is powered off and completely disconnected from the power supply.
- Do not disconnect and reconnect the appliance to the power supply when in operation.
- Do not pull on the power cord to disconnect it from the power supply.
- If the power cord is damaged, it must be replaced by the manufacturer, an authorised representative or a repair facility only.
- Do not perform maintenance or servicing operations on the appliance with wet hands or if the appliance is wet.
- Before connecting the appliance to the power supply, check that the connection unit or socket to which the appliance will be connected is in good condition and shows no signs of damage or rust.
- For any component or sub-assembly containing a battery: do not recharge or dismantle the battery, or throw it into a fire. Do not expose it to high temperatures or direct sunlight.
- In stormy weather, disconnect the appliance from the power supply to prevent it from suffering lightning damage.
- Do not immerse the appliance in water (with the exception of cleaners) or mud.

## **SPECIFIC FEATURES APPLICABLE TO "Pool cleaners"**

- The cleaner is designed to operate properly in pool water at a temperature of between 15°C and 35°C.
- To avoid possible injury or damage to the cleaner, do not operate the cleaner out of the water.
- In order to prevent possible injury, bathing is prohibited when your cleaner is in the pool.
- Do not use the cleaner during shock chlorination.
- Do not leave the cleaner unattended for an extended period.





## **WARNING ON THE USE OF A CLEANER IN A POOL WITH A VINYL SURFACE:**

- Before installing your new cleaner, carefully inspect the lining of your pool. If the liner has eroded in some areas, or if you notice gravel, folds, roots or corrosion caused by metal beneath the liner, or if you notice that the surface (bottom and walls) is damaged, do not install the cleaner before performing the necessary repairs or before having the liner replaced by a qualified professional. The manufacturer may not be held liable in any way for damage caused to the liner.
- The surface of certain vinyl patterned surfaces can wear rapidly and the patterns disappear on contact from objects such as cleaning brushes, toys, inflatable buoys, chlorine distributors and automatic pool cleaners. The decoration on some vinyl surfaces can be scratched or worn by basic friction such as through the use of a pool brush. The colours of certain patterns can also be erased during use or when in contact with objects in the pool. The manufacturer of the pool cleaner may not be held liable for the erased patterns, wear or scratching of vinyl surfaces, which are not covered by the limited warranty.



- Before handling the appliance, it is vital that you read this installation and user manual, as well as the "warnings and warranty" booklet delivered with the appliance. Failure to do so may result in material damage or serious or fatal injury and will void the warranty.
- Keep and pass on these documents for reference during the appliance's service life.
- The distribution or modification of this document in any way is prohibited, without prior authorisation from Zodiac®.
- Zodiac® is constantly developing its products to improve their quality. The information contained herein may therefore be modified without notice.

## CONTENTS

	<b>1 Specifications</b>	<b>5</b>
1.1   Description		5
1.2   Technical specifications and parts list		7
	<b>2 Installation</b>	<b>8</b>
2.1   Set-up		8
2.2   Attachment to the base or caddy assembly (depending on model)		8
	<b>3 Use</b>	<b>10</b>
3.1   Operating principle		10
3.2   Pool preparation		10
3.3   Immersing the cleaner		10
3.4   Electricity supply connection		11
3.5   Starting the cleaning cycle		12
3.6   Ending the cleaning cycle		13
3.7   Setting the time and programming the cleaning cycles (depending on the model)		14
3.8   The remote control (depending on the model)		16
	<b>4 Maintenance</b>	<b>17</b>
4.1   Cleaning the cleaner		17
4.2   Cleaning the filter		17
4.3   Cleaning the propeller		18
4.4   Replacing the brushes		19
4.5   Changing the tyres		20
	<b>5 Troubleshooting</b>	<b>21</b>
5.1   Appliance behaviour		21
5.2   User alerts		22
5.3   Pre-diagnostic menu (depending on the model)		23



**Tip: to make it easier to contact your retailer**

Write down your retailer's contact details to help you find them more easily and fill in the "product" information on the back of the manual; your retailer will ask you for this information.



# 1 Specifications

## 1.1 | Description

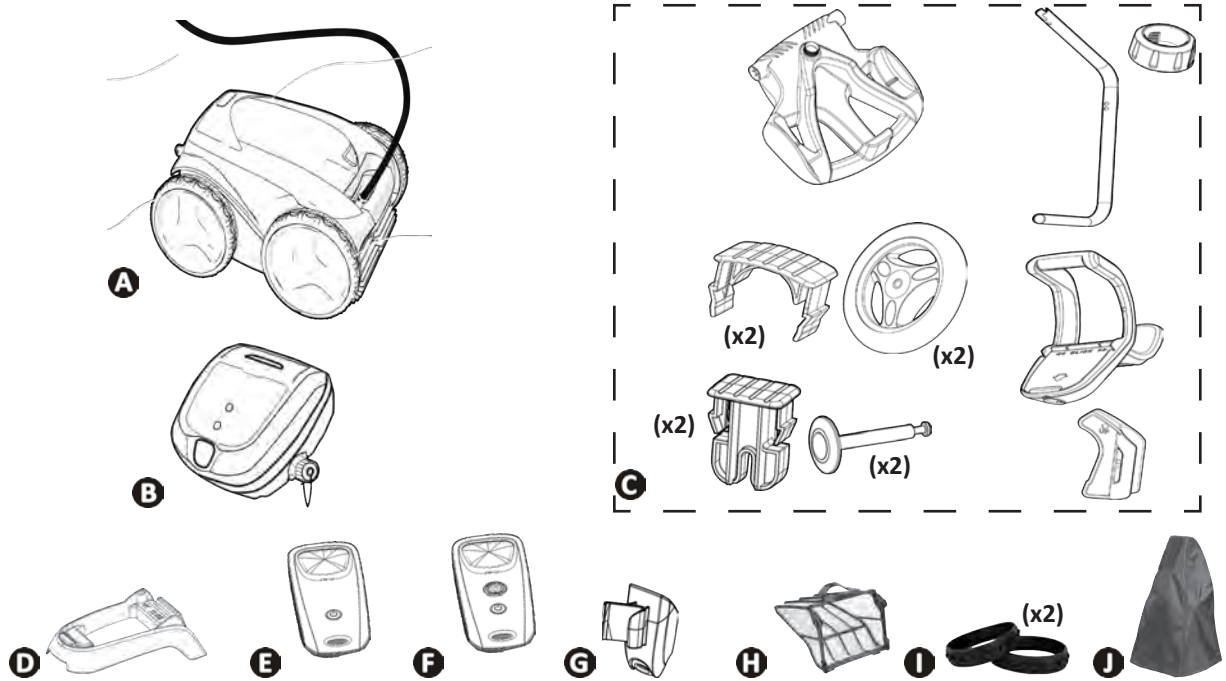

		OV 33xx RV 42xx Vortex™ PS2 Vortex™ 205	AV 34xx GV 34xx OV 34xx RV 43xx RV 44xx Vortex™ 3 PLUS	AV 35xx GV 35xx OV 35xx Vortex™ 4 PLUS Vortex 305	RV 45xx	OV 52xx OV 53xx OV 54xx RV 53xx RV 54xx RV AQ54 RV CA54 Vortex™ PS 400	RV 55xx RV 56xx
A	Cleaner + floating cable	✓	✓	✓	✓	✓	✓
	Front driving wheels (2WD)	✓	✓	✓	✓		
	Front/rear driving wheels (4WD)					✓	✓
B	Control box	✓	✓	✓	✓	✓	✓
C	Caddy kit	+	✓	✓	✓	✓	✓
D	Base for control box	✓					
E	Kinetic remote control			✓			
F	Kinetic remote control "Remove from pool mode"				✓		✓
G	Remote control support			✓	✓		✓
H	100µ fine debris filter	✓	✓	✓	✓	✓	✓
	200µ large debris filter	+	+	+	+	+	+
	60µ very fine debris filter						
I	Front "tiling" tyres	+ / ✓ (GV 3420, GV 3520, Vortex PS 200, Vortex 205, Vortex 305, OV 3310, OV 3480, OV 3505, OV 3510, AV 348 50, AV 350 50)					
J	Protective cover	+ / ✓ (RV 4460)					

✓: Supplied +: Available as an option

Symbol	Description	OV 3300 OV 3310 OV 3400 Vortex™ PS 200 RV 4200 RV 4310 Vortex™ 205	AV 348 50 GV 3420 OV 3410 OV 3450 OV 3480 RV 4390 Vortex™ 3 PLUS	AV 350 50 GV 3520 OV 3500 OV 3505 OV 3510 Vortex™ 4 PLUS Vortex™ 305	RV 4400 RV 4430 RV 4460	RV 4550	RV 4560	OV 5200 OV 5300 OV 5330 OV 5345 OV 5390 RV 5300	OV 5410 OV 5430 OV 5460 RV 5380 RV 5450 RV AQ54 RV CA54 Vortex™ PS 400	RV 5400 RV 5470	RV 5500 RV 5600
	Start/ Stop the appliance	✓	✓	✓	✓	✓	✓	✓	✓	✓	✓
	"Control" indicator	✓	✓		✓			✓			
	"Clean filter" indicator				✓	✓	✓	✓	✓	✓	✓
	Remove from pool mode				✓	✓	✓		✓	✓	✓
	<b>Surface to be cleaned</b>		✓	✓	✓	✓	✓	✓	✓	✓	✓
	Bottom only		✓	✓	✓	✓	✓	✓	✓	✓	✓
	Bottom + walls + water line		✓	✓	✓	✓	✓	✓	✓	✓	✓
	Water line only										✓
	<b>Pool shape</b>										✓
	Flat bottomed rectangular										✓
	Other shapes, other bottoms										✓
	<b>Cleaning intensity</b>										✓
	Low intensity										✓
	Intensive										✓
	<b>Cleaning cycle programming</b>						✓			✓	✓
	Increase or reduce the cleaning time			✓		✓					
	Switch on/off the remote control			✓		✓	✓				✓

EN

✓: Available

## 1.2 I Technical specifications and parts list

### 1.2.1 Technical specifications

	OV 3300 OV 3310 RV 4200 Vortex™ 205 Vortex™ PS 200	AV 348 50 - AV 350 50 - GV 3420 - GV 3520 - OV 3400 - OV 3410 - OV 3450 - OV 3480 - OV 3500 - OV 3505 - OV 3510 - OV 5200 - OV 5300 - OV 5330 - OV 5345 - OV 5390 - OV 5410 - OV 5430 - OV 5460 - RV AQ54 - RV CA54 - RV 4310 - RV 4390 - RV 4400 - RV 4430 - RV 4460 - RV 5300 - RV 5380 - RV 5400 - RV 5470 - Vortex™ 3 PLUS - Vortex™ 4 PLUS - Vortex™ 305 Vortex™ PS 400	RV 4550 RV 4560 RV 5500	RV 5600
Control box power supply	220-240 VAC, 50 Hz			
Cleaner power supply	30 VDC			
Maximum power input	150 W			
Cable length	15 m	18 m	21 m	25 m
Cleaner size (L x W x h)	43 x 48 x 27 cm			
Package dimensions (L x W x h)	69 x 43 x 46 cm	56 x 56 x 46 cm		
Cleaner weight (without cable)	10.2 kg			
Packaged weight	14 kg	19 kg		
Theoretical cleaning width	270 mm			
Pump flow	16 m <sup>3</sup> /h			

### 1.2.2 Parts list

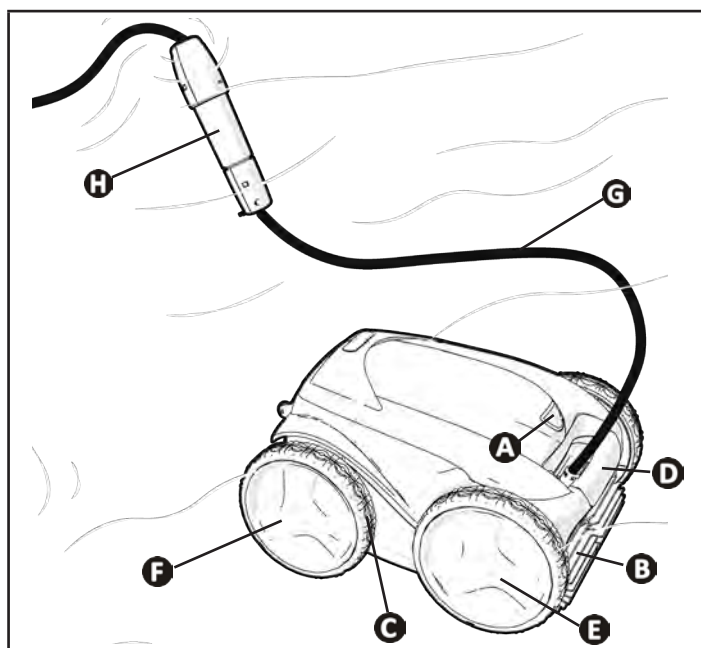

- A**: Filter access hatch lock
- B**: Brushes
- C**: Tyres
- D**: Transport and remove-from-pool handle
- E**: Front driving wheels
- F**: Rear driving wheels (depending on the model)
- G**: Floating cable
- H**: Swivel (depending on the model)





## 2 Installation

### 2.1 I Set-up

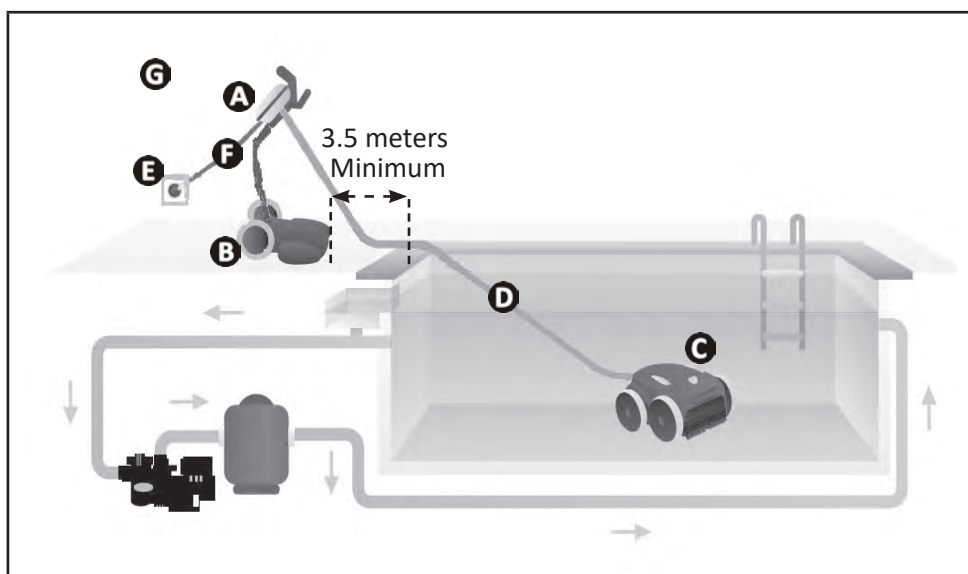

- A**: Control box
- B**: Caddy
- C**: Cleaner
- D**: Floating cable
- E**: Plug
- F**: Power cord

EN

### 2.2 I Attachment to the base or caddy assembly (depending on model)

#### 2.2.1 Attachment to the base

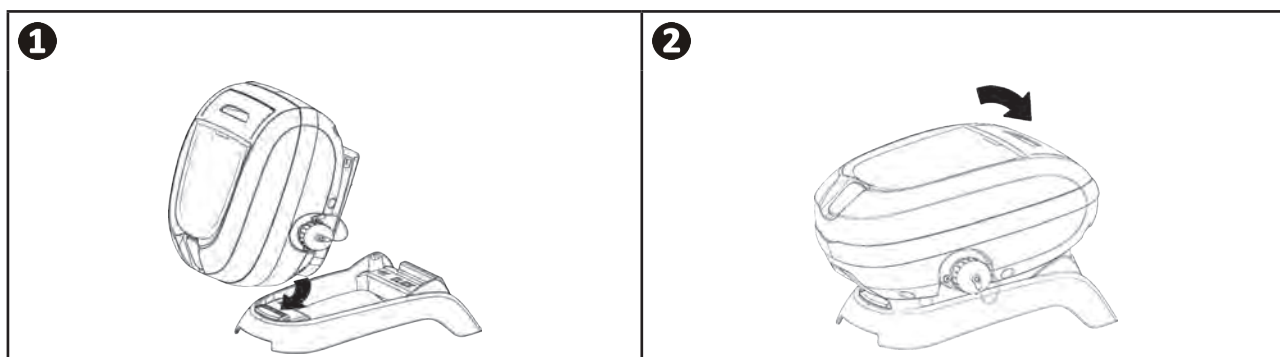

## 2.2.2 Caddy assembly



Tool-free assembly

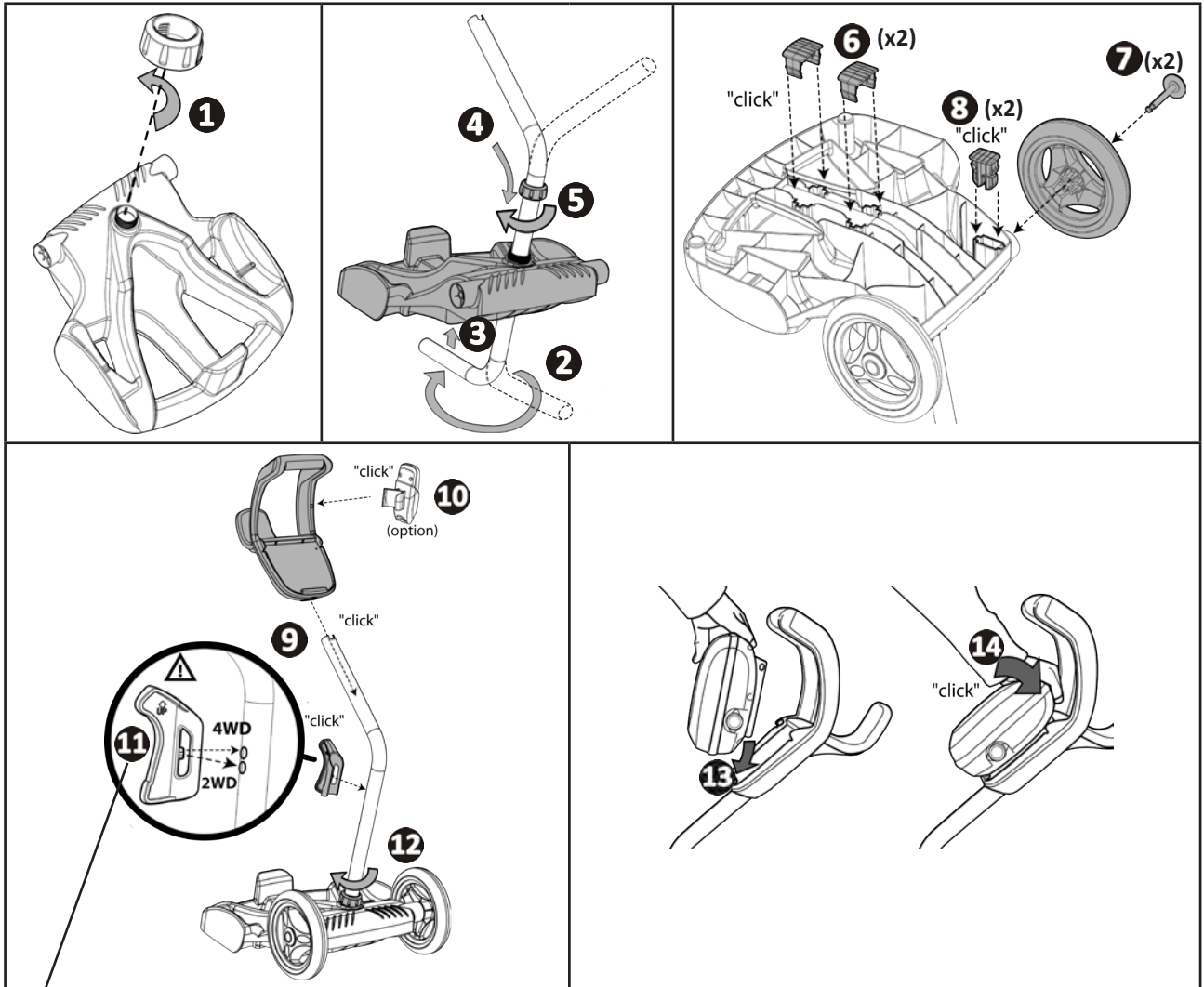

**11** For the number of driving wheels (2WD or 4WD), see: "1.1 | Description"



## 3 Use

### 3.1 | Operating principle

The cleaner is separate from the filtration system and can function independently. It simply needs connecting to the mains.

It finds the best route to move around and clean the areas of the pool for which it has been designed (depending on the model: bottom, walls, water line). Debris is sucked in and stored in the cleaner's filter.

The control box enables the cleaning operations to be started, selected and programmed (depending on the model).

EN

### 3.2 | Pool preparation



- This product is intended to be used in pools which are permanently installed. Do not use it in pools which may be dismantled. A permanent pool is built into the ground or on the ground and cannot be easily dismantled and stored.

- The appliance must operate in pool water with the following properties:

Water temperature	Between 15°C and 35°C
pH	Between 6.8 and 7.6
Free chlorine	< 3 mg/l

- When the pool is dirty, especially when commissioning, remove the largest debris using a net in order to optimise the appliance's performances.
- Remove any thermometers, toys and other objects that might damage the appliance.

### 3.3 | Immersing the cleaner

- Roll out the full length of the cable alongside the pool to avoid the cable becoming tangled during immersion (see figure 1).
- Place the cleaner vertically into the water (see figure 2).
- Move it slightly in all directions so that the air contained in the cleaner escapes (see figure 3).
- It is essential that the appliance sinks on its own and settles on the pool bottom. While it is immersed, the cleaner draws the length of cable it needs into the pool (see figure 4).

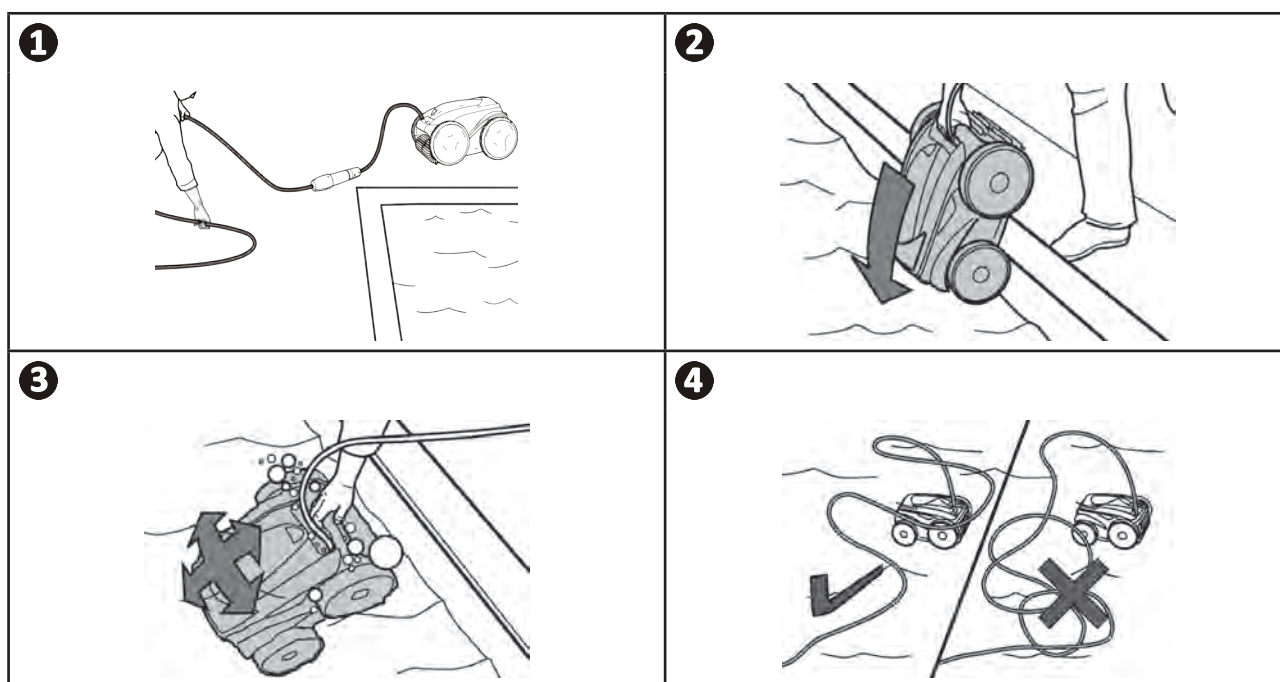

### 3.4 I Electricity supply connection

To prevent all risks of electrocution, fire or serious injury, please comply with the following instructions:



- Use of an electrical extension is prohibited when connecting the control box.
- Make sure that the socket can be easily accessed at all times and is protected from rain or splashes.
- The control box is splash-proof, but must not be immersed in the water or any other liquid. It must not be installed in a floodable area; keep it at least 3.5 metres away from the edge of the pool and avoid exposing it to direct sunlight.
- Place the control box near the socket.

- Unscrew the protective cap (see figure 1).
- Connect the floating cable to the control box and lock it in place by turning the ring only in the clockwise direction (to prevent damage to the floating cable) (see figure 2, 3).
- Make sure that the connector is fully pushed in so that no water can get in (see figure 4).
- Connect the power cord (see figure 5). Only connect the control box to a power outlet protected by a 30 mA maximum residual current device (if in doubt contact a qualified technician).

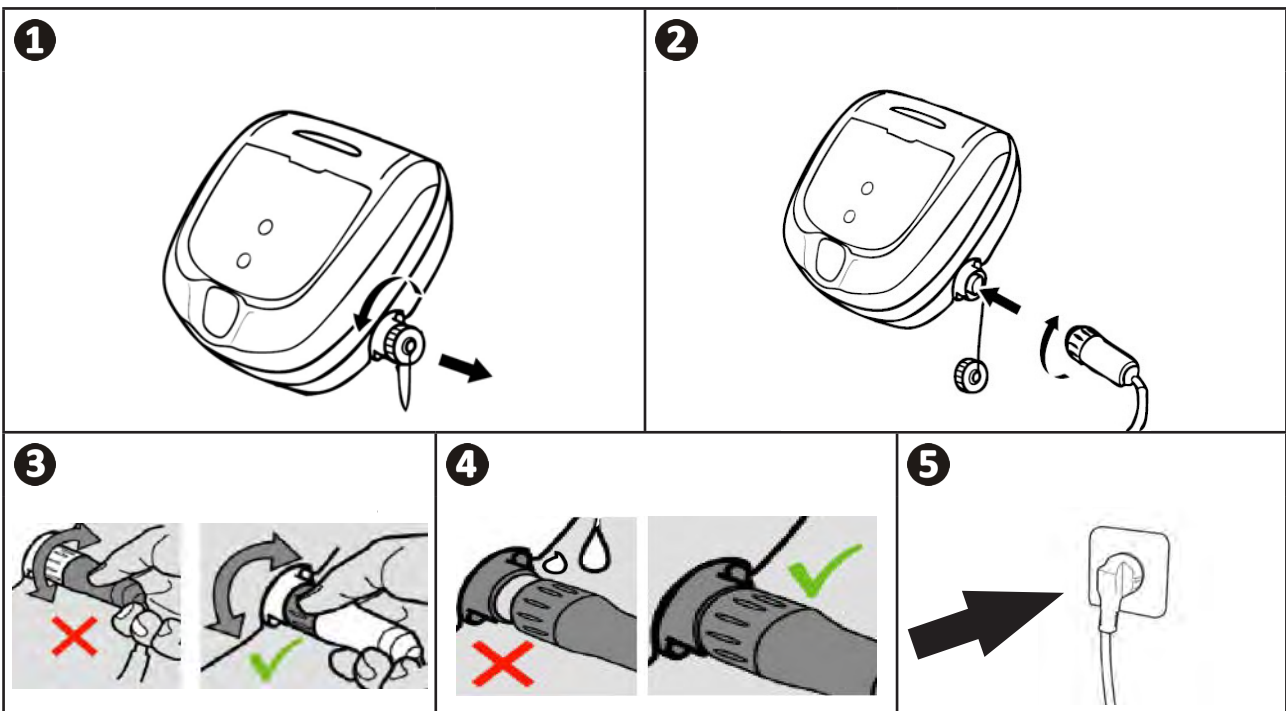

**Tip: choose the location of the control box carefully to prevent the cable from becoming tangled**

Place the control box halfway along the length of the pool, in accordance with the safety conditions relating to the electrical connection. This lets you limit the length of the floating cable to be put into the water to cover the pool, which simplifies set-up and storage operations.

## 3.5 I Starting the cleaning cycle



To prevent all risks of injury or equipment damage, comply with the following directives:







- Bathing is prohibited when the appliance is in the pool.
- Do not use the appliance during shock chlorination.
- Do not leave the appliance unattended for an extended period.
- Do not use the appliance if the roller shutter is closed.

- When the control box is powered up, the following symbols light up to indicate:
  - The action in progress
  - The cleaning mode selected
  - that maintenance is required
- The control box switches to standby after 10 minutes and the screen is switched off. Press any key to exit standby mode. Standby mode does not stop the appliance if it is in a cleaning cycle.

EN

### 3.5.1 Cleaning cycle selection (depending on model)

- A cleaning cycle is already configured by default: the symbols are on and the cleaning time appears on the screen, for example: **0:45** (depending on the model).
- The cleaning cycle can be selected at any time, before the appliance starts or while it is operating. The new cycle will be launched instantly and the remaining time countdown will be reinitialised.
- The cleaner adapts its movement strategy depending on the choice in order to optimise coverage.

Surface to be cleaned	Pool shape	Cleaning intensity
 Bottom only	 Other shapes, other bottoms	 Low intensity
 Bottom + walls + water line	 Flat bottomed rectangular	 Intensive
 Water line only		

### 3.5.2 Launching the cleaning cycle



- Press 



#### Tip to improve cleaning performance

At the start of the bathing season, launch several cleaning cycles in bottom-only mode (after removing large debris with a net). Regular use of the cleaner (without exceeding 3 cycles per week) means that your pool will always be clean and the filter less clogged.

### 3.5.3 Adjusting the cleaning time (depending on model)





- You may reduce or increase the time for the cleaning cycle selected or in progress:
  - : Reduce by 30 minutes.
  - : Increase by 30 minutes.
- Press  to confirm.

## ➤ 3.6 I Ending the cleaning cycle



- To prevent damage to the equipment:

- Do not pull on the cable to remove the appliance from the pool. Use the handle.
- Do not leave the appliance to dry out in sunlight after use.
- Store all the elements away from sunlight, humidity and bad weather.
- Screw the protective cap back on if you unplug the control box power cord.

- Switch off the appliance by pressing .
- When the cleaner is within arm's reach, pick it up by the handle and lift it gently out of the pool so that the water it contains drains into the pool (see figure .
- Place the cleaner vertically in the location provided on the caddy (depending on the model) for it to dry out quickly (see figure .
- Then store it with the control box away from sunlight and any splashes. A protective cover is available as an optional extra (see figure .

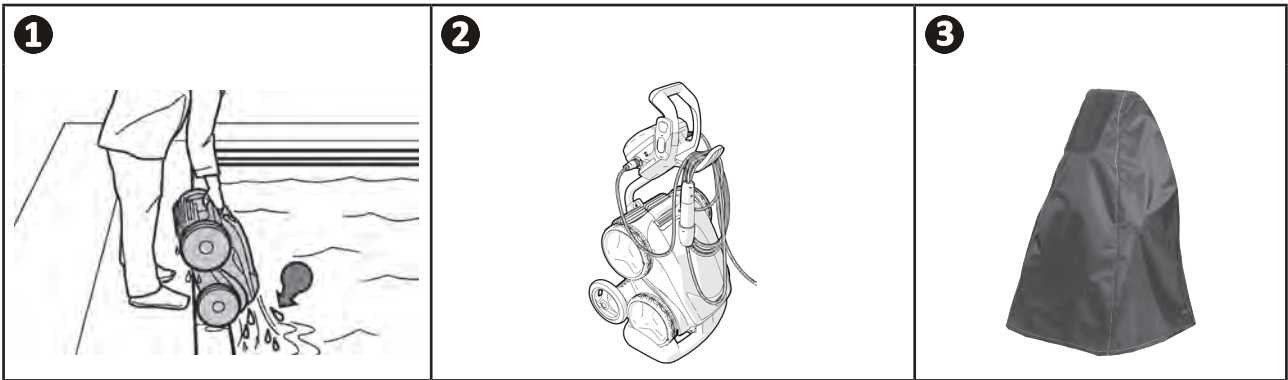

### 3.6.1 "Remove from pool" mode (depending on the model)

This function enables the cleaner to return to an exact point at the edge of the pool. When it climbs the wall, the cleaner sprays a jet of water behind it to make it lighter as it exits the pool.

- Direct the cleaner towards the required pool wall, then make it climb to the water line: hold  down to rotate it. The cleaner moves towards the wall when you release the button.



#### **Tip to prevent the floating cable from becoming tangled**

The cleaner's behaviour is strongly impacted by the tangling of the cable. A cable that is correctly untangled will guarantee better coverage of the pool.

- Untangle the cable and lay it out in the sun so that it returns to its original shape.
- Then wind it up carefully and place it on the caddy handle (depending on the model) or on a fixed support.

### 3.7.1 Setting the time and programming the cleaning cycles (depending on the model)



- Do not disconnect the power cable once the time has been programmed or you will lose it. The time setting will be saved for approximately 2 minutes if the power supply is disconnected.

#### 3.7.1 Setting the time

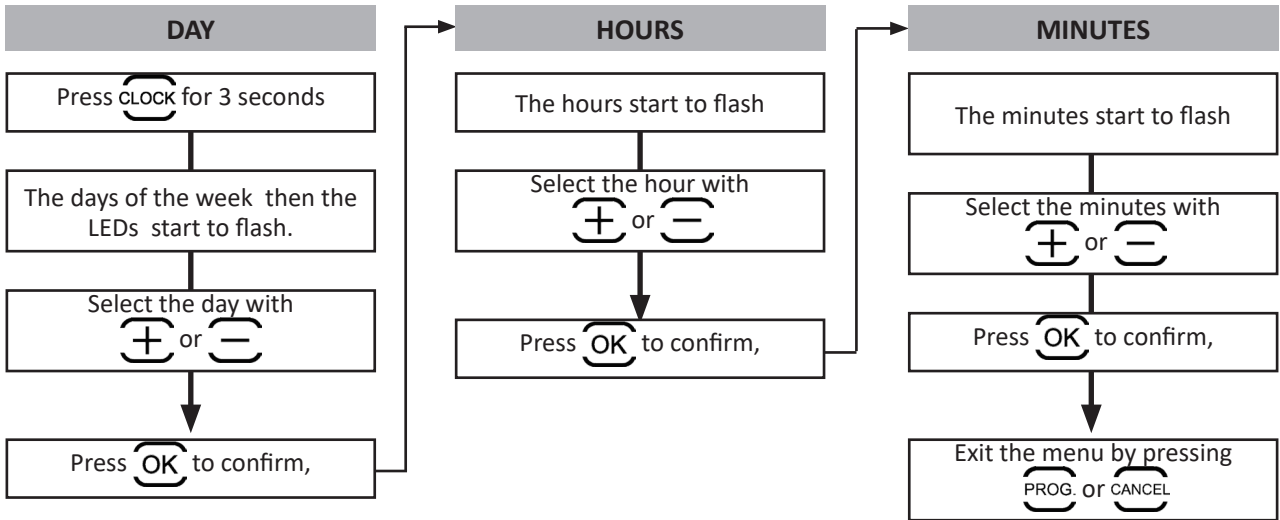

EN



**Tip: check the time setting**

Stopping the appliance if a cleaning cycle is in progress. Press . The time is displayed for 5 seconds.

### 3.7.2 Programming cleaning cycles

Program **up to 7 cleaning cycles** (for example, 2 days per week: Wednesdays and Saturdays over 4 weeks).

- You must set the time before you program the cleaning cycles, see § “3.7.1 Setting the time”.
- Start by selecting the cleaning cycle on the control box, see § “3.5.1 Cleaning cycle selection (depending on model)”.
- Then program the days, hours and minutes.

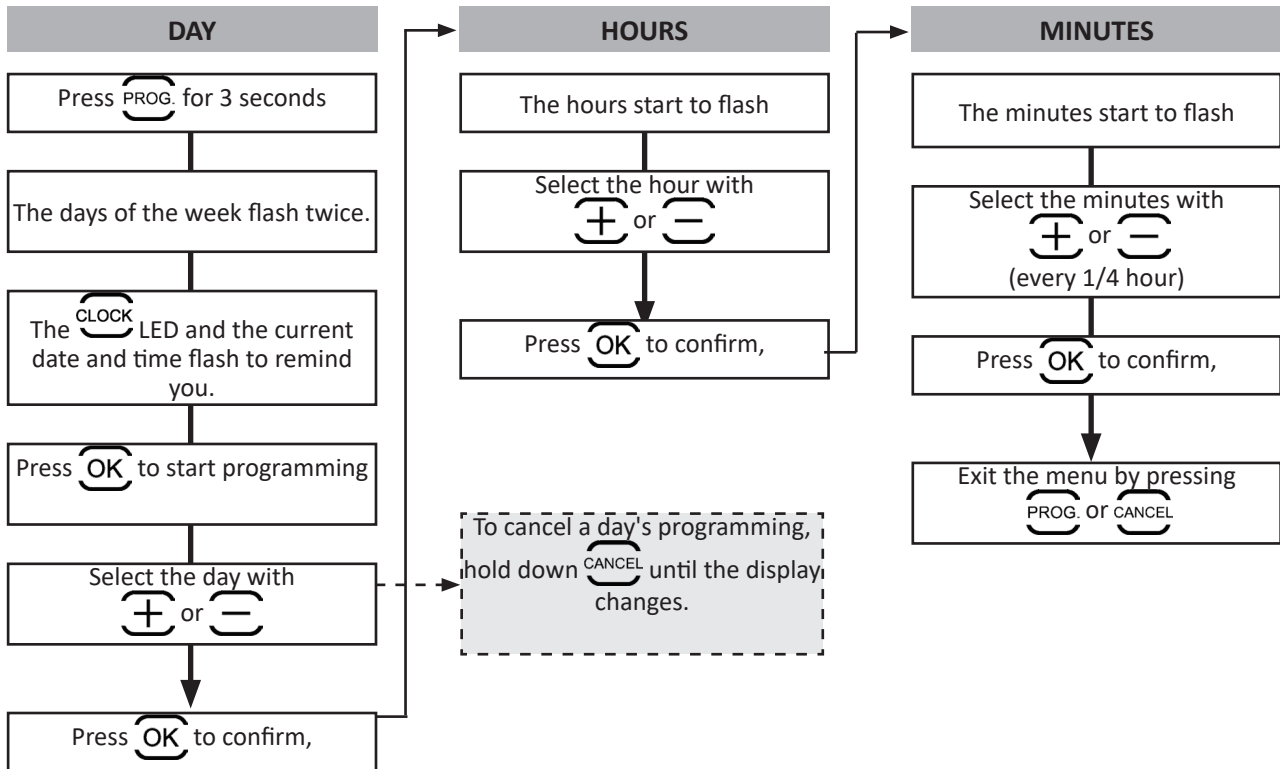

- The programming stops automatically at the end of the 7<sup>th</sup> cleaning cycle and the LED **PROG.** switches off.
- To cancel ALL the programming, exit the menu **PROG.** and hold down **CANCEL** until the display changes.



**Tip: check the programming**

Press **PROG.** Each programming is displayed for 3 seconds.





### 3.8 I The remote control (depending on the model)



- Respect the battery polarity.
- Do not recharge the battery, dismantle it or throw it onto a fire.
- Do not expose it to high temperatures or direct sunlight.

#### 3.8.1 Switching the remote control on and off

- To switch on: press .
- To switch off: press and hold .



**Tip: improve the remote control reception.**

The frequency of the flashing of the led located on the remote control indicates the reception quality. If the LED flashes quickly, reception quality is OK.

For the best communication between the control box and the remote control:

- Position the control box on the caddy.
- Turn the control box towards the pool
- Removal all large obstacles between the control box and the pool.

#### 3.8.2 Directing the cleaner

- The remote control is equipped with movement sensors to direct the cleaner:

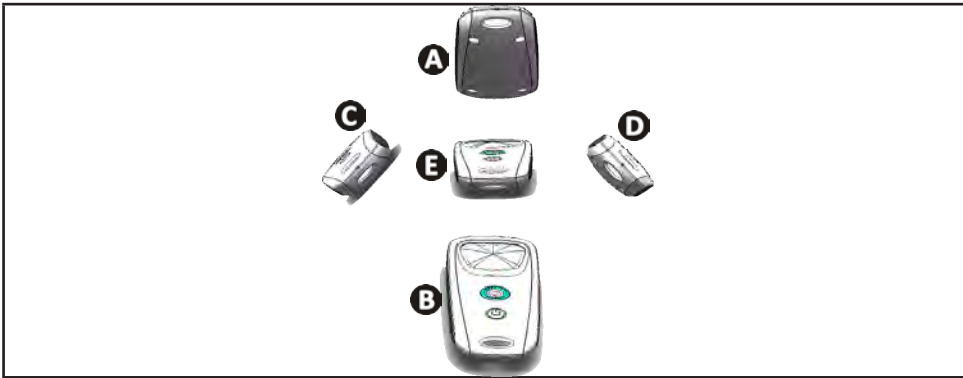



- A**: Forwards
- B**: Backwards
- C**: Left turn
- D**: Right turn
- E**: Stop

#### 3.8 Taking the cleaner out of the water (depending on the model)

- Press . The cleaner moves toward the wall and climbs up to the waterline.

#### 3.8.4 Synchronising the remote control with the control box

By default, the remote control is already synchronised with the control box. If replacing the remote control/control box or if a synchronisation problem occurs, follow the steps below:

- Place the remote control a **maximum of 50 cm** away from the control box.
- Connect the control box, check that the display shows the operating time, and that no cleaning cycle is running.
- Switch on the remote control by pressing .
- Before the remote control switches to standby (around 45 seconds) press the  and  buttons simultaneously for 6 seconds.
- Check that synchronisation was successful by observing the display and the remote LED:

Display on the control box	Remote LED	Result
<b>Good</b> → <b>0:45</b> 2 seconds	Flashing	<ul style="list-style-type: none"> <li>• Synchronisation successful.</li> </ul>
<b>FAIL</b>	On steady	<ul style="list-style-type: none"> <li>• Check that the distance between the control box and the remote control is 50 cm maximum.</li> <li>• Check the remote control batteries. Replace them if necessary. If the problem continues contact your retailer.</li> </ul>



## 4 Maintenance



To avoid serious injury:

- Disconnect the cleaner from the power supply.

### 4.1 | Cleaning the cleaner

- The appliance must be cleaned regularly using clean or slightly soapy water. Do not use solvents.
- Rinse the appliance thoroughly with clean water.
- Do not let your appliance dry in the sun by the pool.



**Tip: replace the filter and brushes every 2 years**

You are encouraged to change the filter and the brushes every 2 years to preserve the integrity of the appliance and guarantee optimum performance.

### 4.2 | Cleaning the filter



- The cleaner's performance may be reduced if the filter is full or dirty.
- Clean the filter regularly with clean water for efficient pool cleaning.
- If the filter is clogged, clean it with an acidic solution (spirit vinegar, for example). It is recommended that you do this at least once a year, since the filter will clog if not used for several months (winterising period).

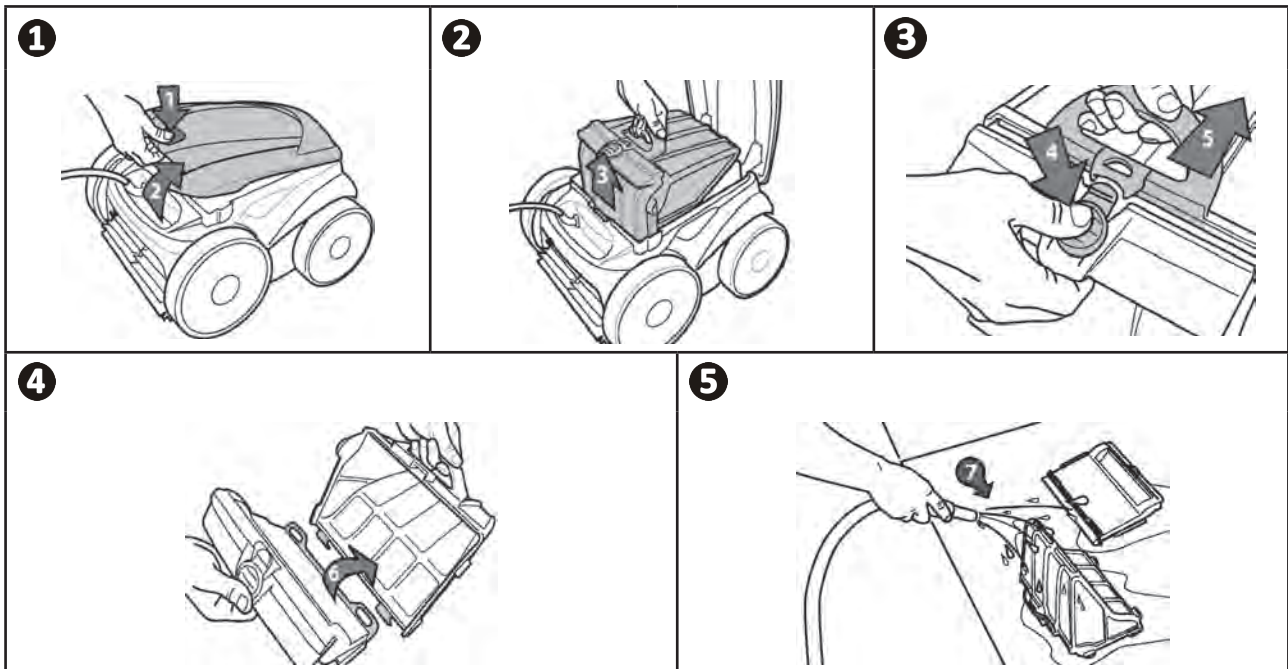

**Tip: Check the status of the "filter cleaning" indicator**  (depending on the model)

We recommend that you clean the filter as soon as the LEDs light up.

### ➤ 4.3 I Cleaning the propeller

To avoid serious injury:



- Disconnect the cleaner from the power supply.

- Wear gloves when maintaining the propeller .

- Loosen the screw on the grid (see figure 1).
- Remove the grid (see figure 2).
- Remove the flow guide carefully (see figure 3).
- To remove the propeller, wear gloves and hold the end of the propeller carefully when pushing it (see figure 4).
- Remove all debris (hair, leaves, stones, etc.) which may be blocking the propeller.

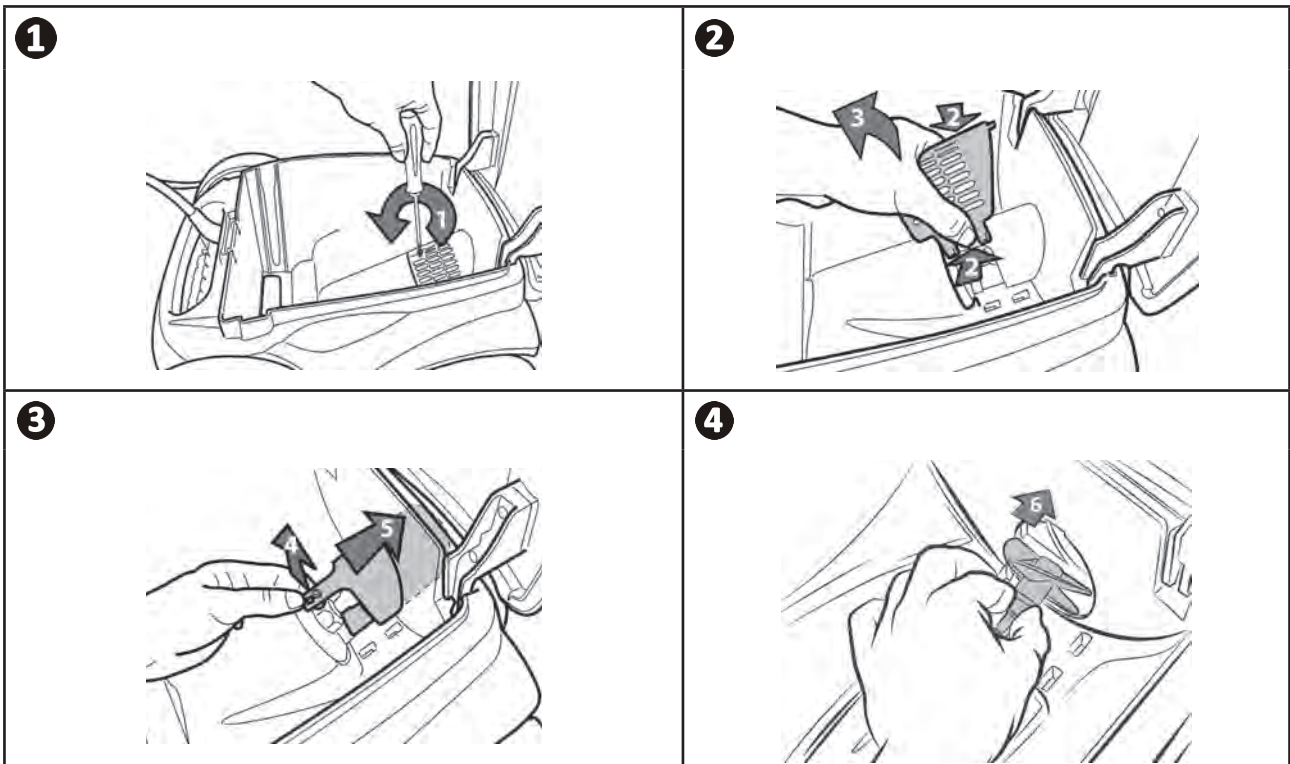

## ➤ 4.4 I Replacing the brushes

- Each brush is equipped with wear indicators; the distance between the indicators and the end of the brush indicates whether the brush is in good condition (see figure 1).
- The brushes are worn and should be replaced when the wear indicators appear as shown in figure 2.
- To remove worn brushes, remove the tabs from the holes in which they are fixed (see figure 3).
- To fit new brushes, start by fitting the side without tabs under the brush holder (see figure 4).
- Roll the brush around its support, slide the tabs into the attachment holes and pull on the end of each tab until its edge passes through the slit (see figure 5).
- Cut the tabs using a pair of scissors for them to be level with the other blades (see figure 6).

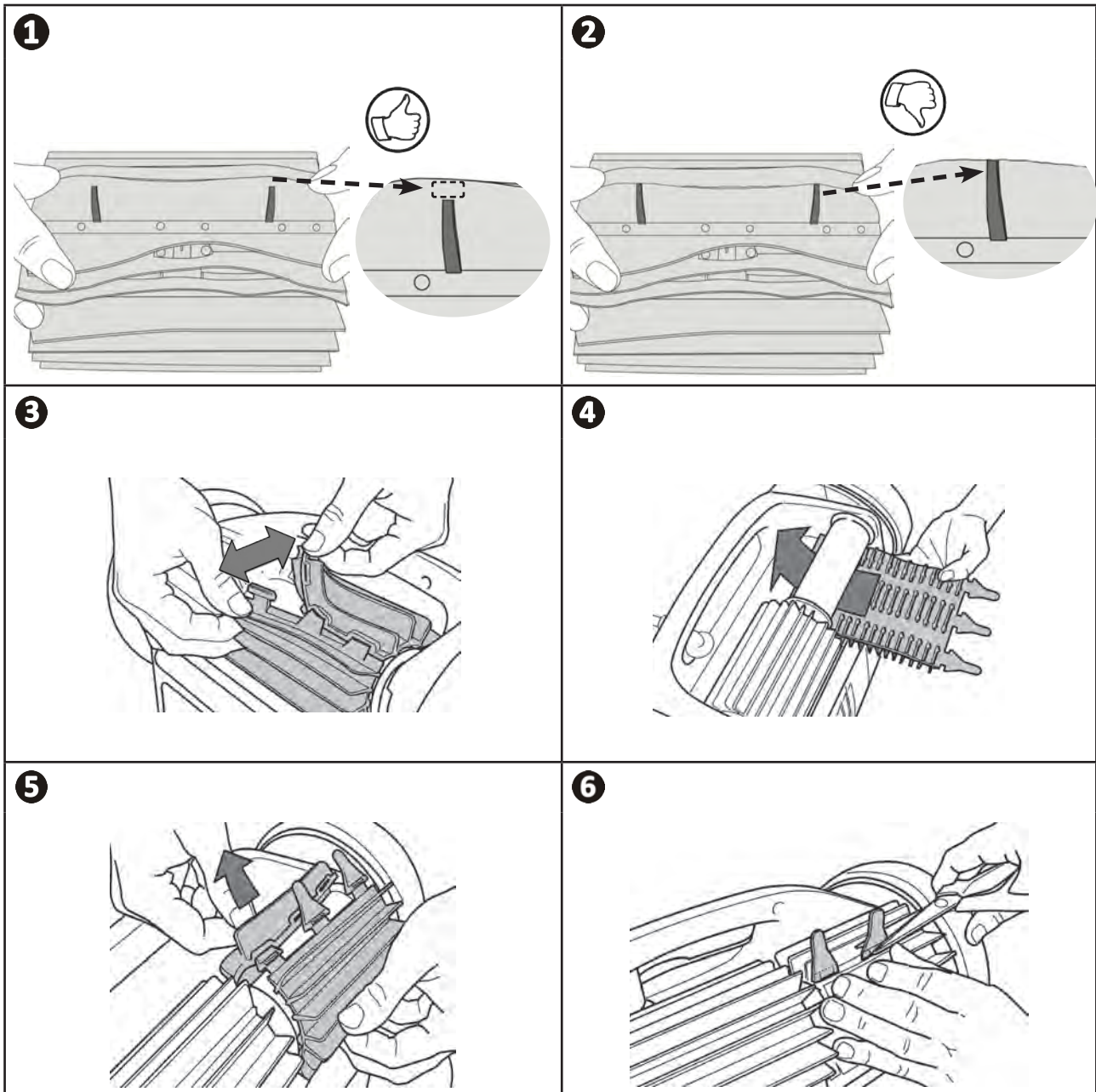

➤ 4.5 I Changing the tyres

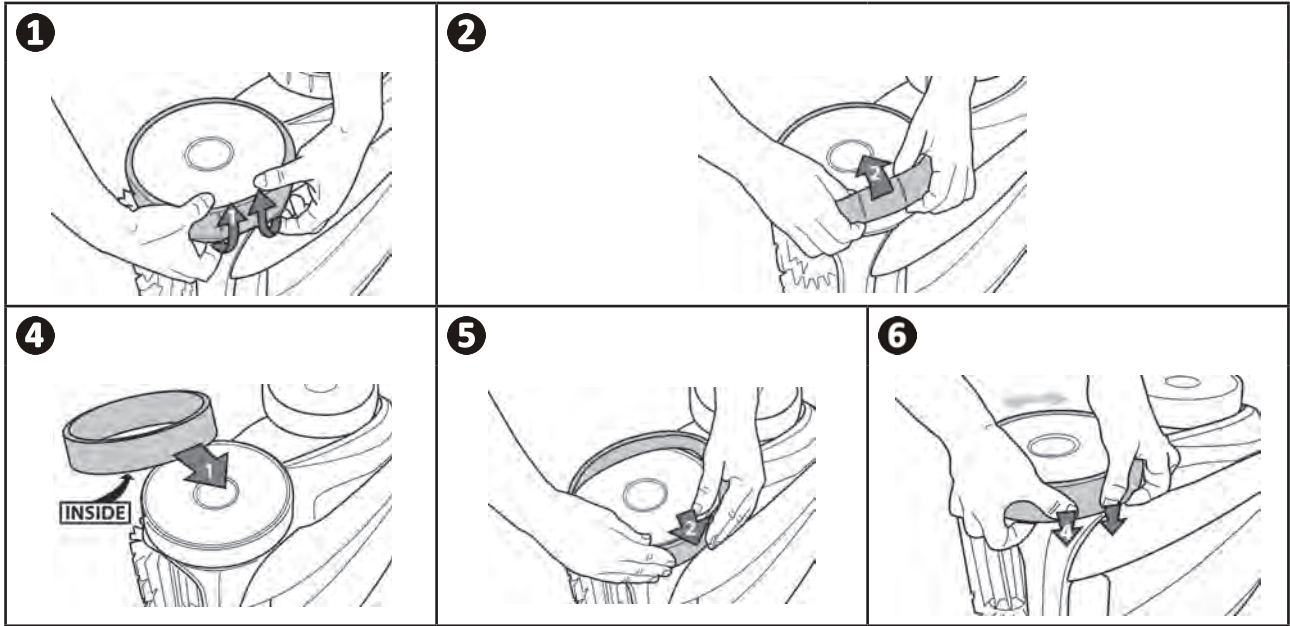

EN







## 5 Troubleshooting





- If a problem occurs, before you contact your retailer, please carry out these few simple checks using the following tables.
- If the problem persists, contact your retailer.
-  : Actions to be performed by a qualified technician only.

### 5.1 I Appliance behaviour

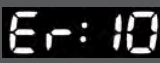
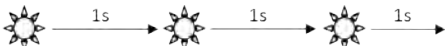

Part of the pool is not correctly cleaned	<ul style="list-style-type: none"> <li>• Repeat the immersion steps (see § “3.3 Immersing the cleaner”), varying the immersion location until you find the right place in the pool.</li> </ul>
The appliance does not stay firmly on the pool bottom	<ul style="list-style-type: none"> <li>• There is still air in the appliance's casing. Repeat the immersion operations (see § “3.3 Immersing the cleaner”).</li> <li>• The filter is full or dirty: clean it.</li> <li>• The filter is clogged: change it.</li> <li>• The propeller is damaged, <b>contact your retailer</b> </li> </ul>
The appliance does not or no longer climbs the pool walls as it originally did. (Its electronic programme means that the appliance does not systematically climb the walls).	<ul style="list-style-type: none"> <li>• The filter is full or dirty: clean it.</li> <li>• The filter is clogged: change it.</li> <li>• Even though the water seems clear, microscopic algae are present in your pool. They are not visible to the naked eye, and they make the walls slippery and prevent the appliance from climbing. Carry out shock chlorination and slightly reduce the pH. <b>Do not leave the appliance in the water during shock treatment.</b></li> <li>• The brushes are worn: check the wear indicators “4.4 I Replacing the brushes”, then turn the brushes to check the rotations. Replace the brushes where necessary.</li> <li>• <b>If the problem continues contact your retailer.</b> </li> </ul>
The appliance does not move on start-up.	<ul style="list-style-type: none"> <li>• Check that the control box's power socket is receiving a power supply.</li> <li>• Check that a cleaning cycle has been launched and that the lights are on.</li> <li>• <b>If the problem continues contact your retailer.</b> </li> </ul>
The cable gets tangled	<ul style="list-style-type: none"> <li>• Do not unroll the entire length of the cable into the pool.</li> <li>• Place the required length of cable in the pool and spread the rest along the side of the pool.</li> </ul>
The cleaner's discharge nozzles or bottom plug holes become blocked	<ul style="list-style-type: none"> <li>• Stop the filter pump and begin a new cleaning cycle.</li> <li>• Place the control box halfway along the length of the pool, in accordance with the safety conditions, see “3.4 I Electricity supply connection”. If cleaning is not optimal, vary the location of the control box and the place at which the cleaner enters the pool.</li> </ul>
The cleaner climbs the walls slowly and stops under the water line  The cleaner climbs the walls quickly and goes past the water line, aspirating air	<ul style="list-style-type: none"> <li>• The cleaner may behave differently depending on the lining of the pool. A parameter may require changing. To do this, <b>contact your retailer.</b> </li> </ul>
The control box does not respond to any button presses.	<ul style="list-style-type: none"> <li>• Unplug the power cord from the mains socket, wait 10 seconds and plug it back in again.</li> </ul>
The screen displays the message  when the remote control mode is active	<ul style="list-style-type: none"> <li>• This means that the remote control batteries are too low: change them.</li> </ul>

<p>The remote control LED is flashing slowly or the LED is steadily lit.</p>	<p>Remote control range problem:</p> <ul style="list-style-type: none"> <li>• Position the control box on the caddy at least 3.5 metres from the pool.</li> <li>• Orient the control box towards the pool in order to improve the range of the remote control. Ensure there are no large obstacles between the control box and the pool.</li> </ul>
<p>The remote control LED is steadily lit.</p>	<ul style="list-style-type: none"> <li>• Synchronisation problem: repeat the synchronisation steps (see §"3.8.4 Synchronising the remote control with the control box").</li> </ul>

➔ 5.2 I User alerts

User alerts (depending on the model)		Solutions
Flashing LED: 	Error code: 	
	<p>Er: 10</p>	<ul style="list-style-type: none"> <li>• Check that the cleaner is correctly connected to the control box. If necessary, unplug it and reconnect it following the appropriate procedure.</li> </ul>
	<p>Er: 02 Er: 03 Er: 05 Er: 06</p>	<ul style="list-style-type: none"> <li>• Check that there is nothing preventing the brushes and wheels from turning. To do so, turn the wheels (1/4 turn) to release any debris that may be jammed.</li> </ul>
	<p>Er: 07 Er: 08</p>	<ul style="list-style-type: none"> <li>• Cleaner operating outside the pool. Make sure you start the cleaner when it is in the water (see § "3.3 Immersing the cleaner").</li> </ul>
	<p>Er: 01 Er: 04</p>	<ul style="list-style-type: none"> <li>• Check that there are no stones or hair in the propeller.</li> <li>• Clean or change the filter if necessary.</li> </ul>

**5.2.1 Error codes**

- Pressing a key deletes the error code and turns off the control box.
- The screen switches to standby after 10 minutes. To turn the screen back on, press any key.
- When an error is detected, the control box temporarily suspends the programme (the  LED is turned off).
- Press and hold the  key to re-confirm the current programming.

### ➤ 5.3 I Pre-diagnostic menu (depending on the model)

- Stopping the appliance if a cleaning cycle is in progress.
- To access the menu:

AV 350 50 - OV 3500 - OV 3505 - OV 3510 -  
RV 4550 - RV 4560 - Vortex™ 4 PLUS - GV 3520

Press  for at least 5 seconds.

RV 5400 - RV 5470 - RV 5500 - RV 5600

Press  +  for at least 5 seconds.

- The appliance status information scrolls:

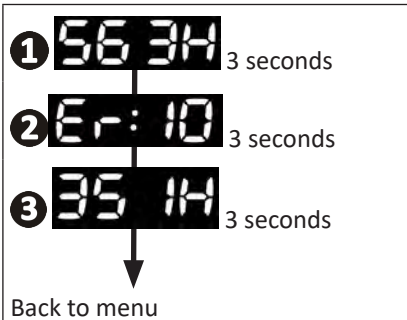

- ➊ The total operating time (in hours)
- ➋ The last error code (if the cleaner has had at least one error)
- ➌ The operating time during the error (if the cleaner has had at least one error)



**Tip: if you require assistance, inform the retailer about the appliance's condition**



#### Recycling

This symbol means that your appliance must not be thrown into a normal bin. It will be selectively collected for the purpose of reuse, recycling or transformation. If it contains any substances that may be harmful to the environment, these will be eliminated or neutralised.

Contact your retailer for recycling information.



Votre revendeur  
*Your retailer*

Modèle appareil  
*Appliance model*

Numéro de série  
*Serial number*

Pour plus d'informations, enregistrement produit et support client :  
*For more information, product registration and customer support:*

**[www.zodiac.com](http://www.zodiac.com)**

