

# DF Through-the-wall



- + Hidden installation without ducts, for simplified project design
- + Available in 3 capacities (3.5 to 8 l/h)
- + Air heating options (electric heating or hot water coil)



## ACCESSORIES INCLUDED IN THE PACK



Hygro control box

## PRODUCT REFERENCES

DF Through-the-wall	DF 403M	DF 405M	DF 405T	DF 408M	DF 408T
Standard Model	W28DF403ME	W28DF405ME	W28DF405TE	W28DF408ME	W28DF408TE
Model with electric heating option	W28DF403MEE	W28DF405MEE	W28DF405TEE	W28DF408MEE	W28DF408TEE
Model with hot water coil option	W28DF403MEB	W28DF405MEB	W28DF405TEB	W28DF408MEB	W28DF408TEB

## TECHNICAL FEATURES

DF Through-the-wall	DF 403M	DF 405M	DF 405T	DF 408M	DF 408T
Capacity (l/h)*	3,5	5		8	
Absorbed power*** (W)	1500	1860		2600	
Air flow (m <sup>3</sup> /h)	1300			1700	
Electric power supply	220-240V / 1 N~ / 50Hz		380-400V / 3N~ / 50Hz	220-240V / 1 N~ / 50Hz	380-400V / 3N~ / 50Hz
Max. absorbed intensity (A)***	13,2	16,1	7,3	24,8	9,5
Refrigerant fluid	R407C				
Refrigerant fluid quantity (kg)	1,18	1,21		1,52	
Evacuation of condensate	PVC 1/2 union, Ø 32, glued				

## ACCESSOIRES EN OPTION

Double deflector supply grate	DF support frame	Remote control electrical unit
WTT02365	WTO04000	W28DEPORT

For all DF orders a deposit of 30% will be requested with the order.

\* Standard unit, in the following nominal conditions: air 30°C, humidity 70%.

\*\*\* Excluding the power consumption of electric heating options.

### HOT WATER COIL SPECIFICATIONS

DF Through-the-wall	DF 403M	DF 405M	DF 405T	DF 408M	DF 408T
Power (kW) with primary at 50-40 °C / 90-70 °C		3,9 / 12,4		4,6 / 14,8	
Water flow (m³/h) with primary at 90/70°C		0,56		0,65	
Load loss (mmCE) with primary 90/70°C		59		81	
Connection (mm)	20 / 27 male thread				

### INSTALLATION

- Installation in a technical room nearby the pool hall.
- Blower and intake grates mounted on the part to be mortared included with the appliance.
- Possibility of double deflector grates to direct the hot dry air towards the windows.
- Hot water coil assembled inside the appliance (option).
- Extra electric heating using incorporated electric heating elements (option).
- Filter on the intake.
- Reversible installation: right-hand (standard) or left-hand (optional) access to the technical door.

Installation of an appliance with the hot water coil option.

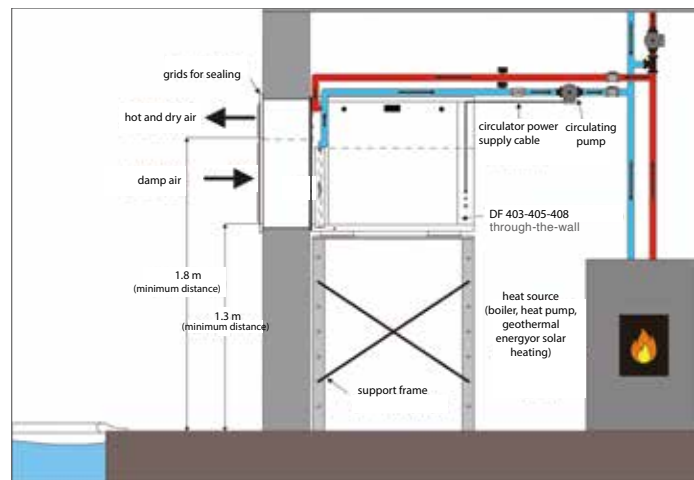

### WEIGHT AND DIMENSIONS

DF Through-the-wall	DF 403M	DF 405M	DF 405T	DF 408M	DF 408T
Weight (kg)	129	130		133	

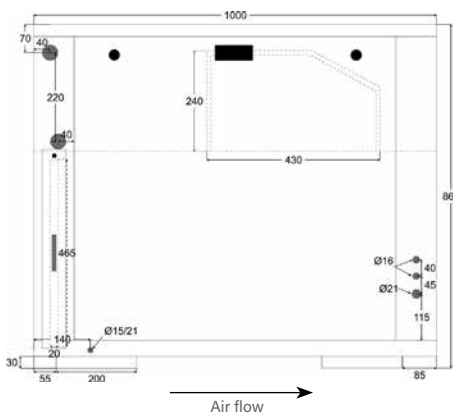
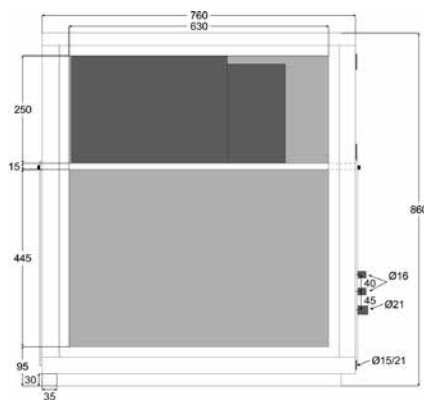

Access panel as standard for electrical connections

Grate to be mortared

