

# Vortex™

**Instructions for installation and use** - English  
Electric robotic cleaner  
Translation of the original instructions in french

**EN**

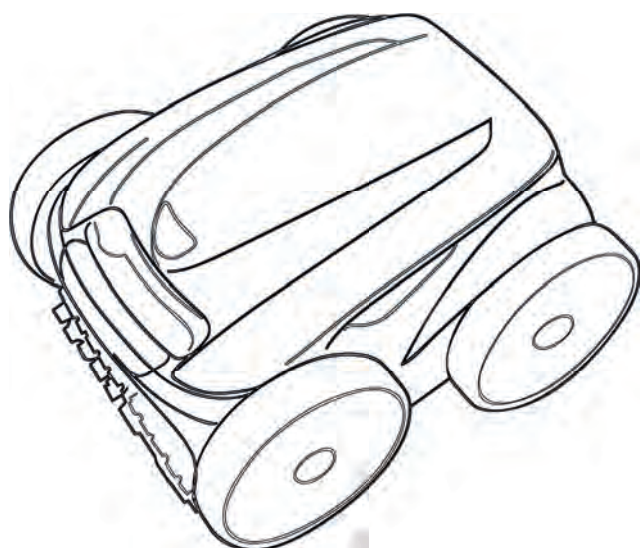

More documents on:  
[www.zodiac.com](http://www.zodiac.com)

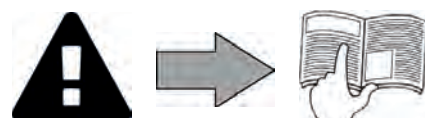

# WARNINGS

## GENERAL WARNINGS

- Failure to respect the warnings may cause serious damage to the pool equipment or cause serious injury, even death.
- Only a person qualified in the technical fields concerned (electricity, hydraulics or refrigeration) is authorised to carry out maintenance or repair the appliance. The qualified technician working on the appliance must use/wear personal protective equipment (such as safety goggles and protective gloves, etc.) in order to reduce the risk of injury occurring when working on the appliance.
- Before handling the appliance, check that it is switched off and isolated.
- The appliance is intended to be used for pools and spas for a specific purpose; it must not be used for any purpose other than that for which it was designed.
- This appliance is not intended to be operated by people (including children) who have a physical, sensory or mental disability or who lack experience and knowledge, unless it is used under supervision or with instructions for use given by a person who is responsible for their safety.
- Keep children away from the appliance.
- The appliance must be installed according to the manufacturer's instructions and in compliance with current local and national standards. The installer is responsible for installing the appliance and for compliance with national installation regulations. Under no circumstances may the manufacturer be held liable in the event of failure to comply with applicable local installation standards.
- For any work other than the simple user maintenance described in this manual, the product should be referred to a qualified professional.
- Incorrect installation and/or use may cause serious damage to property or serious injuries (possibly causing death).
- All equipment, even postage and packing paid, travels at the risks and perils of the recipient. The recipient shall issue reserves in writing on the carrier's delivery slip if damage is detected, caused during transport (confirmation to be sent to the carrier within 48 hours by registered letter). In the event that an appliance containing coolant has been turned on its side, mention your reservations in writing to the carrier.
- If the appliance suffers a malfunction, do not try to repair it yourself; instead contact a qualified technician.
- Refer to the warranty conditions for details of the permitted water balance values for operating the appliance.
- Deactivating, eliminating or by-passing any of the safety mechanisms integrated into the appliance shall automatically void the warranty, in addition to the use of spare parts manufactured by unauthorised third-party manufacturers.
- Do not spray insecticide or any other chemical (inflammable or non-inflammable) in the direction of the equipment, as this may damage the body and cause a fire.
- Zodiac® heat pump, filtration pump and filter appliances are compatible with the most commonly used types of pool water treatment systems.
- Do not touch the fan or moving parts and do not place any objects or your fingers in the vicinity of the moving parts during operation of the appliance. Moving parts can cause serious injury or even death.

## WARNINGS ASSOCIATED WITH ELECTRICAL APPLIANCES

- The power supply to the appliance must be protected by a dedicated 30 mA residual current device, complying with the standards and regulations in force in the country in which it is installed.
- Do not use any extension lead when connecting the appliance; plug the appliance directly into a suitable wall socket.
- Before carrying out any operations, check that:
  - The voltage indicated on the appliance information plate corresponds to the mains voltage.
  - The power grid is adapted to the power requirements of the appliance, and is grounded.
  - The plug (where applicable) is suitable for the socket.
- In the event of abnormal operation or the release of odours from the appliance, turn it off immediately, unplug it from its power supply and contact a professional.
- Before any intervention on the appliance, ensure that the latter is switched off and disconnected from the power supply, in addition to any other equipment connected to the appliance, and that the heating priority (where applicable) is deactivated.
- Do not disconnect and reconnect the appliance to the power supply when in operation.
- Do not pull on the power cord to disconnect it from the power supply.
- If the power cord is damaged, it must be replaced by the manufacturer, its technician or a qualified person to guarantee safety.
- Do not perform maintenance or servicing operations on the appliance with wet hands or if the appliance is wet.
- Clean the terminal board or the power supply socket before connection.
- For any component or sub-assembly containing a battery: do not recharge or dismantle the battery, or throw it into a fire. Do not expose it to high temperatures or direct sunlight.
- In stormy weather, unplug the appliance to prevent it from suffering lightning damage.
- Do not immerse the appliance in water (with the exception of cleaners) or mud.

## SPECIFIC FEATURES APPLICABLE TO "Pool cleaners"

- The cleaner is designed to operate correctly in pool water with a temperature of between 15°C and 35°C.
- Do not operate the cleaner outside the water to prevent it from causing any injury or damage.
- To avoid any risk of injury, bathing is prohibited when your cleaner is in the pool.
- Do not use the cleaner during shock chlorination.
- Do not leave the cleaner unattended for an extended period.

## WARNING ON THE USE OF A CLEANER IN A POOL WITH A VINYL SURFACE:

- Before installing your new cleaner, carefully inspect the lining of your pool. If the liner has eroded in some areas, or if you notice gravel, folds, roots or corrosion caused by metal beneath the liner, or if you notice that the surface (bottom and walls) is damaged, do not install the cleaner before performing the necessary repairs or before having the liner replaced by a qualified professional. The manufacturer may not be held liable in any way for damage caused to the liner.
- The surface of certain vinyl patterned surfaces can wear rapidly and the patterns disappear on contact from objects such as cleaning brushes, toys, inflatable buoys, chlorine distributors and automatic pool cleaners. The decoration on some vinyl surfaces can be scratched or worn by basic friction such as through the use of a pool brush. The colours of certain patterns can also be erased during use or when in contact with objects in the pool. The pool cleaner manufacturer may not be held liable for the erased patterns, wear or scratching of vinyl surfaces, which are not covered by the limited warranty.

## Recycling



This symbol means that your appliance should not be disposed of with other rubbish. It will be selectively collected for the purpose of reuse, recycling or transformation. If it contains any substances that may be harmful to the environment, these will be eliminated or neutralised.

Contact your retailer for recycling information.



- Before you do anything with the device, it is vital that you read this installation and user manual, as well as the "warnings and warranty" booklet delivered with the device. Failure to do so may result in material damage or serious or fatal injury and will invalidate the warranty.
- Keep and pass on these documents for reference during the appliance's service life.
- The distribution or modification of this document in any way is prohibited, without prior authorisation from Zodiac®.
- Zodiac® is constantly developing its products to improve their quality. The information contained herein may therefore be modified without notice.

## CONTENTS



### 1 Specifications

3

1.1 | Description

3

1.2 | Technical specifications and marking

5



### 2 Installation

6

2.1 | Set-up

6

2.2 | Attachment to the base or trolley assembly (depending on model)

6



### 3 Use

8

3.1 | Operating principle

8

3.2 | Pool preparation

8

3.3 | Immersing the cleaner

8

3.4 | Electricity supply connections

9

3.5 | Starting the cleaning cycle

10

3.6 | Ending the cleaning cycle

11

3.7 | Setting the time and programming the cleaning cycles (depending on the model)

12

3.8 | The remote control (depending on the model)

14



### 4 Maintenance

15

4.1 | Cleaning the filter

15

4.2 | Cleaning the propeller

16

4.3 | Replacing the brushes

17

4.4 | Replacing the tyres

18



### 5 Troubleshooting

19

5.1 | Appliance behaviour

19

5.2 | User alerts

20

5.3 | Pre-diagnostic menu (depending on the model)

21

**Tip: to make it easier to contact your retailer**

Write down your retailer's contact details to help you find them more easily and fill in the "product" information on the back of the manual; your retailer will ask you for this information.



# 1 Specifications

## 1.1 I Description

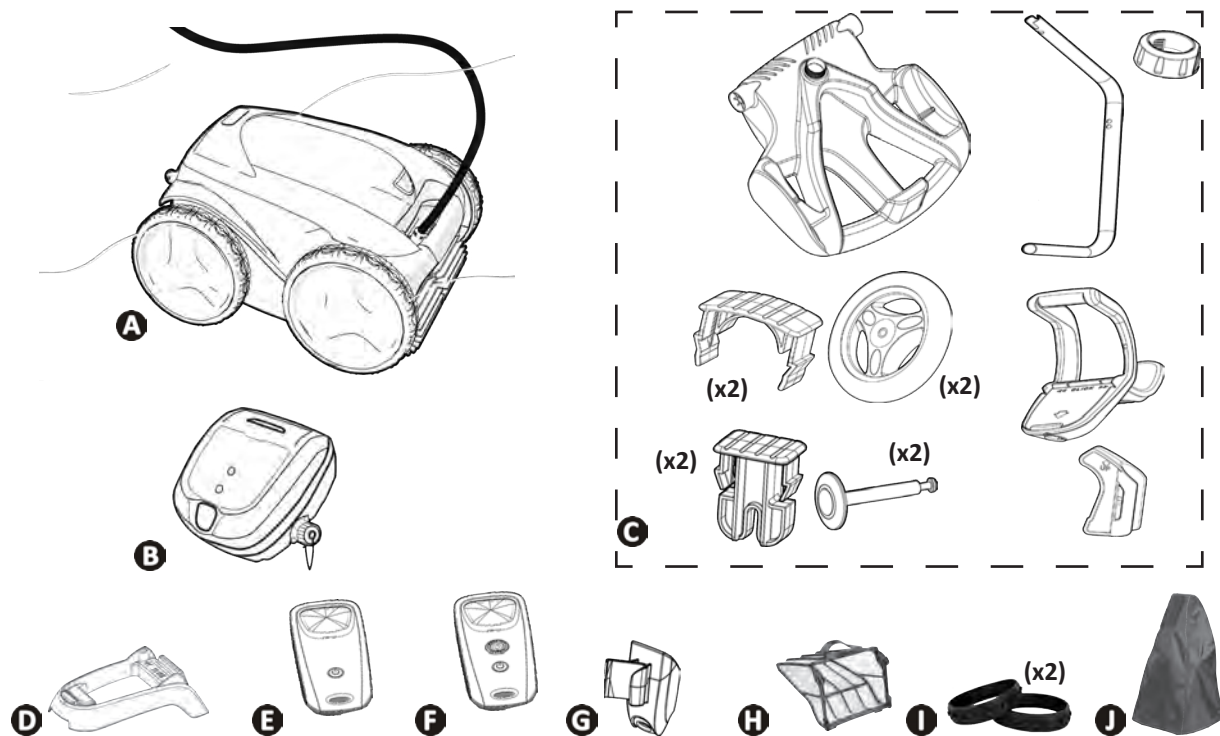

		OV 3300 RV 4200	OV 3400 - OV 3410 - OV 3450 - OV 3480 - RV 4310 - RV 4390 - RV 4400 - RV 4430 Vortex™ 3 PLUS - GV 3420	RV 4460	OV 3500 - OV 3505 - OV 3510 - Vortex™ 4 PLUS - GV 3520	RV 4550 RV 4560	OV 5300 OV 5330 RV 5300 RV 5400 RV 5470	RV 5500 RV 5600
A	Cleaner + floating cable	✓	✓	✓	✓	✓	✓	✓
	Front driving wheels (2WD)	✓	✓	✓	✓	✓		
	Front/rear driving wheels (4WD)						✓	✓
B	Control box	✓	✓	✓	✓	✓	✓	✓
C	Caddy kit	+	✓	✓	✓	✓	✓	✓
D	Base for control box	✓						
E	Kinetic remote control				✓			
F	Kinetic remote control "Remove from pool mode"					✓		✓
G	Remote control support				✓	✓		✓
H	100µ fine debris filter	✓	✓	✓	✓	✓	✓	✓
	200µ large debris filter	+	+	+	+	+	+	+
	60µ very fine debris filter							
I	"Tiled pool" front wheels		+					
J	Protective cover	+	+	✓	+	+	+	+

✓ : Supplied    + : Available as an option

Symbol	Designation	OV 3300 OV 3400 OV 3480 RV 4200 RV 4310 GV 3420	OV 3410 OV 3450 RV 4390 Vortex™ 3 PLUS	OV 3500 OV 3505 OV 3510 Vortex™ 4 PLUS GV 3520	RV 4400 RV 4430 RV 4460	RV 4550	RV 4560	OV 5300 OV 5330 RV 5300	RV 5400 RV 5470	RV 5500 RV 5600
	Start/ Stop the appliance	✓	✓	✓	✓	✓	✓	✓	✓	✓
	"Control" indicator	✓	✓		✓					
	"Clean filter" indicator				✓	✓	✓	✓	✓	✓
	Remove from pool mode				✓	✓	✓		✓	✓
	<b>Surface to clean</b> Bottom only		✓	✓	✓	✓	✓	✓	✓	✓
	Bottom + sides + water line		✓	✓	✓	✓	✓	✓	✓	✓
	Waterline only									✓
	<b>Pool shape</b> Flat bottomed rectangular									✓
	Other shapes, other bottoms									✓
	<b>Cleaning intensity</b> Low intensity									✓
	Intensive									✓
	Cleaning cycle programming						✓		✓	✓
	Increase or reduce the cleaning time			✓		✓				
	Switch on / off the re- mote control			✓		✓	✓			✓

EN

✓ : Available

## ➤ 1.2 I Technical specifications and marking

### 1.2.1 Technical specifications

	OV 3300 RV 4200	OV 3400 - OV 3410 - OV 3450 - OV 3480 - OV 3500 - OV 3505 - OV 3510 - OV 5300 - OV 5330 - RV 4310 - RV 4390 - RV 4400 - RV 4430 - RV 4460 - RV 5300 - RV 5400 - RV 5470 - Vortex™ 3 PLUS - Vortex™ 4 PLUS - GV 3420 - GV 3520	RV 4550 RV 4560 RV 5500	RV 5600
Control box power supply voltage	220-240 VAC, 50 Hz			
Cleaner power supply voltage	30 VDC			
Maximum power input	150 W			
Cable length	15 m	18 m	21 m	25 m
Cleaner size (L x W x h)	43 x 48 x 27 cm			
Package size (L x W x H)	69 x 43 x 46 cm	56 x 56 x 46 cm		
Cleaner weight	10.1 kg			
Packaged weight	14 kg	19 kg		
Theoretical cleaning width	270 mm			
Pump flow	16 m <sup>3</sup> /h			

### 1.2.2 Marking

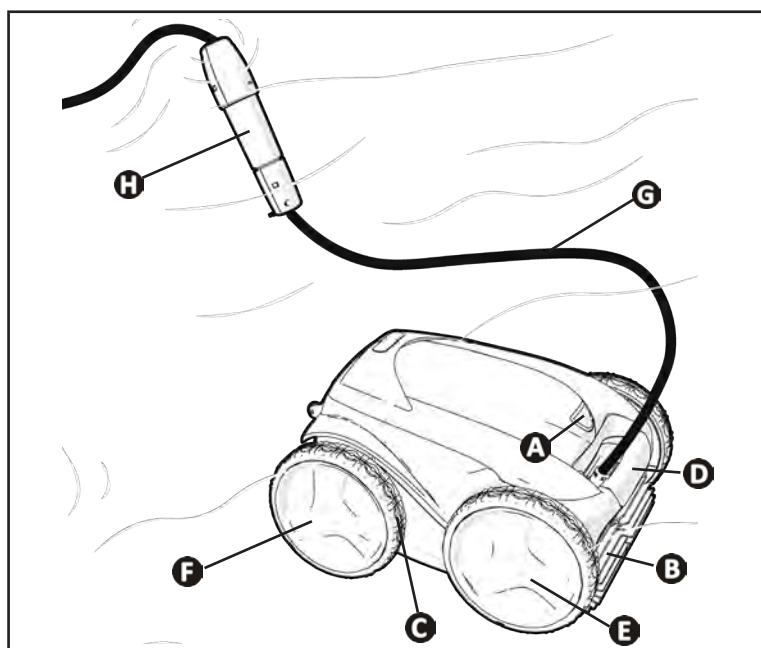

- A**: Filter access hatch lock
- B**: Brushes
- C**: Tyres
- D**: Transport and remove-from-pool handle
- E**: Front driving wheels
- F**: Rear driving wheels (according to model)
- G**: Floating cable
- H**: Swivel (according to model)

### 1.2.3 Product conformity

This appliance has been designed and built according to the following standards:

**Low voltage directive:** 2006/95/EC

**Electromagnetic compatibility directive:** 2004/108/EC

EN 55014-1: 2000 + A1:2001 + A2:2002 ; EN 55014-2: 1997 + A1:2002

EN 60335-1: 2002 + A1:2004 + A2:2006 + A11:2004 + A12:2006 ; EN 60335-2-41: 2003 + A1:2004

Relative to which it is compliant. The product has been tested under the normal conditions of use.

#### SAFETY STANDARDS:

The cleaners have been evaluated, tested and certified as being in conformance with the relevant requirements in IEC 60335-2-41.





## 2 Installation

### 2.1 I Set-up

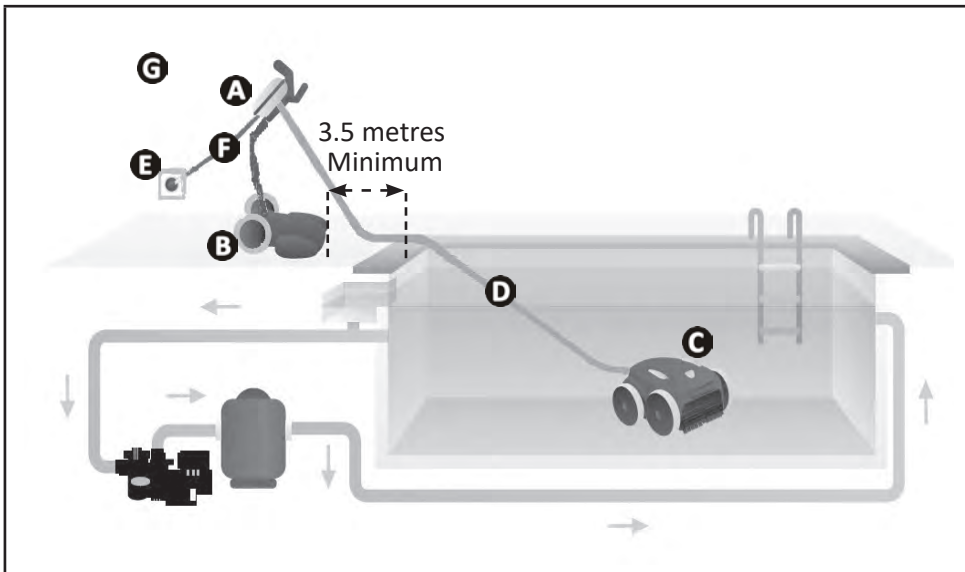

- A**: Control box
- B**: Caddy
- C**: Cleaner
- D**: Floating cable
- E**: Plug
- F**: Power cord

EN

### 2.2 I Attachment to the base or trolley assembly (depending on model)

#### 2.2.1 Attachment to the base

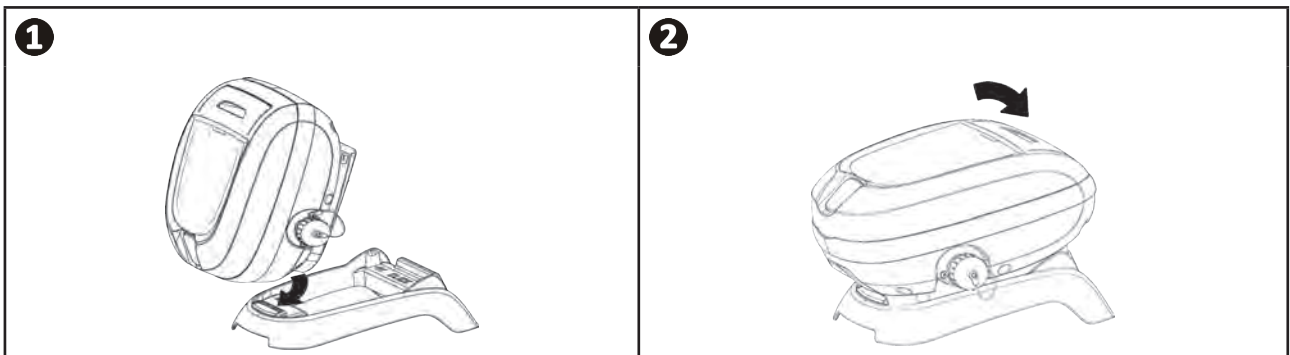

## 2.2.2 Caddy assembly



Tool-free assembly

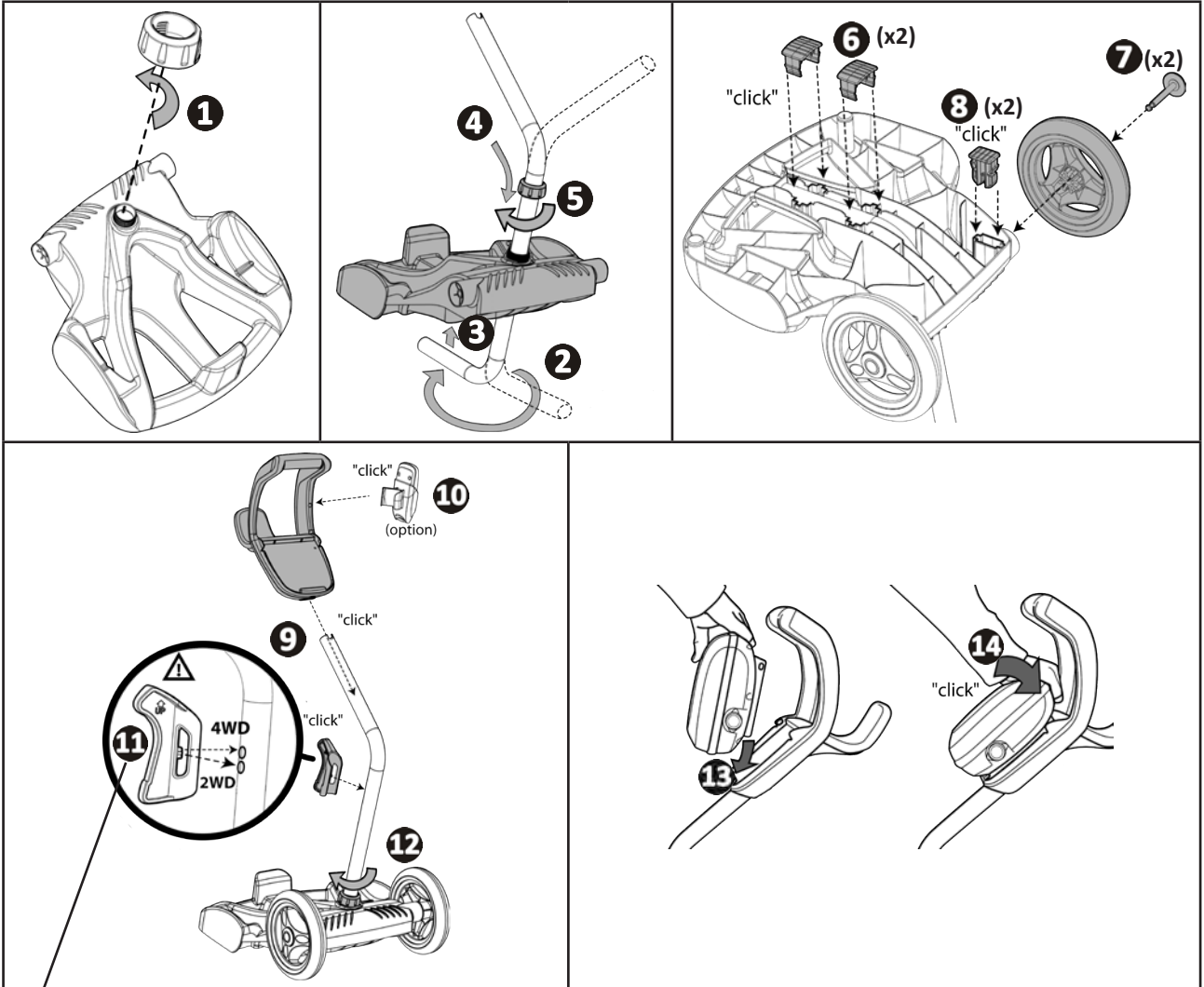

**11** For the number of driving wheels (2WD or 4WD), see: "1.1 I Description"





## 3 Use

### 3.1 I Operating principle

The cleaner is independent of the filtration system and may operate autonomously. Simply connect it to the mains. It finds the best route to move around and clean the areas of the pool for which it has been designed (depending on the model: bottom, walls, water line). Debris is sucked in and stored in the cleaner's filter. The control box enables the cleaning operations to be started, selected and programmed (depending on the model).

### 3.2 I Pool preparation



- This product is intended to be used in pools which are permanently installed. Do not use it in pools which may be dismantled. A permanent pool is built into the ground or on the ground and cannot be easily dismantled and stored.

- The appliance must operate in pool water with the following properties:

Water temperature	Between 15°C and 35°C
pH	Between 6.8 and 7.6
Chlorine	< 3 mg/l

- When the pool is dirty, especially when commissioning, remove the largest debris using a net in order to optimise the appliance's performances.
- Remove any thermometers, toys and other objects that might damage the appliance.

### 3.3 I Immersing the cleaner

- Roll out the full length of the cable alongside the pool to avoid the cable becoming tangled during immersion (see image 1).
- Place the cleaner vertically into the water (see image 2).
- Move it slightly in all directions so that the air contained in the cleaner escapes (see image 3).
- It is essential that the appliance sinks on its own and settles on the pool bottom. While it is immersed, the cleaner draws the length of cable it needs into the pool (see image 4).

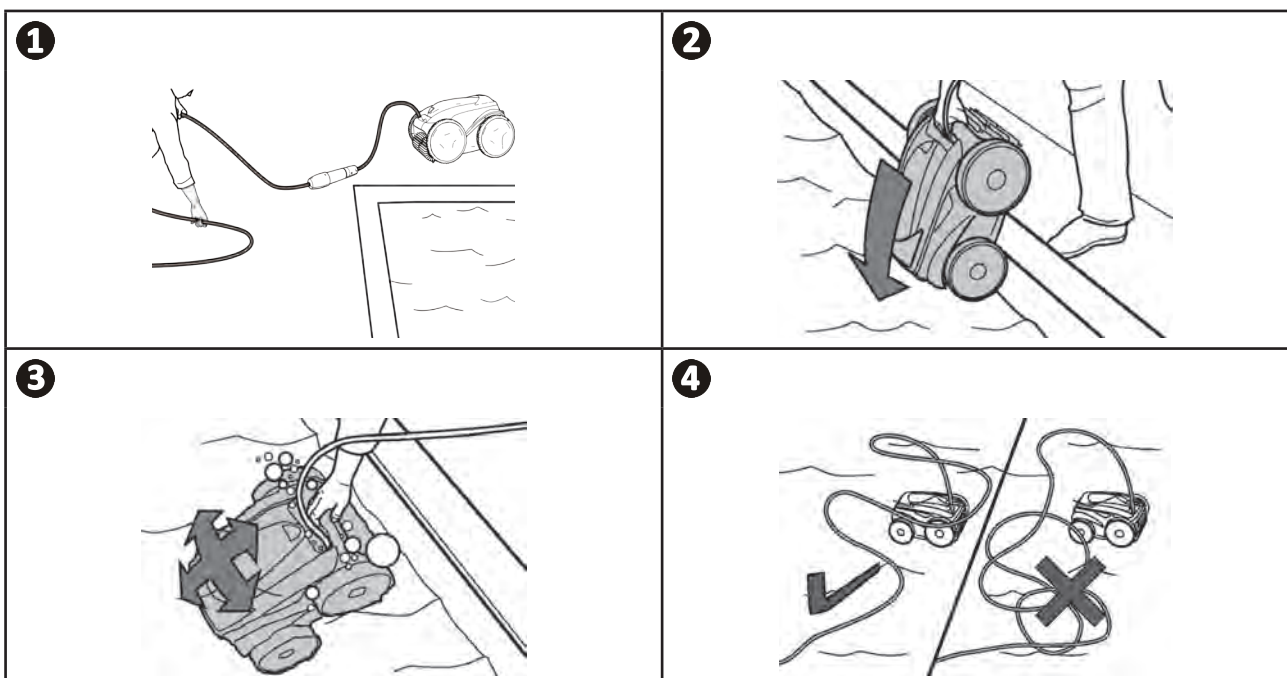

### ▶ 3.4 I Electricity supply connections

Please respect the following instructions to prevent the risk of electrocution, fire or serious injury:



- Use of an electrical extension is prohibited when connecting the control box.
- Make sure that the socket can be easily accessed at all times and is protected from rain or splashes.
- The control box is splash-proof but must not be immersed in water or any liquid. It must not be installed in a floodable area; keep it at least 3.5 metres away from the edge of the pool and avoid exposing it to direct sunlight.
- Place the control box near the socket.

- Unscrew the protective cap (see image ①).
- Connect the floating cable to the control box and lock it in place by turning the ring only in the clockwise direction (to prevent damage to the floating cable) (see image ②, ③).
- Make sure that the connector is fully pushed in so that no water can get in (see image ④).
- Connect the power cord (see image ⑤). Only connect the control box to a power outlet protected by a 30 mA maximum residual current device (if in doubt contact a qualified technician).

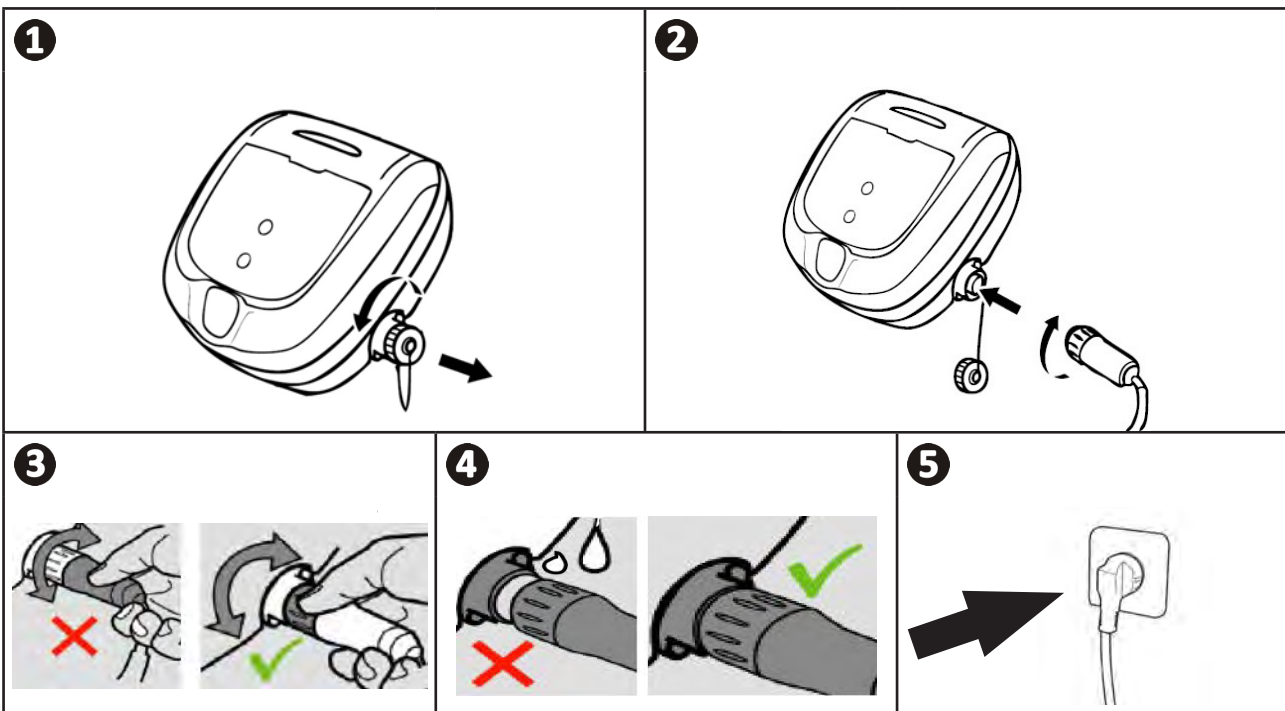

**Tip: choose the location of the control box carefully to prevent the cable from becoming tangled**

Place the control box in the centre of the pool's length, following the safety conditions relating to the electrical connection. This lets you limit the length of the floating cable to be put into the water to cover the pool, which simplifies set-up and storage operations.

## 3.5 I Starting the cleaning cycle



Respect the following instructions to avoid any risk of injury or damage to the equipment:







- Bathing is prohibited when the appliance is in the pool.
- Do not use the appliance during shock chlorination.
- Do not leave the appliance unattended for an extended period.
- Do not use the appliance if the roller shutter is closed.

- When the control box is powered up, the following symbols light up to indicate:
  - The action in progress
  - The cleaning mode selected
  - Maintenance required
- The control box switches to standby after 10 minutes and the screen is switched off. Press any key to exit standby mode. Standby mode does not stop the appliance if it is in a cleaning cycle.

EN

### 3.5.1 Cleaning cycle selection (depending on model)

- A cleaning cycle is already configured by default: the symbols are on and the cleaning time appears on the screen, for example: **0:45** (depending on the model)
- The cleaning cycle can be selected at any time, before the appliance starts or while it is operating. The new cycle will be launched instantly and the remaining time countdown will be reinitialised.
- The cleaner adapts its movement strategy depending on the choice in order to optimise the coverage rate.

Surface to clean	Pool shape	Cleaning intensity
 Bottom only	 Other shapes, other bottoms	 Low intensity
 Bottom + sides + water line	 Flat bottomed rectangular	 Intensive
 Waterline only		

### 3.5.2 Launching the cleaning cycle



- Press 



#### Tip: to improve the cleaning performance

At the start of the bathing season, launch several cleaning cycles in bottom only mode (after removing the large debris with a net). Regular use of the cleaner (without exceeding 3 cycles per week) means that your pool will always be clean and the filter less clogged.

### 3.5.3 Adjusting the cleaning time (depending on model)





- You may reduce or increase the time for the cleaning cycle selected or in progress:
  - : Reduce by 30 minutes.
  - : Increase by 30 minutes.
- Press  to confirm.

## ➤ 3.6 I Ending the cleaning cycle



- To avoid damaging the equipment:

- Do not pull on the cable to remove the appliance from the pool. Use the handle.
- Do not leave the appliance to dry out in sunlight after use.
- Store all the elements away from sunlight, humidity and bad weather.
- Screw the protective cap back on if you unplug the control box power cord.

- Switch off the appliance by pressing .
- When the cleaner is within arm's reach, pick it up by the handle and lift it gently out of the pool so that the water it contains drains into the pool (see image ) .
- Place the cleaner vertically in the location provided on the caddy (depending on the model) for it to dry out quickly (see image ) .
- Then store it with the control box away from sunlight and any splashes. A protective cover is available as an option (see image ) .

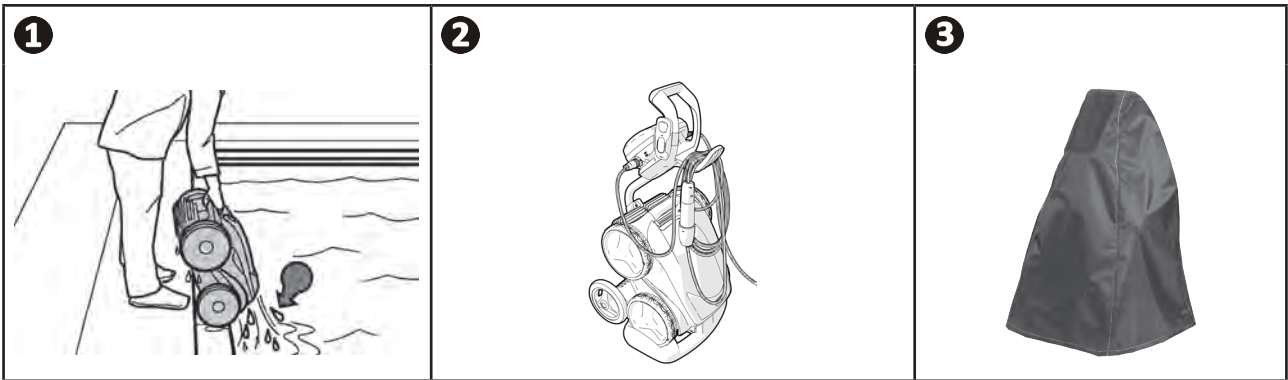

### 3.6.1 "Out of water" mode (depending on the model)

This function enables the cleaner to be returned to an exact point at the edge of the pool. When it climbs the wall, the cleaner sprays a jet of water behind it to make it lighter as it exits the pool.

- Direct the cleaner towards the required pool wall, then make it climb to the water line: hold  down to rotate it. The cleaner moves towards the wall when you release the button.



#### **Tip to prevent the floating cable from becoming tangled**

The cleaner's behaviour is strongly impacted by the tangling of the cable. A cable that is correctly untangled will guarantee better coverage of the pool.

- Untangle the cable and lay it out in the sun so that it returns to its original shape.
- Then wind it up carefully and place it on the caddy handle (depending on the model) or on a fixed support.

### 3.7.1 Setting the time and programming the cleaning cycles (depending on the model)



- Do not disconnect the power cable once the time has been programmed or you will lose it. The time setting will be saved for approximately 2 minutes if the power supply is disconnected.

#### 3.7.1 Setting the time

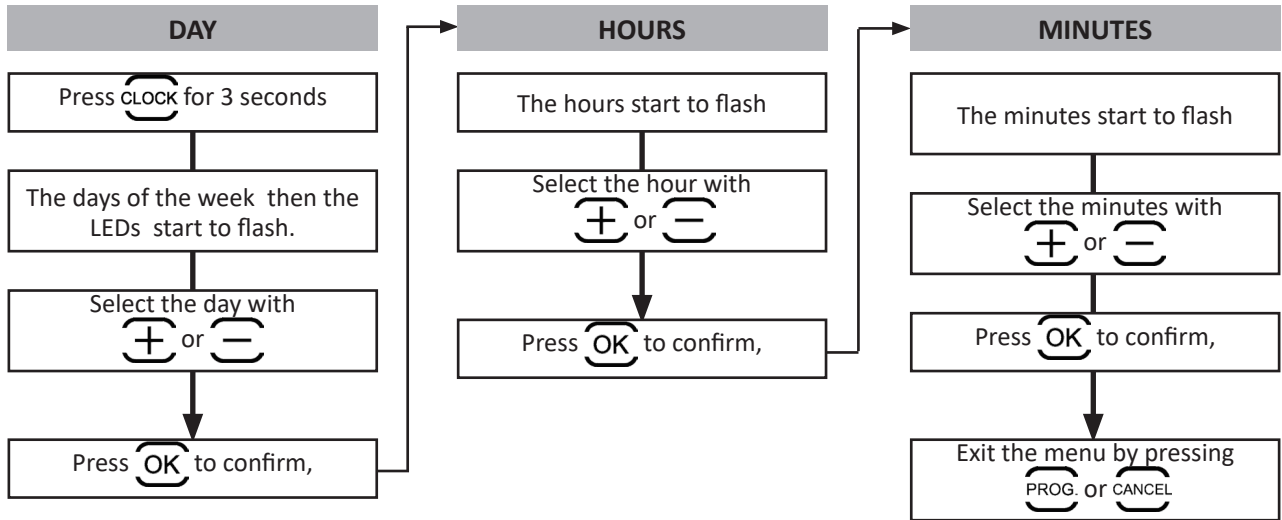

EN



**Tip: check the time setting**

Stopping the appliance if a cleaning cycle is in progress. Press . The time is displayed for 5 seconds.

### 3.7.2 Programming cleaning cycles

Program **up to 7 cleaning cycles** (for example, 2 days per week: Wednesdays and Saturdays over 4 weeks).

- You must set the time before you program the cleaning cycles, see § “3.7.1 Setting the time”.
- Start by selecting the cleaning cycle on the control box, see § “3.5.1 Cleaning cycle selection (depending on model)”.
- Then program the days, hours and minutes.

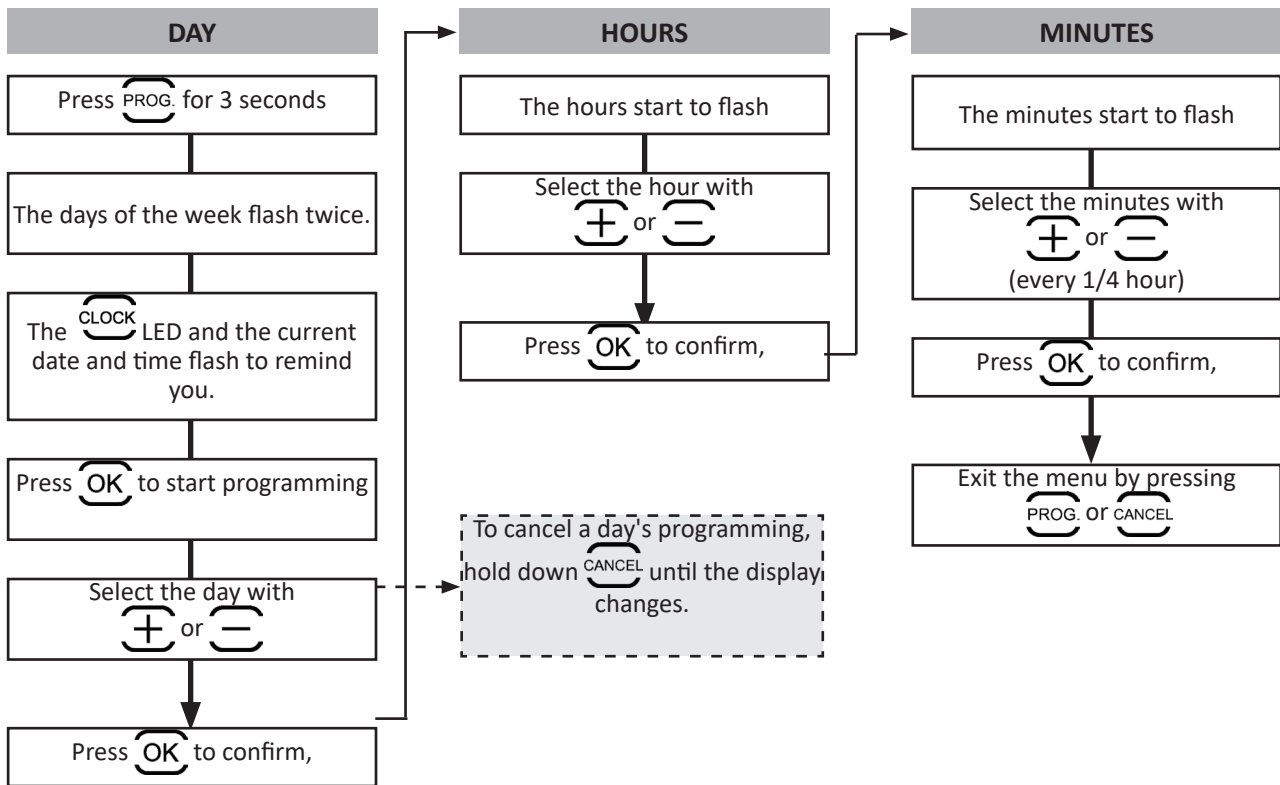

- The programming stops automatically at the end of the 7th cleaning cycle and the LED **PROG** switches off.
- To cancel ALL the programming, exit the menu **PROG** and hold down **CANCEL** until the display changes.





**Tip: check the programming**

Press **PROG**. Each programming is displayed for 3 seconds.

### 3.8 I The remote control (depending on the model)

- ⚠️ **Respect the battery polarity.**
- ⚠️ **Do not recharge the battery, dismantle it or throw it onto a fire.**
- ⚠️ **Do not expose it to high temperatures or direct sunlight.**

#### 3.8.1 Switching the remote control on and off

- To switch on: press .
- To switch off: press and hold .

**i** **Tip: improve the remote control reception.**  
 The frequency of the flashing of the led located on the remote control indicates the reception quality. If the LED flashes quickly, reception quality is OK.  
 For the best communication between the control box and the remote control:

- Position the control box on the caddy.
- Turn the control box towards the pool
- Removal all large obstacles between the control box and the pool.

#### 3.8.2 Directing the cleaner

- The remote control is equipped with movement sensors to direct the cleaner:

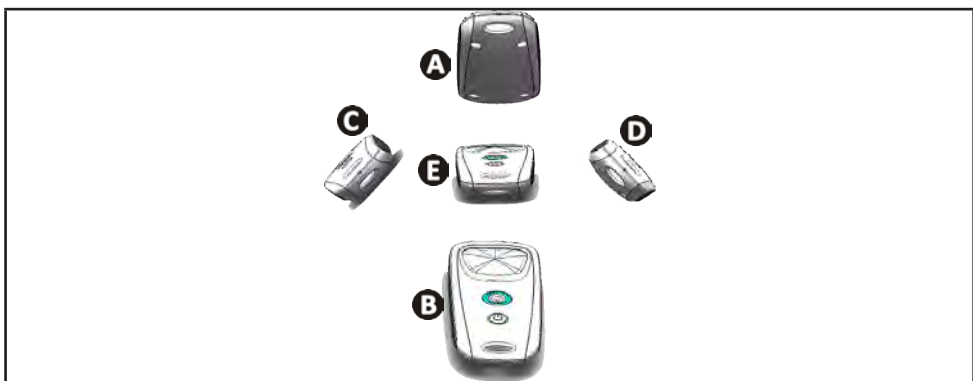



- A**: Forward
- B**: Backwards
- C**: Left turn
- D**: Right turn
- E**: Stop

#### 3.8 Taking the cleaner out of the water (depending on the model)

- Press . The cleaner moves toward the wall and climbs up to the waterline.

#### 3.8.4 Synchronising the remote control with the control box

By default, the remote control is already synchronised with the control box. If replacing the remote control/control box or if a synchronisation problem occurs, follow the steps below:

- Place the remote control a **maximum of 50 cm away** from the control box.
- Connect the control box, check that the display shows the operating time, and that no cleaning cycle is running.
- Switch on the remote by pressing .
- Before the remote control switches to standby (around 45 seconds) press the  and  buttons simultaneously for 6 seconds.
- Check that synchronisation was successful by observing the display and the remote LED:

Display on the control box	Remote LED	Result
<b>Good</b> → <b>0:45</b> 2 seconds	Flashing	<ul style="list-style-type: none"> <li>Synchronisation successful.</li> </ul>
<b>FAIL</b>	On steady	<ul style="list-style-type: none"> <li>Check the distance between the control box and the remote control is 50 cm maximum.</li> <li>Check the remote control batteries. Replace them if necessary. If the problem continues contact your retailer.</li> </ul>



## 4 Maintenance

- The appliance must be cleaned regularly using clean or slightly soapy water. Do not use solvents.
- Rinse the appliance thoroughly with clean water.
- Do not let your appliance dry in the sun by the pool.



**Tip: replace the filter and brushes every 2 years**

You are encouraged to change the filter and the brushes every 2 years to preserve the integrity of the appliance and guarantee optimum performance.

### 4.1 I Cleaning the filter



- The cleaner's performance may be reduced if the filter is full or dirty.
- Clean the filter regularly with clean water for efficient pool cleaning.
- If the filter is blocked, clean it with an acid solution (spirit vinegar, for example). It is recommended that you do this at least once a year, since the filter will clog if not used for several months (winterising period).

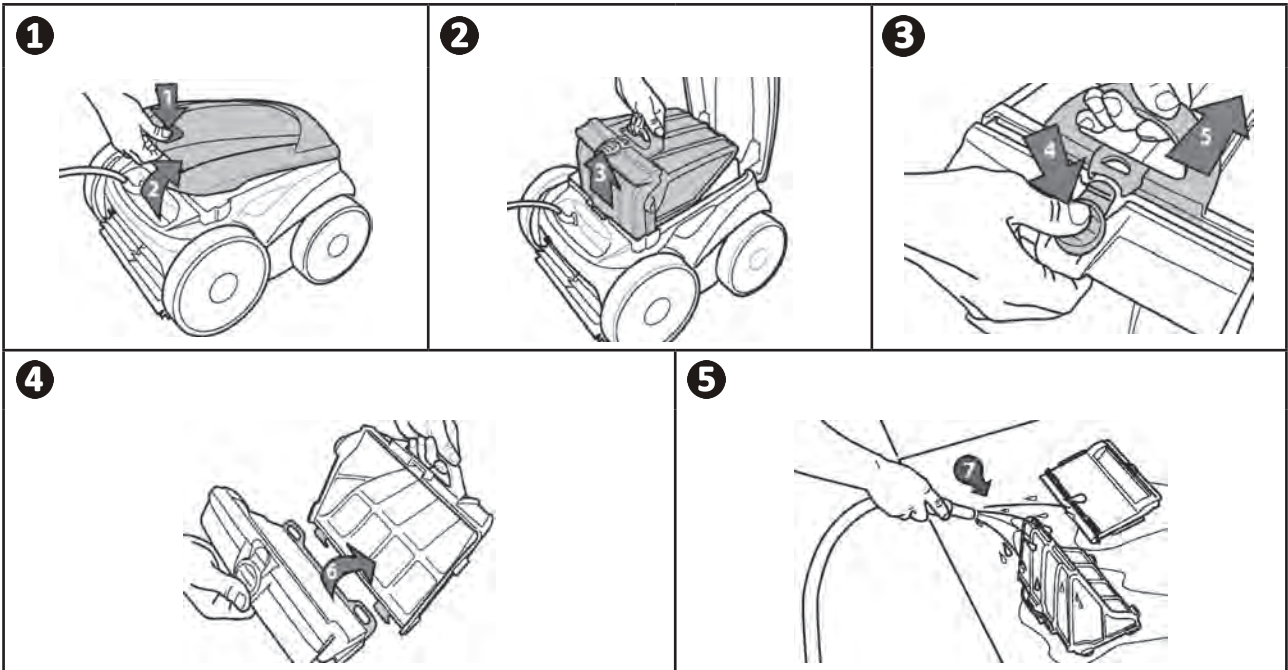

**Tip: Check the status of the "filter cleaning" indicator  (depending on the model)**

We recommend that you clean the filter as soon as the LEDs light up.



## ➤ 4.2 I Cleaning the propeller

To avoid serious injury:



- Disconnect the cleaner from the power supply.
- Wear gloves when maintaining the propeller .

- Loosen the screw on the grid (see image **1**).
- Remove the grid (see image **2**).
- Remove the flow guide carefully (see image **3**).
- To remove the propeller, wear gloves and hold the end of the propeller carefully when pushing it (see image **4**).
- Remove all debris (hair, leaves, stones, etc.) which may be blocking the propeller.

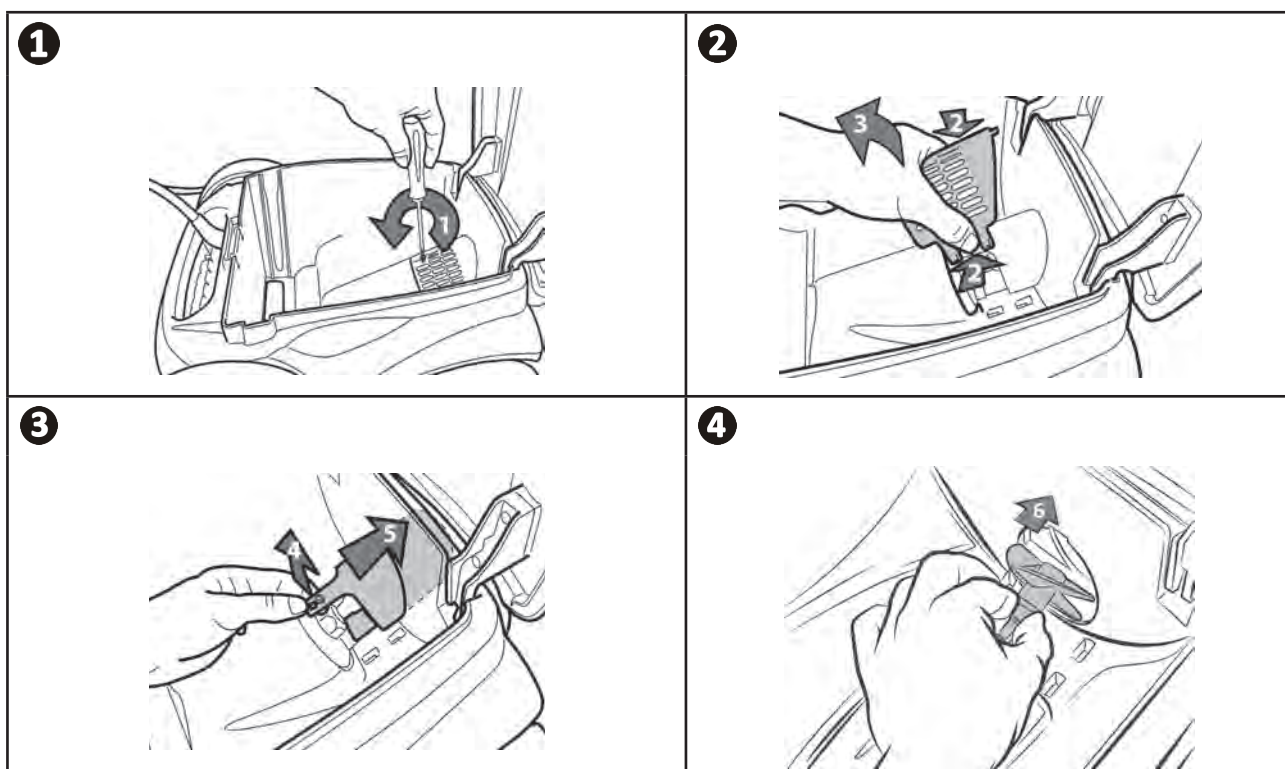

### ➤ 4.3 I Replacing the brushes

- Each brush is equipped with wear indicators, the gap between the indicators and the end of the brush indicates that the brush is in good condition (see image ➊).
- When the wear indicators appear as shown on the image ➋, the brushes are worn and must be replaced.
- To remove worn brushes, remove the tabs from the holes in which they are fixed (see image ➌).
- To fit new brushes, start by fitting the side without tabs under the brush holder (see image ➍).
- Roll the brush around its support, slide the tabs into the attachment holes and pull on the end of each tab until its edge passes through the slit (see image ➎).
- Cut the tabs using a pair of scissors for them to be level with the other blades (see image ➏).

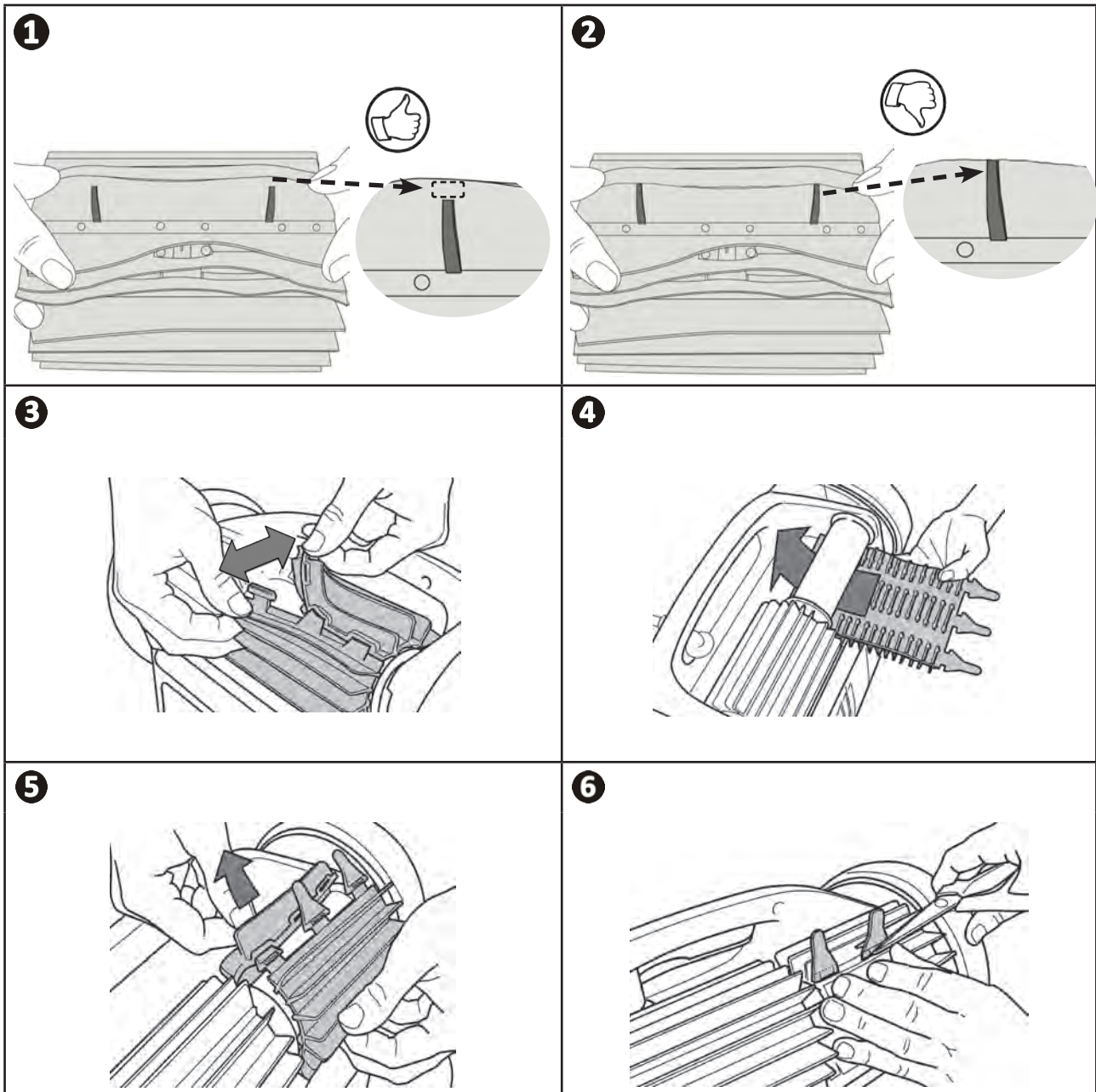

➤ 4.4 I Replacing the tyres

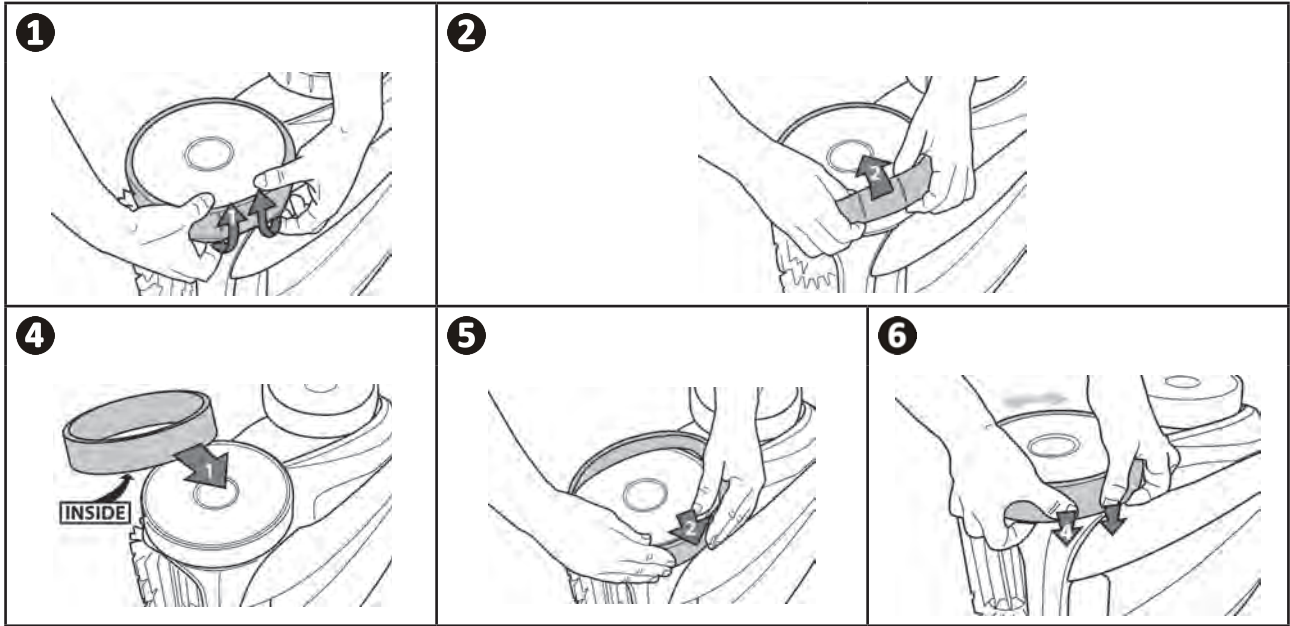

EN







## 5 Troubleshooting





- If a problem occurs, before you contact your retailer, please carry out these few simple checks using the following tables.
- If the problem continues, contact your retailer.
-  : Actions to be performed by a qualified technician only.

### 5.1 I Appliance behaviour

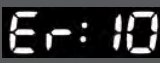
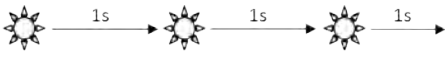

Part of the pool is not correctly cleaned	<ul style="list-style-type: none"> <li>• Repeat the immersion steps (see § “3.3 Immersing the cleaner”), varying the immersion location until you find the right place in the pool.</li> </ul>
The appliance does not stay firmly on the pool bottom	<ul style="list-style-type: none"> <li>• There is still air in the appliance's casing. Repeat the immersion operations (see § “3.3 Immersing the cleaner”).</li> <li>• The filter is full or dirty: clean it.</li> <li>• The filter is clogged: change it.</li> <li>• The propeller is damaged, <b>contact your retailer</b> </li> </ul>
The appliance does not or no longer climbs the pool sides as it originally did. (its electronic programme means that the appliance does not systematically climb the walls).	<ul style="list-style-type: none"> <li>• The filter is full or dirty: clean it.</li> <li>• The filter is clogged: change it.</li> <li>• Even though the water seems clear, microscopic algae are present in your pool. They are not visible to the naked eye, and they make the sides slippery and prevent the appliance from climbing. Carry out shock chlorination and slightly reduce the pH. <b>Do not leave the appliance in the water during shock treatment.</b></li> <li>• The brushes are worn: check the wear indicators “4.3 I Replacing the brushes”, then turn the brushes to verify their rotation. Replace the brushes if necessary.</li> <li>• <b>If the problem continues contact your retailer</b> </li> </ul>
The appliance does not move on start-up.	<ul style="list-style-type: none"> <li>• Check that the control box's power socket is receiving a power supply.</li> <li>• Check that a cleaning cycle has been launched and that the lights are on.</li> <li>• <b>If the problem continues contact your retailer</b> </li> </ul>
The cable gets tangled	<ul style="list-style-type: none"> <li>• Do not unroll the entire length of the cable into the pool.</li> <li>• Place the required length of cable in the pool and spread the rest along the side of the pool.</li> </ul>
The cleaner blocks at the discharge nozzles or bottom plug holes	<ul style="list-style-type: none"> <li>• Stop the filtration pump and launch a new cleaning cycle.</li> <li>• Place the control box in the centre of the pool's length, following the safety conditions, see “3.4 I Electricity supply connections”. If cleaning is not perfect, vary the position of the control box and the cleaner immersion.</li> </ul>
The cleaner climbs the walls slowly and stops under the water line.  The cleaner climbs the walls quickly and goes past the water line until it sucks in air:	<ul style="list-style-type: none"> <li>• The cleaner may behave differently according to the type of pool lining; it may be necessary to modify a parameter, <b>to do so contact your retailer</b> </li> </ul>
The control box does not respond to any button presses.	<ul style="list-style-type: none"> <li>• Unplug the power cord from the mains socket, wait 10 seconds and plug it back in again.</li> </ul>
The screen displays the message  when the remote control mode is active	<ul style="list-style-type: none"> <li>• This means that the remote control batteries are too low: change them.</li> </ul>

<p>The remote control LED is flashing slowly or the LED is steadily lit.</p>	<p>Remote control range problem:</p> <ul style="list-style-type: none"> <li>• Position the control box on the caddy at least 3.5 metres from the pool.</li> <li>• Orient the control box towards the pool in order to improve the range of the remote control. Ensure there are no large obstacles between the control box and the pool.</li> </ul>
<p>The remote control LED is steadily lit.</p>	<ul style="list-style-type: none"> <li>• Synchronisation problem: repeat the synchronisation steps (see §"3.8.4 Synchronising the remote control with the control box").</li> </ul>

## 5.2 I User alerts

User alerts (depending on the model)		Solutions
Flashing LED: 	Error code: 	
	<p>Er: 10</p>	<ul style="list-style-type: none"> <li>• Check that the cleaner is correctly connected to the control box. If necessary, unplug it and reconnect it following the appropriate procedure.</li> </ul>
	<p>Er: 02 Er: 03 Er: 05 Er: 06</p>	<ul style="list-style-type: none"> <li>• Check that there is nothing preventing the brushes and wheels from turning. To do so, turn the wheels (1/4 turn) to release any debris that may be jammed.</li> </ul>
	<p>Er: 07 Er: 08</p>	<ul style="list-style-type: none"> <li>• Cleaner operating outside the pool. Make sure you start the cleaner when it is in the water (see § "3.3 Immersing the cleaner").</li> </ul>
	<p>Er: 01 Er: 04</p>	<ul style="list-style-type: none"> <li>• Check that there are no stones or hair in the propeller.</li> <li>• Clean or change the filter if necessary.</li> </ul>

### 5.2.1 Error codes

- Pressing a key deletes the error code and turns off the control box.
- The screen switches to standby after 10 minutes. To turn the screen back on, press any key.
- When an error is detected, the control box temporarily suspends the programme (the  LED is turned off).
- Press and hold the  key to revalidate the current programming.

### ➤ 5.3 I Pre-diagnostic menu (depending on the model)

- Stopping the appliance if a cleaning cycle is in progress.
- To access the menu:

OV 3500 - OV 3505 - OV 3510 - RV 4550 -  
Vortex™ 4 PLUS - GV 3520

Press  for at least 5 seconds.

OV 5300 - OV 5330 - RV 4560 - RV 5300 - RV 5400 -  
RV 5470 - RV 5500 - RV 5600

Press  +  for at least 5 seconds

- The appliance status information scrolls:

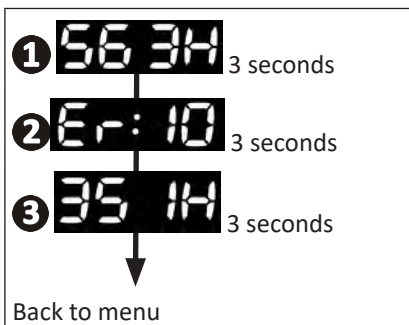

- ① The total operating time (in hours)
- ② The last error code (if the cleaner has had at least one error)
- ③ The operating time during the error (if the cleaner has had at least one error)



**Tip: if you require assistance, inform the retailer about the appliance's condition**

Votre revendeur  
*Your retailer*

Modèle appareil  
*Appliance model*

Numéro de série  
*Serial number*

Pour plus d'informations, enregistrement produit et support client :  
*For more information, product registration and customer support:*

**[www.zodiac.com](http://www.zodiac.com)**

