



Copper T

M150

0.05 - 5 mg/L Cu^{a)}

Cu

Biquinoline

Instrument specific information

The test can be performed on the following devices. In addition, the required cuvette and the absorption range of the photometer are indicated.

Instrument Type	Cuvette	λ	Measuring Range
MD 100, MD 110, MD 200, MD 600, MD 610, MD 640, MultiDirect, PM 600, PM 620, PM 630	ø 24 mm	560 nm	0.05 - 5 mg/L Cu ^{a)}
XD 7000, XD 7500	ø 24 mm	559 nm	0.05 - 5 mg/L Cu ^{a)}

Material

Required material (partly optional):

Reagents	Packaging Unit	Part Number
Copper No. 1	Tablet / 100	513550BT
Copper No. 1	Tablet / 250	513551BT
Copper No. 2	Tablet / 100	513560BT
Copper No. 2	Tablet / 250	513561BT
Set Copper No. 1/No. 2 100 Pc.#	100 each	517691BT
Set Copper No. 1/No. 2 250 Pc.#	250 each	517692BT

Application List

- Cooling Water
- Boiler Water
- Waste Water Treatment
- Pool Water Control
- Pool Water Treatment
- Drinking Water Treatment
- Galvanization



Preparation

1. Strong alkaline or acidic water samples must be adjusted to pH 4 to 6 before analysis.



Determination of Copper, free with tablet

Select the method on the device.

In addition, choose the test: free

For this method, a ZERO measurement does not have to be carried out every time on the following devices: XD 7000, XD 7500



Fill 24 mm vial with **10 mL sample**.

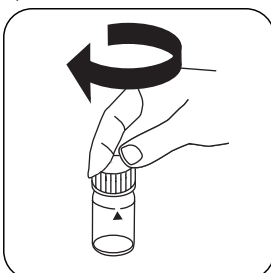

Close vial(s).

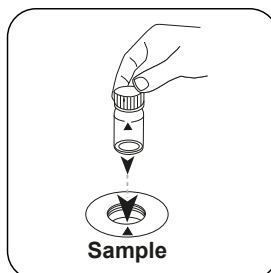

Place **sample vial** in the sample chamber. Pay attention to the positioning.

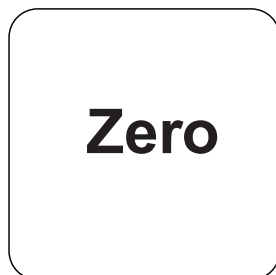

Press the **ZERO** button.

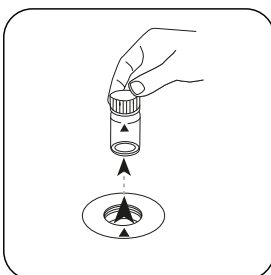

Remove the vial from the sample chamber.

For devices that require **no ZERO measurement**, start here.

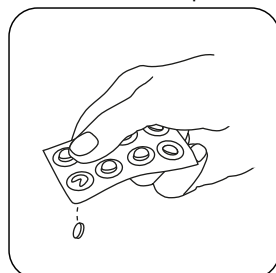

Add **COPPER No. 1 tablet**

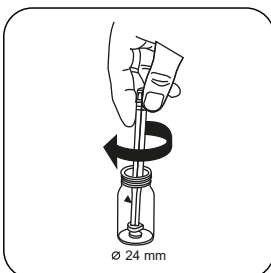

Crush tablet(s) by rotating slightly.

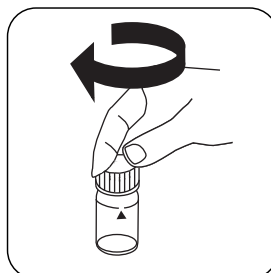

Close vial(s).

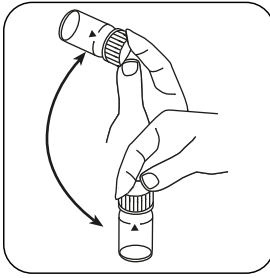

Dissolve tablet(s) by inverting.



Place **sample vial** in the sample chamber. Pay attention to the positioning.



Press the **TEST** (XD: **START**) button.

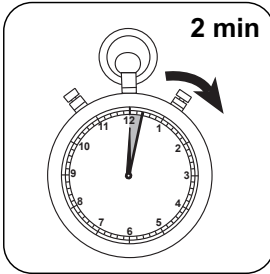

Wait for **2 minute(s) reaction time**.

Once the reaction period is finished, the measurement takes place automatically. The result in mg/L free Copper appears on the display.



Determination of Copper, total with tablet

Select the method on the device.

In addition, choose the test: total

For this method, a ZERO measurement does not have to be carried out every time on the following devices: XD 7000, XD 7500

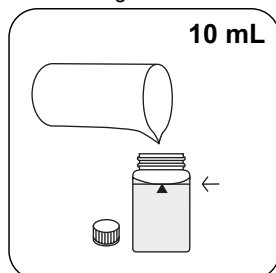

Fill 24 mm vial with **10 mL sample**.

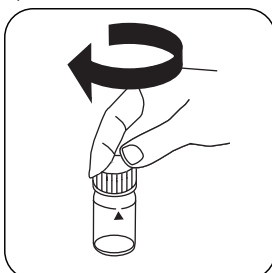

Close vial(s).

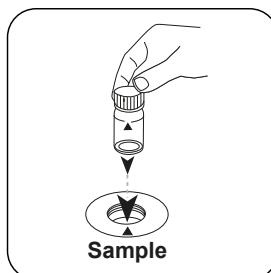

Place **sample vial** in the sample chamber. Pay attention to the positioning.

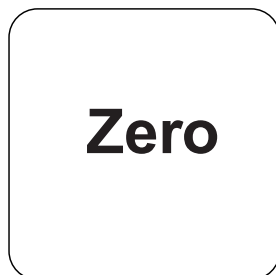

Press the **ZERO** button.

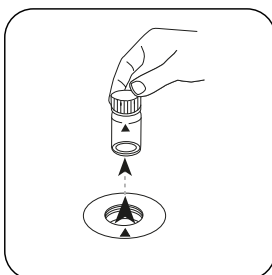

Remove the vial from the sample chamber.

For devices that require **no ZERO measurement**, start here.

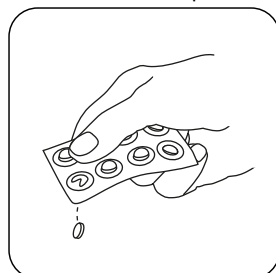

Add **COPPER No. 1 tablet**

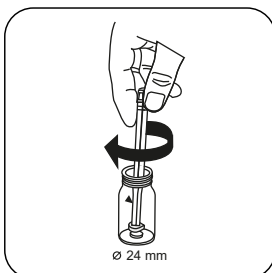

Crush tablet(s) by rotating slightly and dissolve.

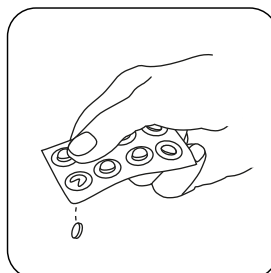

Add **COPPER No. 2 tablet**

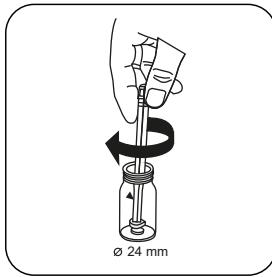

Crush tablet(s) by rotating slightly.

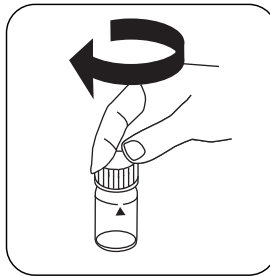

Close vial(s).

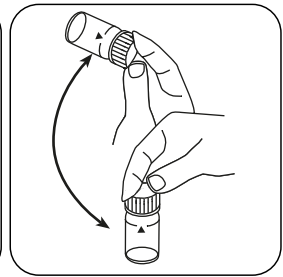

Dissolve tablet(s) by inverting.

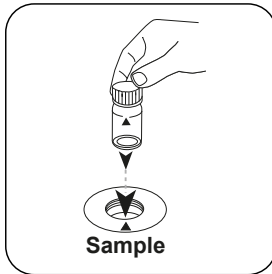

Place **sample vial** in the sample chamber. Pay attention to the positioning.

Once the reaction period is finished, the measurement takes place automatically. The result in mg/L total Copper appears on the display.

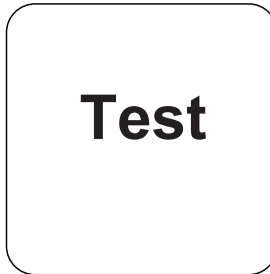

Press the **TEST** (XD: **START**) button.

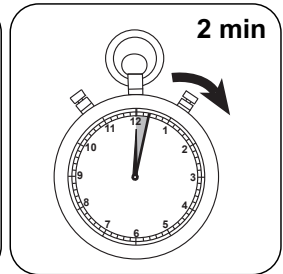

Wait for **2 minute(s)** reaction time.



Determination of Copper, differentiated determination with Tablet

Select the method on the device.

In addition, choose the test: differentiated

For this method, a ZERO measurement does not have to be carried out every time on the following devices: XD 7000, XD 7500



Fill 24 mm vial with **10 mL sample**.

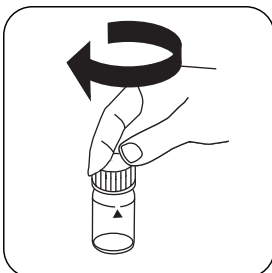

Close vial(s).

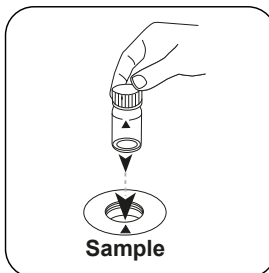

Place **sample vial** in the sample chamber. Pay attention to the positioning.

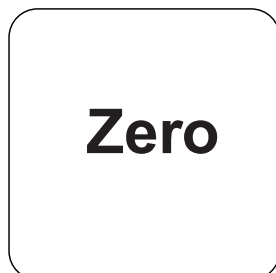

Press the **ZERO** button.

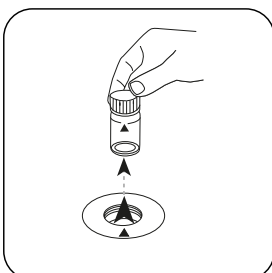

Remove the vial from the sample chamber.

For devices that require **no ZERO measurement**, start here.

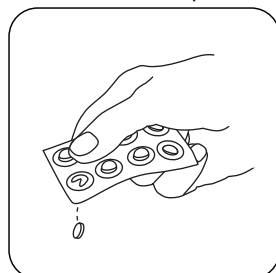

Add **COPPER No. 1 tablet**

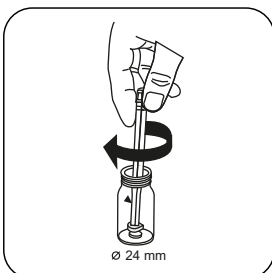

Crush tablet(s) by rotating slightly.

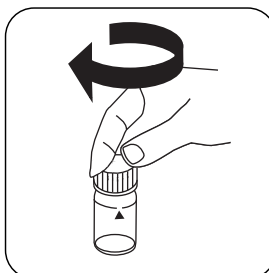

Close vial(s).

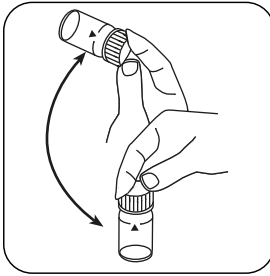

Dissolve tablet(s) by inverting.

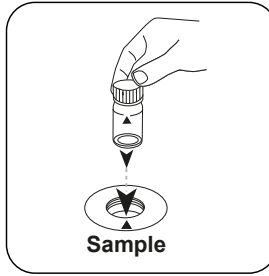

Place **sample vial** in the sample chamber. Pay attention to the positioning.

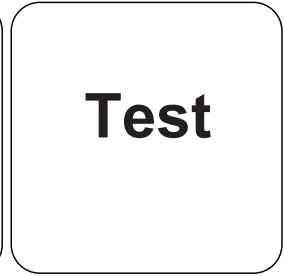

Press the **TEST** (XD: **START**) button.

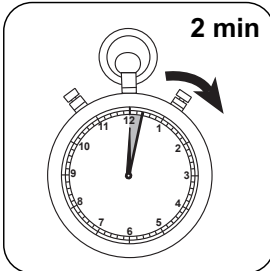

Wait for **2 minute(s) reaction time**.

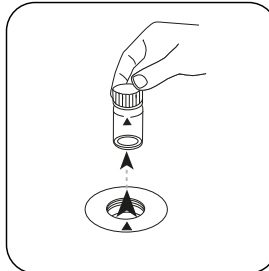

Remove the vial from the sample chamber.

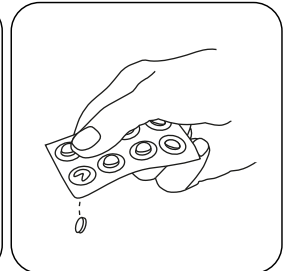

Add **COPPER No. 2 tablet**.

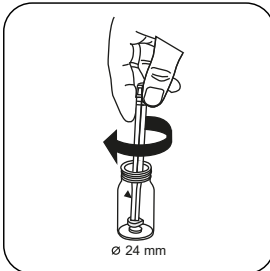

Crush tablet(s) by rotating slightly.

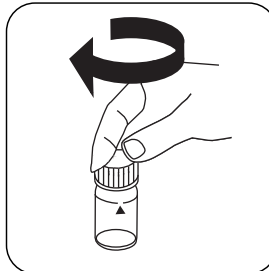

Close vial(s).

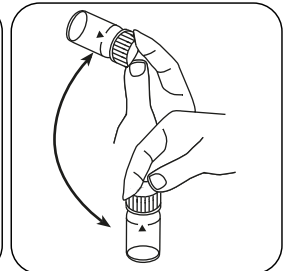

Dissolve tablet(s) by inverting.



Place **sample vial** in the sample chamber. Pay attention to the positioning.

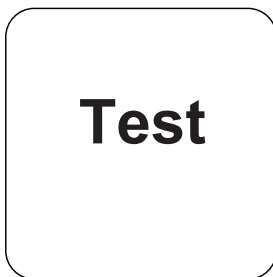

Press the **TEST** (XD: **START**) button.

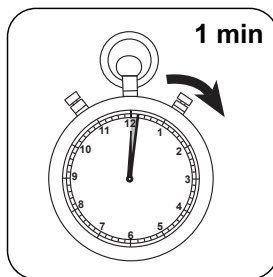

Wait for **1 minute(s) reaction time**.

Once the reaction period is finished, the measurement takes place automatically.

The result in mg/L free Copper; combined Copper; total Copper appears on the display.

Chemical Method

Biquinoline

Appendix

Calibration function for 3rd-party photometers

Conc. = $a + b \cdot \text{Abs} + c \cdot \text{Abs}^2 + d \cdot \text{Abs}^3 + e \cdot \text{Abs}^4 + f \cdot \text{Abs}^5$

	∅ 24 mm	□ 10 mm
a	$-4.78562 \cdot 10^{-2}$	$-5.12445 \cdot 10^{-2}$
b	$3.79263 \cdot 10^{+0}$	$8.20998 \cdot 10^{+0}$
c		
d		
e		
f		

Interferences

Persistent Interferences

1. Cyanide CN^- and Silver Ag^+ interfere with the test result.

Method Validation

Limit of Detection	0.05 mg/L
Limit of Quantification	0.15 mg/L
End of Measuring Range	5 mg/L
Sensitivity	3.8 mg/L / Abs
Confidence Intervall	0.026 mg/L
Standard Deviation	0.011 mg/L
Variation Coefficient	0.42 %

Bibliography

Photometrische Analyse, Lange/Vedjelek, Verlag Chemie 1980

^{a)} determination of free, combined and total | ^{*} including stirring rod, 10 cm