

SYMBOL DEFINITION		MISSING SYMBOLS	
A DIMENSION WITHOUT AN INSPECTION REPORT SYMBOL ( ) DOES NOT REQUIRE INSPECTION. IT MAY BE CONTROLLED ON THE INDIVIDUAL COMPONENT DRAWING.	TOTAL NO OF INSPECTIONS REQUIRED	NO MISSING SYMBOL NUMBER	8
	LAST NO. USED		8

DWG STATUS		REVISION HISTORY		AUTH		DR		APVD			
DATE	STG	REV	N/P	CHG	ZONE			1	2		
25JA19	R	01	-	-	-	CREATED PART DRAWING		444659	YLX	AM	TY

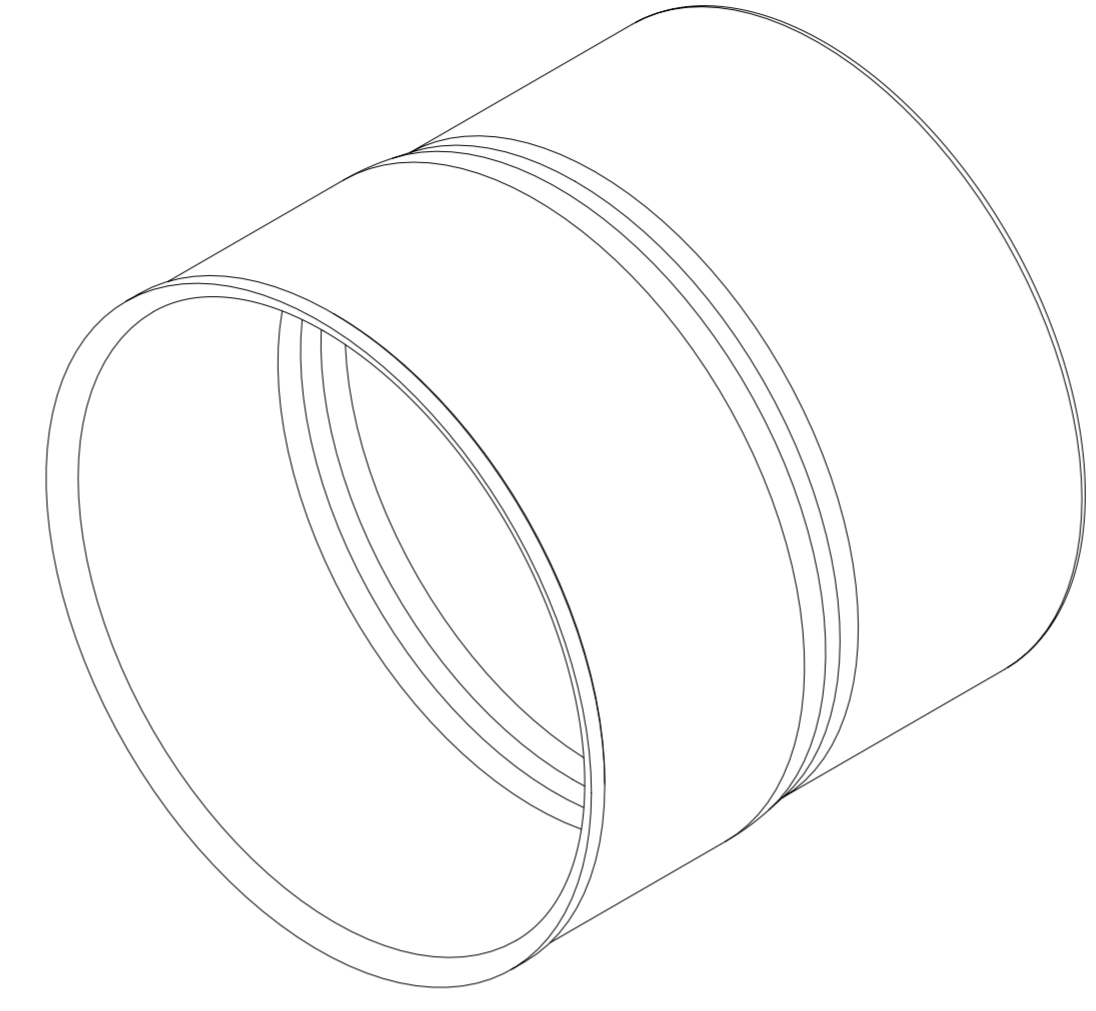

- NOTES
- UNLESS OTHERWISE SPECIFIED AND/OR INDICATED:  
DIMENSIONS ARE TO FACE OF VIEW SHOWN AND AUTOMATICALLY ROUNDED BY COMPUTER FOR INSPECTION (SEE MATH MODEL FOR PRECISE DIMENSIONS). FOR ALL OTHER DIMENSIONS NOT SHOWN BUT REQUIRED FOR TOOL BUILD, SEE MATH MODEL FOR PRECISE TOOL PATH DATA.
  - PART MUST BE FREE OF BURRS, SHARP EDGE, OIL, GREASE OR OTHER CONTAMINANTS.
  - ALL DIMENSIONS ARE AFTER PLATING.
  - PLATING:  
UNDERPLATE: THICKNESS OF NICKEL SHALL BE 1.5µm - 4µm PER ASTM B-689, TYPE 1, CLASS X.  
OVERPLATE: THICKNESS OF SILVER SHALL BE 3µm - 6µm PER ASTM B-700, TYPE 3, GRADE A, CLASS N, 165HV MIN.  
ANTI TARNISH TREATMENT PER DELPHI M5815 SPECIFICATION REQUIREMENTS. ANY COATING BRAND OTHER THAN EVABRITE MUST BE APPROVED BY APTIV.
  - THIS PART IS USED IN ASSEMBLY PARTS ON DRAWING 35287720.
  - PART MUST BE WATERPROOF PACKING.
  - IACS OF MATERIAL PERMITTED MIN. 24% .
  - INSIDE MEASUREMENT POINT FOR PLATING THICKNESS FIRST INTERNAL RELEASE.  
BY MEANS OF CONTROL GRID TO FIX THE MEASUREMENT RATIO INSIDE TO OUTSIDE MEASUREMENT.  
OUTSIDE MEASUREMENT POINT FOR PLATING THICKNESS DURING PRODUCTION.
  - OUTSIDE MEASUREMENT POINTS FOR PLATING THICKNESS DURING PRODUCTION.
  - ONLY RECOMMENDED CABLE ACC. TO LV216-2.  
CABLE SIZE: 25/35/50 MM² PER M6371 VALIDATED.  
ALL OTHER CABLE SUPPLIERS / CABLE SIZES MUST BE VALIDATED.

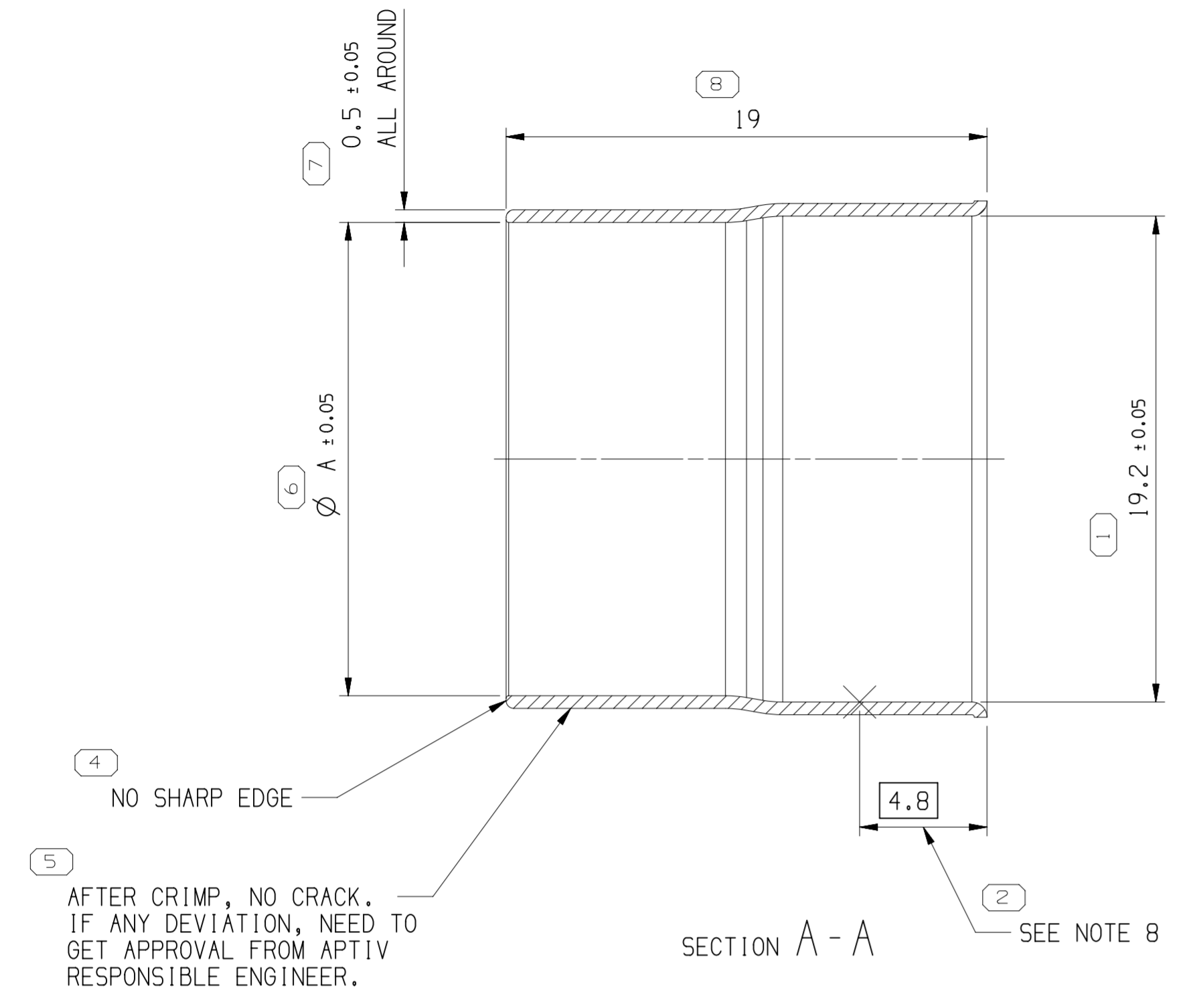
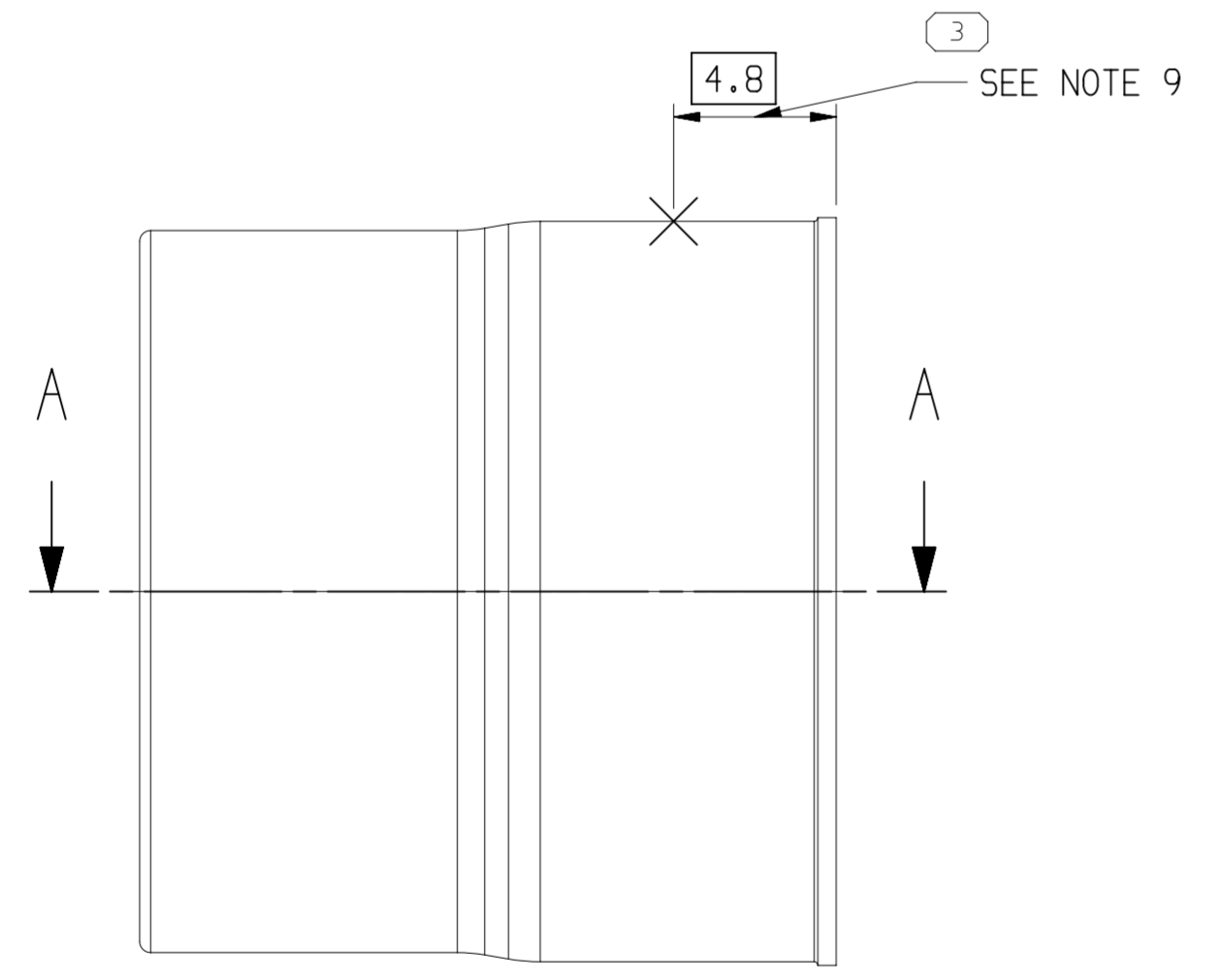

PART NO	REV	DESCRIPTION	Ø A	MATERIAL	VOLUME (CM³)	CABLE OD (CM)
35168227	01	SHIELDING OUTER FERRULE FOR 25 MM² CABLE	15.1	CuZn36 R350	0.558	12.2 <sub>-0.6</sub>
35168228	01	SHIELDING OUTER FERRULE FOR 35 MM² CABLE	17.3	CuZn36 R350	0.571	14.4 <sub>-0.6</sub>
35168229	01	SHIELDING OUTER FERRULE FOR 50 MM² CABLE	18.7	CuZn36 R350	0.579	15.8 <sub>-0.6</sub>

DIMENSIONAL RANGE (MM)	CHART D
FROM 0 TO 12	> 12
TOLERANCE UNLESS OTHERWISE SPECIFIED	
+0.1	+0.2
ANGULAR TOLERANCE	+2°

LINE DRAWN THROUGH A PART NUMBER INDICATES THAT PHYSICAL PARTS ARE NOT AVAILABLE FOR ORDERING.

PART NUMBERS THAT DO NOT HAVE A LINE PRESENT INDICATE THAT PHYSICAL PARTS ARE AVAILABLE FOR ORDERING.

CONTACT APTIV SALES TO ASSURE AVAILABILITY OF PARTS.

DWG TYPE: PART DRAWING

STYLE: SEE CHART

VOLUME (CM³): SEE CHART

DISTR CODE: D

UNLESS OTHERWISE SPECIFIED THIS DOCUMENT IS IN ACCORDANCE WITH ASME Y14.5M-1994 AS AMENDED BY THE GM GLOBAL DIMENSIONING AND TOLERANCING ADDENDUM-2001. SEPARATE PATTERNS OF FEATURES MAY BE GAGED SEPARATELY REGARDLESS OF DATUM REFERENCES.

ALL DIMENSIONS ARE IN MILLIMETERS

THIRD ANGLE PROJECTION

DO NOT SCALE

USE MATH DATA

NX

**• APTIV •**

CONNECTION SYSTEMS

Anting, China

COPYRIGHT 2019 APTIV. ALL RIGHTS RESERVED.

THIS DRAWING IS THE PROPERTY OF APTIV AND CONTAINS APTIV CONFIDENTIAL INFORMATION. THE REPRODUCTION, DISTRIBUTION AND UTILIZATION OF THIS DOCUMENT OR ITS RELATED CAD MATH DATA, AS WELL AS COMMUNICATION OF ANY CONTENT TO OTHERS, WITHOUT EXPRESS AUTHORIZATION, IS PROHIBITED.

DR	DATE
APVD1 YUANLIANG XU	25JA19
APVD2 ARTHUR MA	25JA19
APVD3 TIMON YU	25JA19
APVD4	
APVD5	

SUBSTANCES OF CONCERN AND RECYCLED CONTENT PER APTIV 10949001

MATERIAL: STAINLESS STEEL

DRAWING NAME: TAXI ASM LOCK STRAIN RLF FERRULE

DRAWING NUMBER: 35208635

SIZE	SCALE	FRAME NO	SHEET NO	STG	REV	N/P
A1	5:1	1 OF 1	1 OF 1	R	01	-