

MATING PANEL HOLE

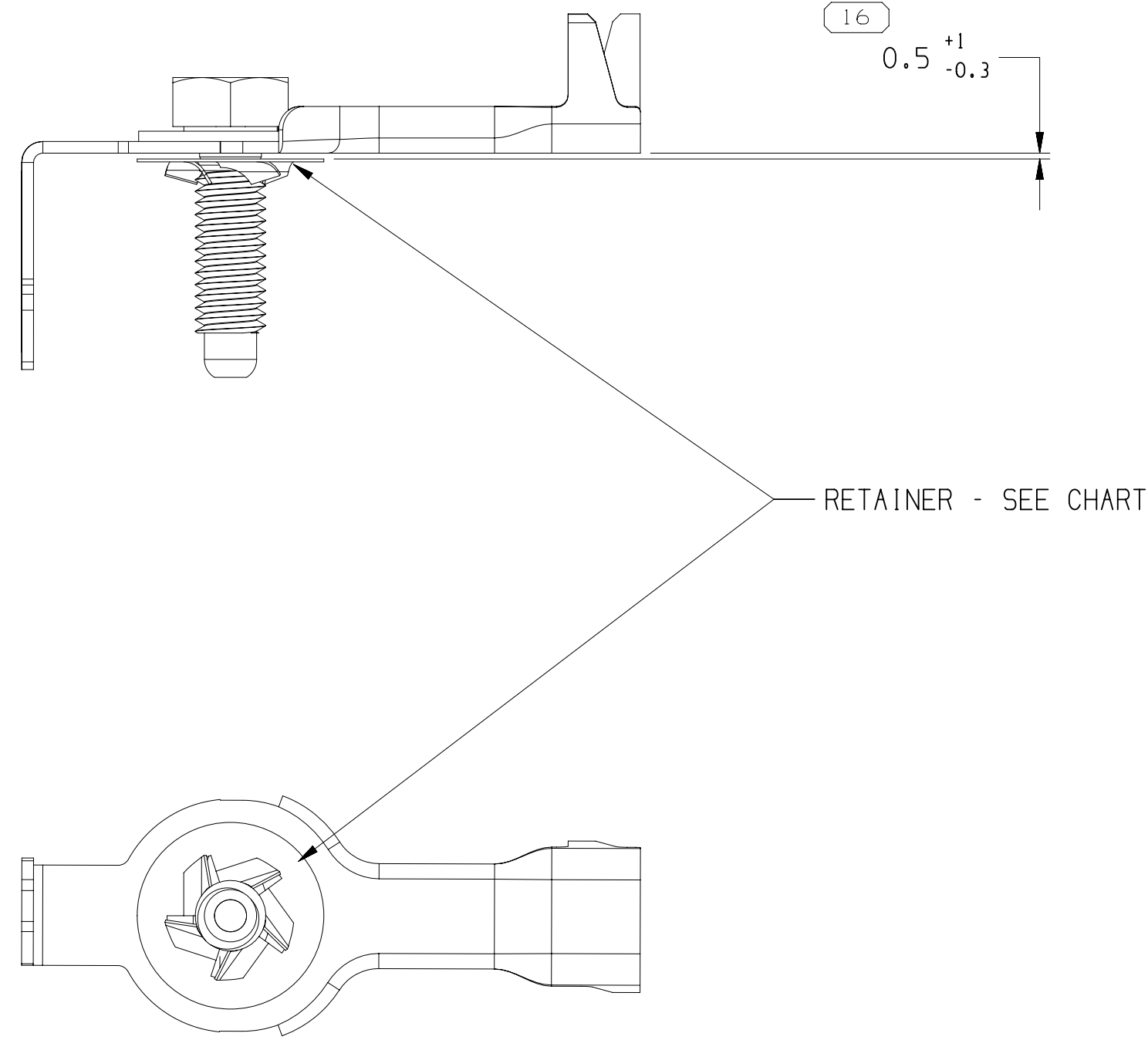

ALL TYPES
OPTIONAL CONSTRUCTION

A DIMENSION WITHOUT AN INSPECTION REPORT SYMBOL □ DOES NOT REQUIRE INSPECTION. IT MAY BE CONTROLLED ON THE INDIVIDUAL COMPONENT DRAWING.	TOTAL NO. OF INSPECTIONS REQUIRED	17
	LAST NO. USED	16

DWS STATUS		NO MISSING SYMBOL NUMBER		REVISION HISTORY		AUTH		DR		APVD	
DATE	STG	REV	N/P	CHG	ZONE						
290C07	R	01	-	-		13637605 WAS SEPARATE DRAWING AND REVISED. 13667844 WAS PE170780 AND RELEASED	402573	CJP	CJP	CJP	CJP
24JN08	R	02	-	-		13637605 - TERMINAL WAS 13642071; 13667844 - TERMINAL WAS 13667845	405123	BLG	JAM	CJP	CJP
18SE08	R	03	-	-		ALL PARTS - RELAXED TOLERANCES DIM #5 WAS 8.6 ±0.1, DIM #11 WAS 90° ±2° DIM #12 WAS 18.55 ±0.2, DIM #13 WAS 25.03 ±0.2 AND DIM #15 WAS 53.03 ±0.2	406150	EAJ	FKV	CJP	CJP
25N008	R	04	-	-		ALL PARTS - ADDED OPTIONAL CONSTRUCTION & REVISED NOTE 2	406882	RGC	RGC	RGC	RGC
24MR10	R	05	-	-		ALL PARTS - DIM 16 WAS 0.5 ±0.5/-0.3	410387	LHT	LHT	RGC	RGC
02N010	R	06	-	-		13838829 - RELEASED	411469	ACR	JAM	CRD	CRD
03MR11	R	07	-	-		ALL PARTS - 90° ±6° WAS 90° ±5°	413552	AJP	JVM	CRD	CRD
210C13	R	08	-	-		33119925 - RELEASED	424231	AHY	AHY	LRS	LRS
300C13	R	09	-	-		13838829 - WAS TYPE 102; 33119925 - WAS TYPE 101 & BUNDLE SIZE 2.5-6.5 AND NO. OF WIRES 1-8	424384	AOC	JVM	LRS	LRS
18FE19	R	10	-	-		13838829 & 33119925 - ADDED OPTIONAL CONSTRUCTION; ALL PARTS - MOVED RETAINER PIN FROM OPTIONAL CONSTRUCTION VIEW TO BOM CHART	442415	LVD	LB	LB	LB

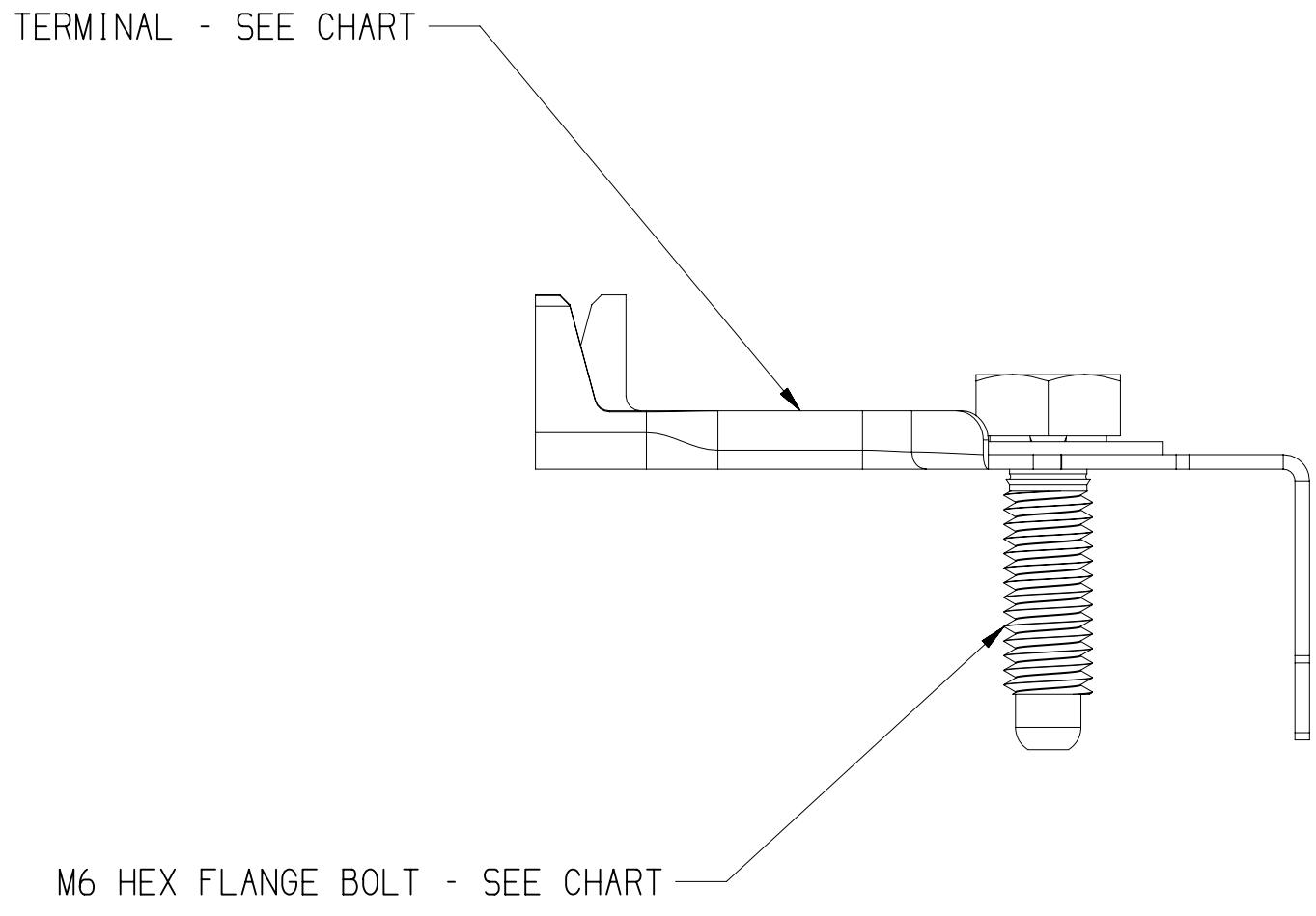
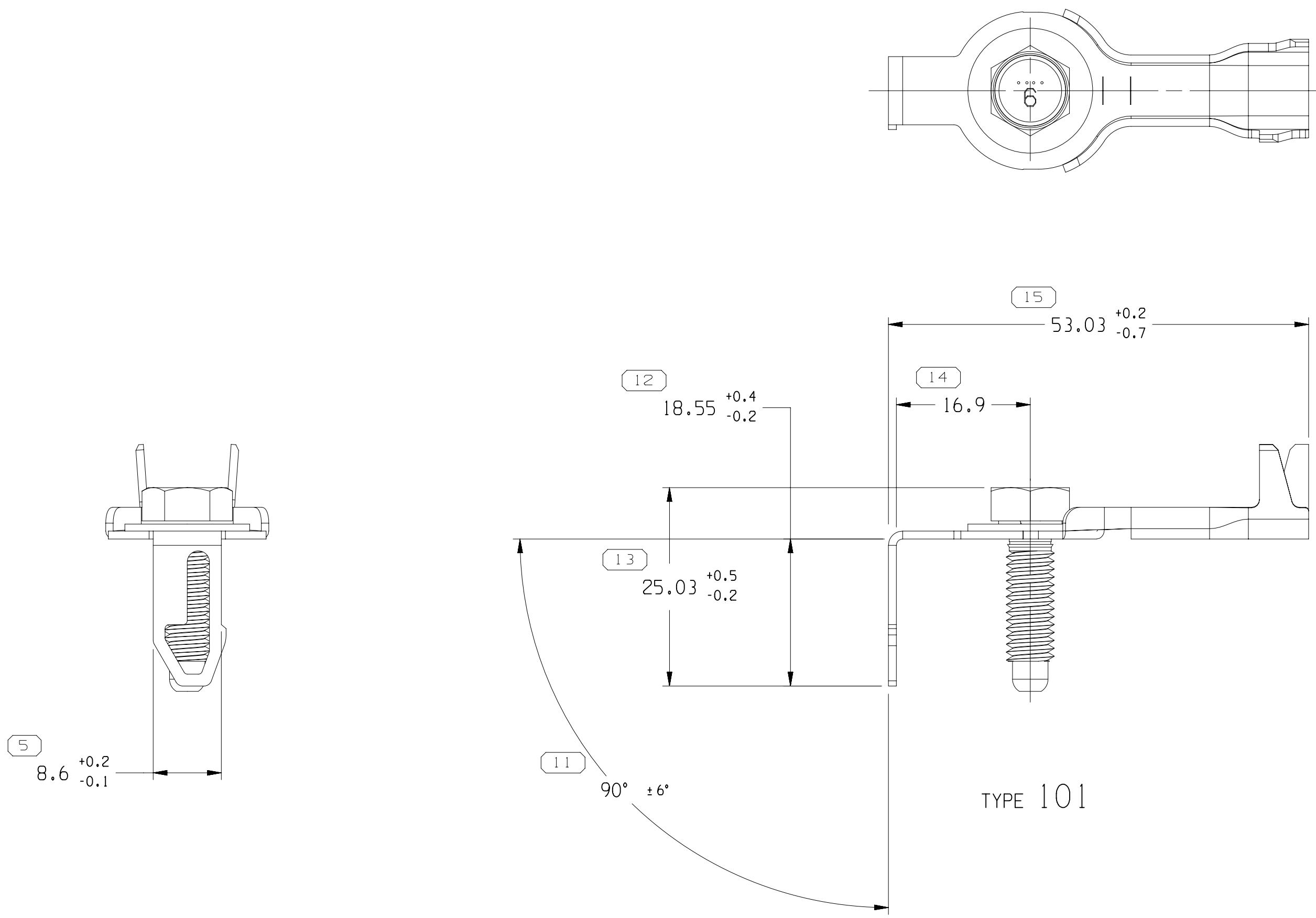

- NOTES
- UNLESS OTHERWISE SPECIFIED AND/OR INDICATED:
DIMENSIONS ARE TO FACE OF VIEW SHOWN AND AUTOMATICALLY ROUNDED BY COMPUTER FOR INSPECTION (SEE MATH MODEL FOR PRECISE DIMENSIONS). FOR ALL OTHER DIMENSIONS NOT SHOWN BUT REQUIRED FOR TOOL BUILD, SEE MATH MODEL FOR PRECISE TOOL PATH DATA.
 - BOLT MUST ROTATE IN ASSEMBLY AT A TORQUE OF LESS THAN 10 LBF-FT (13.5 N-M) BUT WILL NOT COME OUT OF THE TERMINAL.

33119925	02	AA	104	13711877	13838828	13509912	6.5 - 13.5	1 - 12
13838829	01	AC	103	13711878	13838828	13509912	2.5 - 6.5	1 - 8
13667844	03	AC	102	13711878	13509726	13509912	2.5 - 6.5	1 - 8
13637605	05	AC	101	13711877	13509726	13509912	6.5 - 13.5	1 - 12
PART NO	REV	N/P	TYPE	TERMINAL	BOLT	RETAINER	BUNDLE SIZE (MM²)	NO. OF WIRES (MIN-MAX)
						SEE OPTIONAL CONSTRUCTION VIEW		

5	PROCESS SENSITIVE DIMENSION
DIMENSIONS ENCLOSED IN () INDICATE REFERENCE DIMENSIONS AND NO TOLERANCE LIMITS ARE ESTABLISHED	
FROM	TO
0	12
12	12
TOLERANCE UNLESS OTHERWISE SPECIFIED	±0.1
ANGULAR TOLERANCE	±2°

THIRD ANGLE PROJECTION	DO NOT SCALE	USE MATH DATA	NX
------------------------	--------------	---------------	----

APTIV	
CONNECTION SYSTEMS	
WARREN, OH	
COPYRIGHT 2007 APTIV. ALL RIGHTS RESERVED.	
THIS DRAWING IS THE PROPERTY OF APTIV AND CONTAINS APTIV CONFIDENTIAL INFORMATION. THE REPRODUCTION, DISTRIBUTION AND UTILIZATION OF THIS DOCUMENT OR ITS RELATED CAD DATA, AS WELL AS COMMUNICATION OF ANY CONTENT TO OTHERS, WITHOUT EXPRESS AUTHORIZATION, IS PROHIBITED.	
DR	DATE
APVD1 C. PAPAS	290C07
APVD2 C. PAPAS	290C07
APVD3 CAROL J. FITCH	06N007
APVD4	
APVD5	
SUBSTANCES OF CONCERN AND RECYCLED CONTENT PER APTIV 10949001	
MATERIAL SEC CHART	
DRAWING NAME	
TAXI ASM TERM RING SONIC	
DRAWING NUMBER	
13669723	
SIZE	SCALE
A0	2:1
FRAME NO	SHEET NO
1	1 OF 1
STG	REV
1	10