

TYPE 102  
SAME AS TYPE 101  
EXCEPT AS SHOWN

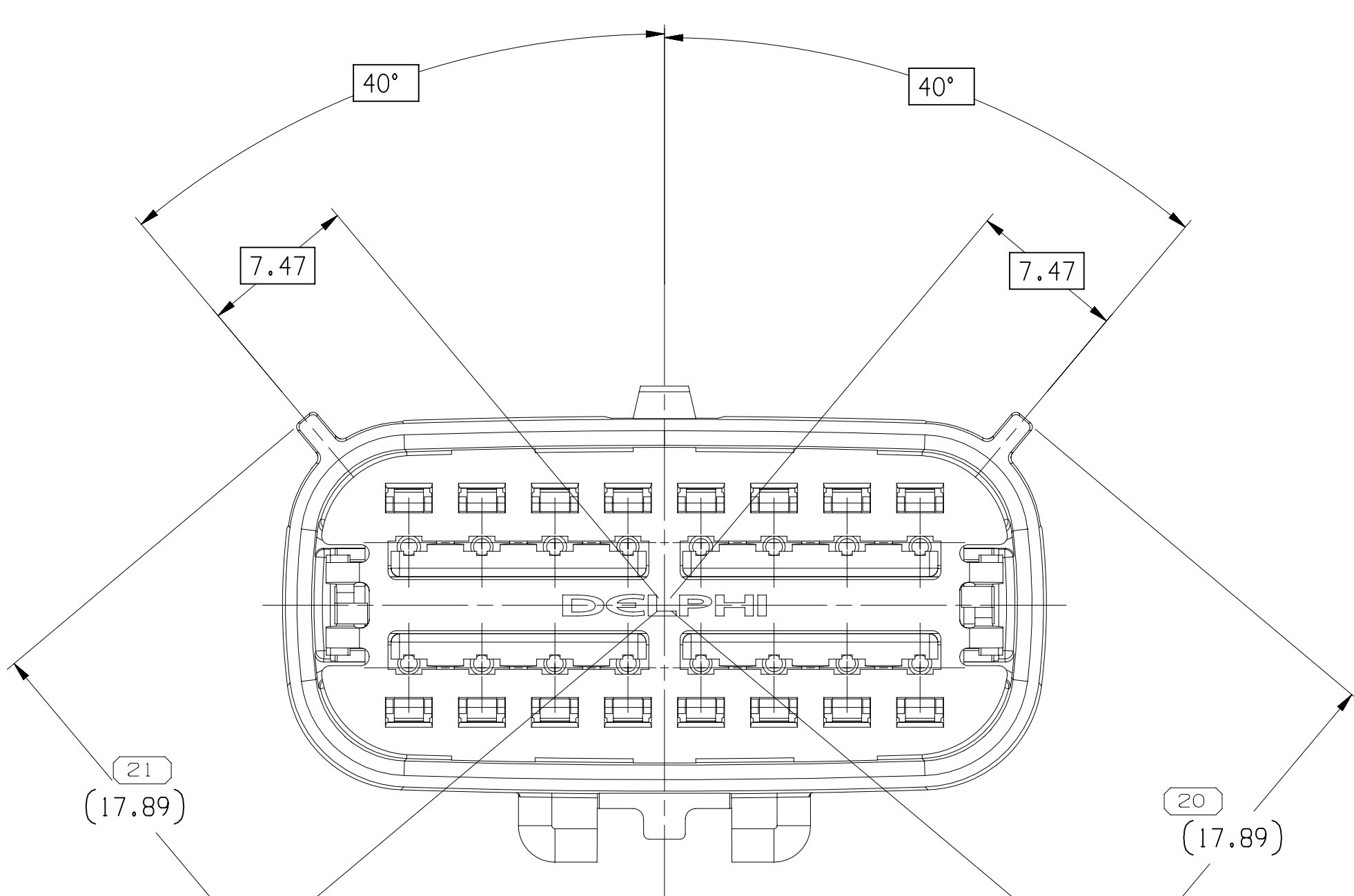

TYPE 105  
SAME AS TYPE 101  
EXCEPT AS SHOWN

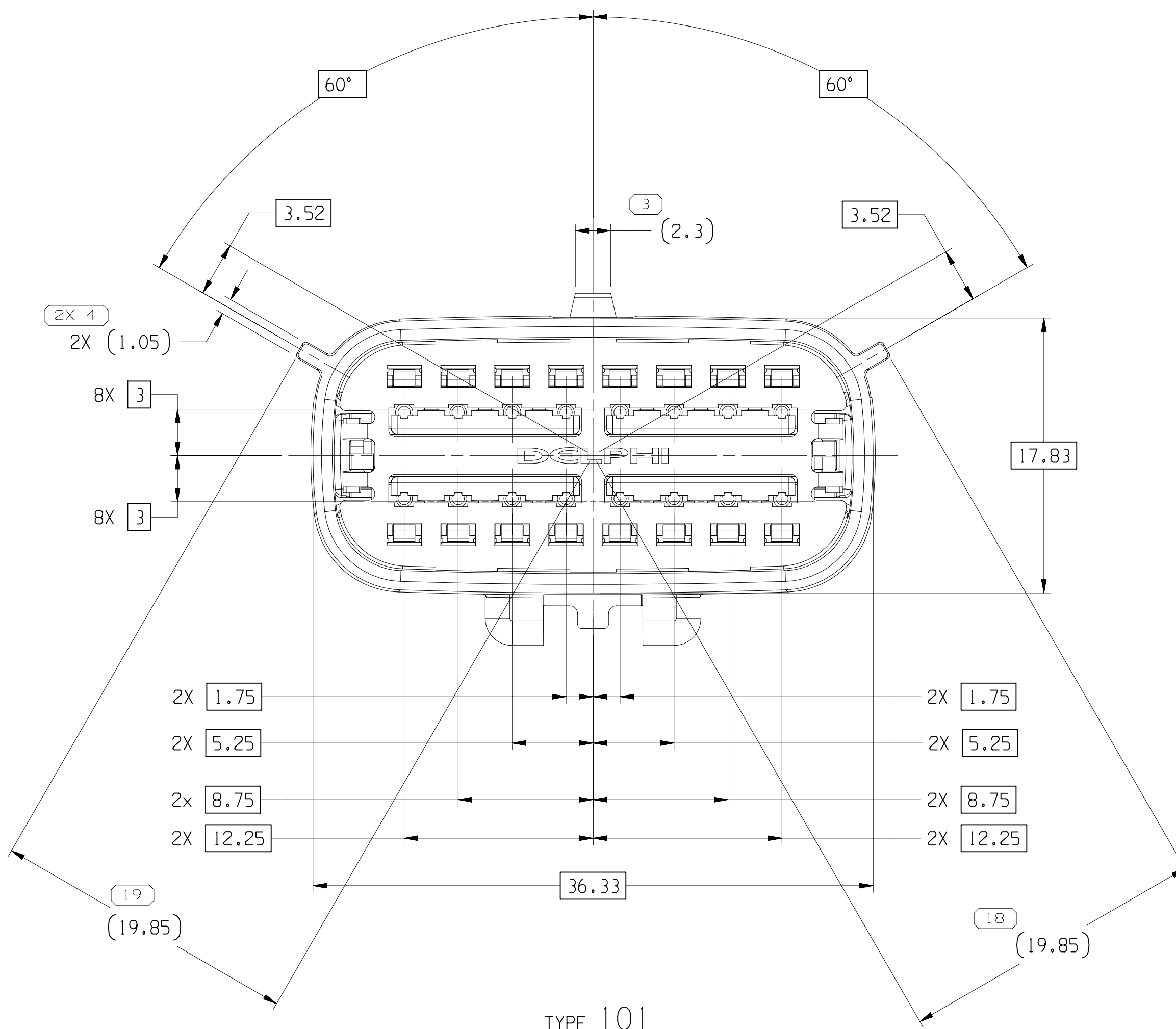
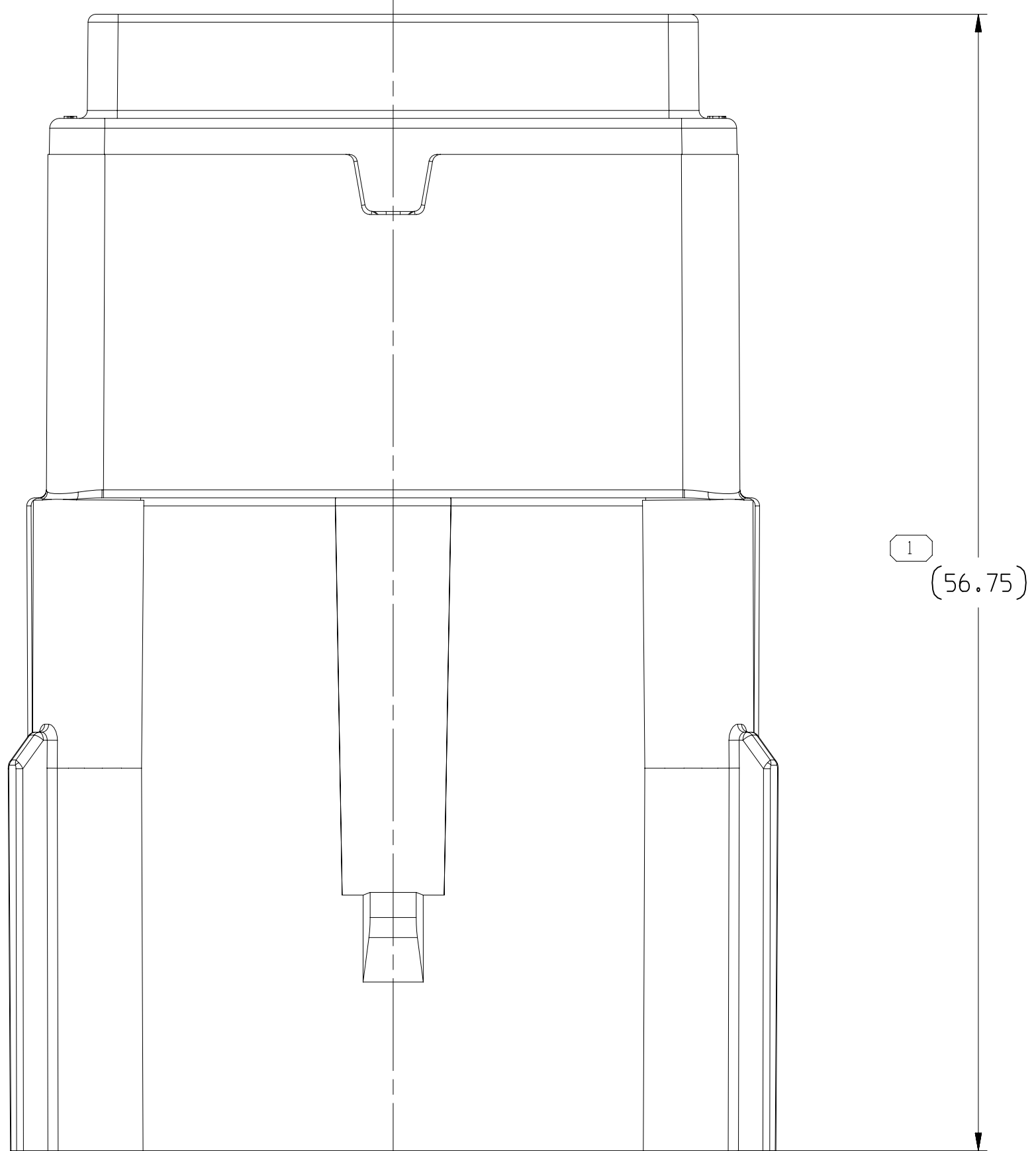

TYPE 101

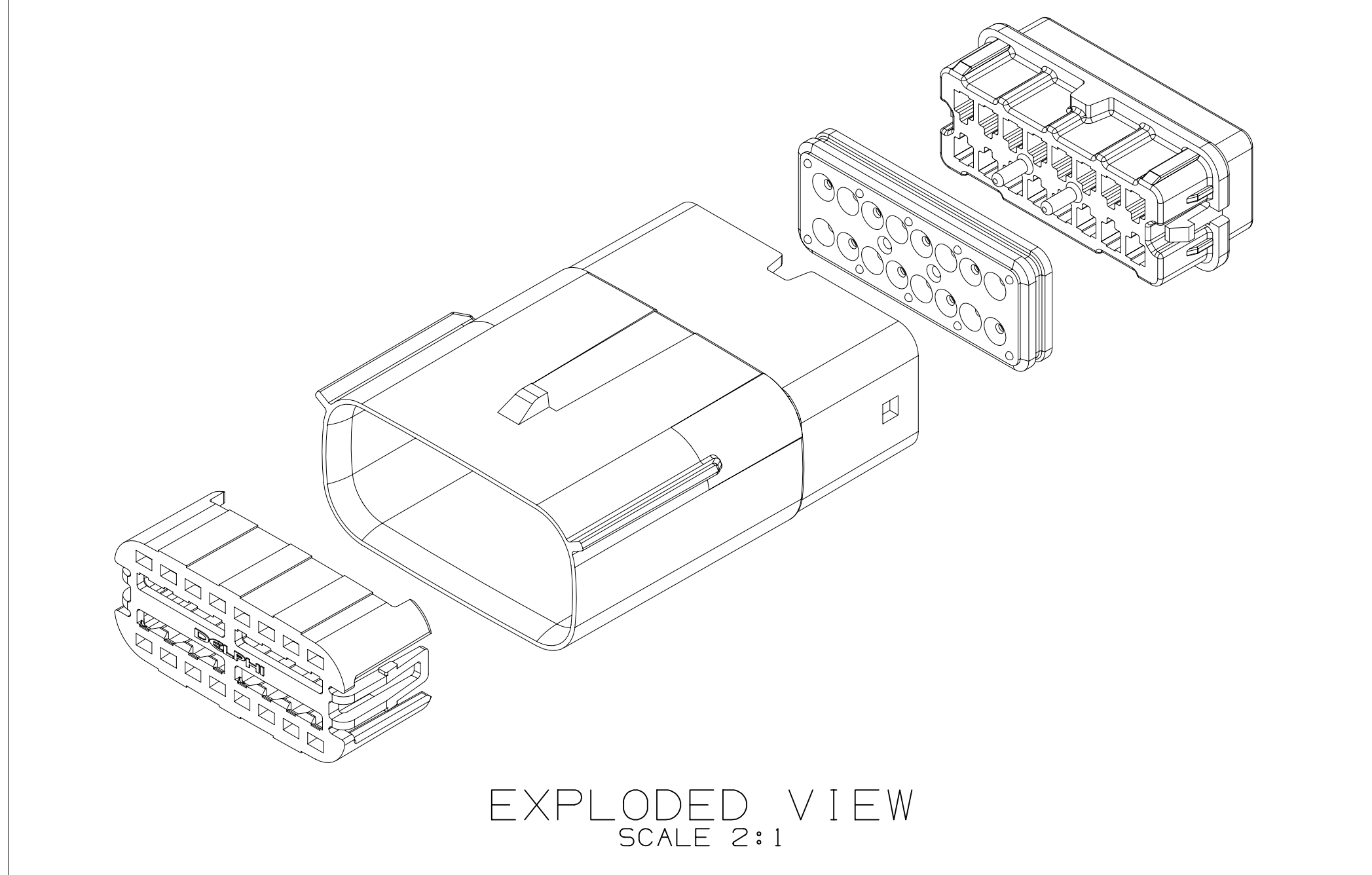

EXPLODED VIEW  
SCALE 2:1

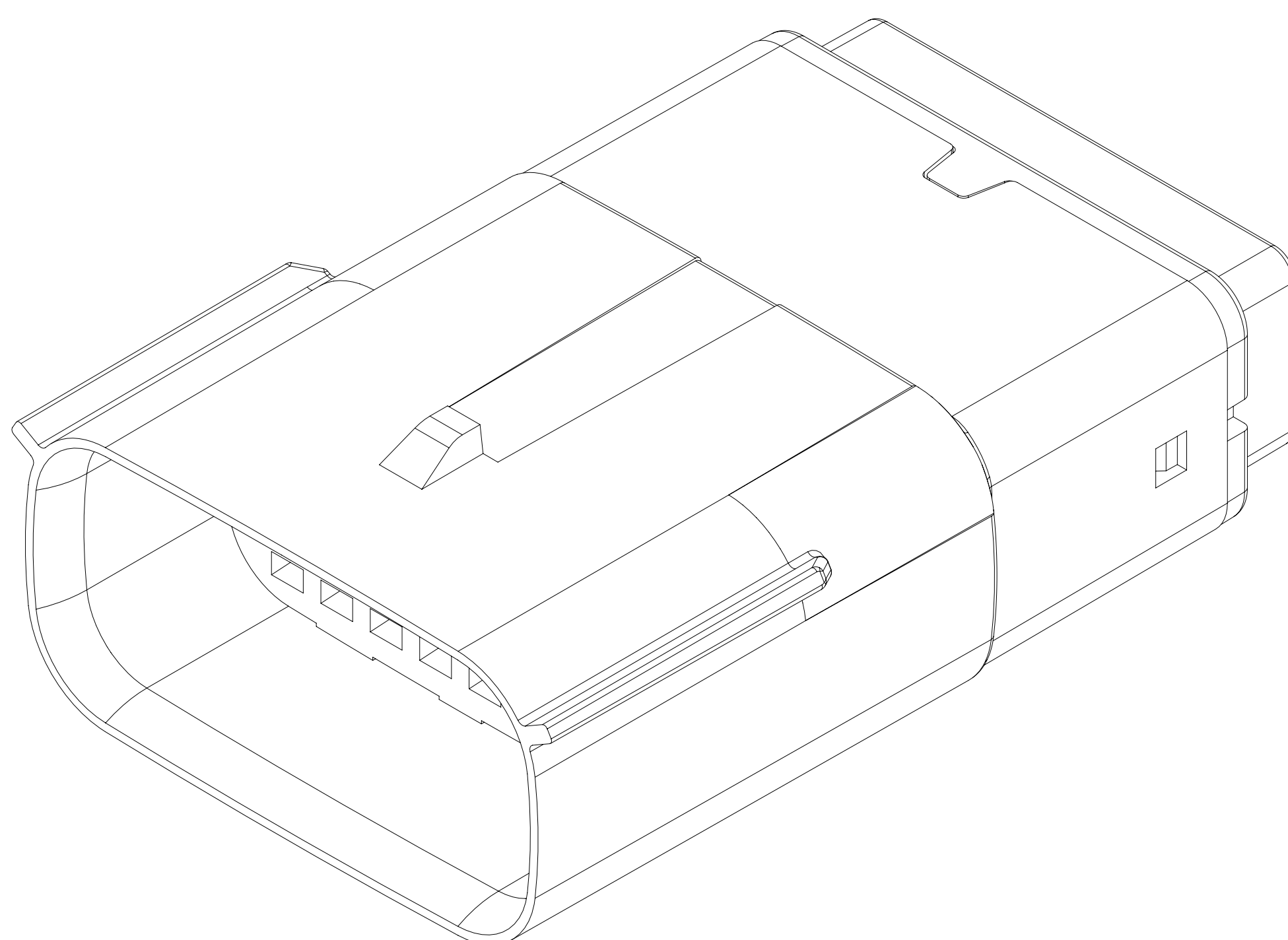

SYMBOL DEFINITION		MISSING SYMBOLS	
A DIMENSION WITHOUT AN INSPECTION REPORT SYMBOL ○ DOES NOT REQUIRE INSPECTION. IT MAY BE CONTROLLED ON THE INDIVIDUAL COMPONENT DRAWING.	TOTAL NO. OF INSPECTIONS REQUIRED	24	NO MISSING SYMBOL NUMBER
	LAST NO. USED	23	

DWG STATUS			ZONE		REVISION HISTORY		AUTH		DR		APPROV	
DATE	STO	REV	N/P	CHK								
15FEB17	R	01	-	-		ALL PARTS - RELEASED RETAINER DRAWING	435542	AHO	AHO	JIE		
21JAN17	R	02	-	-		ALL PARTS - UPDATED RETAINER TO LATEST REVISION	437022	JGM	JGM	DAT		
02FEB18	R	03	-	-		ALL PARTS - REMOVED "ACCEPT CABLE" NOTE; 35021687 - (2.3) WAS 2.3; 2X (11.05) WAS 2X (1.05 +/- 0.05; (18.6) WAS 18.6; (10.5) WAS 10.5; (12.9) WAS 12.9; (2) WAS 2; 35021688 - (19.85) WAS 19.85 +/- 0.1/-0.2 AND (15.62) WAS 15.62 +/- 0.1/-0.2; 35021689 - (15.62) WAS 15.62 +/- 0.1/-0.2 AND (19.85) WAS 19.85 +/- 0.1/-0.2; 35021690 - (15.62) WAS 15.62 +/- 0.1/-0.2 AND (19.85) WAS 19.85 +/- 0.1/-0.2 (2 PLCS); 35021691 - (17.89) WAS 17.89 +/- 0.1/-0.2 (2 PLCS); 35021692 - (19.85) WAS 19.85 +/- 0.1/-0.2 AND (17.89) WAS 17.89 +/- 0.1/-0.2	438922	LXA	GGD	ACV		
07JAN19	R	04	-	-		ALL PARTS - ADDED "PUNCH PATTERN CONFIGURATIONS" - ASSEMBLES WITH 7MM AND "MINIMUM RETAINER DISENGAGE FORCE" NOTES	443301	JLL	JAN	ACV		
05OCT20	R	05	-	-		35021688 - UPDATED PART AVAILABILITY	552642	AHY	JAN	SV		

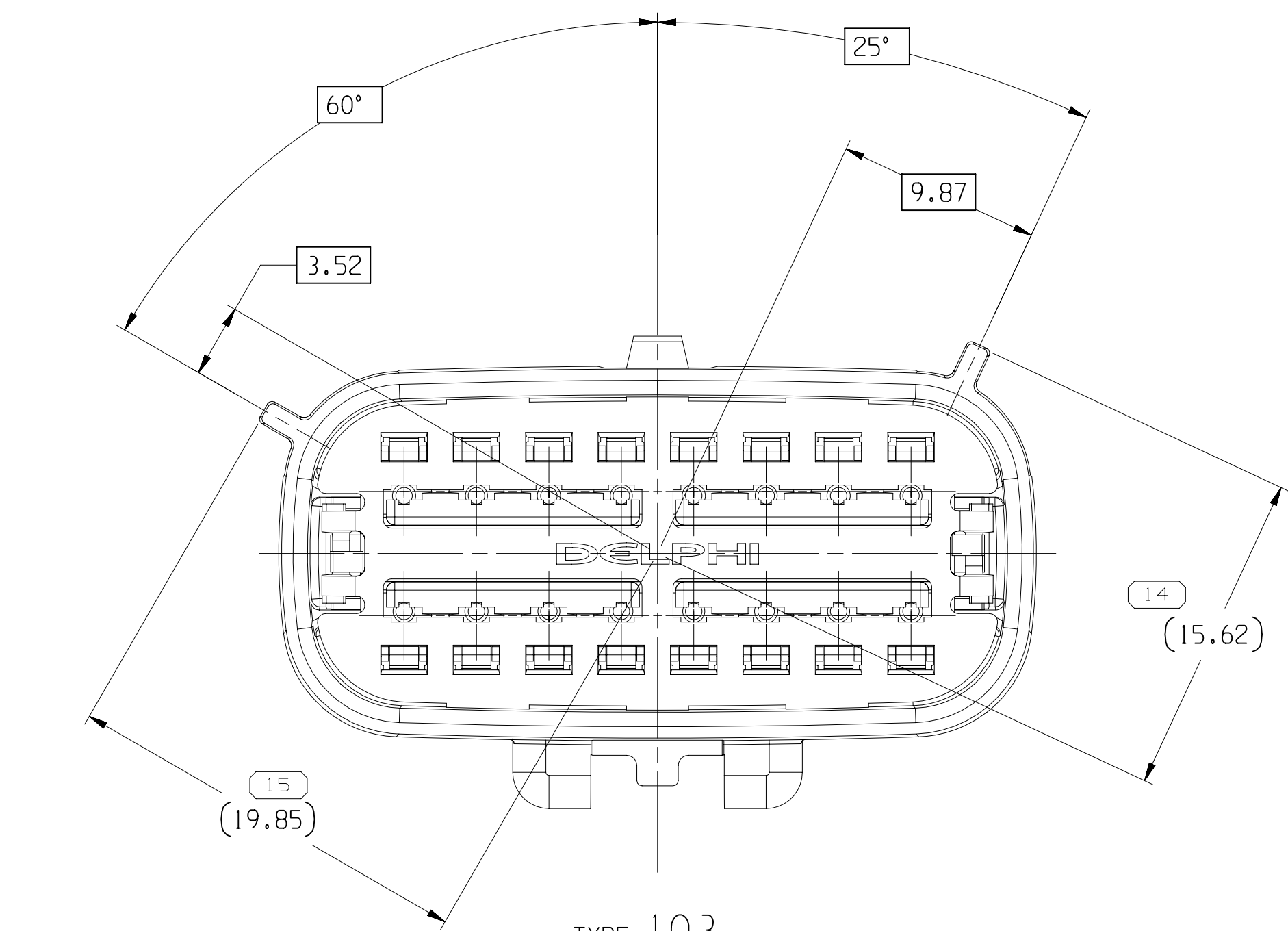

TYPE 103  
SAME AS TYPE 101  
EXCEPT AS SHOWN

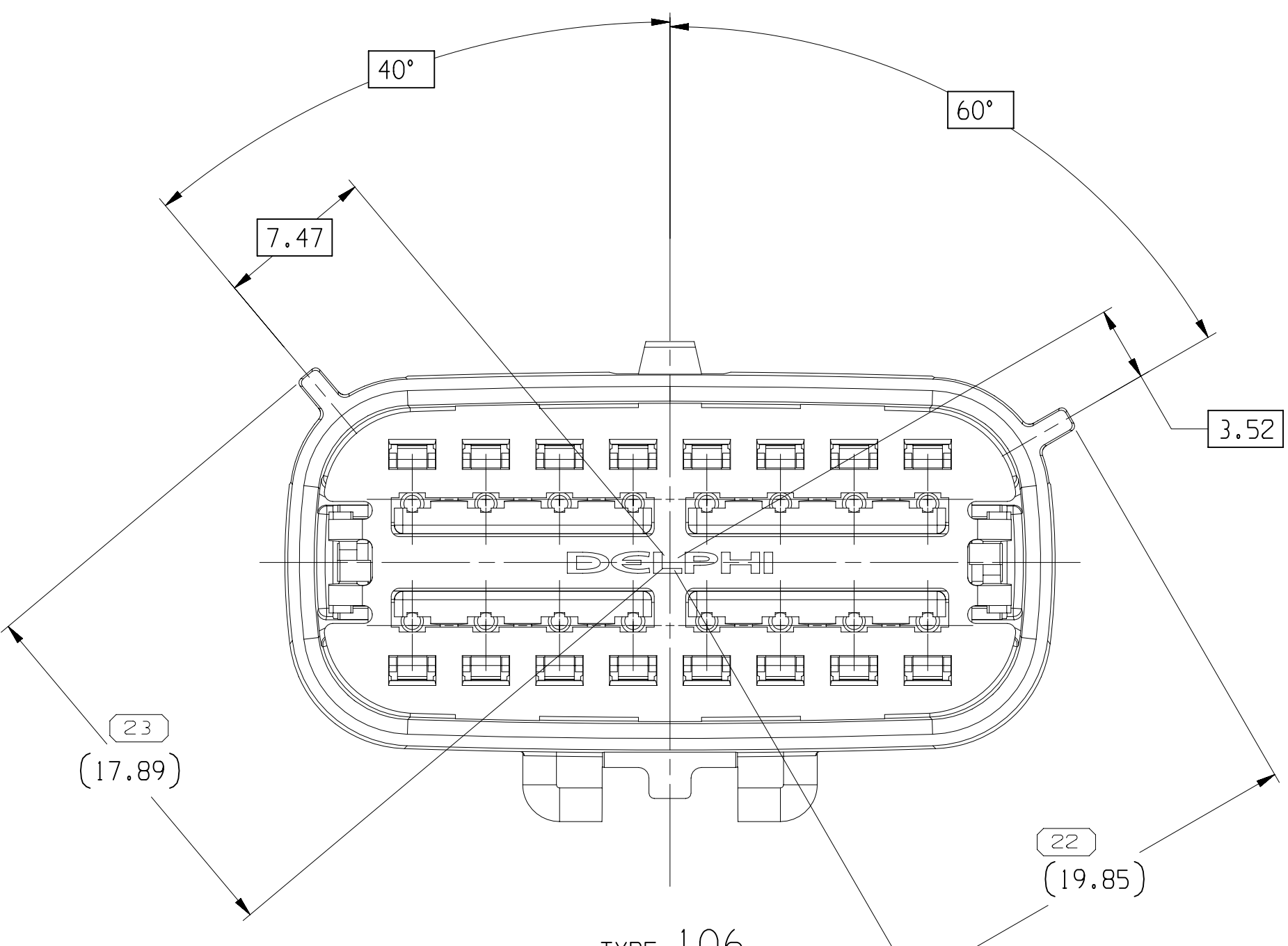

TYPE 106  
SAME AS TYPE 101  
EXCEPT AS SHOWN

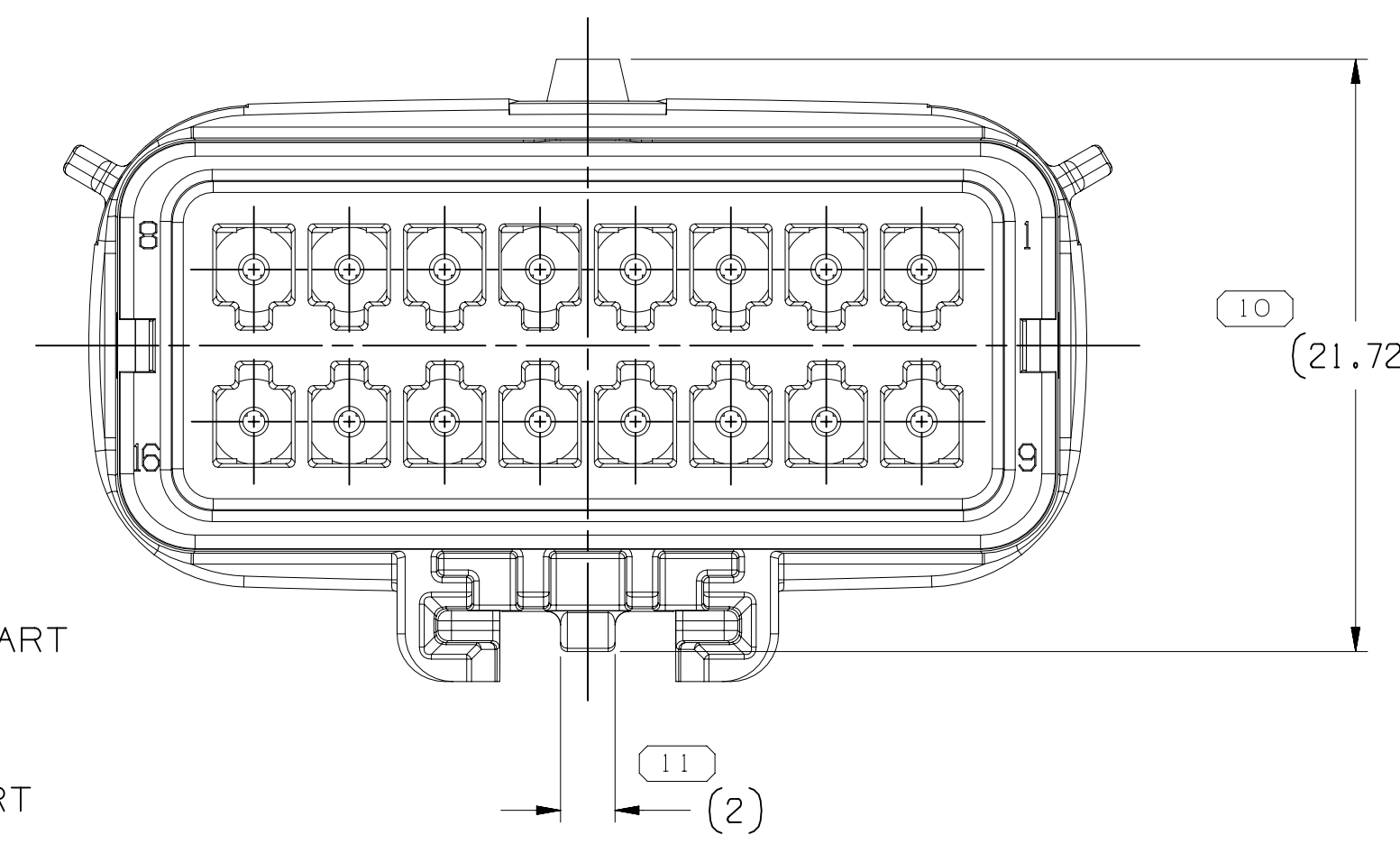
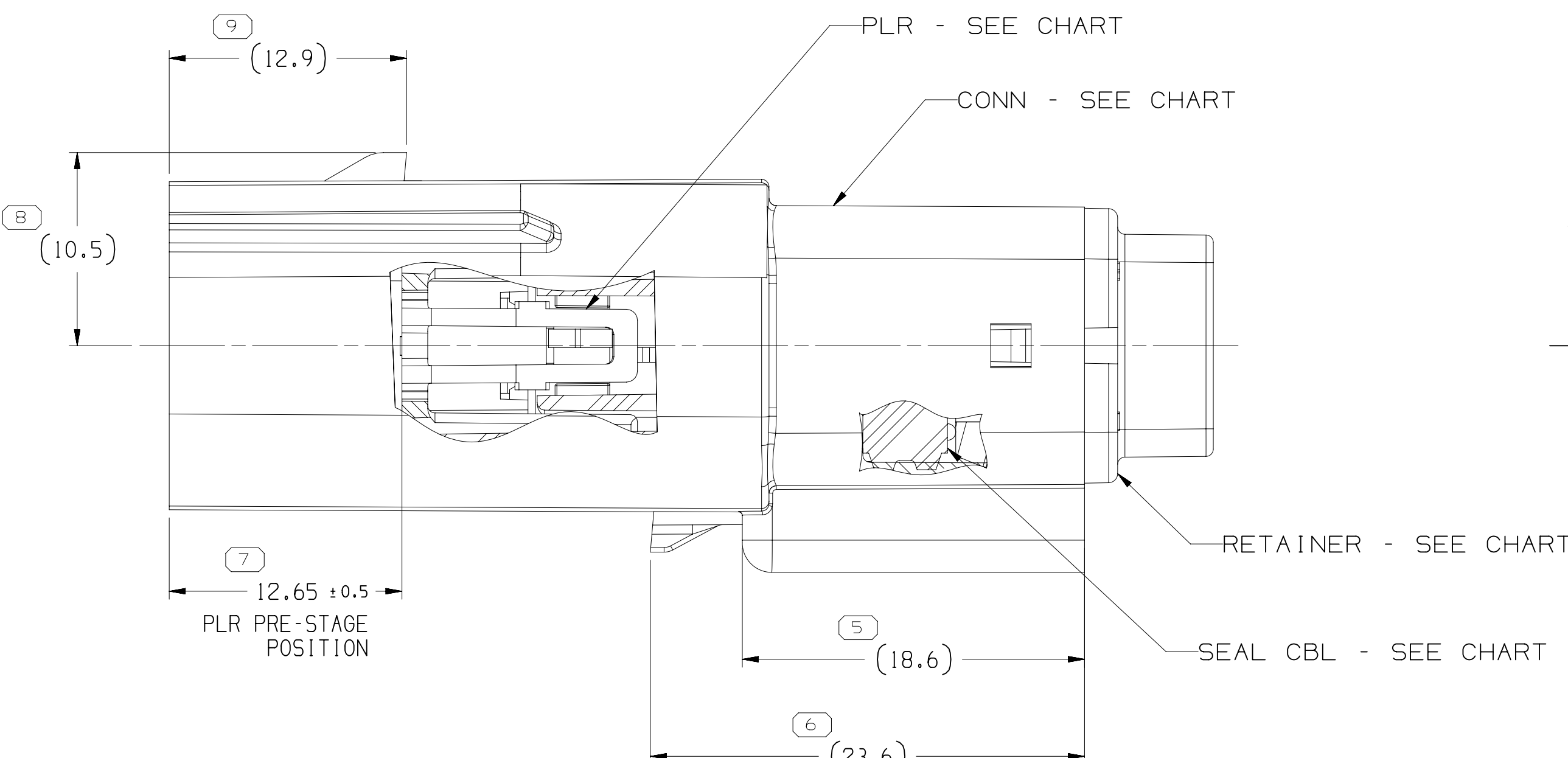

#### NOTES

- UNLESS OTHERWISE SPECIFIED AND/OR INDICATED:  
DIMENSIONS ARE TO FACE OF VIEW SHOWN AND AUTOMATICALLY ROUNDED BY COMPUTER FOR INSPECTION (SEE MATH MODEL FOR PRECISE DIMENSIONS). FOR ALL OTHER DIMENSIONS NOT SHOWN BUT REQUIRED FOR TOOL BUILD, SEE MATH MODEL FOR PRECISE TOOL PATH DATA.
- THIS PRODUCT IS NOT CATEGORIZED AS AN APPEARANCE ITEM. MINOR IMPERFECTIONS INCLUDING, BUT NOT LIMITED TO, FLOW MARKS, COLOR BLEMMISHES, GATE VESTIGE, AND SOFT FLASH THAT DO NOT AFFECT THE FIT, FORM, OR FUNCTION OF THE PART ARE PERMISSIBLE PER ENP-4-3.CS.01-EN.
- PART IS MANUFACTURED TO GEOMETRIC TOLERANCES. CENTERLINE DIMENSIONS ARE FOR REFERENCE ONLY.
- SEALING CODE 4 - DESIGN WILL MEET REQUIREMENTS OF SAE/USCAR-2 CONNECTOR SYSTEM ENVIRONMENTAL TEST FLOWCHART (PRESSURE/VACUUM AND SUBMERSION).
- FOR APPLICATION DATA SEE THE INDIVIDUAL APPLICATION DRAWINGS.
- FOR DIFFERENT PUNCH PATTERN CONFIGURATIONS (IF AVAILABLE) SEE SHEET 2.
- FOR ASSEMBLIES WITH 7MM CLIP SLOT SEE DRAWING 15521026.
- MINIMUM RETAINER DISENGAGE FORCE: 60N.

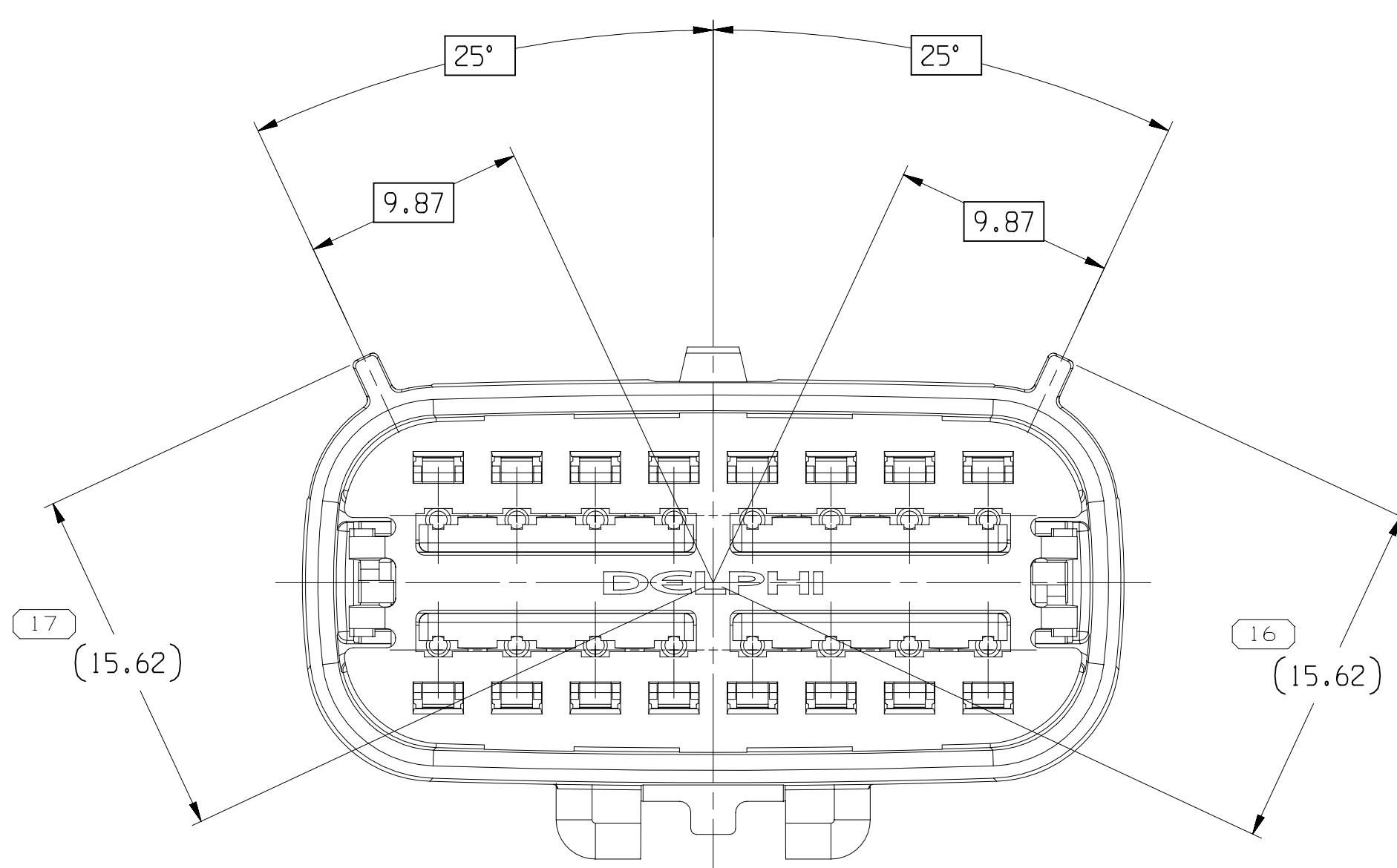

TYPE 104  
SAME AS TYPE 101  
EXCEPT AS SHOWN

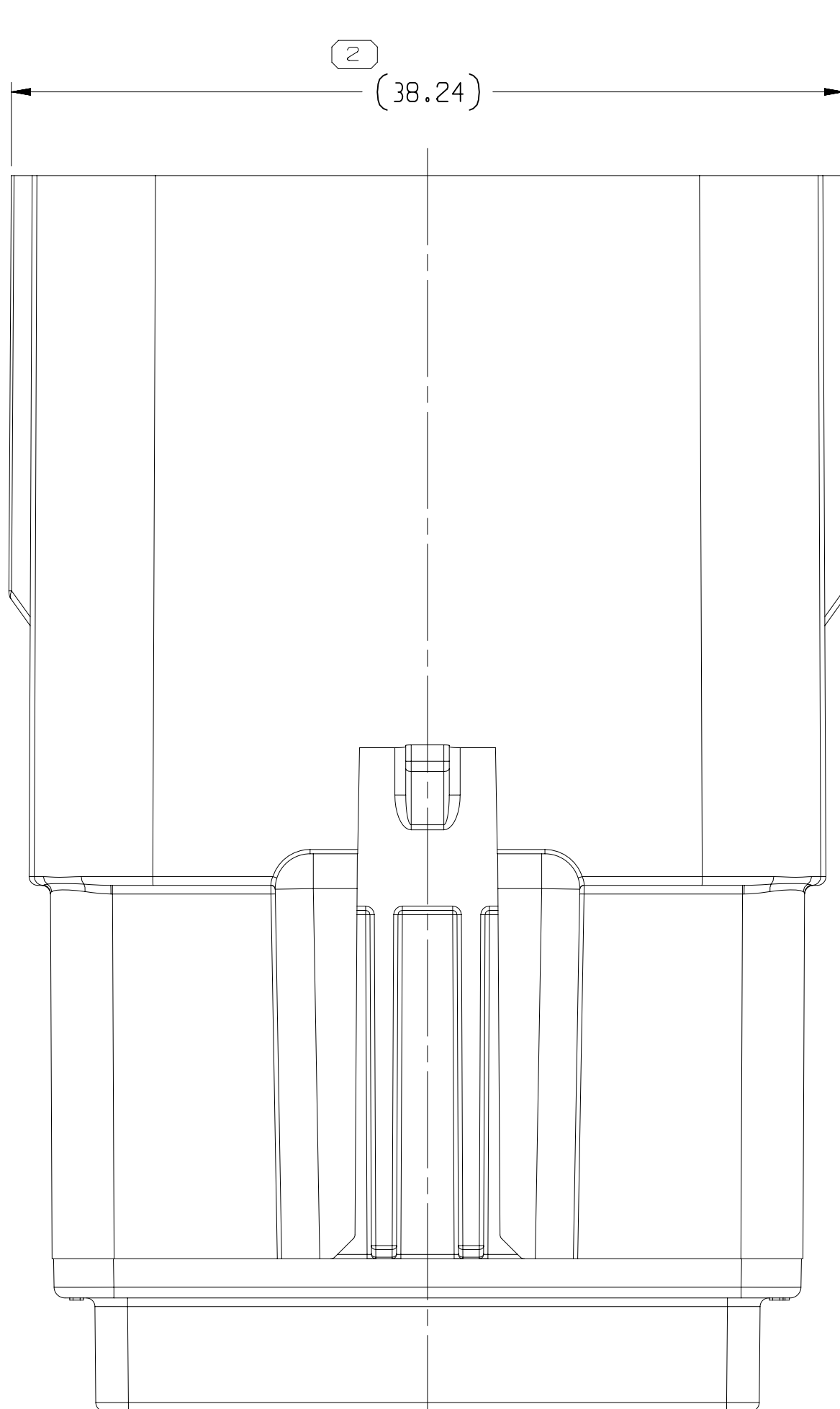

35021692	01	AC	106	35021695	15521010	15514457	15521007	F
35021691	01	AC	105	35021684	15521010	15514457	15521007	E
35021690	01	AC	104	35021683	15521010	15514457	15521007	D
35021689	01	AC	103	35021682	15521010	15514457	15521007	C
35021688	01	AD	102	35021681	15521010	15514457	15521007	B
35021687	01	AC	101	35021680	15521010	15514457	15521007	A
PART NO	REV	N/P	TYPE	MALE CONN	PLR	RETAINER	SEAL CBL	USCAR KEY OPTION

(N/A) PROCESS SENSITIVE DIMENSION

DIMENSIONAL RANGE (MM)													CHART E	
FROM	> 0	> 20	> 30	> 70	> 100	> 150	> 200	> 250	> 300	> 400				
TO	20	30	70	100	150	200	250	300	400					
TOLERANCE UNLESS OTHERWISE SPECIFIED														
	±0.15	±0.2	±0.3	±0.4	±0.5	±0.6	±0.8	±1	±1.2					