

SECTION B-B

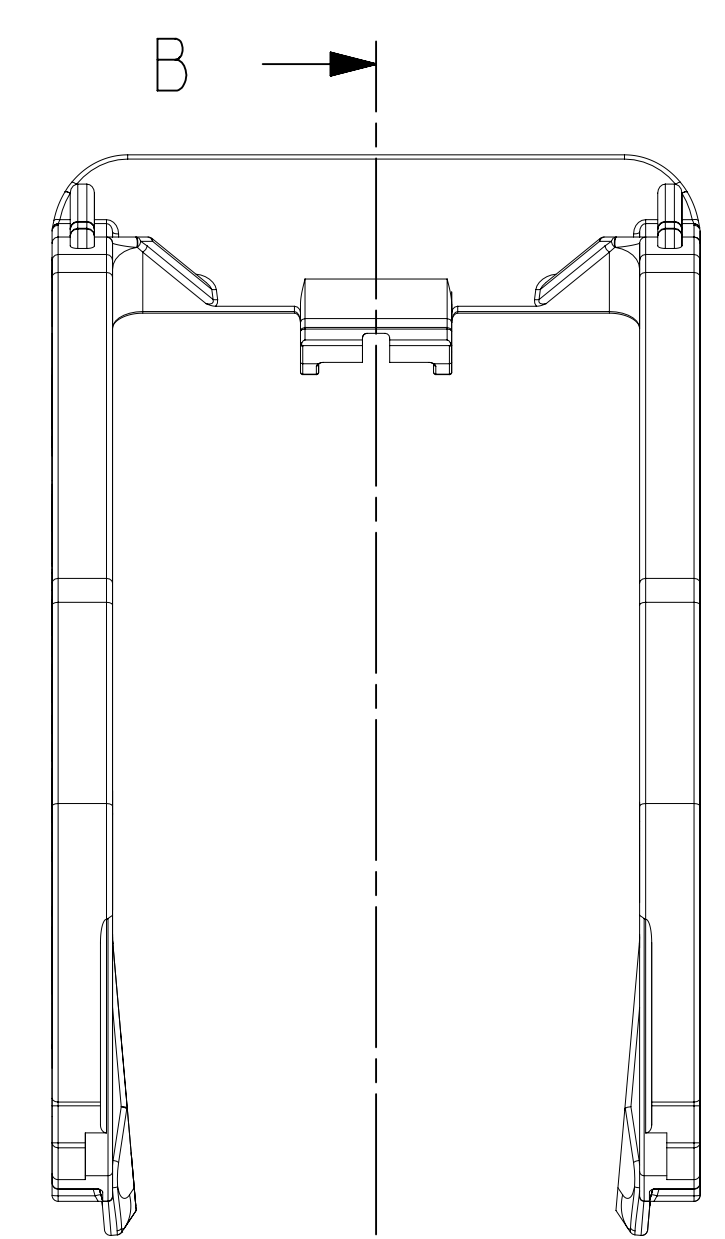

TYPE 102
SAME AS TYPE 101
EXCEPT AS SHOWN

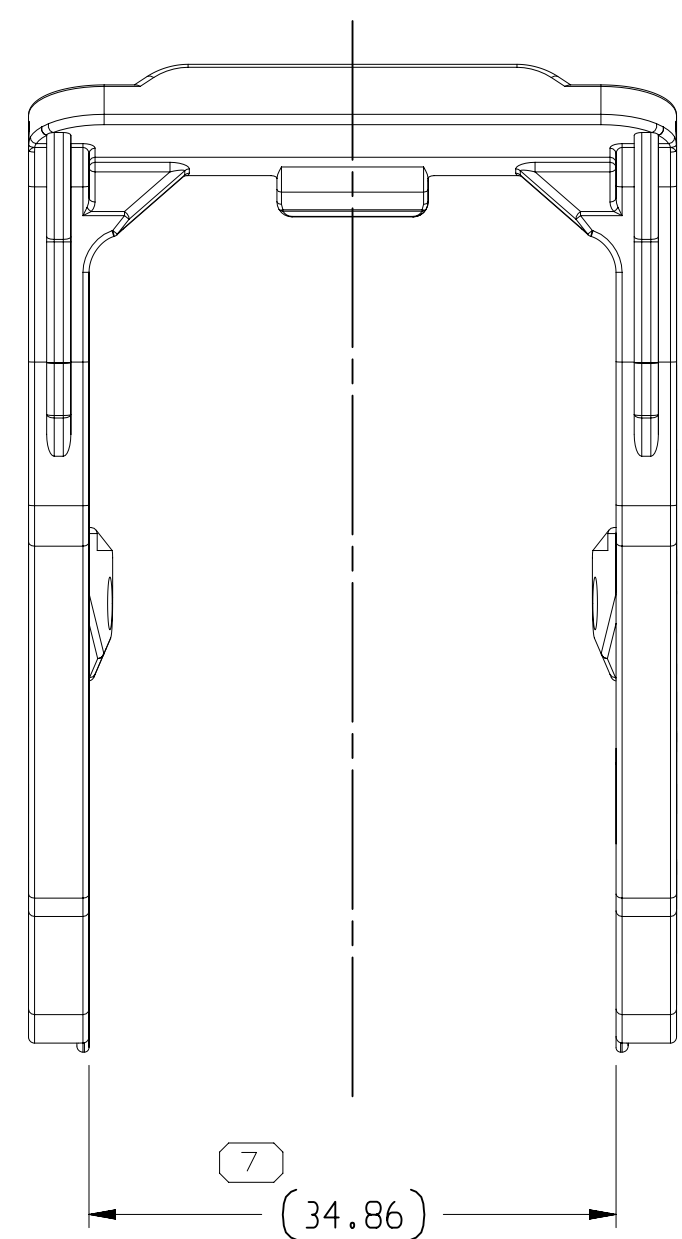

TYPE 101

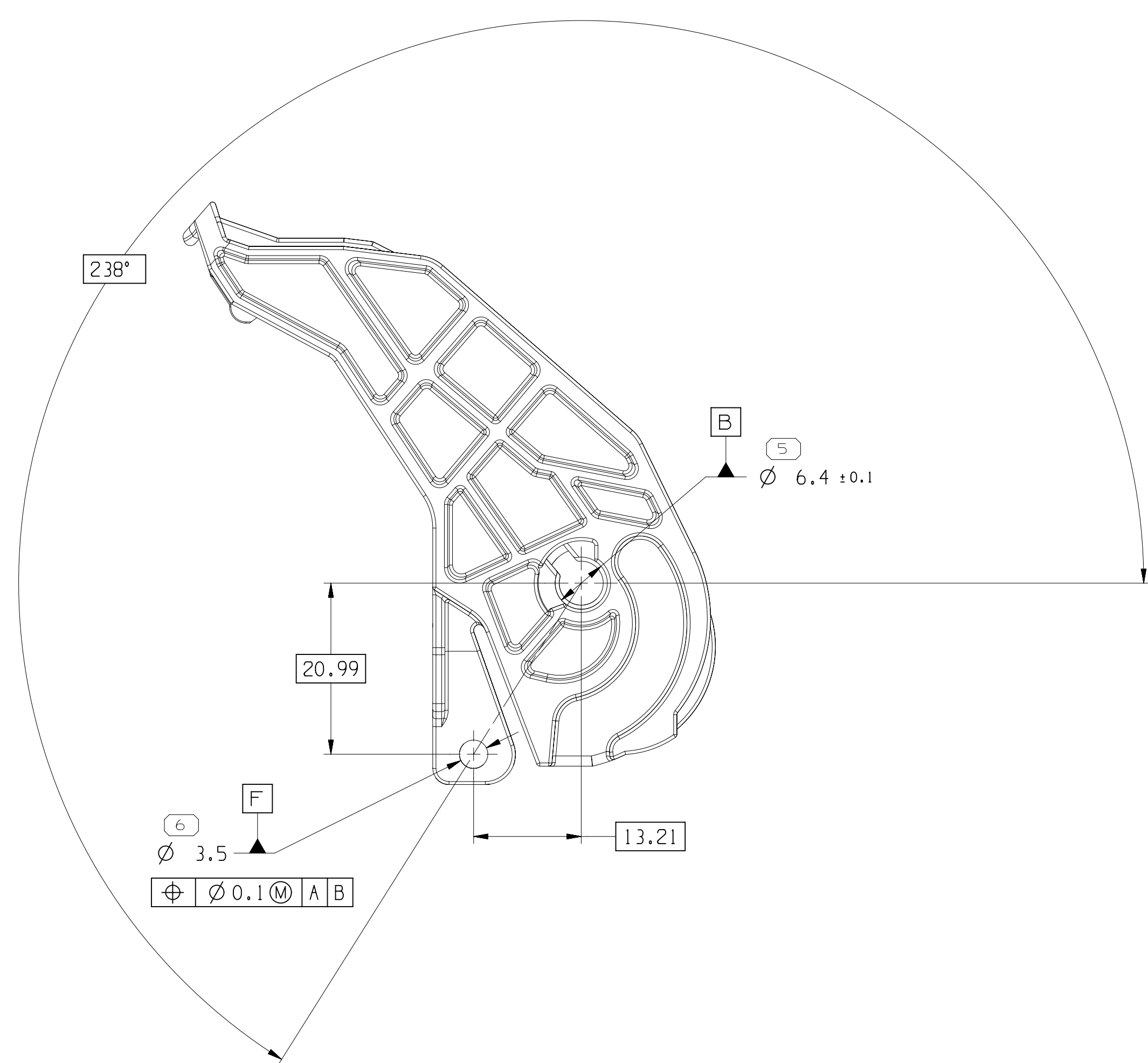
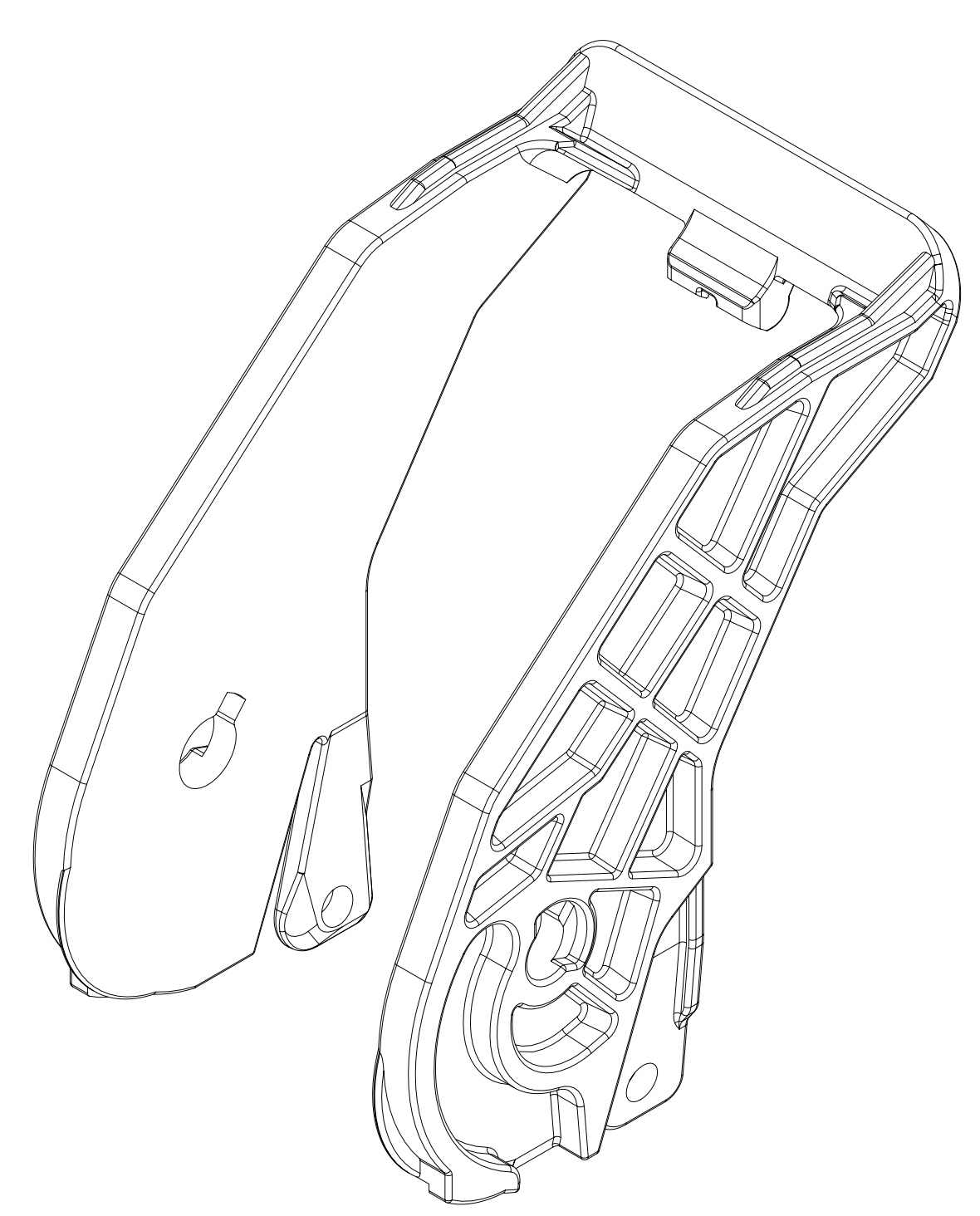

SECTION A-A

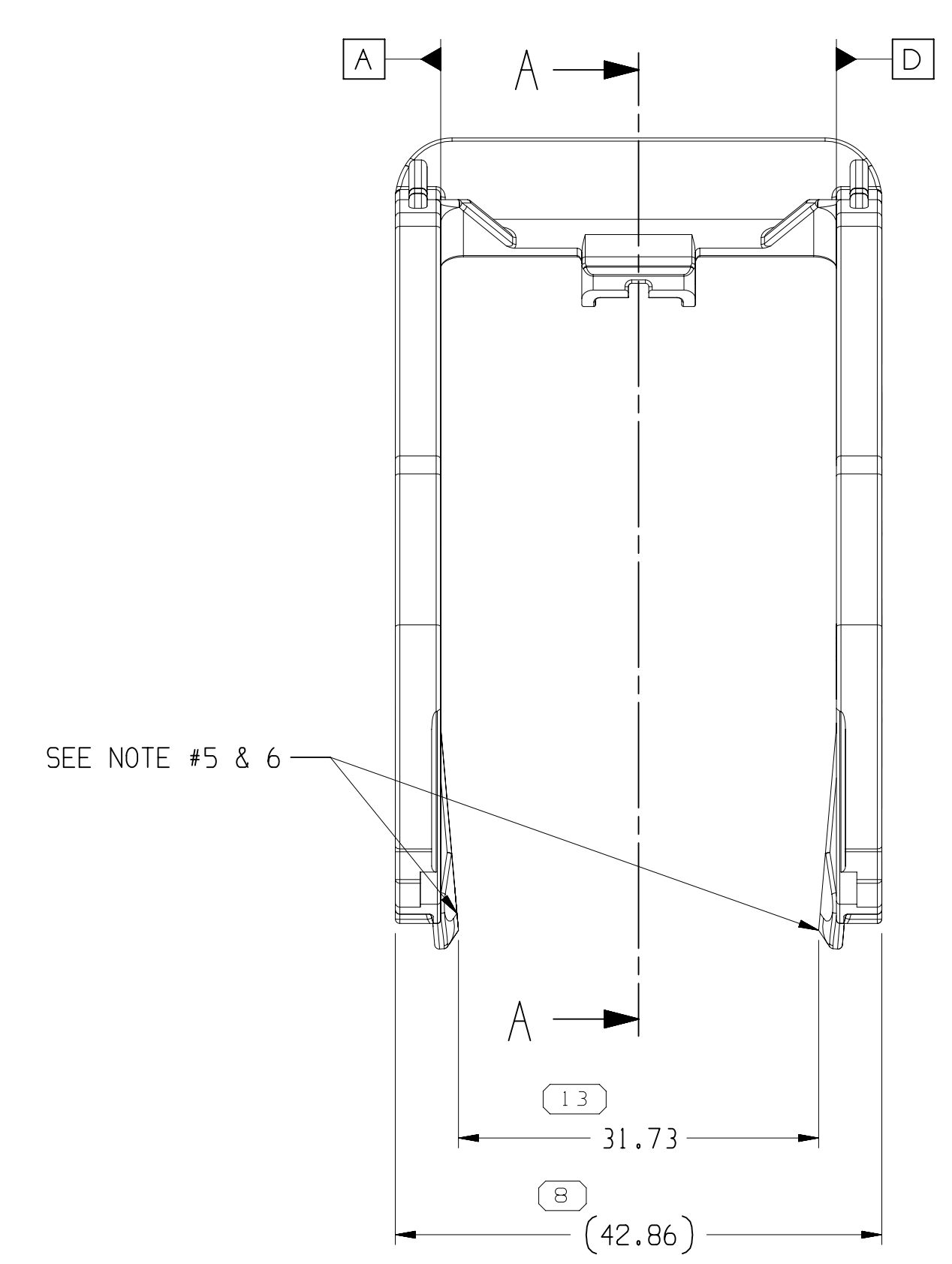

SEE NOTE #5 & 6

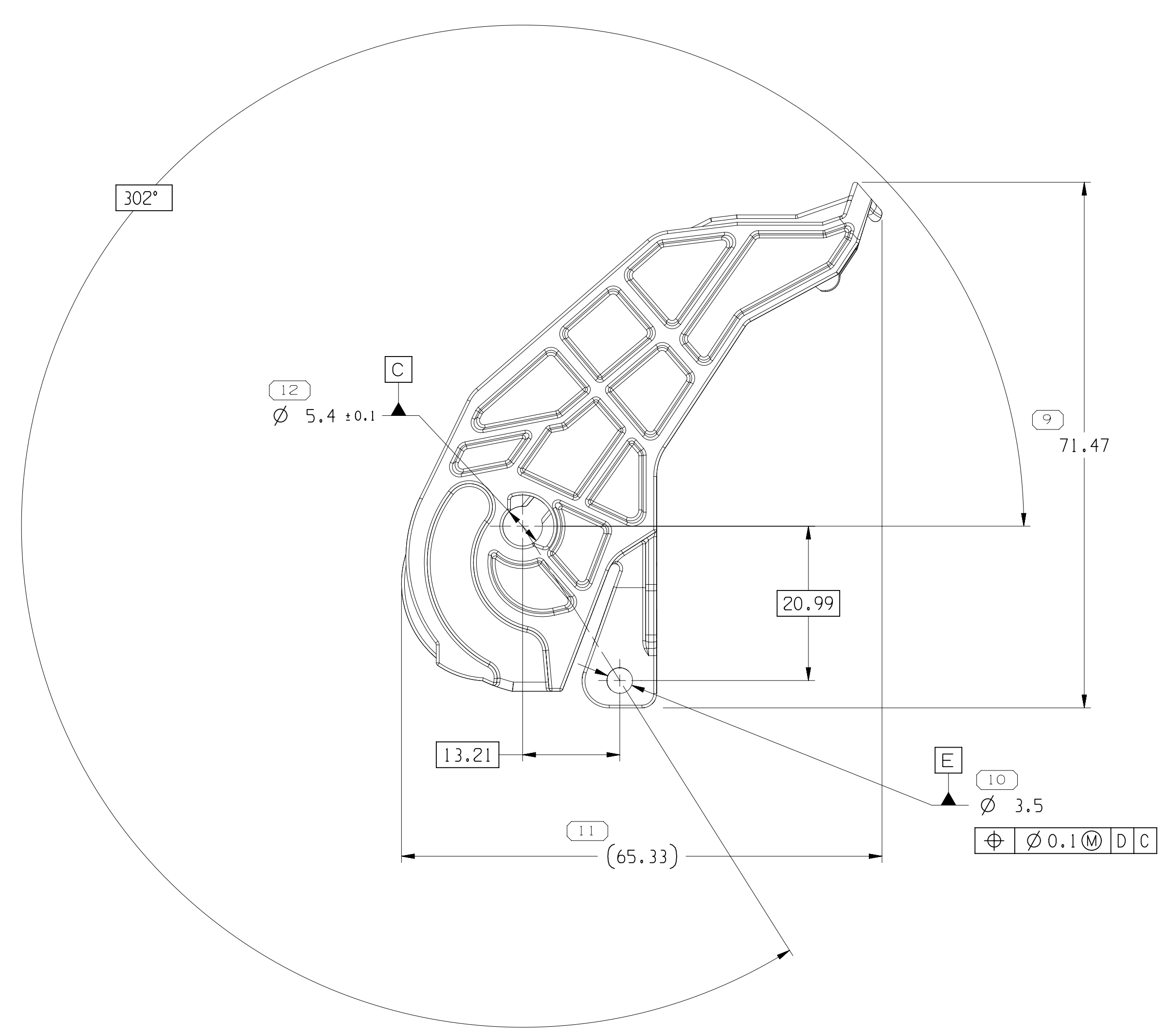

NOTES

- UNLESS OTHERWISE SPECIFIED AND/OR INDICATED:
DIMENSIONS ARE TO FACE OF VIEW SHOWN AND AUTOMATICALLY ROUNDED BY COMPUTER FOR INSPECTION (SEE MATH MODEL FOR PRECISE DIMENSIONS). FOR ALL OTHER DIMENSIONS NOT SHOWN BUT REQUIRED FOR TOOL BUILD, SEE MATH MODEL FOR PRECISE TOOL PATH DATA.
- THIS PRODUCT IS NOT CATEGORIZED AS AN APPEARANCE ITEM, MINOR IMPERFECTIONS INCLUDING, BUT NOT LIMITED TO, FLOW MARKS, COLOR BLEMISHES, GATE VESTIGES, AND SOFT FLASH THAT DO NOT AFFECT THE FIT, FORM, OR FUNCTION OF THE PART ARE PERMISSIBLE PER EAMP.4-3-CS-01-EN.
- REFERENCE MATING COMPONENTS OR EQUIVALENT:
CONNECTOR - SEE CHART
- CORPORATE BRAND TO BE APPLIED TO PRODUCT DESIGN PER THE LATEST REVISION OF ESD S1085201.
- WARPAGE IS PERMISSIBLE IN THE AREA OF LEGS; MAX 3.5 MM.
- PART CAN BE RESTRICTED WITH FIXTURE TO BE MEASURED.

| | | | | | | |
|----------|-----|-----|------|----------------------------------|---------------------|--------------|
| 35294083 | 02 | AA | 102 | POLYAMIDE COMPOUND BLUE | 33371910 & 35264616 | 10.128 |
| 35294082 | 02 | AA | 101 | POLYAMIDE COMPOUND GREEN | 33371909 & 35264615 | 10.147 |
| PART NO | REV | N/P | TYPE | MATERIAL SPECIFICATION AND COLOR | MATING CONNECTOR | VOLUME (CM³) |

| | | |
|--|--|----|
| DIMENSIONAL RANGE (MM) | CHART | ET |
| FROM TO | > 0 > 20 > 30 > 70 > 100 > 150 > 200 > 250 > 300 > 400 | |
| TOLERANCE (UNLESS OTHERWISE SPECIFIED) | | |
| ANGULAR TOLERANCE | ± 2° | |

| | | |
|------------------------|--------------|---------------|
| THIRD ANGLE PROJECTION | DO NOT SCALE | USE MATH DATA |
|------------------------|--------------|---------------|

APTIV

CONNECTION SYSTEMS

WARREN, OH

COPYRIGHT 2019 APTIV. ALL RIGHTS RESERVED.

THIS DRAWING IS THE PROPERTY OF APTIV AND CONTAINS APTIV CONFIDENTIAL INFORMATION. THE REPRODUCTION, DISTRIBUTION AND UTILIZATION OF THIS DOCUMENT OR ITS RELATED CAD DATA, AS WELL AS COMMUNICATION OF ANY CONTENT TO OTHERS, WITHOUT EXPRESS AUTHORIZATION, IS PROHIBITED.

| | |
|-------------------------|--------|
| DR | DATE |
| APV01 JESSICA GARCIA M. | 24JA19 |
| APV02 JESSICA GARCIA M. | 24JA19 |
| APV03 R. NARRO | 25JA19 |
| APV04 | |
| APV05 | |

SUBSTANCES OF CONCERN AND RECYCLED CONTENT PER APTIV 10949001

MATERIAL: SEE CHART

DRAWING NAME: TAXI MOUN LEVER

DRAWING NUMBER: 35294084

SIZE: A0

SCALE: 2:1

FRAME NO: 1

SHEET NO: 1 OF 2

STG: R 03

REV: N/P

| SYMBOL DEFINITION | | | |
|--|--|--|----|
| A DIMENSION WITHOUT AN INSPECTION REPORT SYMBOL DOES NOT REQUIRE INSPECTION. IT MAY BE CONTROLLED ON THE INDIVIDUAL COMPONENT DRAWING. | | | |
| TOTAL NO OF INSPECTIONS REQUIRED | | | 14 |
| LAST NO. USED | | | 13 |

| MISSING SYMBOLS | | | |
|--------------------------|--|--|--|
| NO MISSING SYMBOL NUMBER | | | |

| DWG STATUS | | | | REVISION HISTORY | | | | AUTH | | | |
|------------|-----|-----|-----|------------------|------|---|--|--------|-----|-----|-----|
| DATE | STG | REV | N/P | CHG | ZONE | | | | | | |
| 24JA19 | R | 01 | - | - | | ALL PARTS - RELEASED PART DRAWING | | 441868 | JGM | JGM | RNL |
| 21MR19 | R | 02 | - | - | | 35294082 - MAT'L SPEC WAS POLYAMIDE COMPOUND NATURAL; 35294083 - MAT'L SPEC WAS POLYAMIDE COMPOUND GRAY | | 442734 | ACB | ACB | CGD |
| 27MR19 | R | 03 | - | - | | ALL PARTS - UPDATED PART AVAILABILITY | | 442800 | CGD | CGD | ACB |