

SYMBOL DEFINITION		TOTAL NO OF INSPECTIONS REQUIRED	20
A DIMENSION WITHOUT AN INSPECTION REPORT SYMBOL DOES NOT REQUIRE INSPECTION. IT MAY BE CONTROLLED ON THE INDIVIDUAL COMPONENT DRAWING.		LAST NO. USED	16

MISSING SYMBOLS				NO MISSING SYMBOL NUMBER				REVISION HISTORY				AUTH	DR	APVD	APVD
DATE	STG	REV	N/P	CHG	ZONE										
09NO17	R	01	-	-						ALL PARTS - RELEASED PART DRAWING	436919	NKS	RRR	EH	
14JN18	R	02	-	-						ALL PARTS - REVISED NOTE #03	440094	NKS	NKS	EH	
21SE18	R	03	-	-						ALL PARTS - REVISED GRAPHICS: 35068218 - UPDATED PART AVAILABILITY	441028	SM	RRR	EG	
10AU21	R	04	-	-						35068220 & 21 - UPDATED PART AVAILABILITY	555044	AGC	AGC	CMW	

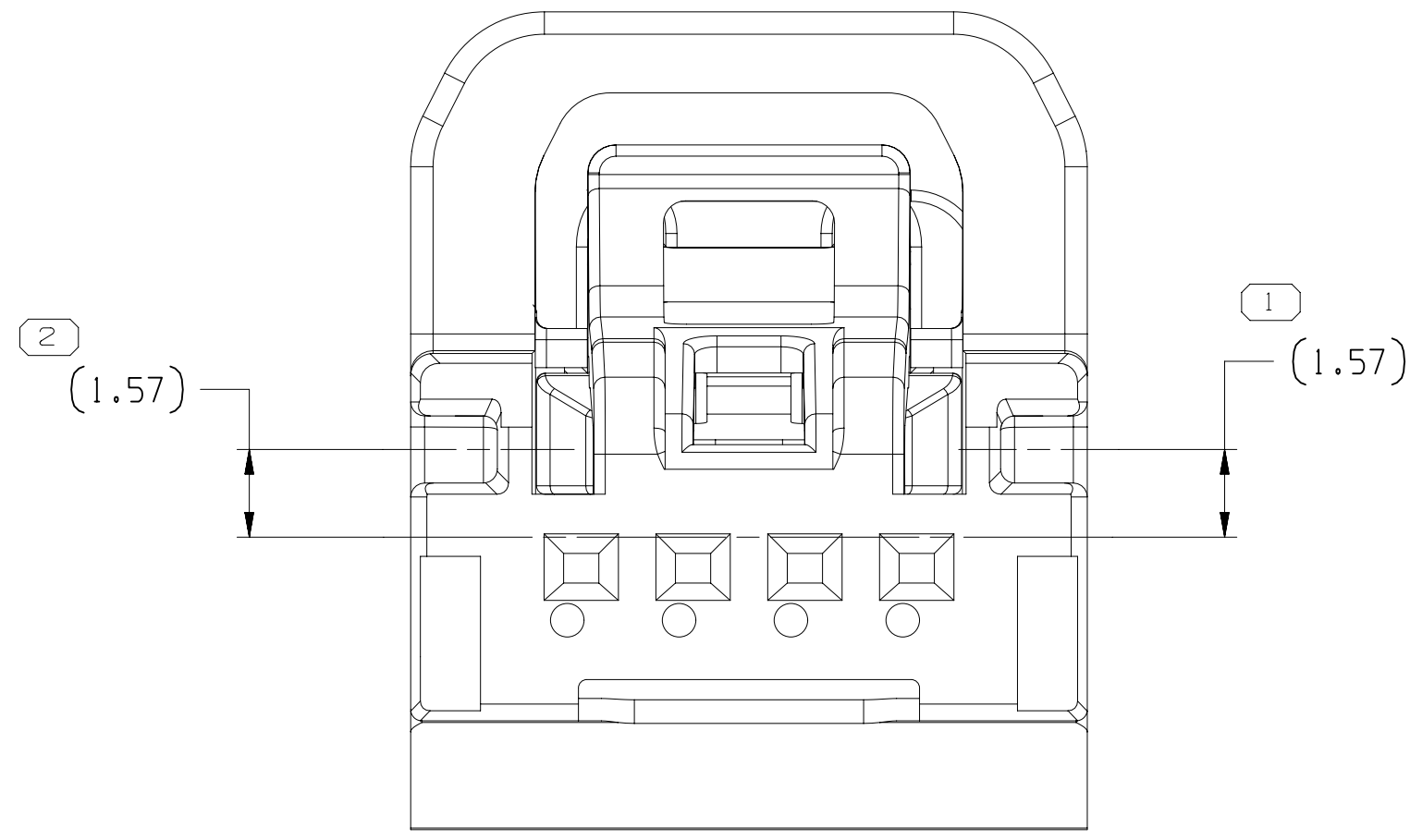

TYPE 102
SAME AS TYPE 101
EXCEPT AS SHOWN

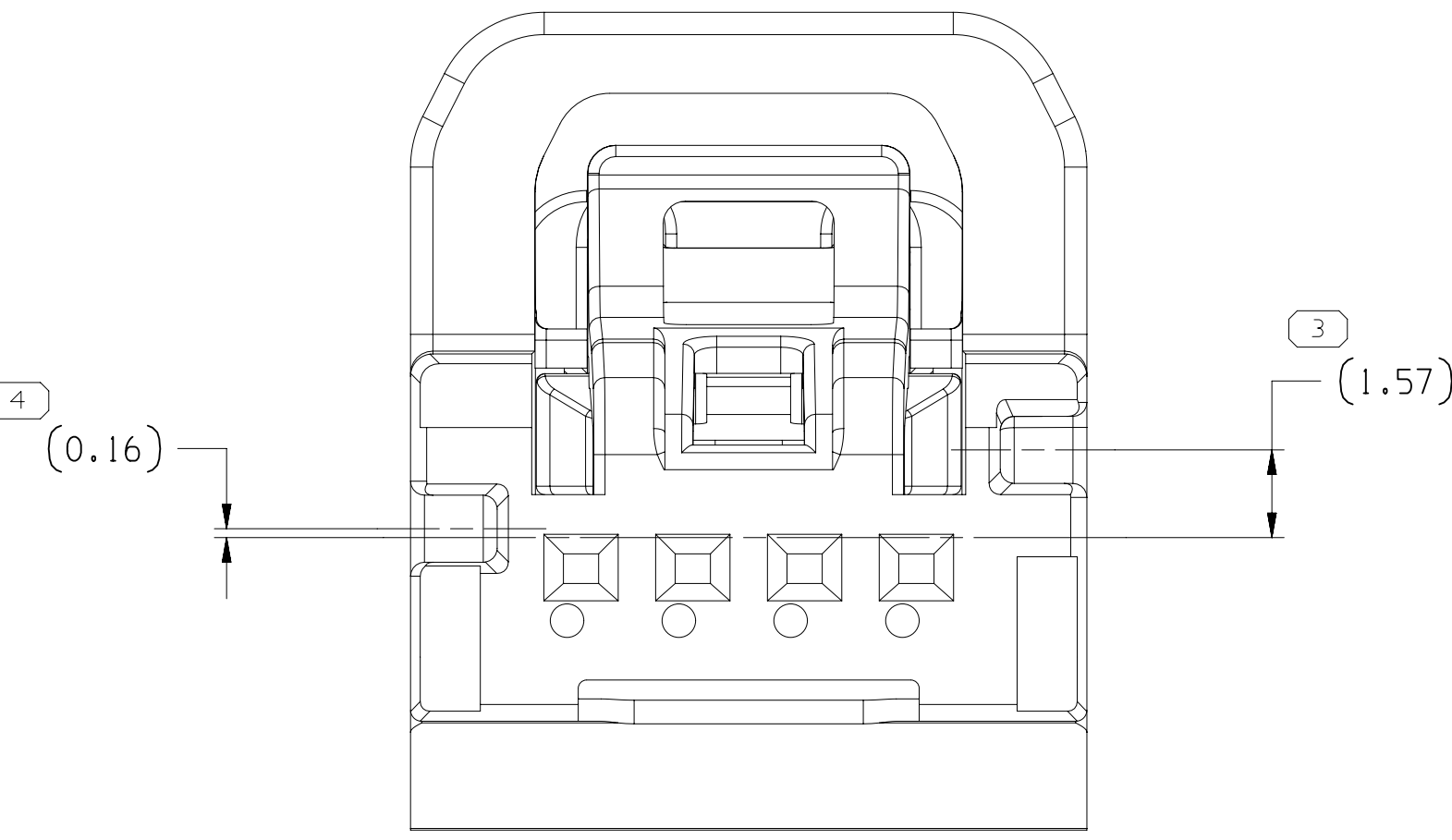
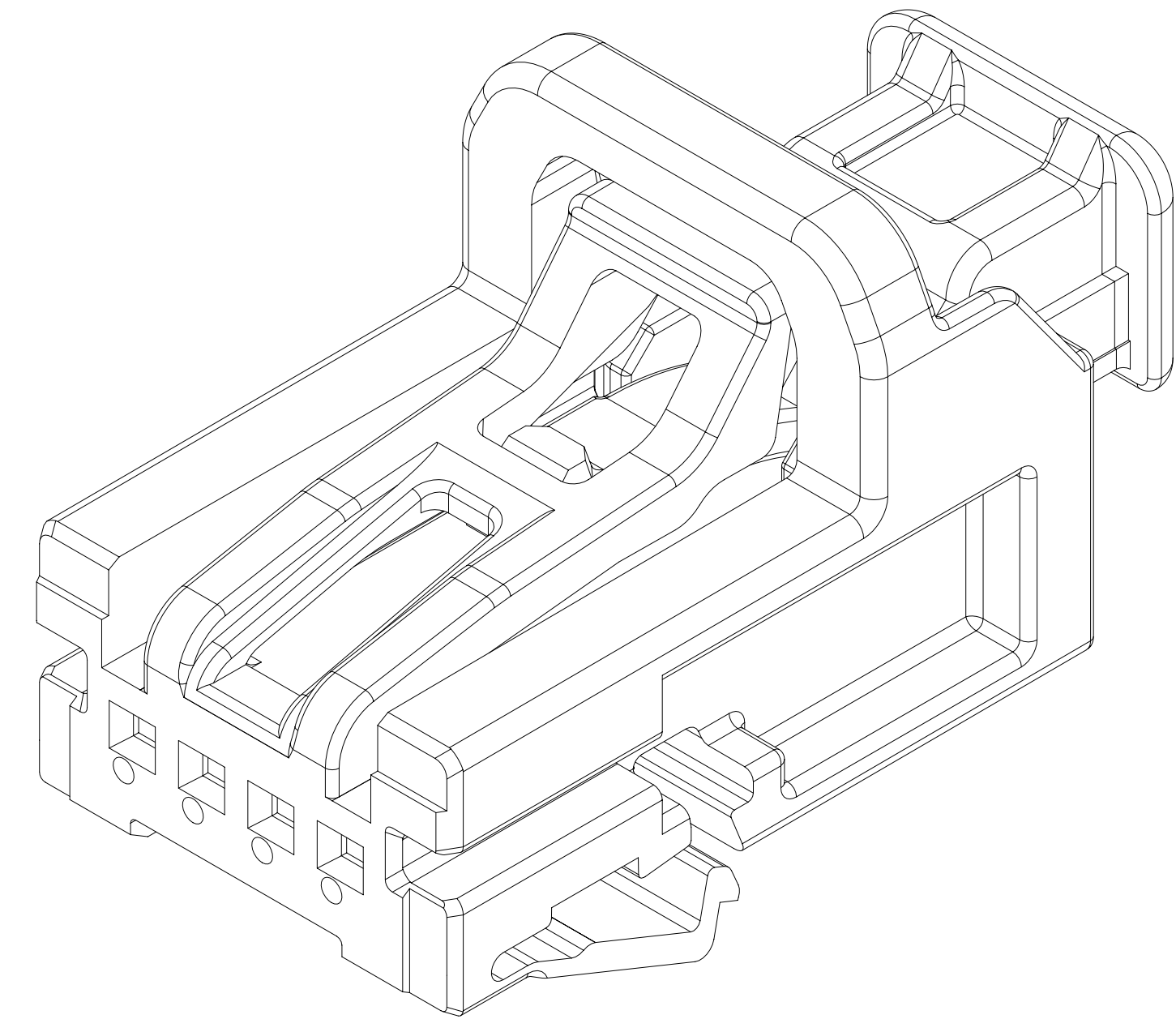
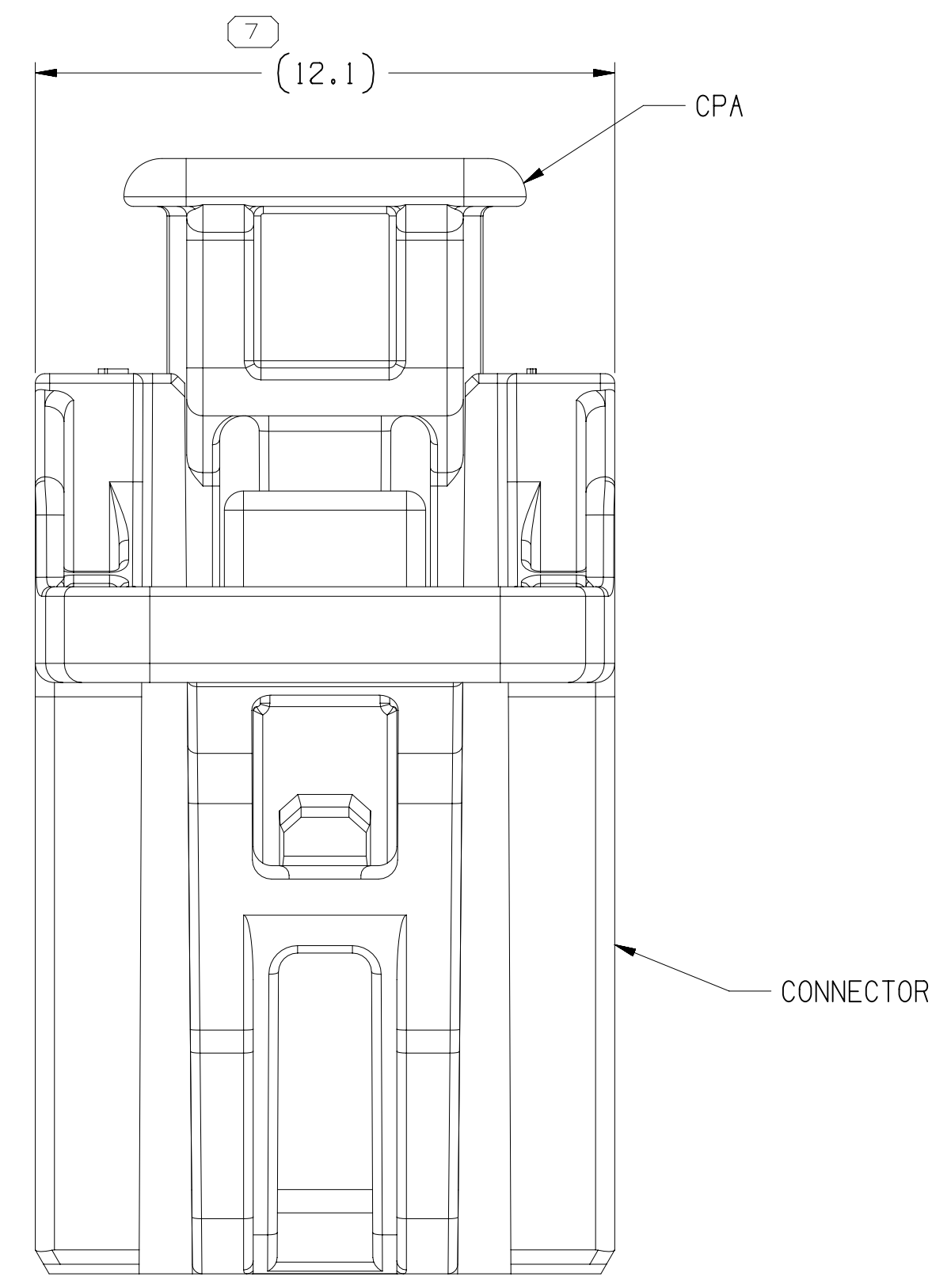

TYPE 103
SAME AS TYPE 101
EXCEPT AS SHOWN

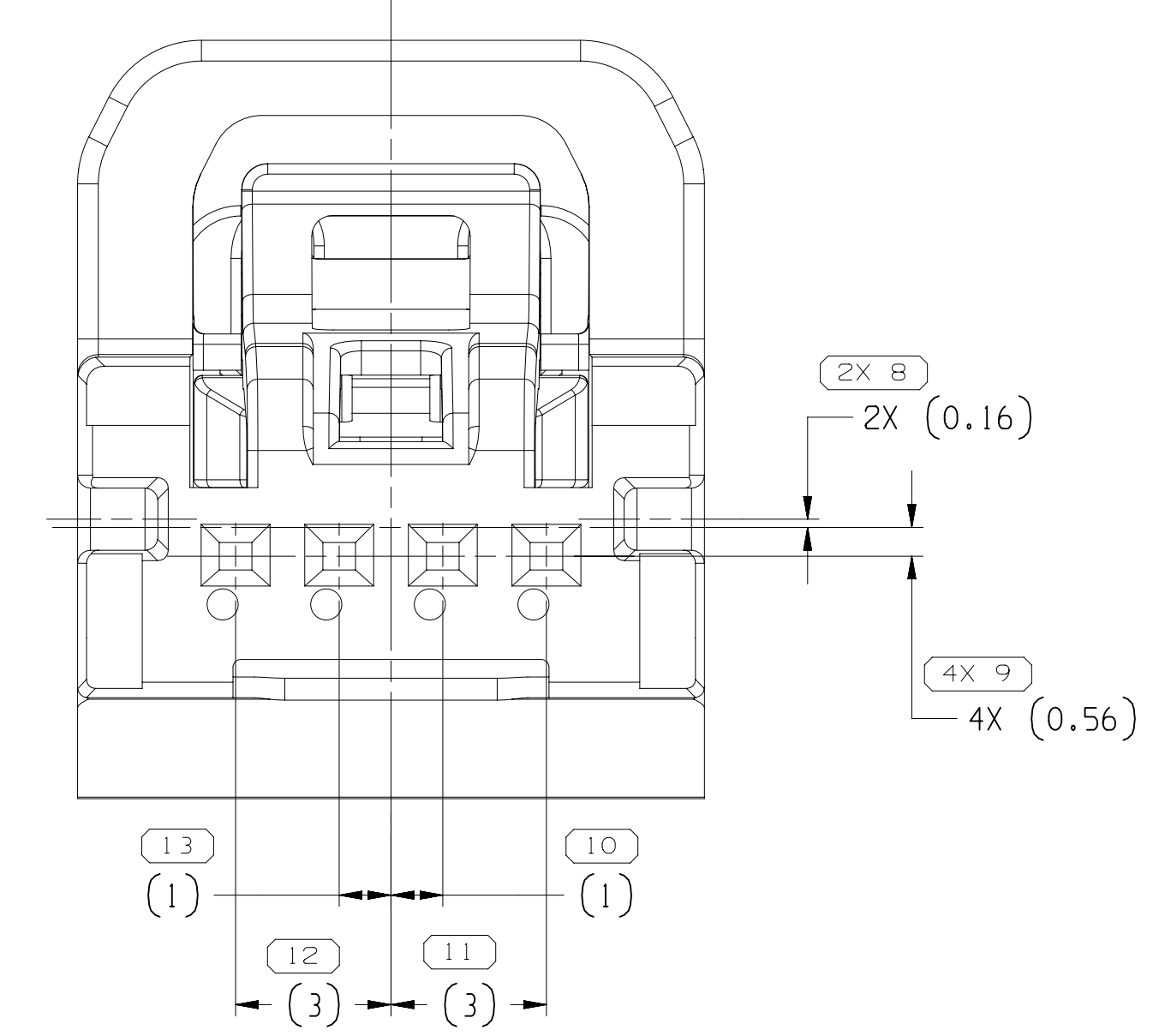

TYPE 101

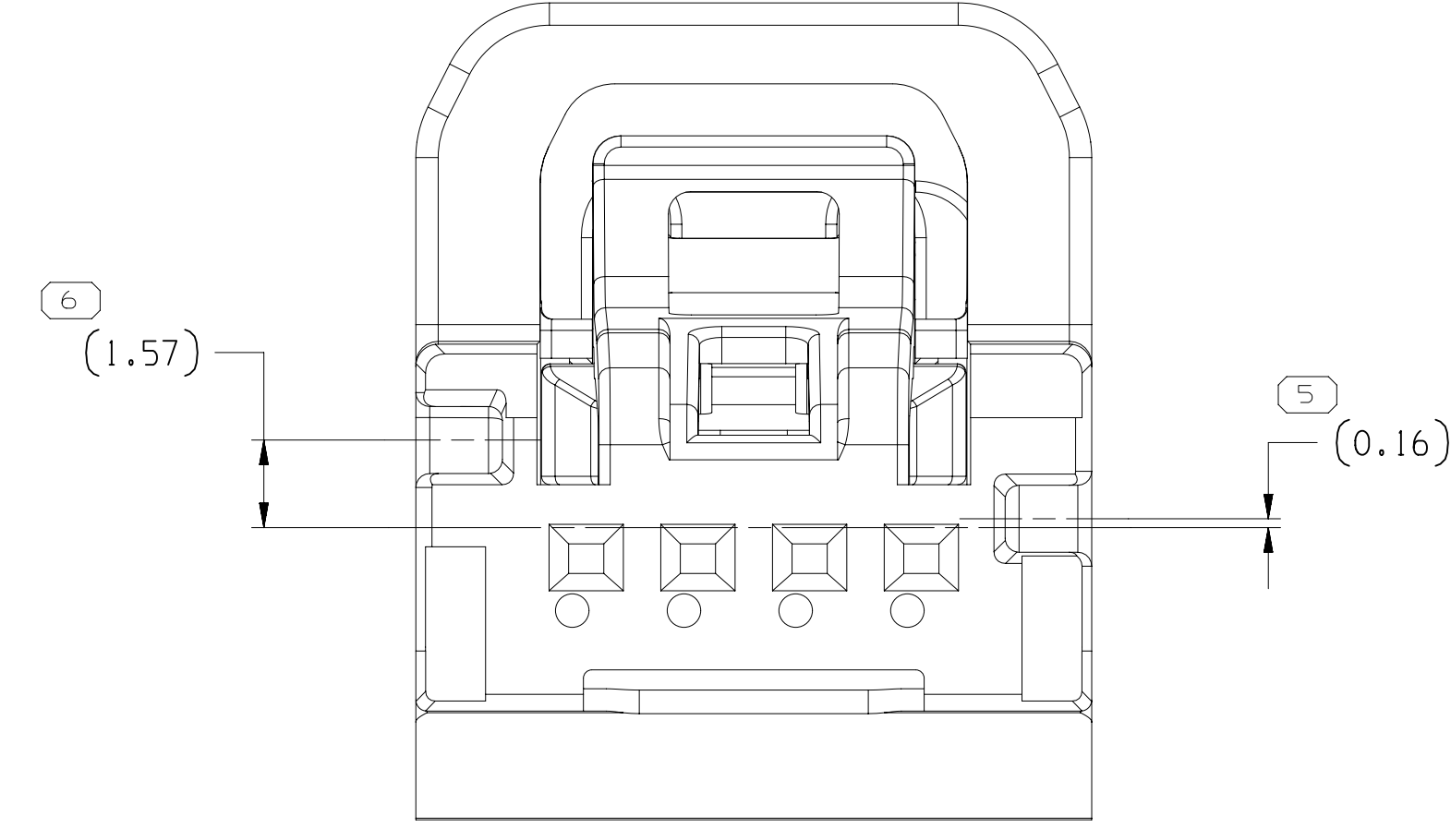
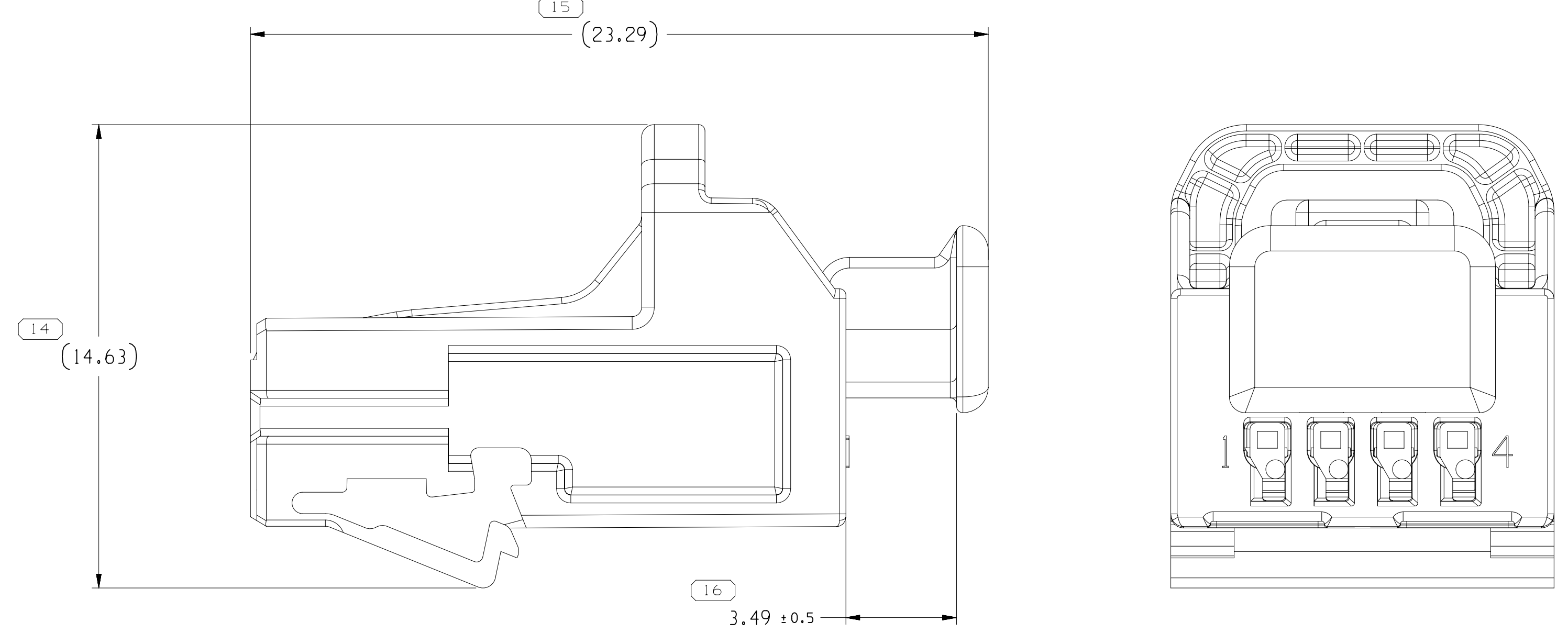

TYPE 104
SAME AS TYPE 101
EXCEPT AS SHOWN

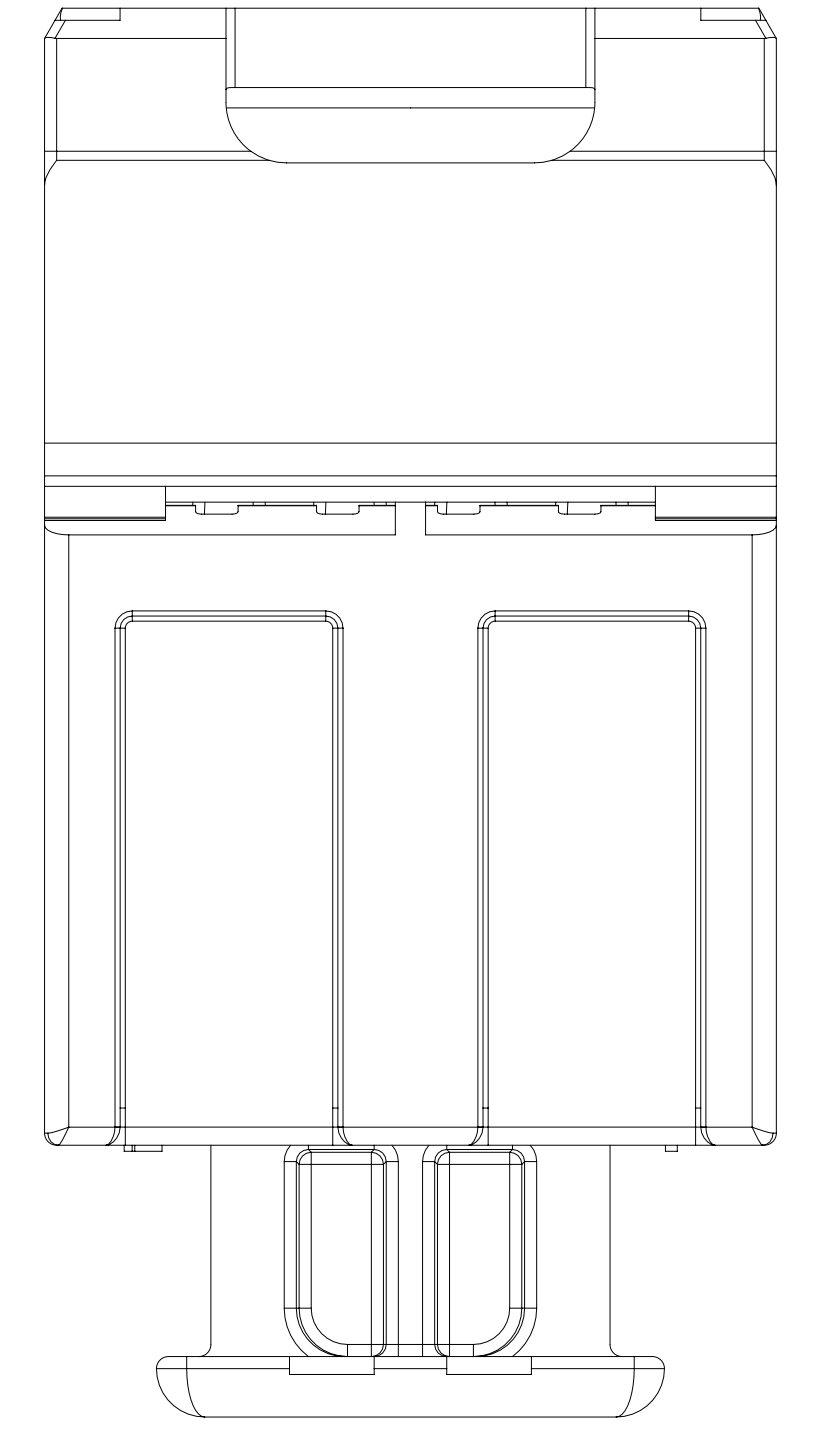

- NOTES
- UNLESS OTHERWISE SPECIFIED AND/OR INDICATED: DIMENSIONS ARE TO FACE OF VIEW SHOWN AND AUTOMATICALLY ROUNDED BY COMPUTER FOR INSPECTION (SEE MATH MODEL FOR PRECISE DIMENSIONS). FOR ALL OTHER DIMENSIONS NOT SHOWN BUT REQUIRED FOR TOOL BUILD, SEE MATH MODEL FOR PRECISE TOOL PATH DATA.
 - WHEN PARTS ARE SHIPPED THEY MUST BE PACKED IN PLASTIC BAGS OR SHIPPING CONTAINERS MUST BE LINED WITH PLASTIC LINERS. BAGS OR LINERS MUST BE SEALED TO AVOID FOREIGN MATTER.
 - SEALING CODE 1 - DESIGN WILL MEET REQUIREMENTS OF SAE/USCAR-6 UNSEALED CONNECTOR SYSTEM ENVIRONMENTAL TEST FLOWCHART.
 - THIS PART IS NOT CONTROLLED FOR AUTOMATIC FEEDING.
 - FOR APPLICATION DATA SEE THE INDIVIDUAL APPLICATION DRAWINGS.

PART NO	REV	N/P	TYPE	CONN	CPA
35068221	02	AB	104	35068205	33380638
35068220	02	AB	103	35068204	33380638
35068219	02	AA	102	35068203	33380638
35068218	02	AA	101	35068202	33380638

DIMENSIONAL RANGE (MM)	TOLERANCE UNLESS OTHERWISE SPECIFIED	CHART	ET
FROM 0 TO >20	±0.25	20	100
>20 TO >30	±0.30	30	100
>30 TO >70	±0.40	70	100
>70 TO >100	±0.50	100	100
>100 TO >150	±0.63	150	100
>150 TO >200	±0.75	200	100
>200 TO >250	±0.90	250	100
>250 TO >300	±1.00	300	100
>300 TO >400	±1.20	400	100
ANGULAR TOLERANCE ±2°			

APTIV
CONNECTION SYSTEMS
Dharmat, India
COPYRIGHT 2017 APTIV, ALL RIGHTS RESERVED.
THIS DRAWING IS THE PROPERTY OF APTIV AND CONTAINS APTIV CONFIDENTIAL INFORMATION. THE REPRODUCTION, DISTRIBUTION AND UTILIZATION OF THIS DOCUMENT OR ITS RELATED CAD DATA, AS WELL AS COMMUNICATION OF ANY CONTENT TO OTHERS, WITHOUT EXPRESS AUTHORIZATION, IS PROHIBITED.

MATERIAL: SEC DRAWING

DRAWING NAME: TAXI ASM CONN 4 F 0.50

DRAWING NUMBER: 35068216

SIZE: A0
SCALE: 10:1
FRAME NO: 1 OF 1
SHEET NO: 1 OF 1
REV: 04

User: r22447 Date: 12-Aug-21 Time: 08:53:41