

TYPE 103
SAME AS TYPE 101
EXCEPT AS SHOWN

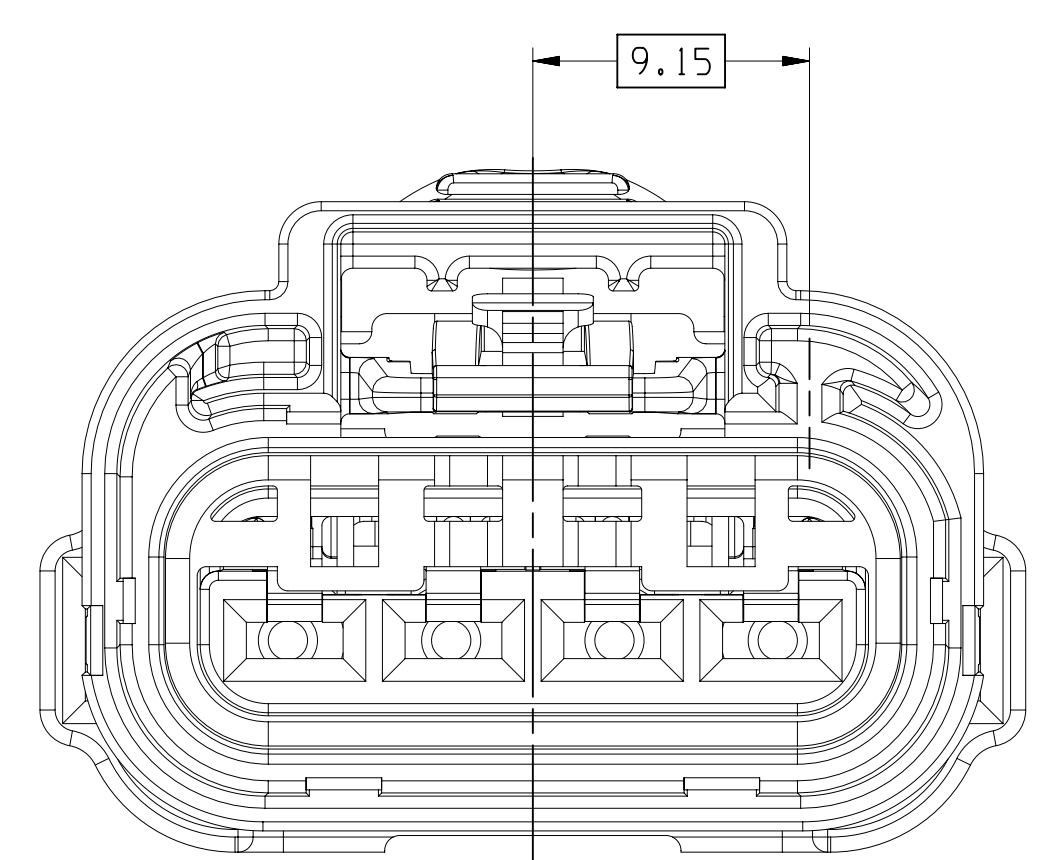

TYPE 104
SAME AS TYPE 101
EXCEPT AS SHOWN

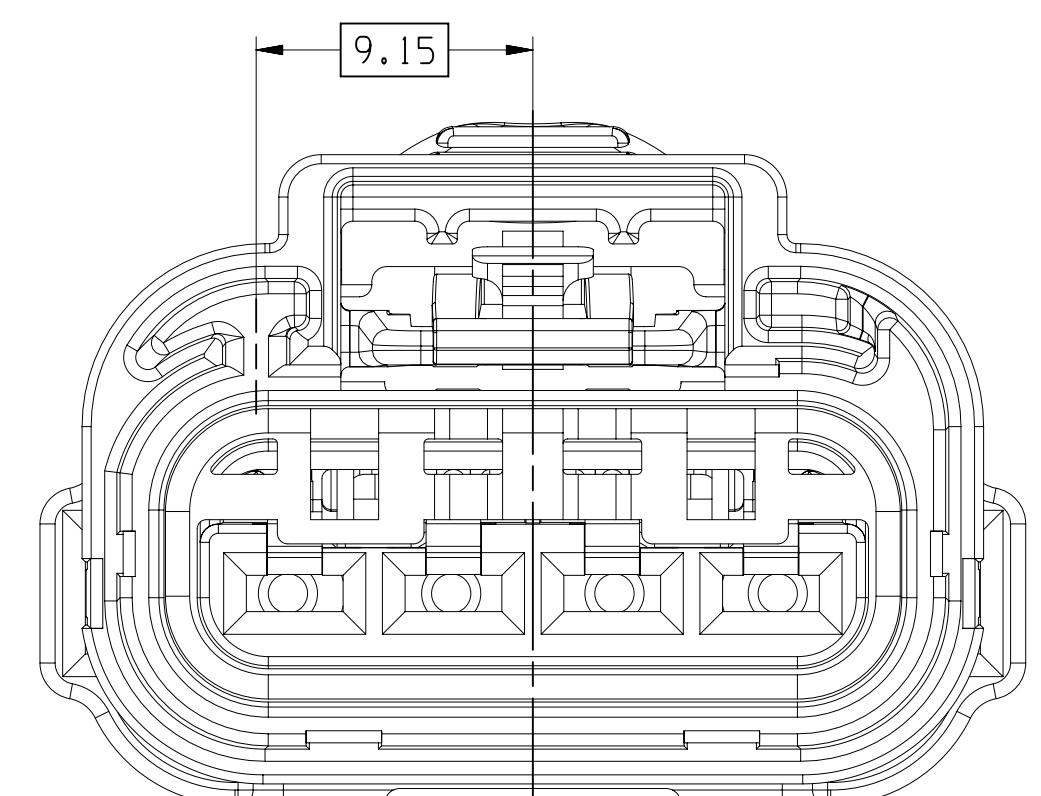

TYPE 105
SAME AS TYPE 101
EXCEPT AS SHOWN

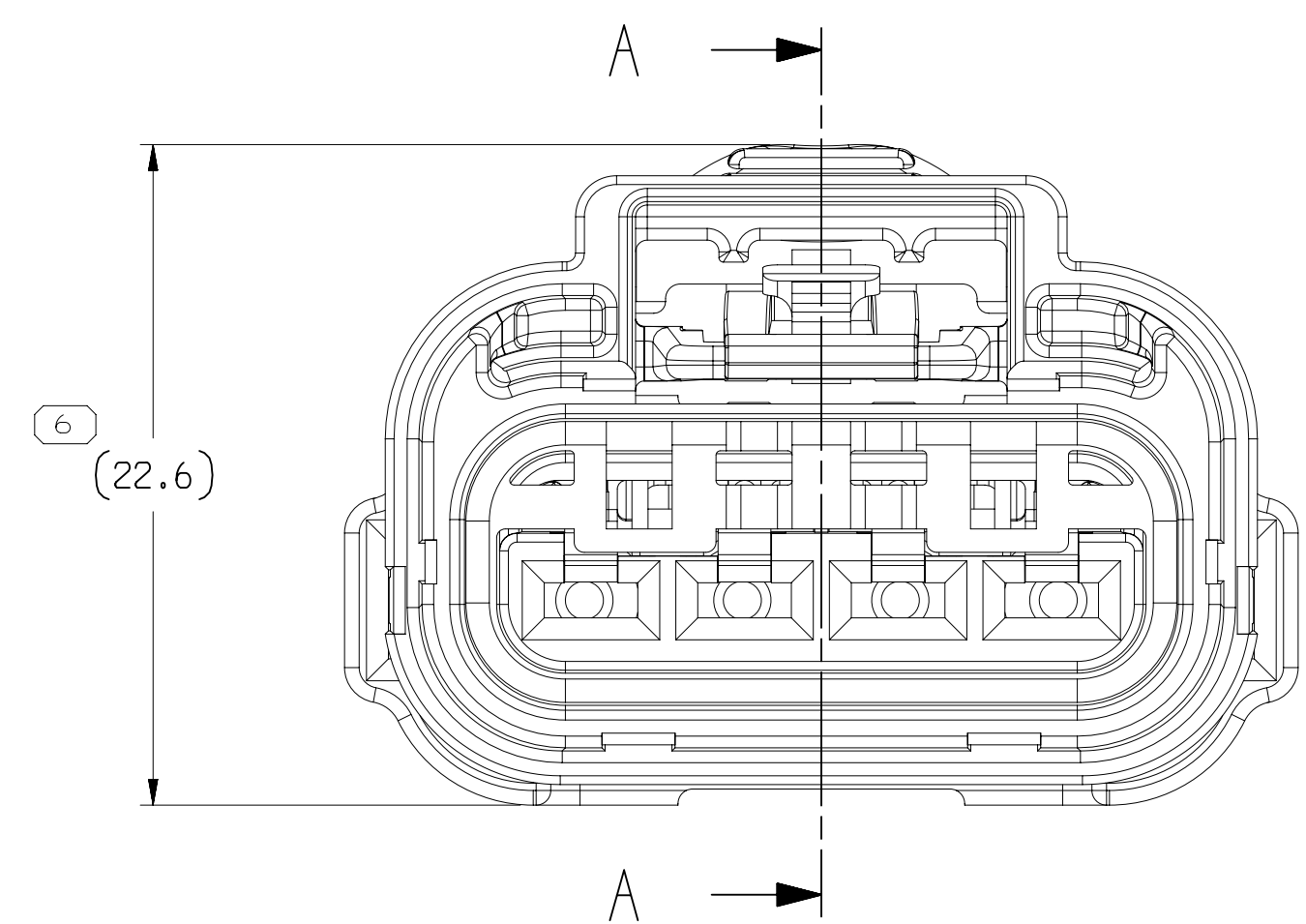
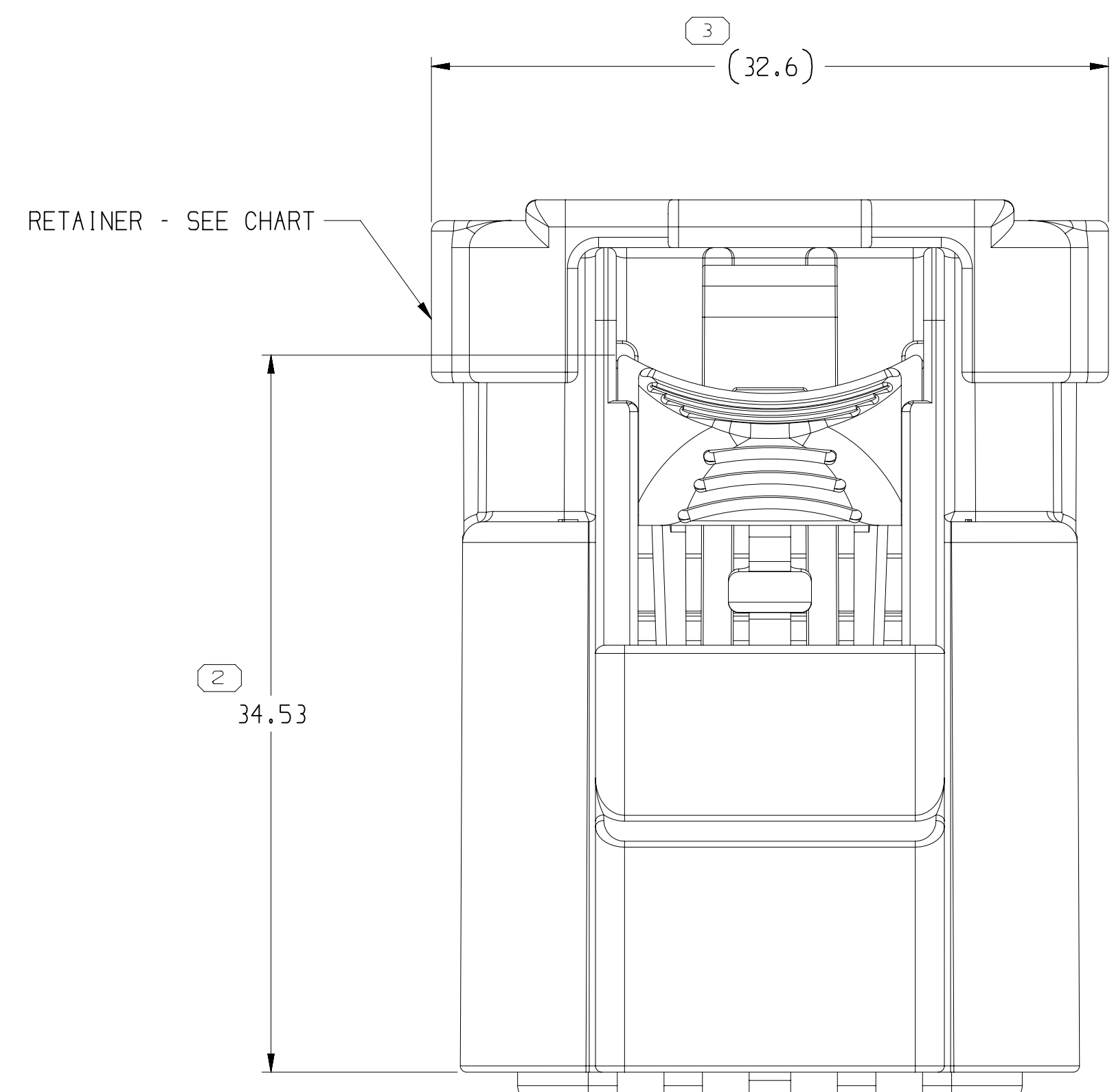

TYPE 101

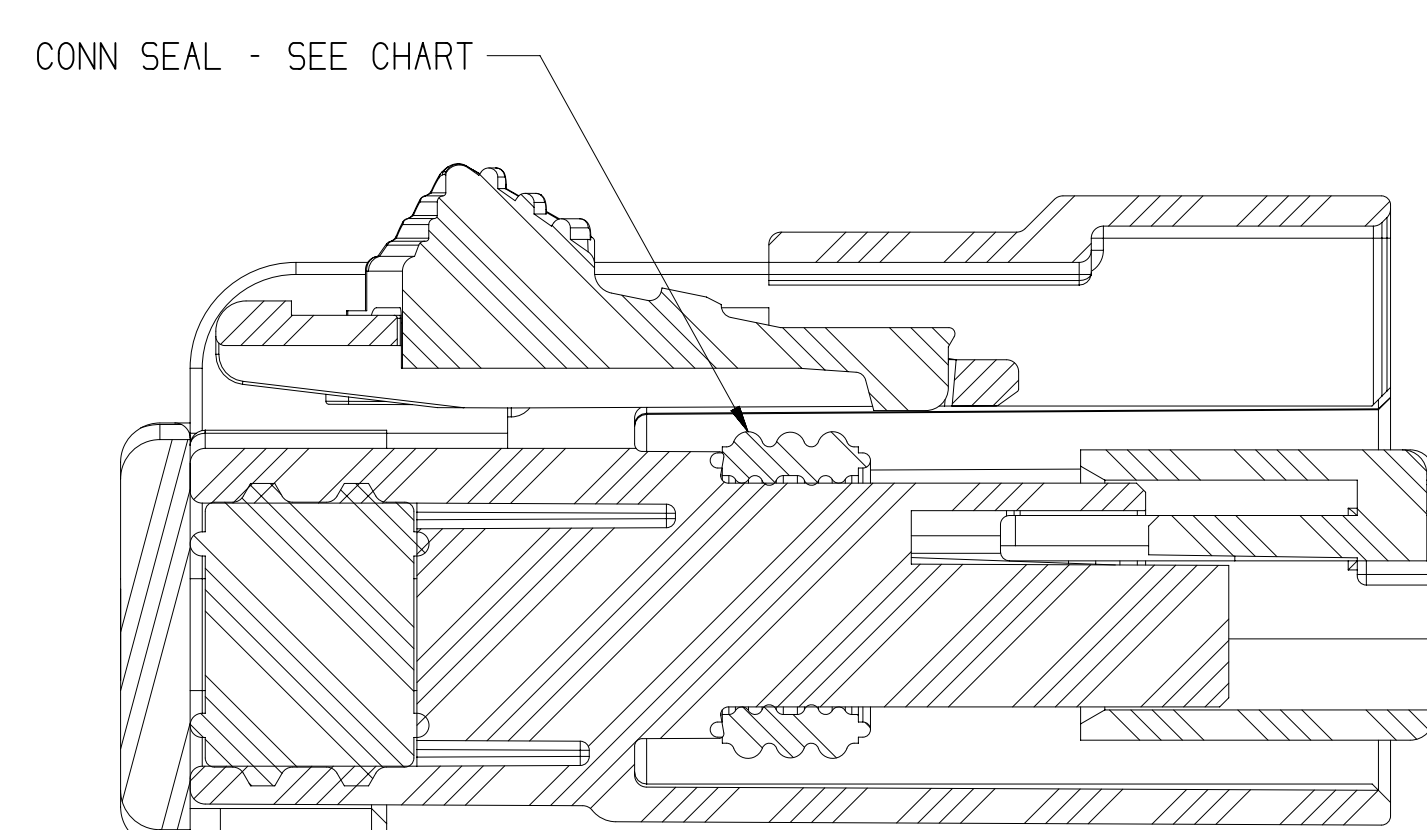
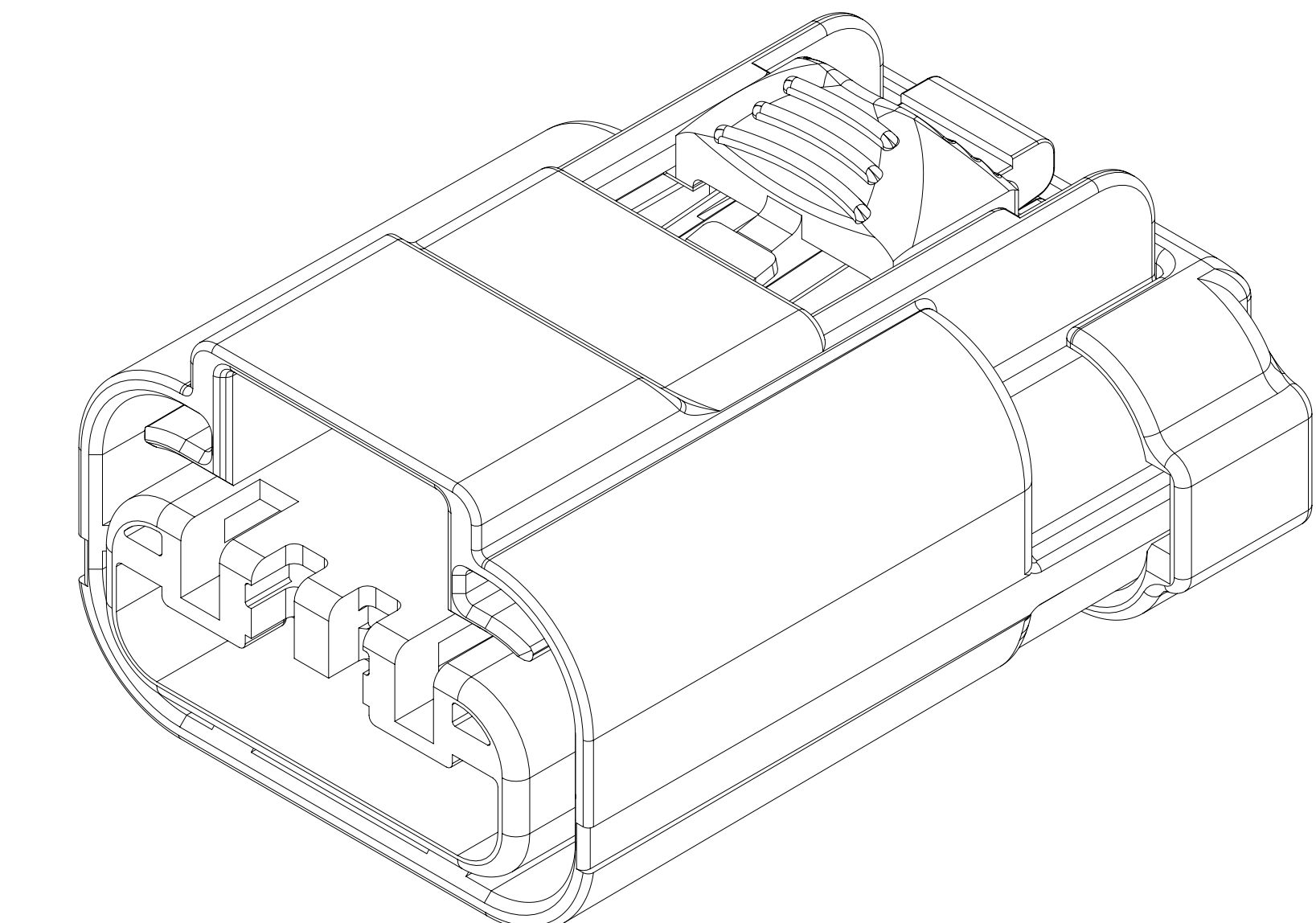
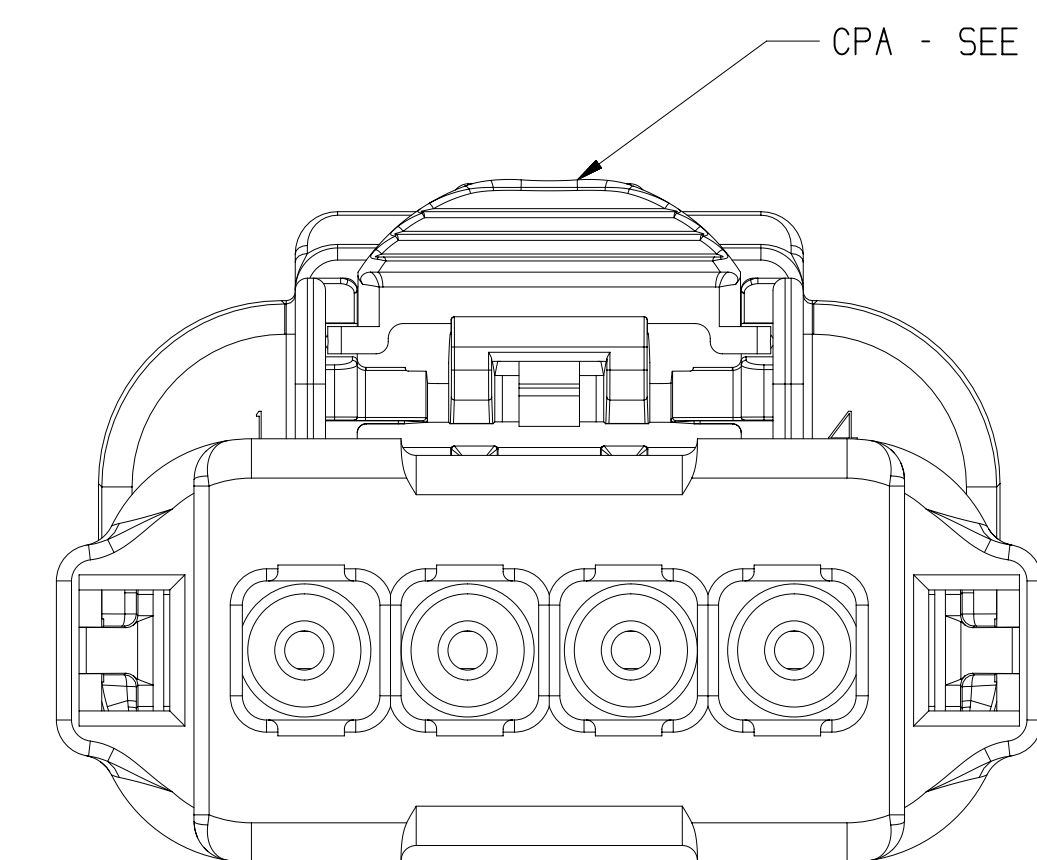
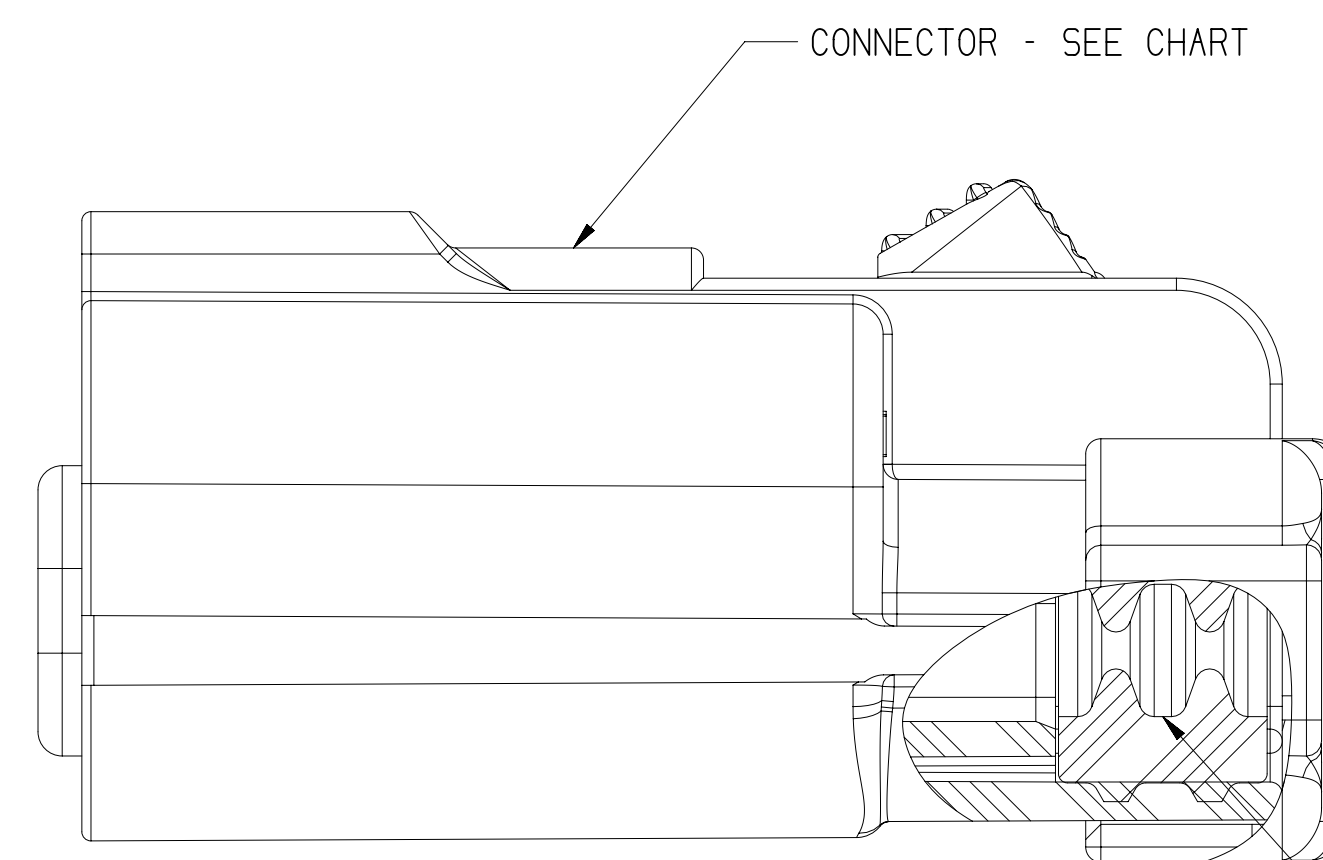

SECTION A - A

— LOCK PLR (PRE-STAGE) - SEE CHART

35333814	01	AD	105	35333810	54200444	3511959	54200459	3511960	C17019-U	33185280	54200440	15537508	15519096	125° C	0.0, 1.72±0.08 to 3.80±0.08 ON ANY LOCATION	-			
35333813	01	AD	104	35333809	54200442	3511959	54200459	3511960	C17019-U	33185280	54200440	15537508	15519096	125° C	0.0, 1.72±0.08 to 3.80±0.08 ON ANY LOCATION	-			
35333812	01	AD	103	35333807	54200442	3511959	54200459	3511960	C17019-U	33185280	54200440	15537508	15519096	125° C	0.0, 1.72±0.08 to 3.80±0.08 ON ANY LOCATION	-			
35337829	01	AD	102	35264993	54200442	3511959	54200459	3511960	C17019-U	33185280	-	35234776	15519096	125° C	0.0, 1.72±0.08 to 3.80±0.08 ON ANY LOCATION	-			
35243535	02	AE	101	35264993	54200442	3511959	54200459	3511960	C17019-U	33185280	54200440	15537508	15519096	125° C	0.0, 1.72±0.08 to 3.80±0.08 ON ANY LOCATION	-			
PART NO	REV	N/P	TYPE	CONNECTOR	MVL	APTIV	MVL	APTIV	MVL	APTIV	MVL	APTIV	CPA	TEMP APPV	1	2	3	4	PLUG
					LOCK PLR		CONN SEAL		MATT SEAL		RETA INER				WIRE GAGE CIRCUITS NO				

SYMBOL DEFINITION		
A DIMENSION WITHOUT AN INSPECTION REPORT SYMBOL  DOES NOT REQUIRE INSPECTION. IT MAY BE CONTROLLED ON THE INDIVIDUAL COMPONENT DRAWING.	TOTAL NO OF INSPECTIONS REQUIRED	5
	LAST NO. USED	6

MISSING SYMBOLS		DATE		WAVE STATUS	ZONE	REVISION HISTORY		AUTH	DR	APPLICANT
		1	2	3	4	5	6	7	8	9
31A.1B	R	01	-	-	3524.95.35	-	RELEASED PART DRAWING	439784	AHJ	AHJ/LMW
10A.1P	R	02	-	-	3524.95.35	-	0-D WAS 1, 7-3-4 FOR WIRE CIRCUIT NO 1 & 2, 0-D WAS 3, 1-4-09 FOR WIRE CIRCUIT NO 3 & 4, LOCK PLUG WAS 35111959, CONN SEAL WAS 35111960, WATT SEAL WAS 352.4478, TEMP APPLY WAS 150°C AND REMOVED "SEAL BAKED" NOTE 35337229 - RELEASED	442956	JMO	LJM/LMW
02M.Y19	R	03	-	-	3533812-14	-	RELEASED: 35337229 - REMOVED GRAPHICS AND 3524.95.35 & 35337229 - REMOVED "ALL THE SEALED CONNECTOR APPLICATIONS" NOTE	442872	LOL	LOL/LMW
28A.1J	R	04	-	-	3524.95.35, 3533812-14	-	RETAINED WAS 155.374.51 ALL PARTS, PSD WAS N/A, REMOVED "ENGINEERING APPROVAL", "WIRING FABRICATORS", "TEST METHOD", "MOLD & CAVITY ID", "ANNUAL QUALITY REQUIREMENT", "MIL SUPPLIER" & "QUALITY ASSURANCE" NOTES & AUXILIARY VIEW, ADDED "SEALING CODE" NOTE AND UPDATED CONNECTORS TO LATEST REVISION	443784	GDH	JAA/LMW
27SE.1R	R	05	-	-	ALL PARTS	-	UPDATED CONNECTOR TO LATEST REVISION	550119	LVB	AJA/LMW
130C.2D	R	06	-	-	ALL PARTS	-	UPDATED CONNECTOR TO LATEST REVISION AND REMOVED "ID & DATE" LABEL	552679	JGO	CSO/LMW
150E.2D	R	07	-	-	3524.95.35, 3533812-14	-	UPDATED PART AVAILABILITY	553222	AHJ	JAA/LMW

NOTES

1. UNLESS OTHERWISE SPECIFIED AND/OR INDICATED:

DIMENSIONS ARE TO FACE OF VIEW SHOWN AND
AUTOMATICALLY ROUNDED BY COMPUTER FOR INSPECTION
(USE MATH MODEL FOR PRECISION DIMENSIONS), FOR ALL
OTHER DIMENSIONS NOT SHOWN, USE STANDARD TOOL
BUILD, USE MATH MODEL FOR PRECISION TOOL PATH DATA.
2. THIS PRODUCT IS NOT CATEGORIZED AS AN APPEARANCE ITEM, MINOR
IMPERFECTIONS INCLUDING, BUT NOT LIMITED TO, FLOW MARKS, COLOR
BLEMSHES, GATE VESTIGES, AND SLOTT FLAT THAT DO NOT AFFECT THE
FIT, FORM, OR FUNCTION OF THE PART ARE PERMISSIBLE PER EIA649-4-2.CS.01.ENV.
3. FOR APPLICATION DATA SEE THE INDIVIDUAL APPLICATION DRAWINGS.
4. SEALING CODE 4 - DESIGN WILL MEET REQUIREMENTS OF SEA/CAUSE-4
CONNECTOR SYSTEM ENVIRONMENTAL TEST FLOWCHART
(PRESSURE/VACUUM AND SUBMERSION).

[illegible]

DIMENSIONAL RANGE (MM)		LIMITS ARE ESTABLISHED									
FROM	TO	> 0	> 20	> 30	> 70	> 100	> 150	> 200	> 250	> 300	> 400
TOLERANCE UNLESS OTHERWISE SPECIFIED											
		+0.15	+0.2	+0.3	+0.4	+0.5	+0.6	+0.8	+1	+1.2	+1.5