

KEY PRODUCT CHARACTERISTICS					
SAFETY/COMPLIANCE		FIT/FUNCTION		TOTAL ON DRAWING	0
S/C CHECKPOINTS		F/F CHECKPOINTS		LAST NO. USED	0
NO & TYPE	DESCRIPTION	RATIONALE	PTS	ZONE	

LTG.-TYP CABLE-TYPE	K ₁ ±0.4	L ₁ ±0.2	L ₂ ±0.2	L ₃ ±0.2	H ₂ ±0.2	H ₁ ±0.2	H _{1a} ±0.2	H _{1x} ±0.2	B ₂ ±0.2	B ₁ ±0.2	B _{1a} ±0.2	B _{1x} ±0.2	DV ±0.2	CROSS SECTION QUERSCH.	
FLRY	0.80	6.40	2.00	3.40	1.95			1.55	1.80	2.10		1.65	1.80	1.20	0.13
	0.80	5.50	2.10	2.50	2.80	2.10			2.70	2.10		1.60	1.60	0.20-0.35	
	0.80	5.50	1.50	3.00	3.90	2.80			3.60	2.60		1.60	1.60	0.5-1.0	
	0.80	5.50	1.50	3.00	4.70	3.20			4.10	3.40		1.60	1.60	0.20-0.35	
	0.80	5.80	1.60	3.30	4.90	3.80			4.60	3.60		1.60	1.60	1.5-2.5	
	0.80	5.80	1.60	3.30	5.15	4.85			4.70	4.40		1.60	1.60	3.0-4.0	

RECOMMENDED APPLICATION MALE BLADE THICKNESS EMPFOHLENE STIFT DICKE	SURFACE OBERFLAECHE	MATERIAL WERKSTOFF	LTG.-TYP CABLE-TYPE	CROSS SECTION QUERSCH.	PART-NO. TEILE-NR.	PART-REV	DATE DATUM	PART WEIGHT (G)	DWG STATUS			ZONE	REVISION HISTORY		AUTH	DR	APVD 1	APVD 2	
									DATE	STG	REV		IN	CHG					INITIAL
0.8 MM	SN	CUFE	FLRY	0.5-1.0	15409039	01	24JAO3	0.42	24JAO3	01	01								
	SN	CUFE	FLRY	1.5-2.5	15409041	01	24JAO3	0.45	24JAO3	01	01								
	SN	CUFE	FLRY	0.5-1.0	15409037	01	24JAO3	0.44	24JAO3	01	01								
	SN SEL. AU	CUFE	FLRY	0.5-1.0	15470847	01	200E05	0.42	200E05	01	01								
	SN SEL. AU	CUFE	FLRY	1.5-2.5	15470849	01	200E05	0.45	200E05	01	01								
	SN SEL. AU	CUFE	FLRY	0.5-1.0	15470851	01	200E05	0.44	200E05	01	01								
0.6 MM	SN	CUNISI	FLRY	0.5-1.0	13549667	01	200E05	0.42	200E05	01	01								
	SN	CUNISI	FLRY	1.5-2.5	13549670	01	200E05	0.45	200E05	01	01								
	SN	CUNISI	FLRY	0.5-1.0	13549675	01	200E05	0.44	200E05	01	01								
	SN	CUFE	FLRY	0.5-1.0	13644607	01	24AP07	0.42	24AP07	01	01								
	SN	CUFE	FLRY	1.5-2.5	13644618	01	24AP07	0.45	24AP07	01	01								
	SN	CUFE	FLRY	0.5-1.0	13644625	01	24AP07	0.44	24AP07	01	01								
0.8 MM	SN	CUFE	FLRY	3.0-4.0	13716403	01	09JNO8	0.47	09JNO8	01	01								
	SN	CUFE	FLRY	0.13	13981504	01	31AUI2	0.37	31AUI2	01	01								
	SN SEL. AG	CUNISI	FLRY	1.5-2.5	13718244	01	09JNO8	0.45	09JNO8	01	01								
	SN SEL. AG	CUNISI	FLRY	3.0-4.0	13718671	01	09JNO8	0.47	09JNO8	01	01								
	SN	CUSN4	FLRY	0.50-1.00	13720164	01	23OC08	0.42	23OC08	01	01								
	SN	CUSN4	FLRY	1.50-2.50	13720163	01	23OC08	0.39	23OC08	01	01								

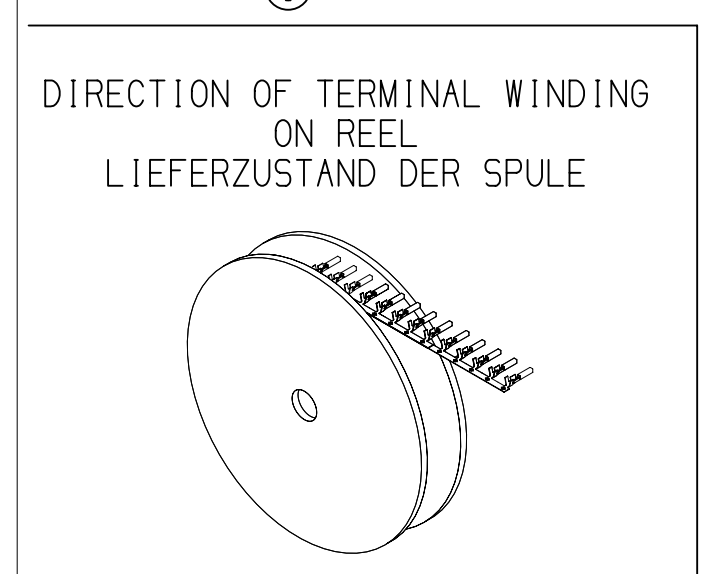
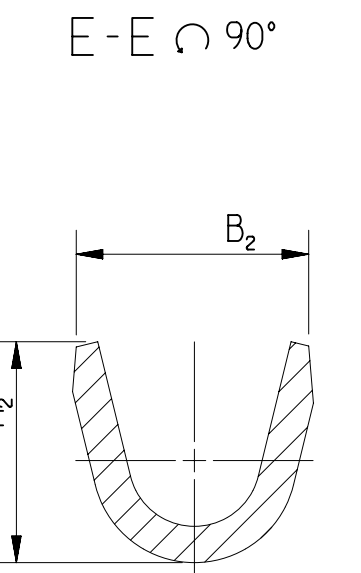
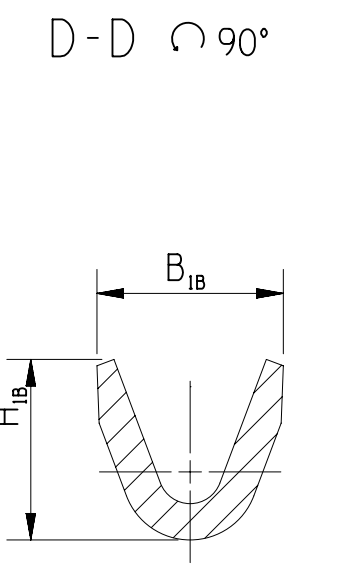
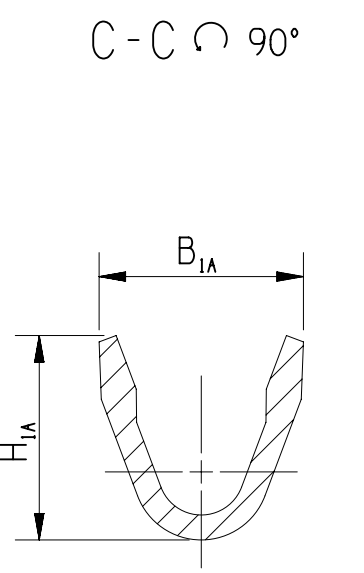
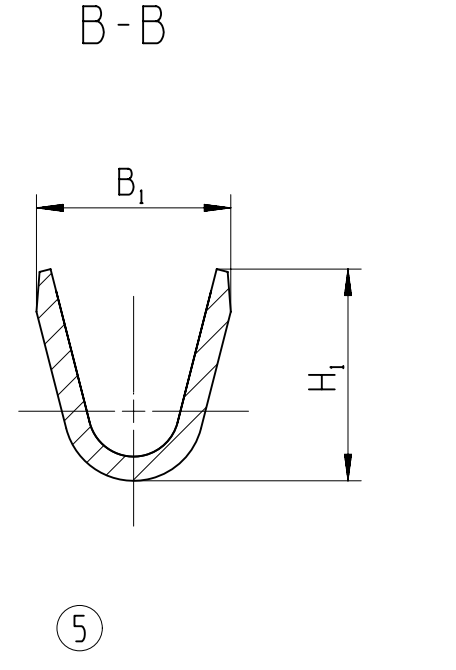
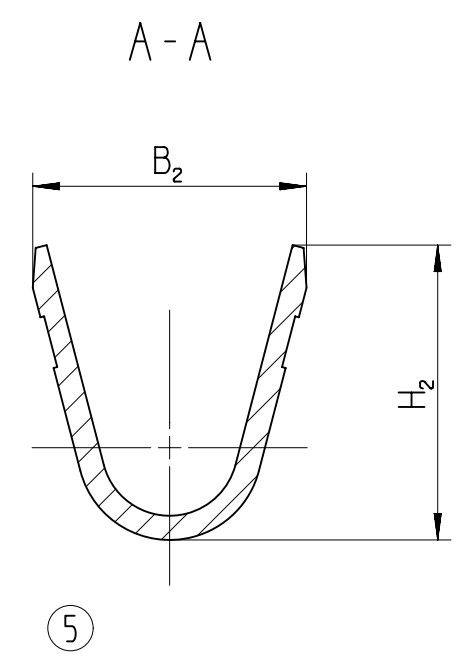
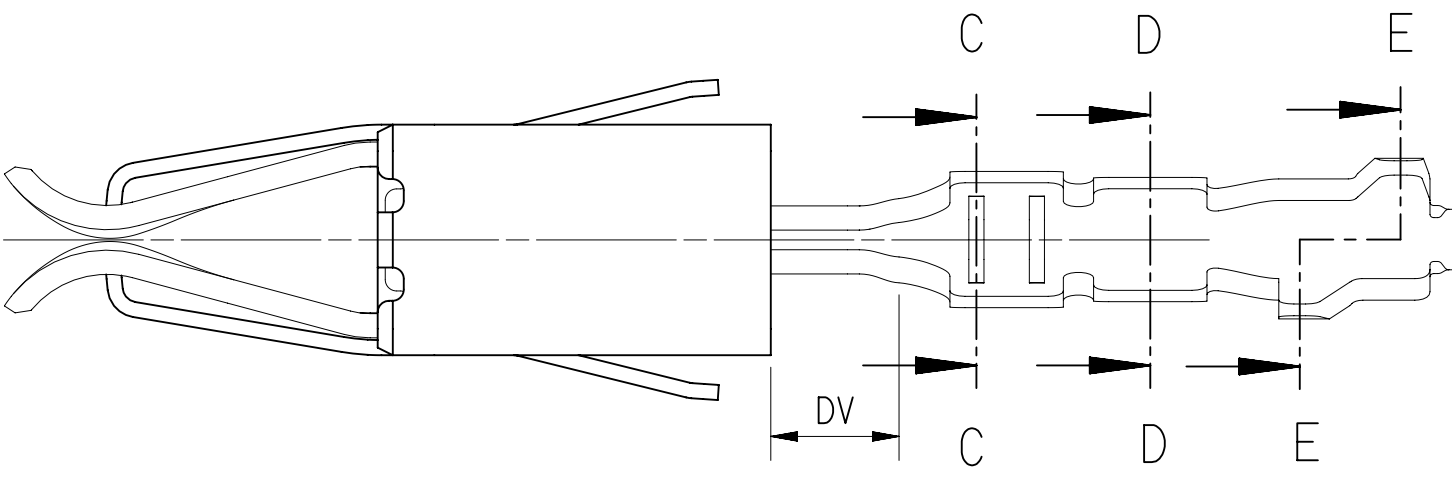
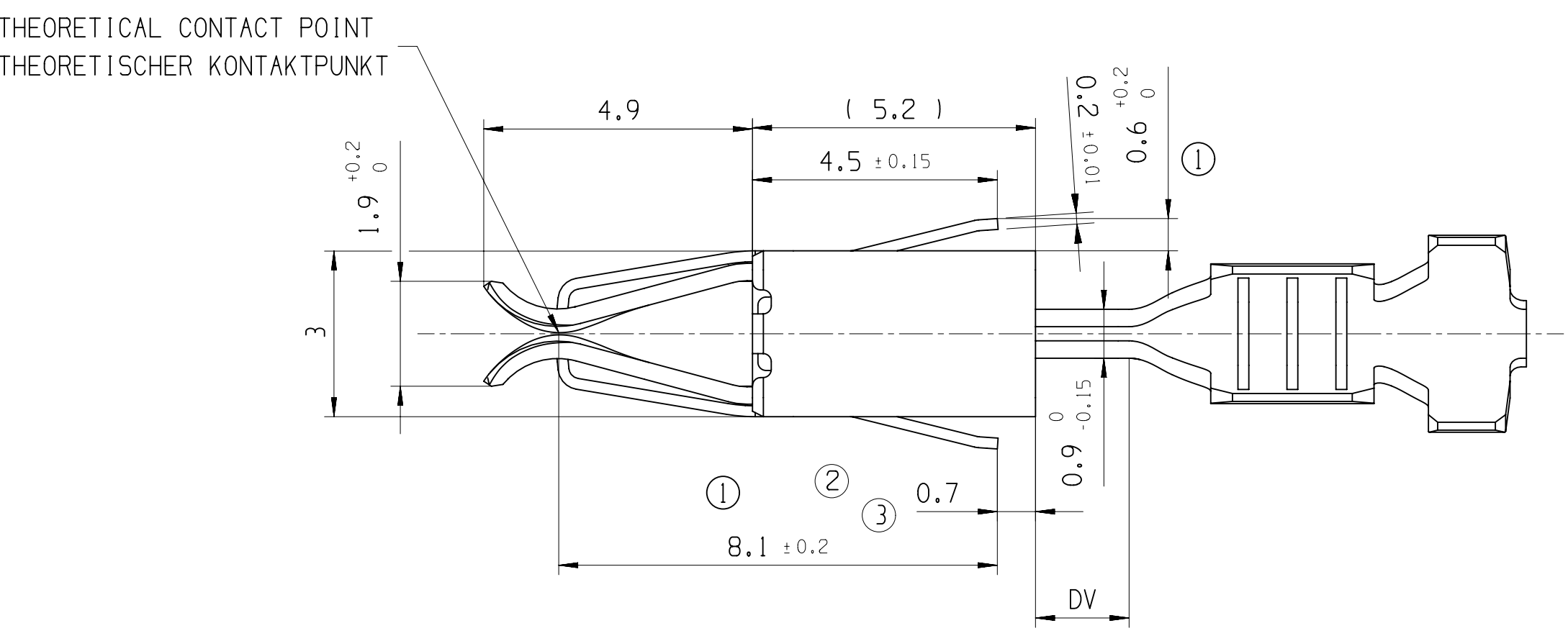
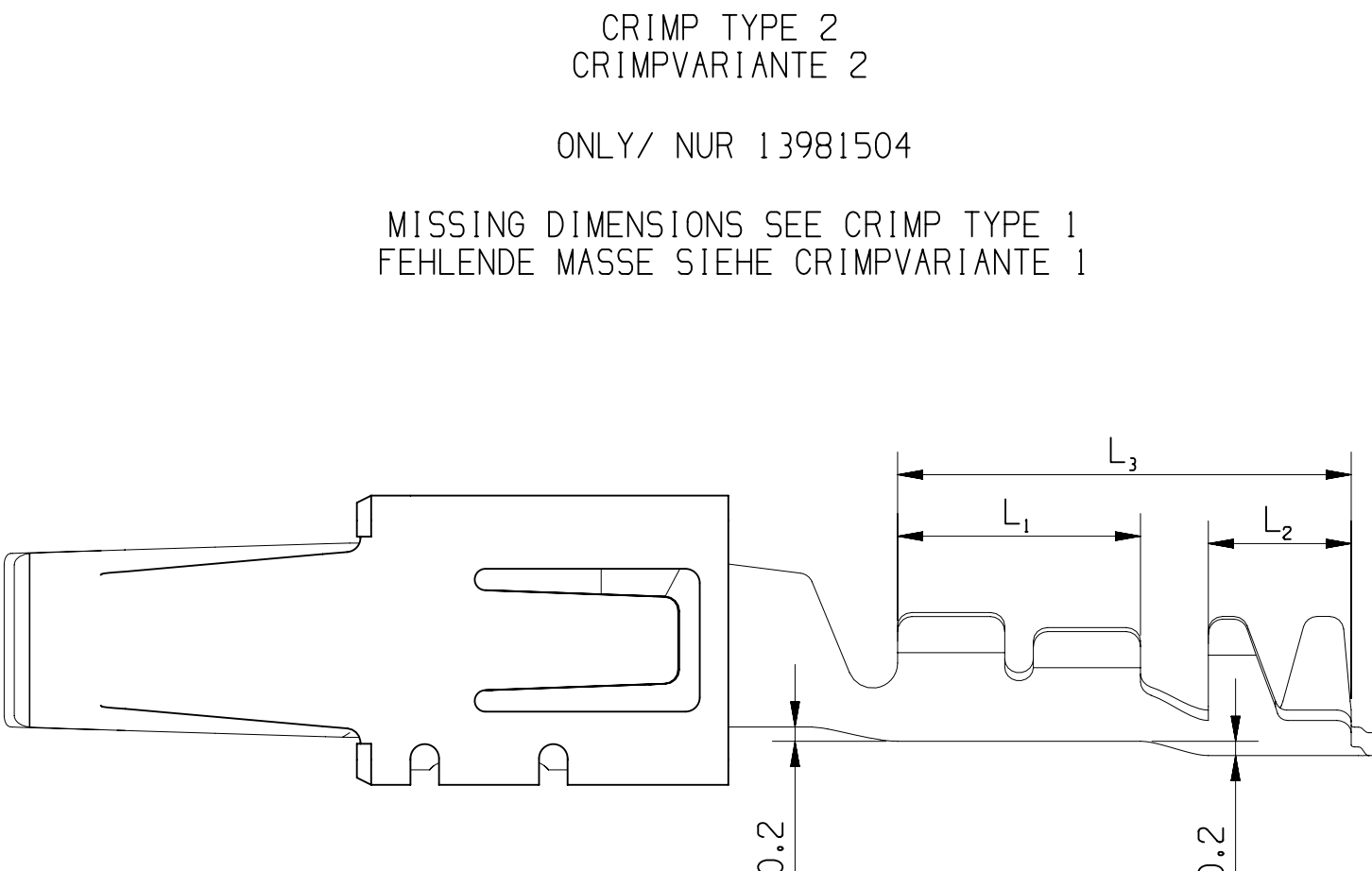
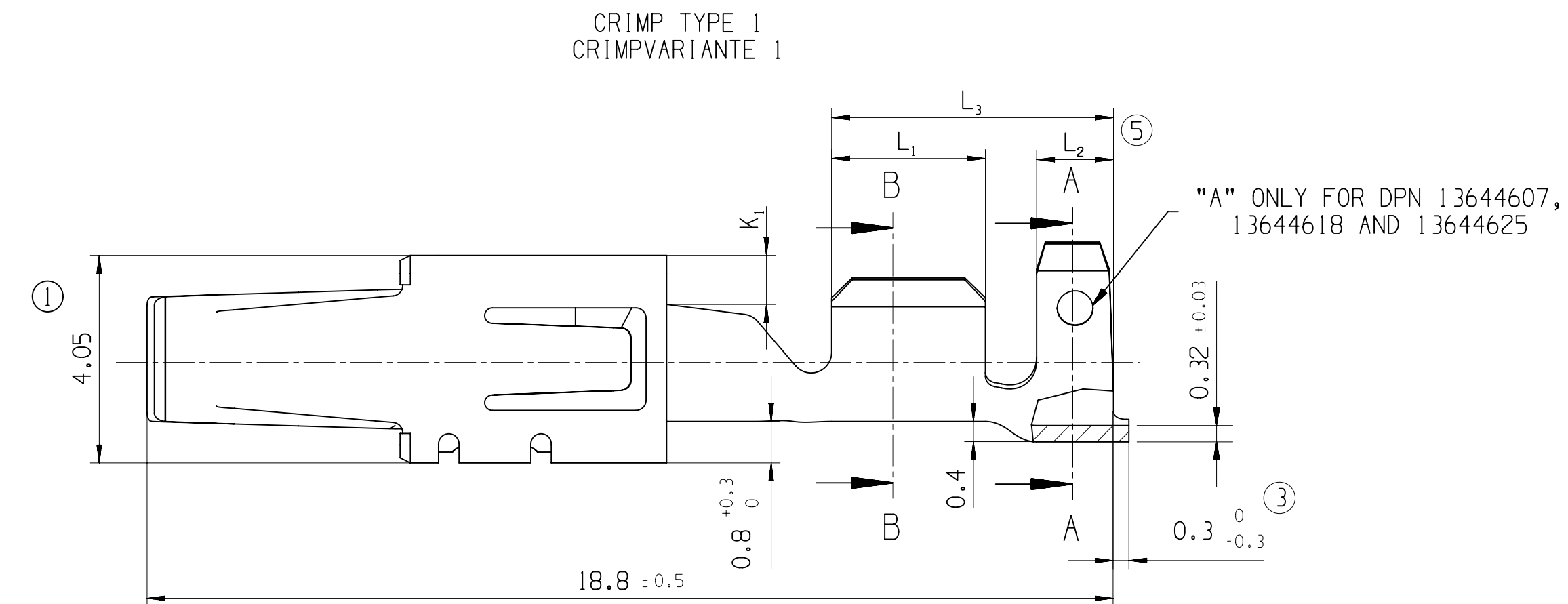

REMARKS:
 - PART-NO.: 13644607, 13644618 AND 13644625 WITH HIGHER RETENTION AND MATING FORCE
 - SLEEVE MATERIAL EN 10151 XI0CRNI188

BEMERKUNGEN:
 - PART-NO.: 13644607, 13644618 UND 13644625 MIT GROESSERER HALTE- UND STECKKRAFT
 - UEBERFEDER MATERIAL EN 10151 XI0CRNI188

CRIMP MANUFACTURING PARAMETERS AND TOOLING ACCORDING TO DELPHI-SPECIFICATION	CRIMPVERARBEITUNGSPARAMETER UND WERKZEUGE GEMÄSS DELPHI-SPECIFICATION
A LINE DRAWN THROUGH A PART NUMBER INDICATES THAT PHYSICAL PARTS ARE NOT AVAILABLE FOR ORDERING.	WIT EENER LEEGTE DEURCHHEERTEHENE PART-NR. GEKENDEKNET, DASS DESE PART-NR. NICHT BESTELLT WERDEN KAN.
PART NUMBERS THAT DO NOT HAVE A LINE PRESENT INDICATE THAT PHYSICAL PARTS ARE AVAILABLE FOR ORDERING.	PART-NR. DIE KEINE LEEGTE ZEGEN, KANZEGEDEN, DASS TELE ZUR BESTELLUNG VERFUEGBAR SIND.
CONTACT APPLICATOR TO ASSURE AVAILABILITY OF PARTS.	WIT EENER LEEGTE DEURCHHEERTEHENE PART-NR. GEKENDEKNET, DASS DESE PART-NR. NICHT BESTELLT WERDEN KAN.
PART-NR. DIE KEINE LEEGTE ZEGEN, KANZEGEDEN, DASS TELE ZUR BESTELLUNG VERFUEGBAR SIND.	WIT EENER LEEGTE DEURCHHEERTEHENE PART-NR. GEKENDEKNET, DASS DESE PART-NR. NICHT BESTELLT WERDEN KAN.
FLYER VERLEGBAARKEIT DER PARTS DEN EINKAUF VON APTEV KENNTEREN	FLYER VERLEGBAARKEIT DER PARTS DEN EINKAUF VON APTEV KENNTEREN
R 0.2 MAX	R 0.1 MAX
SHARP CORNER TOLERANCE	SHARP CORNER TOLERANCE
ANGULAR TOLERANCE 2P2	ANGULAR TOLERANCE 2P2

UNLESS OTHERWISE SPECIFIED	GENERAL TOLERANCES ACCORDING TO: SEE CHART / SIEHE TABELLE
OD&T ACCORDING TO:	
FIRST ANGLE PROJECTION	
DO NOT SCALE	
USE MATH DATA	

•APTEV•

CONNECTION SYSTEMS
 D-42119 WUPPERTAL

THIS DRAWING IS THE PROPERTY OF APTEV AND CONTAINS APTEV CONFIDENTIAL INFORMATION. THE REPRODUCTION, DISTRIBUTION AND UTILIZATION OF THIS DOCUMENT OR ITS RELATED CAD DATA, AS WELL AS COMMUNICATION OF ANY CONTENT TO OTHERS, WITHOUT EXPRESS AUTHORIZATION, IS PROHIBITED.

DESE ZEICHNUNG IST EIGENTUM DER FIRMA APTEV UND ENTHAHLT DELPHI VERTRAULICHE INFORMATIONEN. DIE REPRODUKTION, VERTEILUNG UND NUTZUNG DIESER DOKUMENTE ODER DIESER ZUGEHÖRIGEN CAD DATEN, ODER AUCH ALS KOMMUNIKATION VON BELEIBEN INHALT ZU ANDEREN, IST OHNE BESONDERE KENNTERUNG DURCH DIE FIRMA APTEV VERBODEN.

DATE	28SE01
DR	JUETT
APVD1	CVASA
APVD2	R.WIS.
APVD3	
APVD4	
APVD5	

DRAWING NUMBER: 15409047

SIZE: A2 SCALE: 10:1 FRAME NO: 1 OF 1 SHEET NO: 576 REV: NPT

SCALE/MASSTAB	1:1
SCALE/MASSTAB	5:1

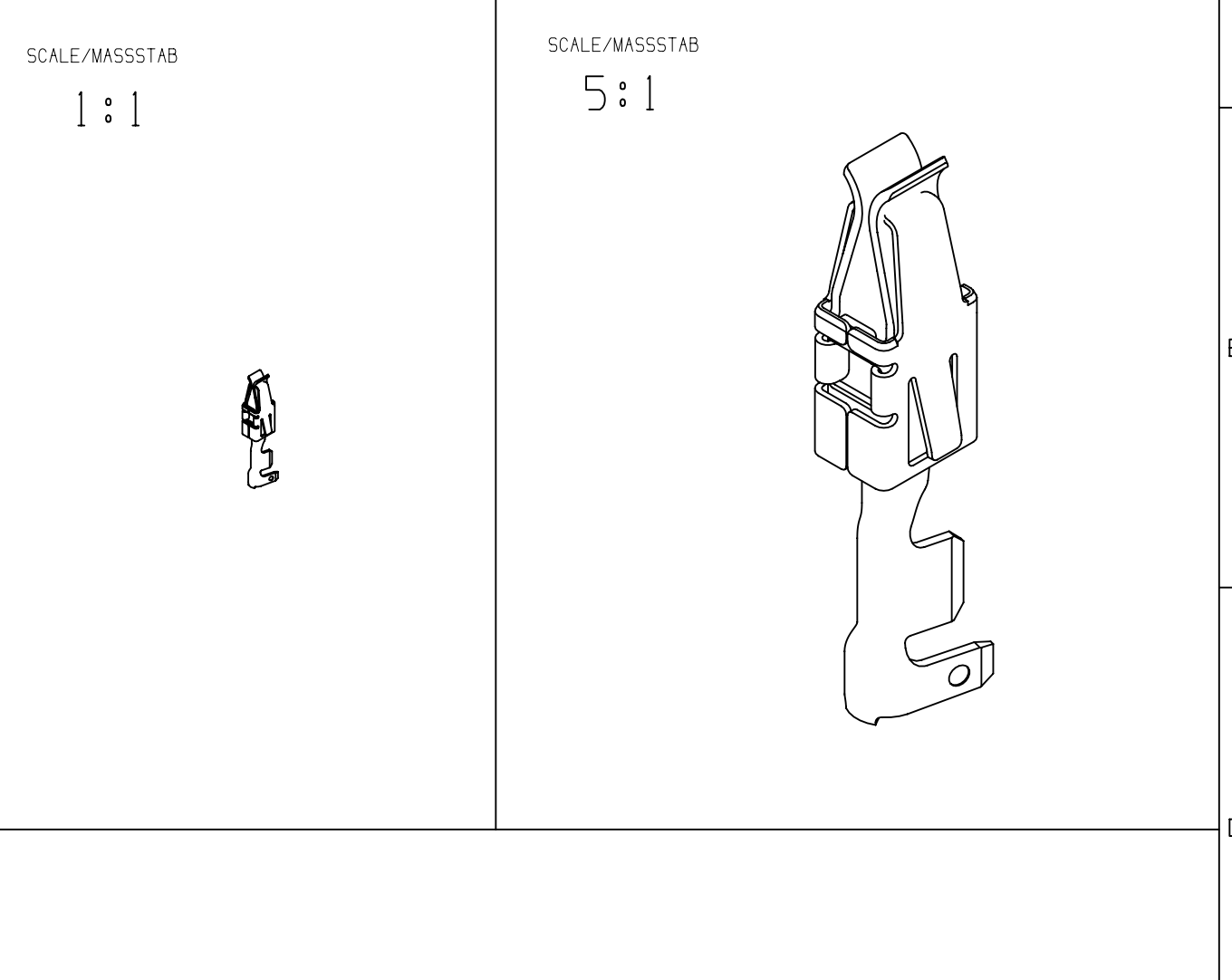

CONNECTION SYSTEMS ARE ONLY AVAILABLE ON THE SERVER