

FISHER & PAYKEL

BUILT-IN COFFEE MAKER

PROFESSIONAL

EB76PSX1 models

INSTALLATION GUIDE

NZ AU

IMPORTANT SAFETY INSTRUCTIONS!

Installation

⚠ WARNING!	
	<p>Cut Hazard Take care – some edges are sharp. Failure to use caution could result in injury or cuts.</p>

Checking for transport damage

After removing the packaging, make sure the product is complete and undamaged and that all accessories are present. Do not use the appliance if it is visibly damaged. Contact Customer Care.

IMPORTANT!

- Installation must be performed by a qualified professional in compliance with legislation in force in the country of installation.
- The packing elements (plastic bags, polystyrene foam, etc.) should be kept out of reach of children.
- Never install the appliance in rooms where the temperature may drop to 0°C or lower.
- Customise the water hardness as soon as possible following the instructions in your user guide.
- This appliance can be installed over a built-in oven if the latter is fitted with a cooling fan at the rear (maximum microwave power: 3 kW).
- Connecting the appliance
- Danger! Check that the mains power supply voltage corresponds to the value indicated on the rating plate on the bottom of the appliance.
- Connect the appliance to an efficiently earthed and correctly installed socket with a minimum current rating of 10A only.
- Do not allow children and animals to stop or linger near the appliance when it is pulled out of the cabinet.
- If the power socket does not match the plug on the appliance, have the socket replaced with a suitable type by a qualified professional. To comply with safety directives, an omnipolar switch with a minimum contact distance of 3 mm must be installed.
- Do not use multiple sockets or extensions.

- If the power socket does not match the plug on the appliance, have the socket replaced with a suitable type by a qualified professional. To comply with safety directives, an omnipolar switch with a minimum contact distance of 3 mm must be installed.
- Do not use multiple sockets or extensions.
- Safety cutout devices must be included in the mains power supply in compliance with the installation regulations in the country concerned.
- This appliance conforms to EC Regulation 1935/2004 on materials and articles intended to come into contact with food.
- Do not allow children and animals to stop or linger near the appliance when it is pulled out of the cabinet-.
- Do not leave the machine pulled out of the cabinet when it is being used.
- Do not leave the machine pulled out of the cabinet when it is not needed.
- Install the machine according to the instructions in the handbook to guarantee there are no spills when it is pulled out from the cabinet.
- The rails fixing panel must have a thickness suited to the fixing screws supplied standard.
- The panel material must be suited to the machine weight of approximately 25kg.

DISPOSAL

- The appliance must not be disposed of with household waste, but taken to an authorised waste separation and recycling centre.

IMPORTANT!
SAVE THESE INSTRUCTIONS

INSTALLATION CONSIDERATIONS

PRIOR TO INSTALLATION

Prior to installing your coffee maker, ensure the following:

- The countertop and coffee maker cavity are square and level, and are the required dimensions.
- The installation will comply with all clearance requirements and applicable standards and regulations.
- The isolating switch will be easily accessible to the customer with the coffee maker installed.
- The electrician provides sufficient free length of power supply cable to reach from the bottom rear of the cavity to at least 1.5m in front of the bottom edge of the opening.
- The cable may enter the cavity from the side, top or bottom, but top entry must be at the rear of the cavity.
- The coffee maker connection socket (if fitted) is outside the cavity if the appliance is flush to the rear wall.
- The coffee maker will rest on a surface that can support its weight.
- The height from the floor suits the customer.
- You consult local building authorities and by-laws if in doubt regarding installation.

WARNING!

Some environmental factors and cooking habits can cause condensation in and around the coffee maker during use. To protect surrounding cabinetry from possible damage caused by frequent or excessive condensation, we recommend moisture-proofing the oven cavity.

DURING INSTALLATION

During installation, please ensure the following:

- The coffee maker can be used fully without obstruction.
- The power supply cable does not touch any hot metal parts.
- The isolating switch is easily accessible to the customer with the coffee maker installed.
- You complete the 'Final checklist' at the end of the installation.
- If, after following the instructions given, correct performance cannot be achieved, please contact your nearest Fisher & Paykel Service Centre, Customer Care, or contact us through our local website listed at the end of this document.

WARNING!

Take extra care not to damage the lower trim of the coffee maker during installation. The trim is important for correct air circulation and allows the coffee maker to move without obstruction.

The manufacturer does not accept any responsibility for damage resulting from incorrect installation.

- The coffee maker must be installed in a column and the column must be firmly fixed to the wall with commercially available brackets.
- The cabinet material must be able to withstand heat.
- To guarantee correct ventilation, leave a gap in the cabinet according to the measurements under cabinetry dimensions.

COMPONENTS REQUIRED

PARTS SUPPLIED

- Keep all packing materials until the unit has been inspected.
- Inspect the product to ensure there is no shipping damage. If any damage is detected contact the dealer or retailer you bought the product from to report the damage.
- Fisher & Paykel is not responsible for shipping damage.

Supplied



Mounting screws
(28)

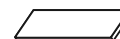

Spacers
(4 for side)
(4 for bottom)



Rails (2)



Clip (1)

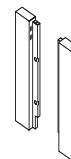

Side trims (2)



Lower trim (1)



Side/lower trim
screws (10)



3mm hex
key (1)

TOOLS REQUIRED

Not supplied

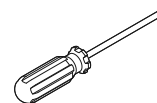

Crosshead
screwdriver



Power drill

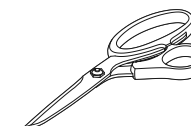

Scissors

PRODUCT DIMENSIONS

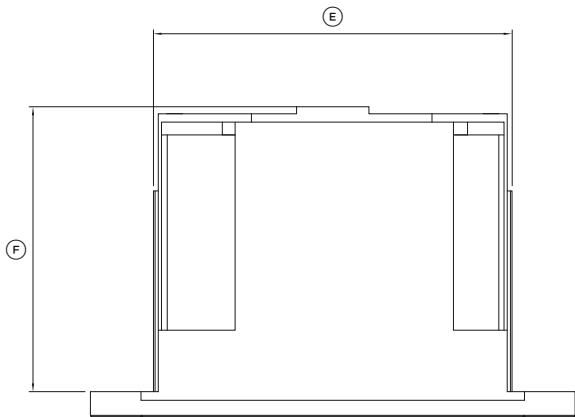

PLAN

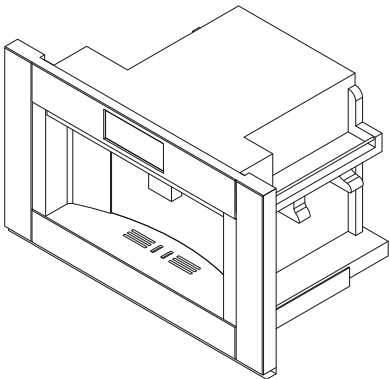

ISOMETRIC

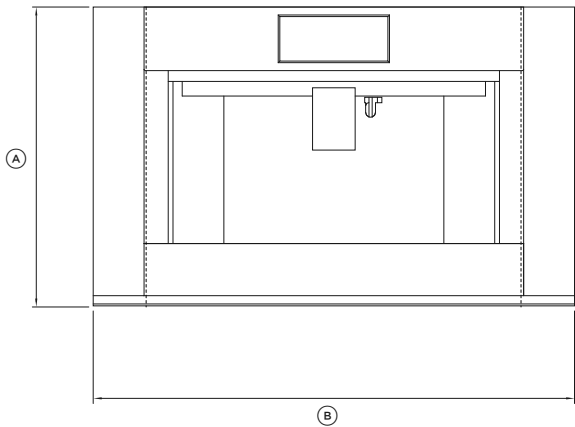

FRONT

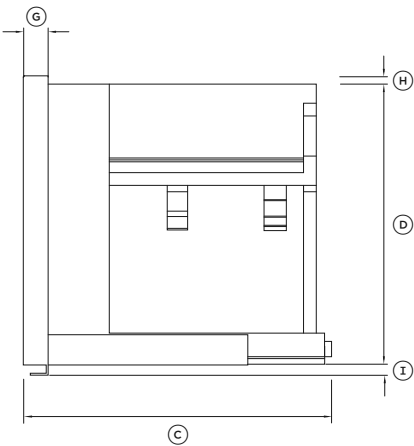

PROFILE

PRODUCT DIMENSIONS

EB76 MODELS

MM

Ⓐ Overall height	470
Ⓑ Overall width	757
Ⓒ Overall depth	484
Ⓓ Height of chassis	442
Ⓔ Width of chassis	560
Ⓕ Depth of chassis	445
Ⓖ Depth of coffee maker frame and control panel	39
Ⓗ Height of stepdown from top of control panel to top of chassis	13
Ⓘ Height of stepdown from bottom of chassis to bottom of lower trim	15

Actual product dimensions may vary by ± 2 mm.

CABINETRY DIMENSIONS (FLUSH INSTALL)

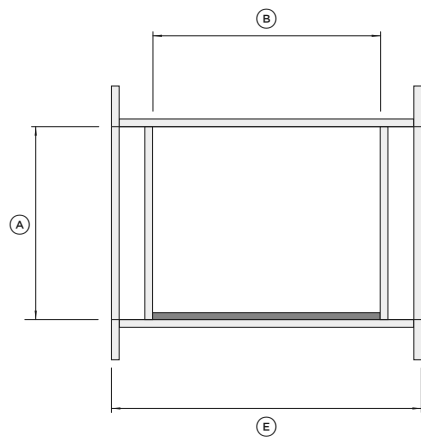

FRONT ELEVATION

without front panels

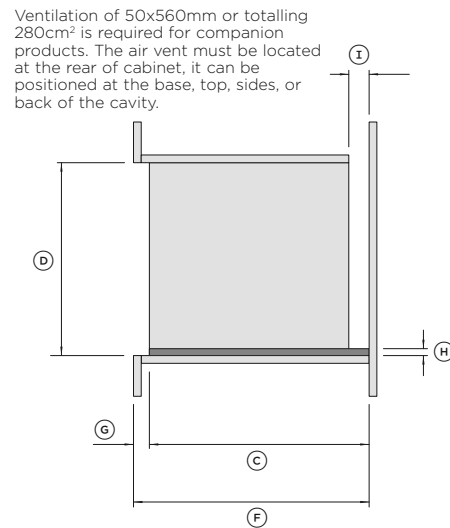

SIDE ELEVATION

with front panels

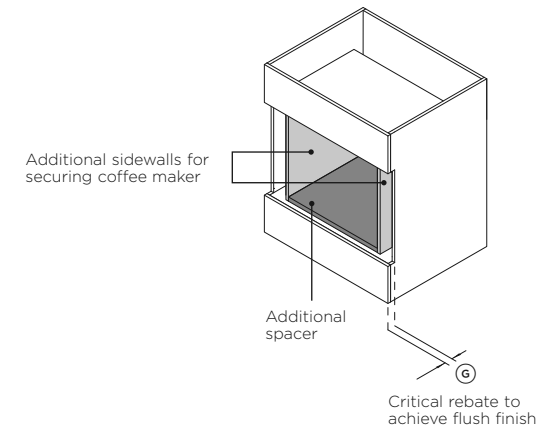
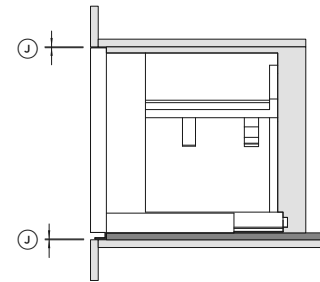

CAVITY DIMENSIONS

(A)	Minimum inside height of cavity and rebate
(B)	Inside width between additional sidewalls*
(C)	Minimum inside depth of cavity (from front of rebate)
(D)	Minimum height between cabinetry front panels
(E)	Overall width of cabinetry
(F)	Minimum overall depth of cavity (incl. front panel)
(G)	Rebate depth for flush install (incl. front panel)
(H)	Overall height of spacer in base of cavity
(I)	Ventilation gap
(J)	Minimum clearance to adjacent cabinetry or other appliances

EB76 MODELS

MM

474
560
560
474
762
600
39
16
50
2

*Cabinetry requires additional vertical sidewalls to secure the product.

DETAIL - PLAN VIEW

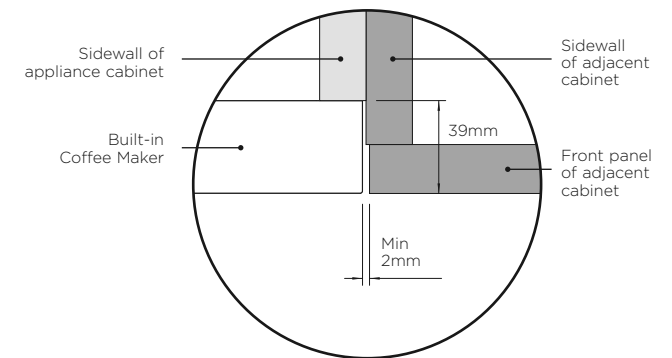

CABINETY DIMENSIONS (PROUD INSTALL)

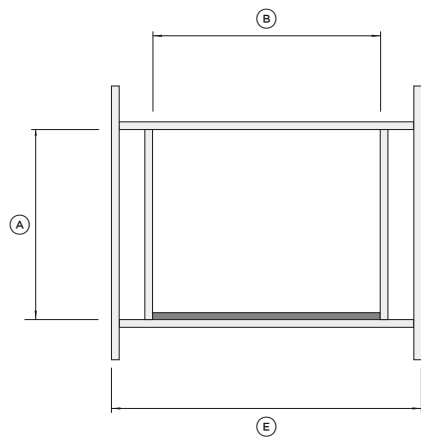

FRONT ELEVATION

without front panels

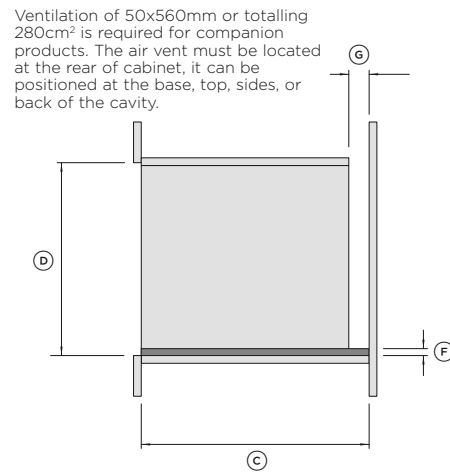

SIDE ELEVATION

with front panels

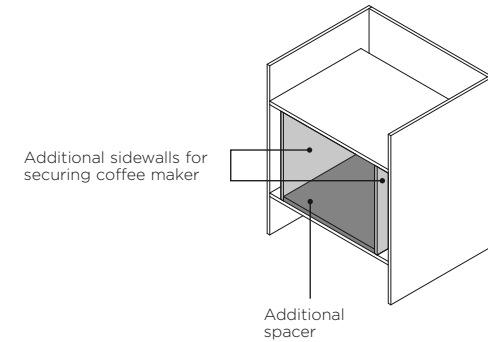
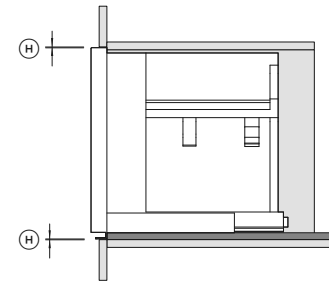

CAVITY DIMENSIONS

(A)	Minimum inside height of cavity
(B)	Inside width between additional sidewalls*
(C)	Minimum inside depth of cavity
(D)	Minimum height between cabinetry front panels
(E)	Overall width of cabinetry
(F)	Overall height of spacer in base of cavity
(G)	Ventilation gap
(H)	Minimum clearance to adjacent cabinetry or other appliances

EB76 MODELS

MM

467
560
560
474
762
16
50
2

*Cabinetry requires additional vertical sidewalls to secure the product.

DETAIL - PLAN VIEW

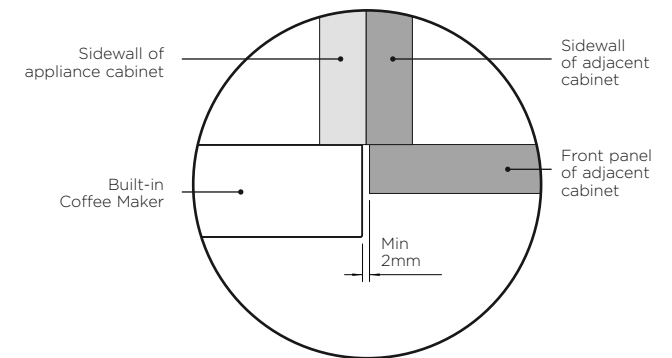

ELECTRICAL CONNECTION

Before placing the coffee maker into the cavity:

- Route the power cord into the back of the cavity and plug it in to the switched socket.
- The switched socket should be in an easily accessible area within 900mm of the centre rear of the product.

Note: All electrical work may only be carried out by suitably qualified and competent persons in accordance with national and local safety regulations.
This coffee maker must be grounded.

Power requirements

POWER	HZ	VOLTAGE (V)	PRESSURE
1350 W	50-60 Hz	220-240 V	1.5MPa

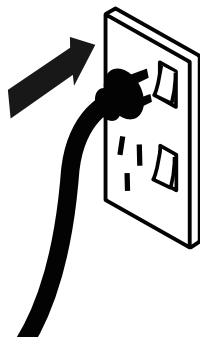

ATTACH THE TRIM TO THE COFFEE MAKER

Before installing the coffee maker in the cabinetry, the side trims and lower trim need to be attached.

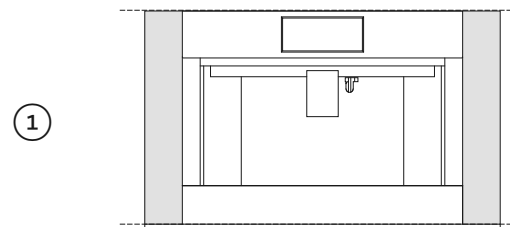

Align the side trims on either side of the coffee maker, using the locating tabs and corresponding slots.

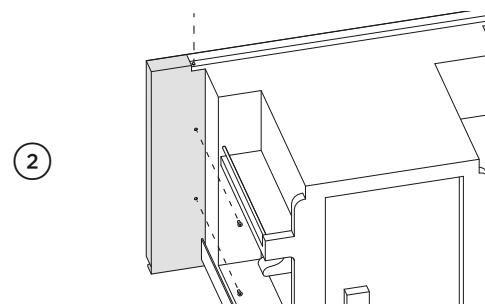

Attach the side trims using the hex key and 6 of the screws provided.
Do not over-tighten.

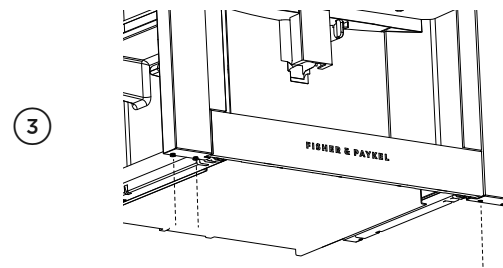

Attach the 4 remaining screws to the base of the side trims.
Only screw halfway in so the lower trim can be mounted.

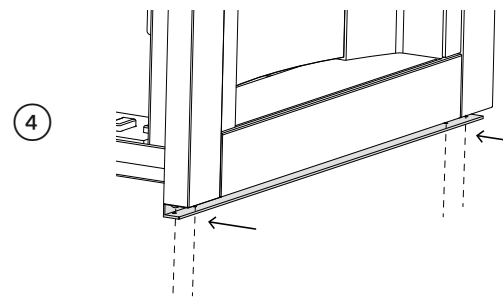

Slot the lower trim onto the screws, using the locating slots.
Ensure the screws are seated as far as possible into the the locating slots.
Pull the side trims forward so the lower trim is flush with the back edges.
Tighten the screws to secure.

SECURE THE COFFEE MAKER TO THE CABINETRY

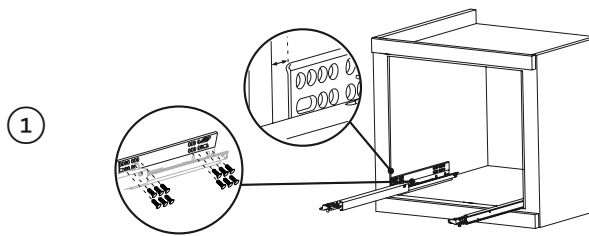

Position the rails on the sides of the cabinet.

Fix with the screws provided, then extract them completely.

- If the coffee maker is installed over a warmer drawer, use the top surface of this as a reference to position the rails.
- In this case, there will be no surface to rest the rails on.

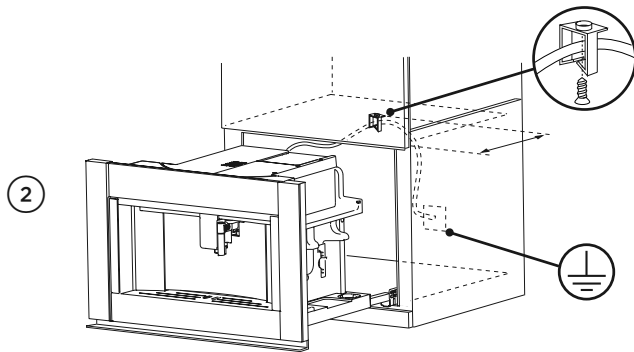

Fix the power cable with the clip.

The power cable must be long enough to allow the appliance to be extracted from the cabinet to fill the coffee bean container.

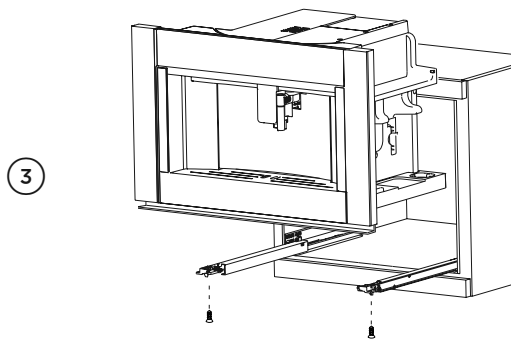

Position the appliance on the rails, making sure the pins are correctly inserted in the housings, then fix it with the screws supplied.

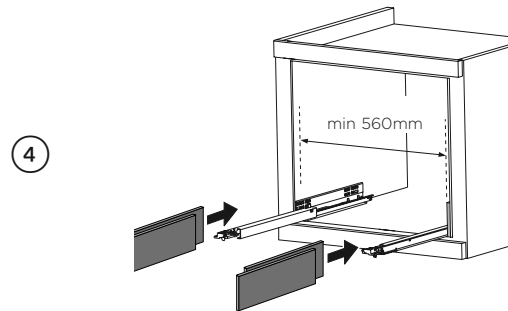

If necessary, correct alignment of the appliance by positioning the spacers supplied under or at the sides of the support.

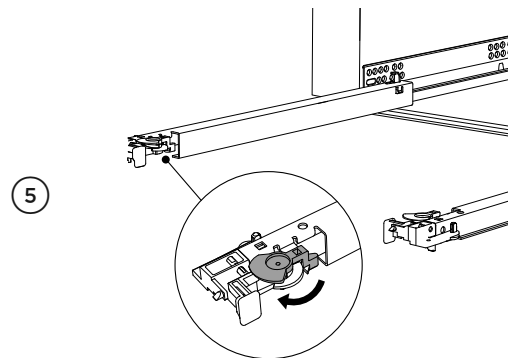
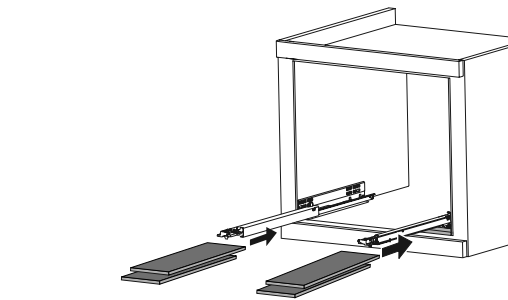

Use the levers at the front of the rails to adjust the height of the appliance.

INSTALLER CHECKLIST

TO BE COMPLETED BY THE INSTALLER

- | | |
|---|---|
| <input type="checkbox"/> Make sure the coffee maker is level and securely fitted to the cabinetry. | <input type="checkbox"/> Turn the power to the coffee maker on. The display should turn on. |
| <input type="checkbox"/> Check the lower trim is undamaged. | <input type="checkbox"/> Fill the water tank to the indicated level. |
| <input type="checkbox"/> Check there is adequate clearance. This is to ensure correct air circulation. | <input type="checkbox"/> Have you demonstrated basic operation to the customer? |
| <input type="checkbox"/> Make sure any cable ties and internal packaging has been removed from the coffee maker. | |
| <input type="checkbox"/> Make sure all vents and openings are clear and free of any obstruction or damage. Failure to make sure all vents are clear may result in poor product performance. | |
| <input type="checkbox"/> Make sure the isolating switch is accessible to the customer. | |

Complete and keep for safe reference:

Model	_____
Serial No.	_____
Purchase Date	_____
Purchaser	_____
Dealer Address	_____
Installer's Name	_____
Installer's Signature	_____
Installation Company	_____
Installation Date	_____

FISHERPAYKEL.COM

© Fisher & Paykel Appliances 2021. All rights reserved.

The models shown in this guide may not be available in all markets
and are subject to change at any time.

The product specifications in this guide apply to the specific products and
models described at the date of issue. Under our policy of continuous product
improvement, these specifications may change at any time.

For current details about model and specification availability in your country,
please go to our website or contact your local Fisher & Paykel dealer.

592843A 12.21