

The Haier logo is displayed in white text on a dark grey rectangular background in the top right corner of the page.

Haier

90cm Ovens

HWO90S11EB3, HWO90S16TB3, HWO90S16TG3,
HWO90S17TPB3, HWO90S17TPG3

CONTENTS

Safety and warnings	5
Components required	9
Product dimensions	10
Cabinetry dimensions	11
Check cavity	12
Connect power	13
Fit the product	14
Installer checklist	15

⚠ WARNING!



Electric Shock Hazard

Turn the oven off at the wall before replacing the oven lamp or before carrying out any work or maintenance on it.

Failure to follow this advice may result in electrical shock or death.

⚠ WARNING!



Fire Hazard

Failure to follow this advice may result in serious burns or death.

Do not place aluminium foil, dishes, trays, water or ice on the oven floor during cooking, as doing so will irreversibly damage the enamel; lining the oven with aluminium foil or single use protection available from stores may cause fire.

Never use your appliance for warming or heating the room. Persons could be burned or injured or a fire could start.

Storage in or on appliance: flammable materials should not be stored in an oven or near its surface.

Failure to follow this advice may result in overheating, burning, and injury.

⚠ WARNING!



Cut Hazard

Take care during installation of the oven - some edges are sharp.

Failure to use caution could result in injury or cuts.

⚠ WARNING!



Hot Surface Hazard

Accessible parts may become hot when in use. To avoid burns and scalds, be careful not to touch any hot part and keep children away.

Use oven mitts or other protection when handling hot surfaces such as oven shelves or dishes.

Use care when opening the oven door. Let hot air or steam escape before removing or replacing food.

Do not touch heating elements or interior surfaces of the oven. Heating elements may be hot even though they are dark in colour.

Interior surfaces of an oven become hot enough to cause burns.

During and after use, do not touch, or let clothing or other flammable materials contact heating elements or interior surfaces of the oven until they have had sufficient time to cool. Other surfaces of the appliance may become hot enough to cause burns - among these surfaces are the oven vent, the surface near the oven vent, and the oven door.

Failure to follow this advice could result in burns and scalds.

READ AND SAVE THIS GUIDE

IMPORTANT SAFETY INSTRUCTIONS

To reduce the risk of fire, electrical shock, injury to persons or damage when using the oven, follow the important safety instructions listed below. Read all the instructions before using the oven. Use the oven only for its intended purpose as described in these instructions.

General

- Be sure your appliance is properly installed and earthed by a qualified technician.
- Isolating switch: make sure this oven is connected to a circuit which incorporates an isolating switch providing full disconnection from the power supply in accordance with the wiring rules.
- The yellow-green earth cable should not be interrupted by the device and must be easily accessible when the appliance is installed.
- Household appliances are not intended to be played with by children.
- IF THE OVEN IS PROVIDED BY THE MANUFACTURER WITHOUT THE PLUG, THE APPLIANCE MUST NOT BE CONNECTED TO THE POWER SOURCE USING PLUG OR SOCKETS, BUT MUST BE DIRECTLY CONNECTED TO THE SUPPLY MAINS.
- Children should not be left alone or unattended in the area where the appliance is in use. They should never be allowed to sit or stand on any part of the appliance.
- Children of less than 8 years old must be kept away from the appliance unless continuously supervised. This appliance can be used by children aged from 8 years and above, and persons with reduced physical, sensory or mental capabilities or lack of experience and knowledge, if they have been given supervision or instruction concerning the use of the appliance in a safe way and they understand the hazards involved.
- Cleaning and user maintenance shall not be done by children without supervision.
- Do not place heavy objects on the oven door.
- Wear proper apparel. Do not wear loose fitting or hanging garments when using the appliance. They could ignite or melt if they touch an element or hot surface and you could be burned.
- User servicing: do not repair or replace any part of the appliance unless specifically recommended in the manual. All other servicing should be referred to a qualified technician.
- Do not use water on grease fires. Smother the fire or flame or use a dry chemical or foam type extinguisher.
- Use only dry oven mitts or potholders. Moist or damp potholders on hot surfaces could result in burns from steam. Do not let potholders touch hot areas or heating elements. Do not use a towel or a bulky cloth for a potholder as it could catch fire.
- Do not heat unopened food containers. They can build up pressure that may cause the container to burst and result in injury.
- Safe food handling: leave food in the oven for as short a time as possible before and after cooking. This is to avoid contamination by organisms which may cause food poisoning. Take particular care during warm weather.
- Always keep oven vents unobstructed.
- Do not operate your appliance by means of an external timer or separate remote-control system.
- Caution: Hot air can blow from the vent at the top of the oven as part of the oven's cooling system.
- Placement of oven shelves: always position shelves in the desired location while the oven is cool (before preheating). If a shelf must be removed while the oven is hot, do not let the oven mitts or potholder contact hot heating elements in the oven or the base of the oven.
- When you place the shelf inside, make sure that the stop is directed upwards and in the back of the cavity. The shelf must be inserted completely into the cavity.
- Do not clean the oven seal or use any oven-cleaning products on it. It is essential for a good seal,

SAFETY AND WARNINGS

which ensures that the oven operates efficiently. Care should be taken not to rub, damage or move it.

- Do not use oven cleaners, harsh/abrasive cleaning agents, waxes, or polishes. No commercial oven cleaner, oven liner, or protective coating of any kind should be used in or around any part of the oven.
- Do not use harsh/abrasive cleaners, scourers or sharp metal scrapers to clean the oven door glass since they scratch the surface, which may result in the glass shattering.
- Clean only the parts listed in this manual.
- Do not use a steam cleaner to clean any part of the oven.
- Do not store things children might want above the oven. Children could be burned or injured while climbing on the oven to retrieve items.
- Do not install or operate the appliance if it is damaged or not working properly. If you receive a damaged product, contact your dealer or installer immediately.
- Use only bakeware approved for oven use. Follow the bakeware manufacturer's instructions.
- No additional operation/setting is required in order to operate the appliance at the rated frequencies.
- If the power cable is damaged, it should be substituted with a cable or special bundle available from the manufacturer or by contacting the customer service department. The type of power cable must be H05V2V2-F. This operation must be carried out by a suitably qualified professional. The earth conductor (yellowgreen) must be approximately 10 mm longer than the other conductors. For any repairs, refer only to the Customer Care Department and request the use of original spare parts. Failure to comply with the above can compromise the safety of the appliance and invalidate the guarantee.
- The oven must be switched off before removing the removable parts. After cleaning, reassemble them according to the instructions.
- **WARNING:** Never remove the oven door seal.
- When inserting the grid tray pay attention that the anti-slide edge is positioned rearwards and upwards
- The appliance must not be installed behind a decorative door in order to avoid overheating.
- The oven can be located high in a column or under a worktop. Before fixing, you must ensure good ventilation in the oven space to allow proper circulation of the fresh air required for cooling and protecting the internal parts. Make the openings specified on last page according to the type of fitting. Always fix the oven to the furniture with the screws provided with the appliance.

COMPONENTS REQUIRED

TOOLS

Supplied

☐ Screws (4)

Not supplied

☐ Powered driver

☐ Cross-head screwdriver

PRODUCT DIMENSIONS

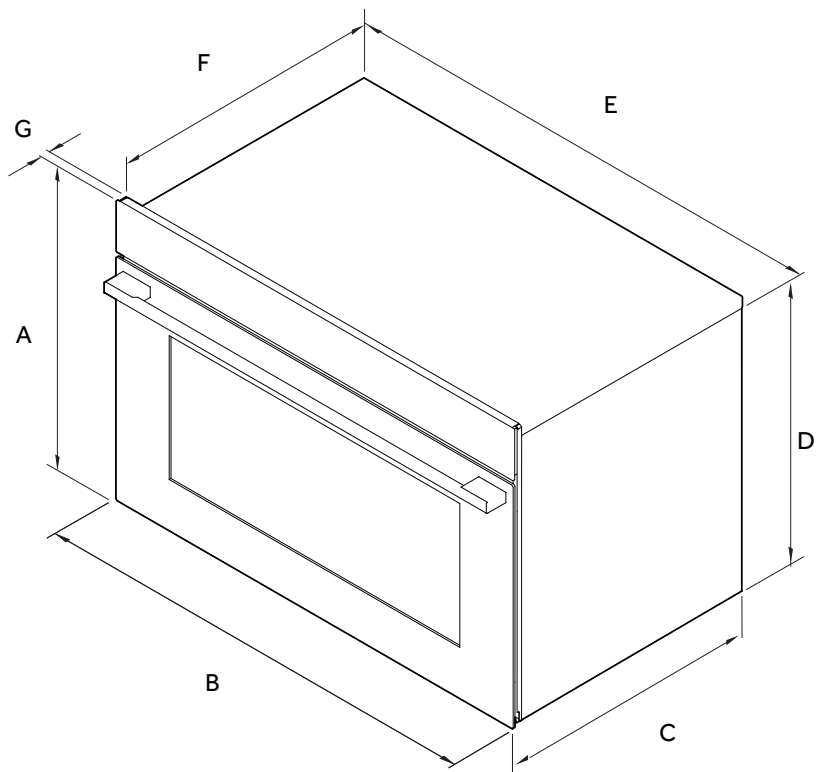

Product dimensions		mm
A	Overall height of oven	594
B	Overall width of oven	895
C	Overall depth of oven	574
D	Height of chassis	575
E	Width of chassis	856
F	Depth of chassis	554
G	Depth of oven frame and control panel (distance between front of chassis and front of oven door)	20

CABINETRY DIMENSIONS

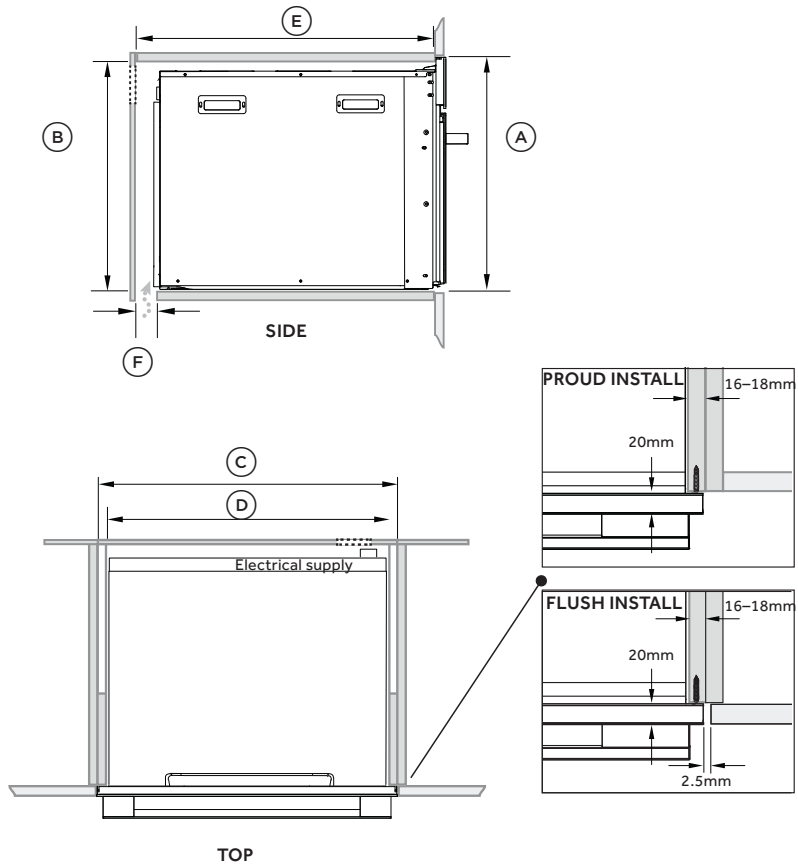

		mm
A	Overall height of cabinetry	597
B	Minimum inside height of cavity	590
C	Overall width of cabinetry	900
D	Minimum inside width of cabinetry	864
E	Minimum inside depth of cabinetry	580
F	Ventilation air vent	20

Note: If installing a cooktop above the oven, ensure adequate clearance is provided for the cooktop as per the cooktop manufacturer's instructions.

If installing the oven under a worktop, ensure the top rail has been removed to provide airflow around the product.

CHECK CAVITY

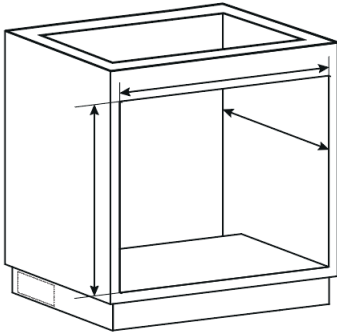

1. Measure cavity dimensions.
Ensure all minimum specifications
have been met.

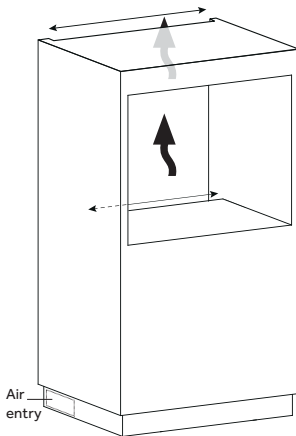

2. Ensure any cooktop ventilation
requirements have been considered.

CONNECT POWER

- This oven must be connected to the mains power supply only by a suitably qualified person.
- The mains lead must not be clamped, bent, trapped, or come into contact with hot parts of the appliance.
- This oven must be earthed.
- Before connecting the oven to the mains power supply, check that:
 - The domestic wiring system is suitable for the power drawn by the oven (as specified on the rating plate)
 - The voltage corresponds to the value given on the rating plate.

MODEL CODE	HW090S series
VOLTAGE	220-240V
FREQUENCY	50Hz
TOTAL POWER	4800W
TOP ELEMENT	1200W
GRILL ELEMENT	1800W
BOTTOM ELEMENT	1800W
CIRCULAR ELEMENTS	1500W + 1500W
FAN	-

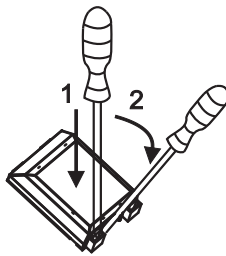

1. Use a screwdriver to open the connector cover at the rear of the appliance.
2. Release the two locks located at either side of the connector bottom, and run the mains lead through the relief safety device to protect it from disconnection.
3. Tighten the relief device securely and close the connector cover.

Colour code

The wires in the mains lead are coloured in accordance with the following code:

- L = LIVE, coloured red or brown for single-phase.
- N = NEUTRAL, coloured light blue or black. Beware of the correct N-connection!

 EARTH = coloured green and yellow.

- Cable of correct size rating must be used.
- The earth wire shall be longer than the other wires.

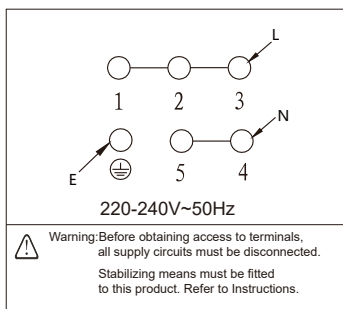

FIT THE PRODUCT

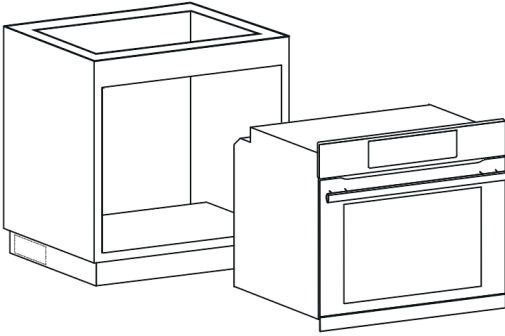

1. Lift the product into the cavity, align it with surrounding cabinetry and appliances.

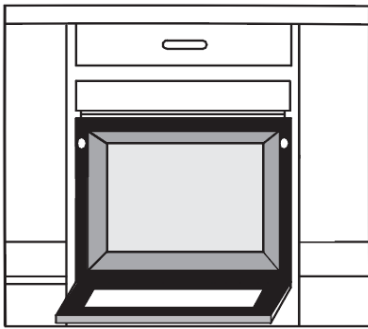

2. Using the product as a guide, pre-drill 4 x 3mm pilot holes.

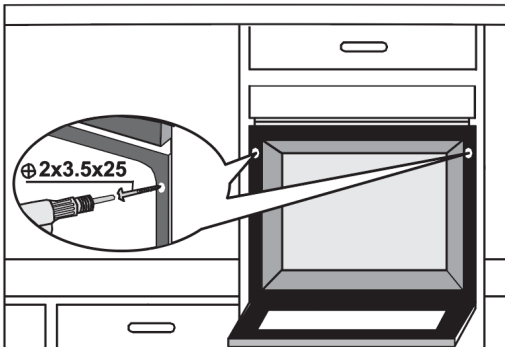

3. Secure the oven to the cavity using the 4 x #3.5x25 screws provided.

INSTALLER CHECKLIST

To be completed by the installer

- ☐ Ensure the oven is level and securely fitted to the cabinetry.
- ☐ Open the oven door slowly until it is fully open, and check there is adequate clearance between the bottom of the door and the lower trim. This is to ensure correct air circulation. Should the lower trim become damaged, straighten the trim and ensure the oven door opens fully without obstruction.
- ☐ Remove all internal packaging before using the oven.
- ☐ Ensure all oven vents and openings are clear and free of any obstruction or damage. Failure to make sure all oven vents and openings are clear may result in poor product performance.
- ☐ Ensure the isolating switch is accessible by the customer.

Complete and keep for safe reference:

Model _____

Serial no. _____

Purchase date _____

Purchaser _____

Dealer address _____

Installer's name _____

Installer's signature _____

Installation company _____

Installation date _____



WWW.HAIER.COM.AU
WWW.HAIER.CO.NZ

432722A | 04.25