

FISHER & PAYKEL

RECIRCULATION KIT

KRECIRCDDFT

INSTALLATION GUIDE

US CA

COMPONENTS REQUIRED

TOOLS

Not supplied

- ☐ Crosshead screwdriver
- ☐ Silicone - optional

PARTS

Supplied and required

- ☐ 1x Filter Box
- ☐ 1x Carbon Filter
- ☐ 1x Stainless Steel Grille
- ☐ 4x Crosshead wood screws
- ☐ 2x Crosshead machine screws

Not supplied

- ☐ Metal Ducting*
- ☐ AD325X12X10 **
Adapter 3.25" x 12" to 3.25" x 10"
- ☐ Drive Cleats
- ☐ S Cleats
- ☐ Aluminium Tape

COMPATIBLE PRODUCTS

- | | |
|---|--|
| <input type="checkbox"/> CD5DB1
5" Series 11 Modular Auxiliary
Downdraft | <input type="checkbox"/> CID364DTB4
36" Series 9 4 Zone Induction Cooktop
with Integrated Ventilation |
|---|--|

* Ducting must be purchased separately.
KRECIRCDDFT Recirculation Kit outlet is designed for 3.25" x 12" metal ducting.
CD5DB1 Modular Auxiliary Downdraft external blower outlet is designed for 3.25" x 12" metal ducting.
CID364DTB4 36" Induction Cooktop with Integrated Ventilation is designed for 3.25" x 10"

** Available to purchase separately via fisherpaykel.com (compatible with CID364DTB4).

ACCESSING YOUR PRODUCT SPECIFICATIONS



For full product, cabinetry and service specifications, refer to the Planning Guide. To access the Planning Guide, scan the QR code or visit fisherpaykel.com/specify. Search by appliance type, product name or model code.

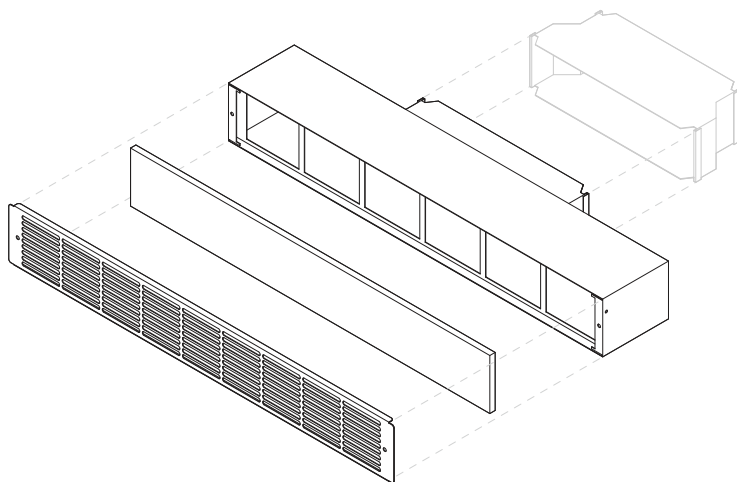

IMPORTANT

Installation work must be done by qualified person(s) in accordance with all applicable codes and standards.

PRIOR TO INSTALLATION

Plan ducting layout

Design duct route and plan sequence of installation. This will be specific to cabinetry design and appliance placement.

Ensure cabinetry and servicing specifications have been met and clearances have been considered.

Refer to individual cooktop Planning Guides for details.

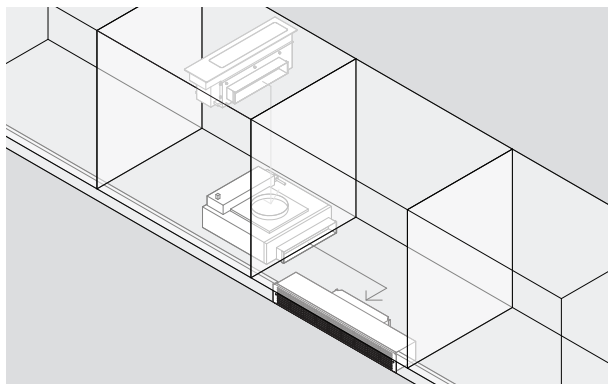

CD5DB1 models only:
Example duct route.

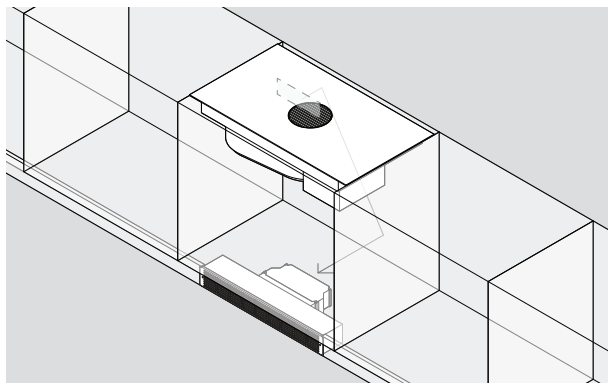

CID364DTB4 models only:
Example duct route.

PREPARATION

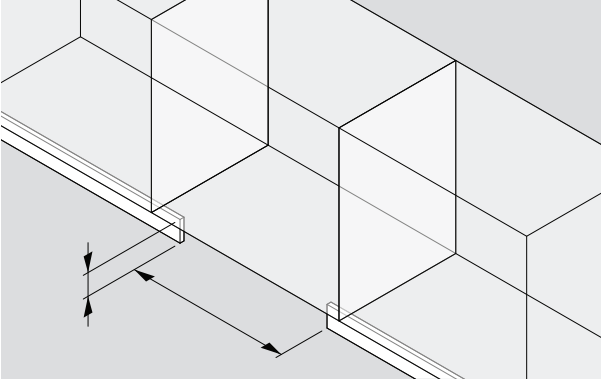

1. Create a 27 3/4" x 3 7/8" (705 x 99mm) cutout in toe kick for recirculation kit.

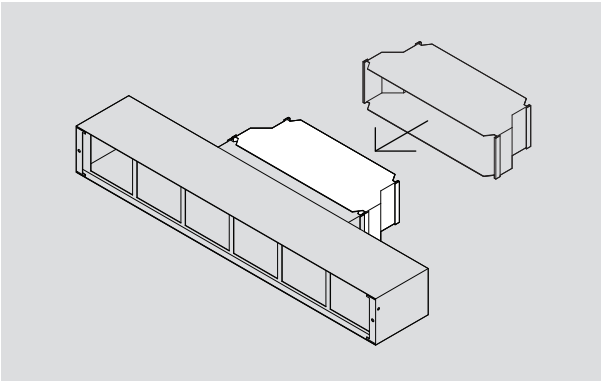

2. If required, connect adapter to filter box.

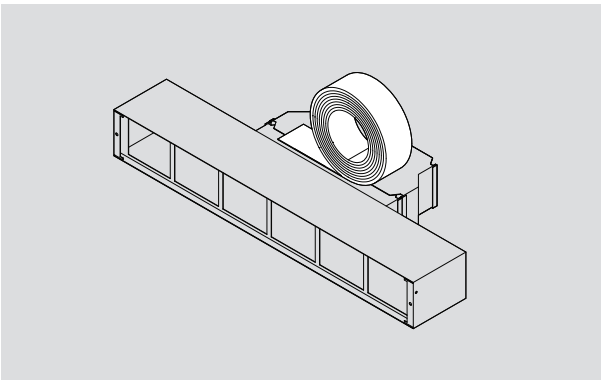

3. If required, pre-assemble metal ducting to filter box.

4. Secure ducting with drive and S cleats as required and seal all joins with aluminium tape.

INSTALLATION

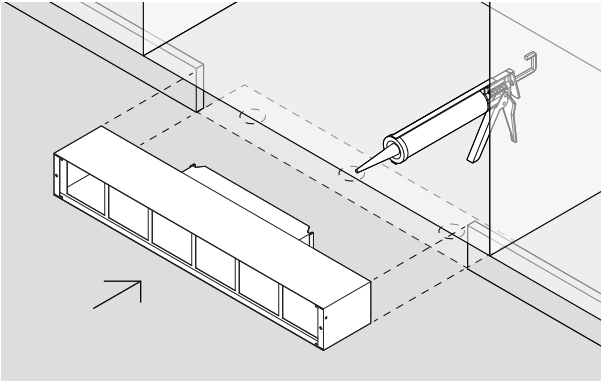

1. Position filter box in cutout. If required, use adhesive to secure.

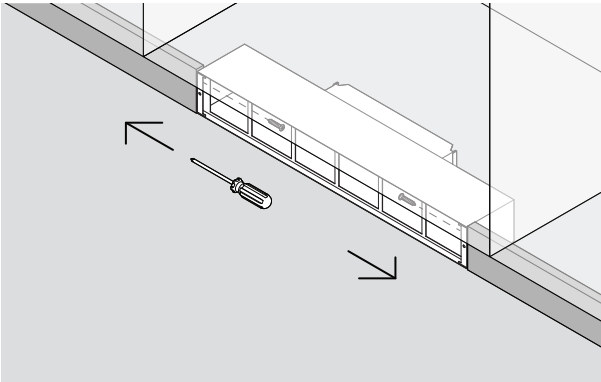

2. If required, secure filter box to cabinetry with wood screws supplied. If not secured previously, attach and seal ducting to product outlet.

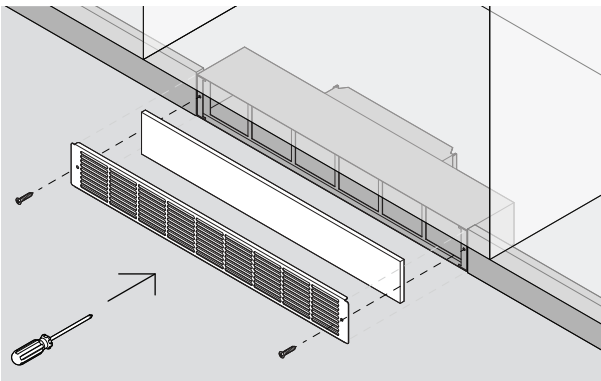

3. Align filter and grille. Ensure the filter is placed evenly over cutout so air cannot bypass it. Secure grille to filter box with machine screws supplied.

INSTALLER CHECKLIST

TO BE COMPLETED BY THE INSTALLER

GENERAL

- ☐ Only metal ducting has been used.
- ☐ Recirculation Kit has been securely fastened.
- ☐ Ducting has been secured.
- ☐ All duct joints have been sealed with aluminium tape.

Complete and keep for safe reference:

Model	_____
Serial no.	_____
Purchase date	_____
Purchaser	_____
Dealer address	_____
Installer's name	_____
Installer's signature	_____
Installation company	_____
Installation date	_____

FISHERPAYKEL.COM

© Fisher & Paykel Appliances 2025. All rights reserved.

The models shown in this guide may not be available in all markets
and are subject to change at any time.

The product specifications in this guide apply to the specific products and
models described at the date of issue. Under our policy of continuous product
improvement, these specifications may change at any time.

For current details about model and specification availability in your country,
please go to our website or contact your local Fisher & Paykel dealer.

432900A 03.25