

LICENSE AGREEMENT

Static Control Components, Inc. (Static Control) grants this limited license to the person, firm or corporation (hereinafter "User") downloading electronically or by printing this file to use Static Control's copyrighted documents in accordance with the terms of this agreement. If you agree with the terms of the license then you may download this information. If you do not agree with the terms of the license, then you are not authorized to use this information, and any use of it may be in violation of Static Control's copyrights or trademarks.

TRADEMARKS

The Static Control material herein may make reference to its own trademarks, or trademarks of others. Static Control grants a limited license to the User to use Static Control's trademarks in its internal documents and for its internal purposes on the following terms and conditions. Any use of Static Control's trademark must be used in a context which makes it clear that the product reference is a Static Control Components, Inc. product, and not a product from any source. The materials provided to the User may include reference to trademarks of others. Any use of the User makes of these marks should reference the owner of those marks. Nothing in this agreement constitutes any authorization by Static Control to use any of these trademarks in any context.

COPYRIGHTS

Static Control grants a limited license to the User to use the attached copyrighted documents. The permitted use of these documents is limited to internal purposes and needs of the company. The company is prohibited from using these copyrighted documents, or any part of them, including graphic elements, in any materials that are used outside the physical business location of the User. The User is prohibited from using any materials in any documents whether printed or electronic, which are distributed to any third party. The use of these copyrighted documents, or parts of them, including graphic elements, from these documents in marketing material, either print, electronic or web is prohibited. The sale, transfer, copying of these documents or any parts of these documents to any other party is prohibited.

Static Control Components, Inc. retains all rights to its copyrighted documents, and any use of these documents by User should reference Static Control's copyrights, with the notice "copyright Static Control Components, Inc."

Static Control reserves the right to cancel this license on 30-days written notice. All of the User's material incorporating Static Control's copyrighted documents shall be destroyed upon receipt of its notice of termination.

The User may not distribute, share, and otherwise convey the copyrighted documents to any other persons, corporations or individuals.

The User, by use of these documents, acknowledges Static Control's copyright in these materials.

STATIC CONTROL DOES NOT GUARANTEE OR WARRANT DOWNLOADED INFORMATION

The information User is downloading is published by Static Control in "as is" condition "with all faults". Static Control makes no representations or warranties of any kind concerning the quality, safety, or suitability of the downloadable materials, either express or implied, including without limitation any implied warranties of merchantability, fitness for a particular purpose, or non-infringement. Further, Static Control makes no representations or warranties as to the truth, accuracy or completeness of any statements, information or materials concerning items available for download. In no event will Static Control be liable for any indirect, punitive, special, incidental, or consequential damages however they may arise even if Static Control has been previously advised of the possibility of such damages.



Version 1 Revision 0 - April 2004
SYSTEM SUPPORT SERIES™

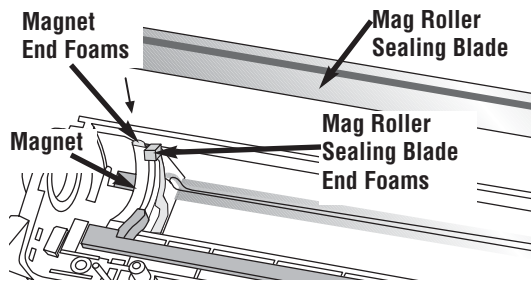

HP4300/4200 Mag Roller Sealing Blade (HP43MRSBLADE) Mag Roller Sealing Blade End Foams (4KMRSFOAM) and Mag Roller Magnet End Foams (HP43MRMAGEFM)

Product Description

When removing the Mag Roller Sealing Blade the Magnet End Foams and the Mag Roller Sealing Blade End Foams will become damaged and should be replaced. HP 4300/4200 toner hoppers require a mag roller magnet end foam to help insure against toner leakage. During the cartridge cycle the cells of this foam become compressed, and toner builds up on the surface. Foams that are pitted, torn or damaged, should be replaced.

For complete remanufacturing instructions for the HP4300/4200 refer to the System Support Series™ (SSS™) 473.

Contact your SCC Support Team for product information, ordering and technical support services.

WWW.SCC-INC.COM

US AND CANADA 800.488.2426 • INTERNATIONAL 919.774.3808 •
EUROPE +44 (0) 118.923.8800

US/CAN FAX: 800-488-2452 • INTERNATIONAL FAX 919-774-1287

All brand names and trademarks are for descriptive purposes only and are the property of their respective owners.

Product INSTRUCTIONS FOR:

HP4300/4200 Mag Roller Sealing Blade and Mag Roller Magnet End Foams

[GO TO WWW.SCC-INC.COM](http://WWW.SCC-INC.COM)

For the latest cartridge information

Click on "Online Engine Center"

Other System Support Series™ documents available in Adobe® Acrobat® format

QUESTIONS?

Please call one of our main numbers

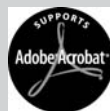

and ask for your Support Team Representative or E-mail us at:

US AND CANADA
info@scs-inc.com

UK
info@scceurope.co.uk

PRODUCT INSTRUCTIONS

This SSS™ provides the information needed to remove and replace the Mag Roller Sealing Blade, Sealing Blade End Foams, and the Mag Roller Magnet End Foams.

1. Remove the Mag Roller Sealing Blade from the cartridge, by peeling back one end and pulling across the cartridge.
2. Using Felt/Foam Scraper Tool (FSTOOL) remove the Mag Roller Sealing Blade End Foams.

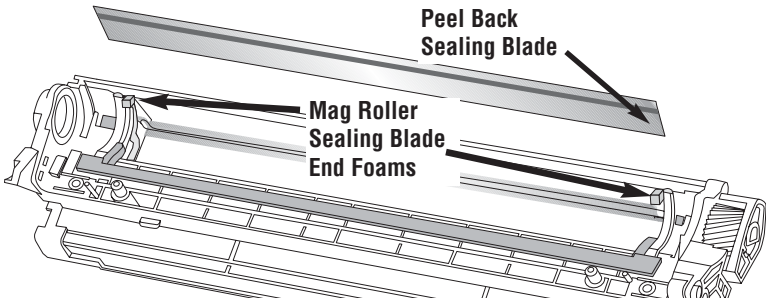

3. Using a Phillips Screwdriver remove the screw from the Drive Side End Plate; then, remove the end plate from the Mag section.

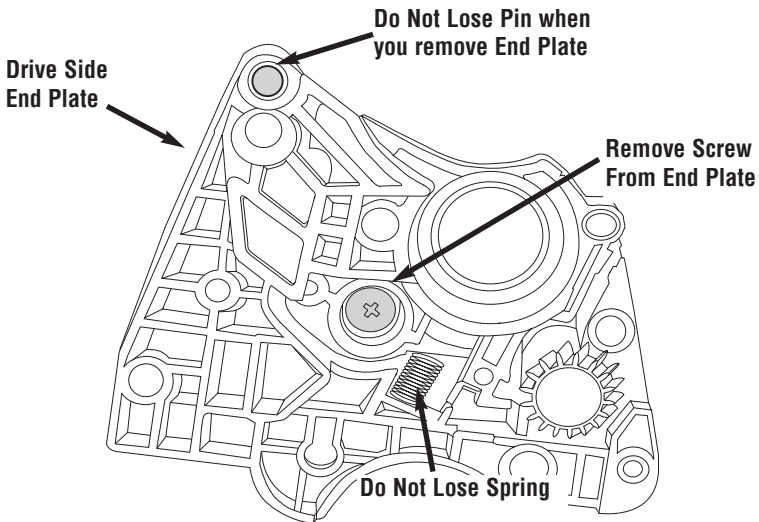

PRODUCT INSTRUCTIONS

4. Remove the Toner Sensor Bar; then, repeat Step 3 for the Contact Side End Plate.

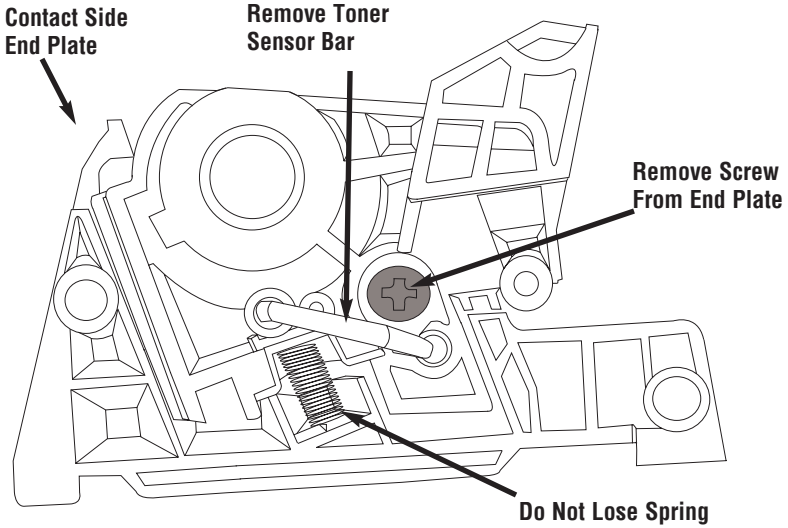

5. Lift the Drive Side Magnet forward, as shown, to expose the End Foam underneath. Remove the End Foam from the magnet; then, repeat this step on the Contact Side Magnet.



Caution: Magnets are brittle, and can break if not properly handled!

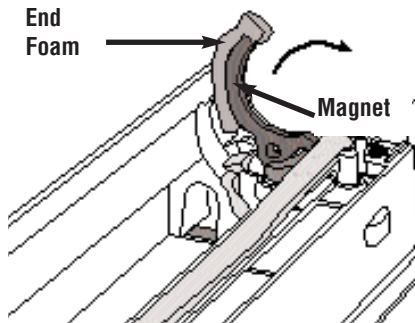

PRODUCT INSTRUCTIONS

6. Using a dry, lint free cloth and 91-99% Isopropyl Alcohol, clean any residual adhesive from the mounting surfaces of the Sealing Blade, Sealing Blade End Foams, and Magnet End Foams.
7. Peel the backing from the new Magnet End Foam, and attach foam, to the back of the Drive Side Magnet; then, push magnet back until it is fully seated in place. A small piece of foam will be exposed at the top of the magnet. Then repeat step for the Contact Side Magnet.

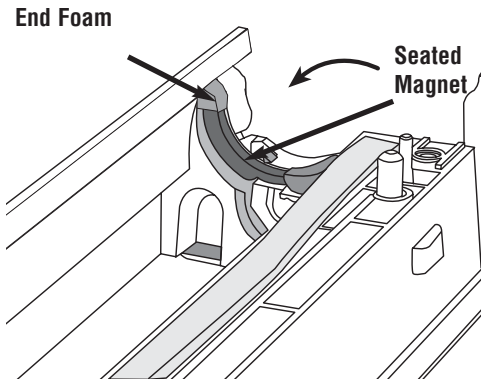

PRODUCT INSTRUCTIONS

8. Remove the adhesive backing from the Sealing Blade End Foams; then, place against the magnet and Magnet End Foam, just below the Sealing Blade mounting surface.



Note: For more information on the Mag Roller Sealing Blade End Foams reference SSS™ 197.

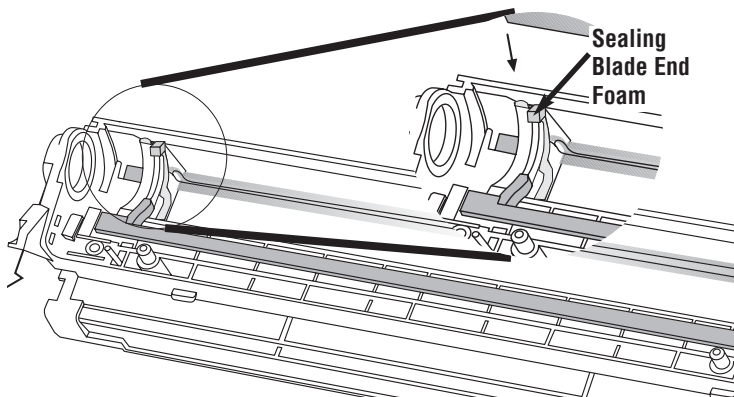

9. Peel the backing from the new Mag Roller Sealing Blade and place it on the cartridge. To keep the adhesive free from contaminants, use the Sealing Blade Tool (MRSBITOOL).

PRODUCT INSTRUCTIONS

10. Align the top edge of the Mag Roller Sealing Blades adhesive along the top edge of mag section; then, press firmly to activate the adhesive.

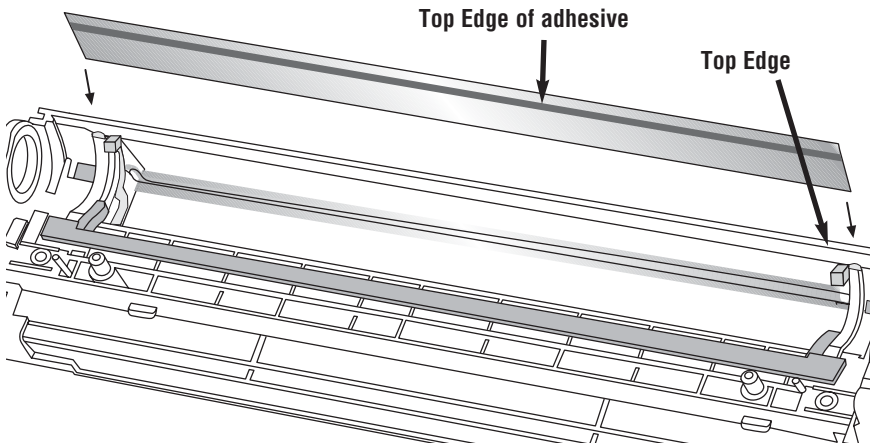

Note: When properly installed, the Mag Roller Sealing Blade will overlap the Mag Roller Sealing Blade End Foams and Mag Roller Magnets.

11. Reattach the end plates to each end to secure the magnets in place.



Imaging System Technology You Can Count On!

STATIC CONTROL INSTRUCTIONS

The development of quality products for the remanufacturing of printer cartridges, is the primary mission of our Imaging Labs. Through extensive testing and research, we develop the optimum combination of matched components for each cartridge system. Our engineering and manufacturing expertise provides us with total control in design, quality and development to produce products from the ground up. The result is a system of components that seamlessly work together in each cartridge application.

This dedication and commitment results in integrated cartridge systems that Static Control fully supports, allowing you to quickly attack new market opportunities with complete confidence in the reliability and performance of your cartridges.



STATIC CONTROL COMPONENTS, INC.

SCC Imaging Division

3010 Lee Avenue • PO Box 152 • Sanford, NC 27331
US/Can 800-488-2426 • US/Can Fax 800-488-2452
Int'l 919-774-3808 • Int'l Fax 919-774-1287
www.scc-inc.com

Static Control Components (Europe) Limited

Unit 30, Worton Drive
Reading • Berkshire RG2 0TG • United Kingdom
Tel +44 (0) 118-923-8800 • Fax +44 (0) 118-923-8811