

# JHBS916 METAL CUTTING BANDSAW PRODUCT # 222335

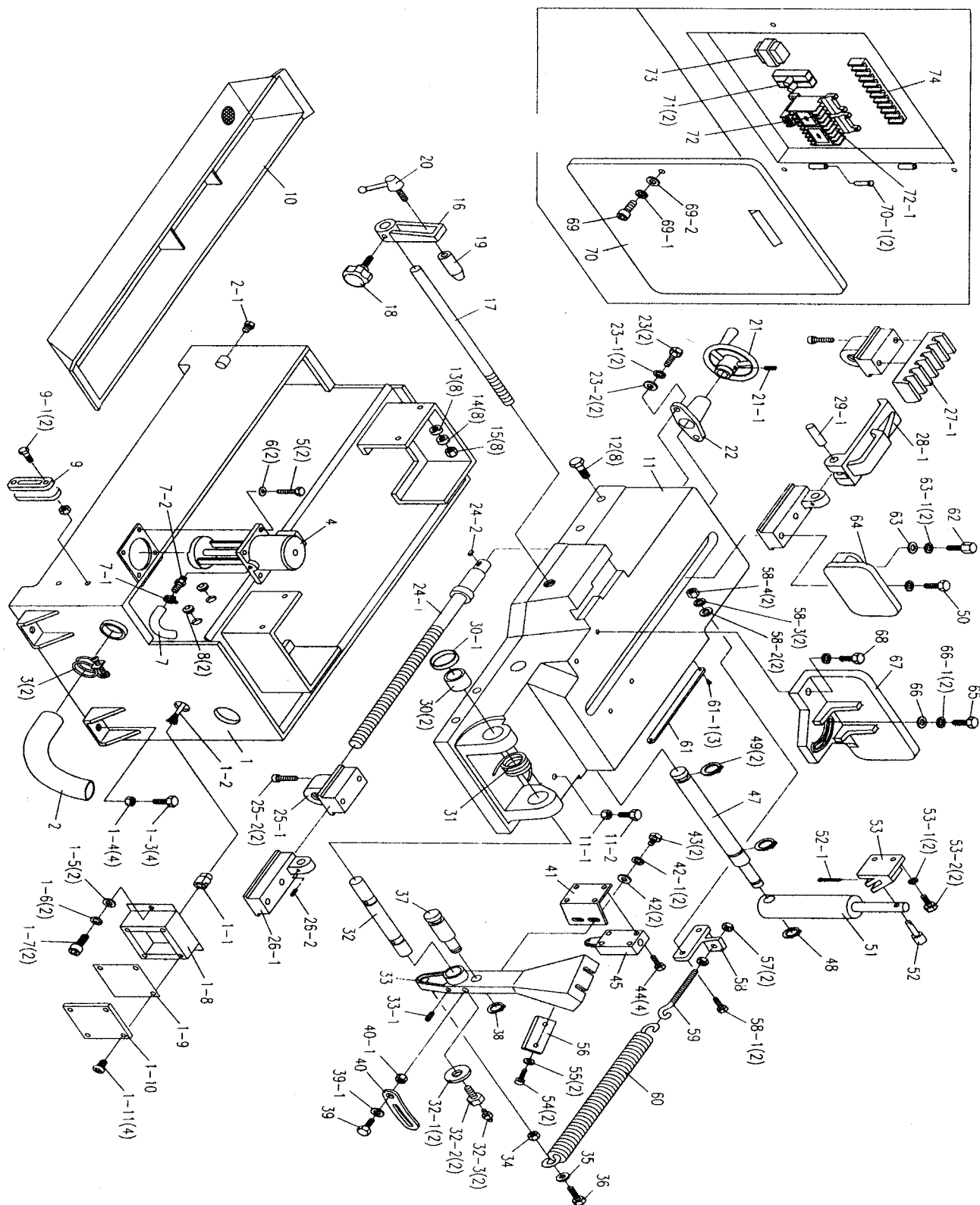

# JHBS916 METAL CUTTING BANDSAW PRODUCT # 222335

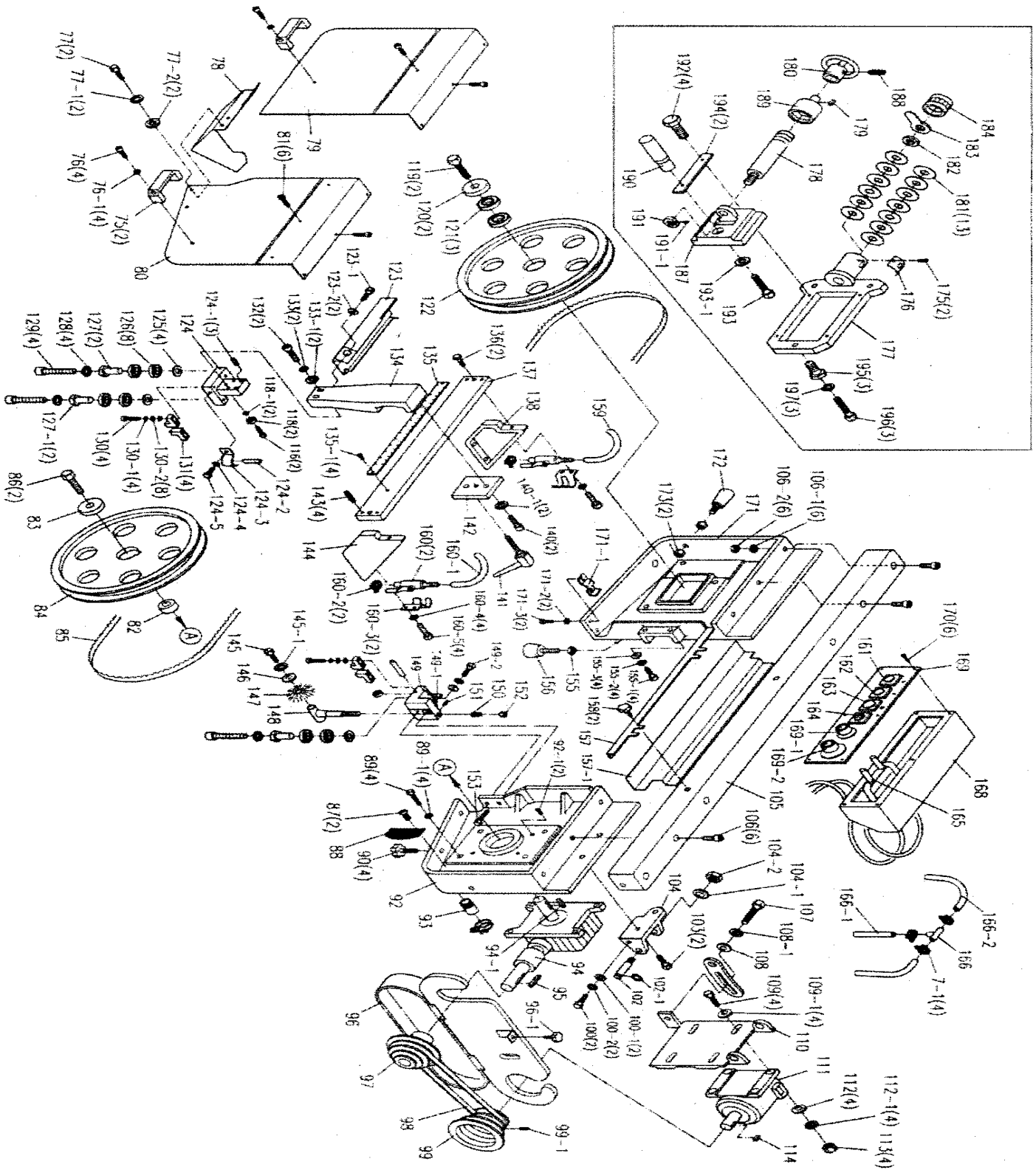

# JHBS916 METAL CUTTING BANDSAW PRODUCT # 222335

REF	PART NUMBER	DESCRIPTION	REQ
1	PDNJHBS9161	Base	1
1-1	PDNJHBS9161-1	WireProtector	1
1-2	PDNJHBS9161-2	PowerCord	1
1-3	PDNJHBS9161-3	Hex.Cap Bolt	4
1-4	PDNJHBS9161-4	NutM12	4
1-5	PDNJHBS9161-5	WasherM6	2
1-6	PDNJHBS9161-6	LockWasher	2
1-7	PDNJHBS9161-7	Hex.Socket cap	2
1-8	PDNJHBS9161-8	ConjunctionBox	1
1-9	PDNJHBS9161-9	RubberPlate	1
1-10	PDNJHBS9161-10	Cover	1
1-11	PDNJHBS9161-11	RoundHead Screw	4
2	PDNJHBS9162	Hose	1
2-1	PDNJHBS9162-1	DrainPlug 3/8 pt	1
3	PDNJHBS9163	HoseClamp	2
4	PDNJHBS9164	CoolantPump	1
5	PDNJHBS9165	Round HeadScrew	2
6	PDNJHBS9166	LockWasher	2
7	PDNJHBS9167	Hose	1
7-1	PDNJHBS9167-1	HoseClamp	4
7-2	PDNJHBS9167-2	HoseFitting 3/8 PT X 5/16H	1
8	PDNJHBS9168	StrainRelief	2
9	PDNJHBS9169	CoolantGauge	1
9-1	PDNJHBS9169-1	Hex.Cap Bolt	2
10	PDNJHBS91610	ChipTray	1
11	PDNJHBS91611	Bed	1
11-1	PDNJHBS91611-1	NutM10	1
11-2	PDNJHBS91611-2	Hex.Cap Bolt M10 X 30	1
12	PDNJHBS91612	Hex.Cap Bolt M8 X 30	8
13	PDNJHBS91613	WasherM8	8
14	PDNJHBS91614	LockWasher	8
15	PDNJHBS91615	NutM8	8
16	PDNJHBS91616	WorkStop Bracket	1
17	PDNJHBS91617	WorkStop Rod	1
18	PDNJHBS91618	LockKnob	1
19	PDNJHBS91619	WorkStop	1
20	PDNJHBS91620	LockHandle	1
21	PDNJHBS91621	HandWheel Ass	1
21-1	PDNJHBS91621-1	SetScrew	1
22	PDNJHBS91622	LeadScrew Seat	1
23	PDNJHBS91623	Hex.Cap Bolt M8 x 30	2
23-1	PDNJHBS91623-1	LockWasher	2
23-2	PDNJHBS91623-2	WasherM8	2
24-1	PDNJHBS91624-1	LeadScrew	1
24-2	PDNJHBS91624-2	Key5x20	1
25-1	PDNJHBS91625-1	LeadScrew Bracket	1
25-2	PDNJHBS91625-2	Hex.Socket cap	2
26-1	PDNJHBS91626-1	SlideBracket	1

# JHBS916 METAL CUTTING BANDSAW PRODUCT # 222335

REF	PART NUMBER	DESCRIPTION	REQ
26-2	PDNJHBS91626-2	SetScrew M6 X 8	1
27-1	PDNJHBS91627-1	Rack	1
28-1	PDNJHBS91628-1	RackBlock	1
29-1	PDNJHBS91629-1	Pin	1
30	PDNJHBS91630	ClosedBearing HK25 15	2
30-1	PDNJHBS91630-1	Bushing	1
31	PDNJHBS91631	TorsionSpring	1
32	PDNJHBS91632	PivotShaft	1
32-1	PDNJHBS91632-1	Washer2	2
32-2	PDNJHBS91632-2	Hex.Cap Bolt M12x 20	2
32-3	PDNJHBS91632-3	GreaseCup	2
33	PDNJHBS91633	PivotBracket	1
33-1	PDNJHBS91633-1	SetScrew M10 x 12	1
34	PDNJHBS91634	NutM12	1
35	PDNJHBS91635	WasherM12	1
36	PDNJHBS91636	Hex.Cap Bolt M12x 20	1
37	PDNJHBS91637	TorsionSpring Shaft	1
38	PDNJHBS91638	C-Ring	1
39	PDNJHBS91639	Hex. Cap Bolt M8x 30	1
39-1	PDNJHBS91639-1	WasherM8	1
40	PDNJHBS91640	MotorTilt Plate	1
40-1	PDNJHBS91640-1	NutM8	1
41	PDNJHBS91641	LimitSwitch Plate	1
42	PDNJHBS91642	WasherM8	2
42-1	PDNJHBS91642-1	LockWasher	2
43	PDNJHBS91643	Hex.Cap Bolt M12x 20	2
44	PDNJHBS91644	Hex.Cap Bolt M12x 20	4
45	PDNJHBS91645	LimitSwitch	1
47	PDNJHBS91647	CylinderPin	1
48	PDNJHBS91648	CoRingS-20	1
49	PDNJHBS91649	C-RingS-25	2
50	PDNJHBS91650	Hex.Cap Bolt M12x 20	1
51	PDNJHBS91651	Hydraulic Cyl Assy	1
52	PDNJHBS91652	CylinderPin-Top	1
52-1	PDNJHBS91652-1	Pin	1
53	PDNJHBS91653	HydraulicMounting	1
53-1	PDNJHBS91653-1	LockWasher	2
53-2	PDNJHBS91653-2	Hex.Bolt	2
54	PDNJHBS91654	Hex.Bolt	2
55	PDNJHBS91655	WasherM12	2
56	PDNJHBS91656	LockPlate	1
57	PDNJHBS91657	Nut	2
58	PDNJHBS91658	SpringBracket	1
58-1	PDNJHBS91658-1	Hex.Cap Bolt M12x 20	2
58-2	PDNJHBS91658-2	WasherM8	2
58-3	PDNJHBS91658-3	WasherM8	2
58-4	PDNJHBS91658-4	NutM8	2
59	PDNJHBS91659	Spring Adjustable rod	1

# JHBS916 METAL CUTTING BANDSAW PRODUCT # 222335

REF	PART NUMBER	DESCRIPTION	REQ
60	PDNJHBS91660	Spring	1
61	PDNJHBS91661	AngleScale	1
61-1	PDNJHBS91661-1	Rivet	3
62	PDNJHBS91662	Hex.Cap Bolt M12x 20	1
63	PDNJHBS91663	WasherM12	1
63-1	PDNJHBS91663-1	LockWasher M12	2
64	PDNJHBS91664	ViseJaw-Left	1
65	PDNJHBS91665	Hex.Cap Bolt	1
66	PDNJHBS91666	WasherM12	1
66-1	PDNJHBS91666-1	LockWasher	2
67	PDNJHBS91667	ViseJaw-Right	1
68	PDNJHBS91668	Hex.Cap Bolt	1
69	PDNJHBS91669	Hex.Socket Cap Screw	1
69-1	PDNJHBS91669-1	LockWasher	1
69-2	PDNJHBS91669-2	WasherM6	1
70	PDNJHBS91670	Electrical Panel Cover	1
70-1	PDNJHBS91670-1	Pin	2
71	PDNJHBS91671	FuseBlock	2
72	PDNJHBS91672	Contactor(main	1
72-1	PDNJHBS91672-1	Contactor(pump)	1
73	PDNJHBS91673	Transformer	1
74	PDNJHBS91674	TerminalStrip	1
75	PDNJHBS91675	Handle	2
76	PDNJHBS91676	Round HeadScrew	4
76-1	PDNJHBS91676-1	WasherM6	4
77	PDNJHBS91677	Hex.Cap BoltCap	10
77-1	PDNJHBS91677-1	LockWasher	2
77-2	PDNJHBS91677-2	WasherM6	2
78	PDNJHBS91678	Wire BrushGuard	1
79	PDNJHBS91679	Blade Wheel Cover	1
80	PDNJHBS91680	Blade Wheel Cover	1
81	PDNJHBS91681	Hex.Socket Cap Screw	6
82	PDNJHBS91682	Bushing	1
83	PDNJHBS91683	Washer	1
84	PDNJHBS91684	DriveWheel	1
86	PDNJHBS91686	Hex.Cap Bolt	2
87	PDNJHBS91687	RoundHead Screw	2
88	PDNJHBS91688	FilterScreen	1
89	PDNJHBS91689	Hex.Cap Bolt	4
89-1	PDNJHBS91689-1	LockWasher	4
90	PDNJHBS91690	LockKnob	4
92	PDNJHBS91692	BladeWheel Box right	1
92-1	PDNJHBS91692-1	SetScrewM10x12	2
93	PDNJHBS91693	Connector	1
94	PDNJHBS91694	GearBox Assy	1
94-1	PDNJHBS91694-1	Key7MM	1
95	PDNJHBS91695	Key7MM	1
96	PDNJHBS91696	PulleyCover	1

# JHBS916 METAL CUTTING BANDSAW PRODUCT # 222335

REF	PART NUMBER	DESCRIPTION	REQ
96-1	PDNJHBS91696-1	LockKnob	1
97	PDNJHBS91697	GearBox Pulley	1
98	PDNJHBS91698	BeltA.39	1
99	PDNJHBS91699	MotorPulley	1
99-1	PDNJHBS91699-1	SetScrew M8 X 10	1
100	PDNJHBS916100	Hex.Cap Bolt	2
100-1	PDNJHBS916100-1	WasherM8	2
100-2	PDNJHBS916100-2	LockWasher M8	2
102	PDNJHBS916102	Suppor1Shaft	1
102-1	PDNJHBS916102-1	C-RingS-19	1
103	PDNJHBS916103	Hex.Cap Bolt	2
104	PDNJHBS916104	MotorMount Braket	1
104-1	PDNJHBS916104-1	WasherM12	1
104-2	PDNJHBS916104-2	Nut	1
105	PDNJHBS916105	Column	1
106	PDNJHBS916106	Hex.Socket Cap Screw	6
106-1	PDNJHBS916106-1	LockWasher	6
106-2	PDNJHBS916106-2	NutM12	6
107	PDNJHBS916107	Hex.Cap Bolt	1
108	PDNJHBS916108	WasherM8	1
108-1	PDNJHBS916108-1	LockWasher	1
109	PDNJHBS916109	Hex.Cap Bolt	4
109-1	PDNJHBS916109-1	WasherM8	4
110	PDNJHBS916110	MotorMount Plate	1
111	PDNJHBS916111	Motor	1
112	PDNJHBS916112	WasherM8	4
112-1	PDNJHBS916112-1	LockWasher	4
113	PDNJHBS916113	NutM8	4
114	PDNJHBS916114	Key7MM	1
116	PDNJHBS916116	Hex.Socket Cap Screw	2
118	PDNJHBS916118	BallBearing 608ZZ	2
118-1	PDNJHBS916118-1	LockWasher	2
119	PDNJHBS916119	Hex.Cap Bolt	2
120	PDNJHBS916120	WasherM12	2
121	PDNJHBS916121	BallBearing 608ZZ	3
122	PDNJHBS916122	IdlerWheel	1
123	PDNJHBS916123	BladeGuard	1
123-1	PDNJHBS916123-1	Hex.Cap Bolt	1
123-2	PDNJHBS916123-2	WasherM8	2
124	PDNJHBS916124	GuideBracket-Left	1
124-1	PDNJHBS916124-1	Set Screw M8x16	3
124-2	PDNJHBS916124-2	Nozzle	1
124-3	PDNJHBS916124-3	NozzleSuppor1	1
124-4	PDNJHBS916124-4	LockWasher	1
124-5	PDNJHBS916124-5	Hex. Cap Bolt M6x12	1
125	PDNJHBS916125	WasherM8x25	4
126	PDNJHBS916126	BallBearing 608ZZ	8
127	PDNJHBS916127	CentricSleeve	2

# JHBS916 METAL CUTTING BANDSAW PRODUCT # 222335

REF	PART NUMBER	DESCRIPTION	REQ
127-1	PDNJHBS916127-1	EccentricSleeve	2
128	PDNJHBS916128	LockWasher M8	4
129	PDNJHBS916129	Hex.Socket Cap Screw	4
130	PDNJHBS916130	Hex.Socket Cap Screw	4
130-1	PDNJHBS916130-1	LockWasher	4
130-2	PDNJHBS916130-2	Washer	8
131	PDNJHBS916131	TungstenCarbide Blade Guide	4
132	PDNJHBS916132	Hex.Cap Bolt	2
133	PDNJHBS916133	LockWasher M8	2
133-1	PDNJHBS916133-1	WasherM8	2
134	PDNJHBS916134	AdjustableBracket	1
135	PDNJHBS916135	Scale	1
135-1	PDNJHBS916135-1	RoundHead Screw	4
136	PDNJHBS916136	Hex.Socket Cap Screw	2
137	PDNJHBS916137	Slide	1
138	PDNJHBS916138	BladeBracket-Left	1
140	PDNJHBS916140	Hex.Cap Bolt	2
140-1	PDNJHBS916140-1	LockWasher	2
141	PDNJHBS916141	LockHandle 3/8 x30	1
142	PDNJHBS916142	StationaryPlate	1
143	PDNJHBS916143	SetScrewM8x10	4
144	PDNJHBS916144	BladeBracket-Right	1
145	PDNJHBS916145	Hex.Cap Bolt	1
145-1	PDNJHBS916145-1	LockWasher 1	1
146	PDNJHBS916146	WasherM6	1
147	PDNJHBS916147	WireBrush	1
148	PDNJHBS916148	WireBrush Rod	1
149	PDNJHBS916149	GuideBracket-Right	1
149-1	PDNJHBS916149-1	Nozzle	1
149-2	PDNJHBS916149-2	Hex.Socket Cap Screw 1	1
150	PDNJHBS916150	Spring	1
151	PDNJHBS916151	SetScrew	1
152	PDNJHBS916152	NutM10	1
153	PDNJHBS916153	Hex.Socket Cap	1
155	PDNJHBS916155	NutM12	1
155-1	PDNJHBS916155-1	Hex.Cap Bolt	4
155-2	PDNJHBS916155-2	LockWasher M12	4
155-3	PDNJHBS916155-3	WasherM12	4
156	PDNJHBS916156	StandBolt M12x 50	1
157	PDNJHBS916157	BladeGuard	1
157-1	PDNJHBS916157-1	BladeGuard-Down	1
158	PDNJHBS916158	LockKnob	2
159	PDNJHBS916159	Hose8x700MM	1
160	PDNJHBS916160	AdjustingValve	2
160-1	PDNJHBS916160-1	Hose8x320MM	1
160-2	PDNJHBS916160-2	HoseClamp	2
160-3	PDNJHBS916160-3	Brace	2
160-4	PDNJHBS916160-4	LockWasher	4

# JHBS916 METAL CUTTING BANDSAW PRODUCT # 222335

REF	PART NUMBER	DESCRIPTION	REQ
160-5	PDNJHBS916160-5	Hex.Cap Bolt	4
161	PDNJHBS916161	PowerIndicator Light	1
161-1	PDNJHBS916161-1	SwitchWith Key	1
162	PDNJHBS916162	StanSwitch	1
163	PDNJHBS916163	EmergencyStop Switch	1
164	PDNJHBS916164	PumpSwitch	1
165	PDNJHBS916165	SpeedControl Valve	1
166	PDNJHBS916166	ConnectionTube	1
166-1	PDNJHBS916166-1	Hose5/160 X 400MM	1
166-2	PDNJHBS916166-2	Hose5/160 X940MM	1
168	PDNJHBS916168	ControlBox	1
169	PDNJHBS916169	ControlPanel	1
169-1	PDNJHBS916169-1	OilRegulating Switch	1
169-2	PDNJHBS916169-2	On Off Switch	1
170	PDNJHBS916170	RoundHead Screw	6
171	PDNJHBS916171	WheelBox-Left	1
171-1	PDNJHBS916171-1	LockPlate	1
171-2	PDNJHBS916171-2	WasherM6	2
171-3	PDNJHBS916171-3	Hex.Cap Bolt	2
172	PDNJHBS916172	HandleM12	1
173	PDNJHBS916173	NutM12	2
175	PDNJHBS916175	RoundHead Screw	2
176	PDNJHBS916176	IndicatorScale	1
177	PDNJHBS916177	SlideBracket	1
178	PDNJHBS916178	TensionShaft	1
179	PDNJHBS916179	Key5x15	1
180	PDNJHBS916180	Handwheel	1
181	PDNJHBS916181	DiscSpring	13
182	PDNJHBS916182	FlatWasher	1
183	PDNJHBS916183	TensionIndicator	1
184	PDNJHBS916184	ThrustBearing 51104	1
187	PDNJHBS916187	Slide	1
188	PDNJHBS916188	SetScrew 5/16 X 38	1
189	PDNJHBS916189	ExtensionBar	1
190	PDNJHBS916190	BladeWheel Shaft	1
191	PDNJHBS916191	NutM16	1
191-1	PDNJHBS916191-1	SetScrew 5/16 X 38113	1
192	PDNJHBS916192	Hex.Socket Cap Screw	4
193	PDNJHBS916193	Hex.Socket Cap Screw	1
193-1	PDNJHBS916193-1	Washer	1
194	PDNJHBS916194	Gib	2
195	PDNJHBS916195	Hex.Cap Bolt	3
196	PDNJHBS916196	Hex.Cap Bolt	3
197	PDNJHBS916197	LockWasher	3