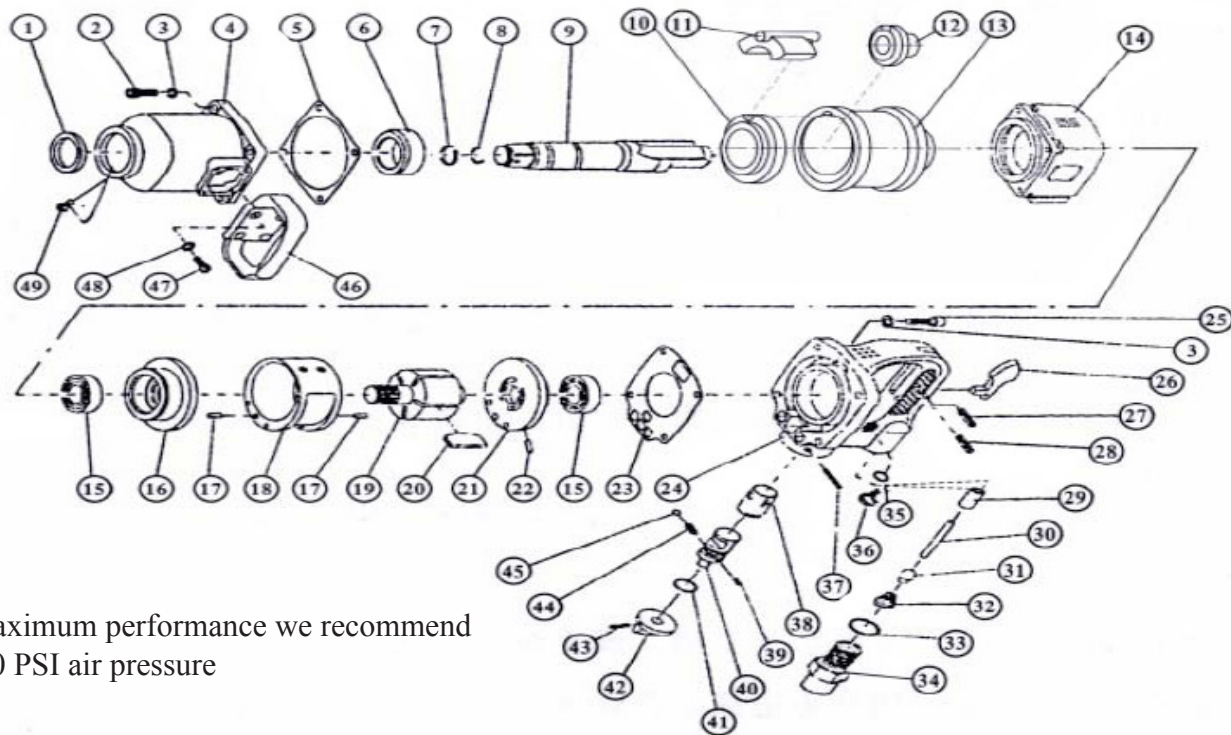

AW25AD6/2 1" DR IMPACT WRENCH PRODUCT # 400456 400455

For maximum performance we recommend
90-120 PSI air pressure

REF	PART NUMBER	DESCRIPTION	REQ	REF	PART NUMBER	DESCRIPTION	REQ
1	PZF-AW25AD6-01	OIL SEAL	1	25	PZF-AW25AD6-25	SCREW	4
2	PZF-AW25AD6-02	SCREW	4	26	PZF-AW25AD6-26	TRIGGER	1
3	PZF-AW25AD6-03	SPRING WASHER	8	27	PZF-AW25AD6-27	SPRING PIN	1
4	PZF-AW25AD6-04	HAMMER CASE ASSEMBLY	1	28	PZF-AW25AD6-28	TRIGGER PIN	1
5	PZF-AW25AD6-05	HAMMER CASE GASKET	1	29	PZF-AW25AD6-29	ADMISSION VALVE BUSHING	1
6	PZF-AW25AD6-06	BUSHING	1	30	PZF-AW25AD6-30	VALVE OPENER	1
7	PZF-AW25AD6-07	RETAINER RING	1	31	PZF-AW25AD6-31	AIR CLOSER	1
8	PZF-AW25AD6-08	O-RING	1	32	PZF-AW25AD6-32	AIR INLET SPRING	1
9	PZF-AW25AD6-09	ANVIL LONG	1	33	PZF-AW25AD6-33	O-RING	1
9	PZF-AW25AD6-09	ANVIL SHORT	1	34	PZF-AW25AD6-34	CLOSER	1
10	PZF-AW25AD6-10	HAMMER CASE LINING	1	35	PZF-AW25AD6-35	O-RING	1
11	PZF-AW25AD6-11	HAMMER	1	36	PZF-AW25AD6-36	FINESTRA SCREW	1
12	PZF-AW25AD6-12	CAM	1	37	PZF-AW25AD6-37	REAR COVER PIN	1
13	PZF-AW25AD6-13	HAMMER CASE	1	38	PZF-AW25AD6-38	REVERSE VALVE BUSHING	1
14	PZF-AW25AD6-14	HOUSING	1	39	PZF-AW25AD6-39	REVERSE SPRING PIN	1
15	PB6204-2Z	BALL BEARING REAR	2	40	PZF-AW25AD6-40	REVERSE VALVE	1
15	PB6205-2Z	BALL BEARING FRONT	1	41	PZF-AW25AD6-41	O-RING	1
16	PZF-AW25AD6-16	FRONT END PLATE	1	42	PZF-AW25AD6-42	REVERSE KNOB	1
17	PZF-AW25AD6-17	LOCK PIN	2	43	PZF-AW25AD6-43	SPRING PIN	1
18	PZF-AW25AD6-18	CYLINDER	1	44	PZF-AW25AD6-44	SPRING	1
19	PZF-AW25AD6-19	ROTOR	1	45	PZF-AW25AD6-45	STEEL BALL	1
20	PZF-AW25AD6-20	ROTOR BLADE	6	46	PZF-AW25AD6-46	HANDLE	1
21	PZF-AW25AD6-21	REAR END PLATE	1	47	PZF-AW25AD6-47	SCREW	4
22	PZF-AW25AD6-22	PLATE PIN	1	48	PZF-AW25AD6-48	SPRING WASHER	4
23	PZF-AW25AD6-23	REAR COVER GASKET	1	49	PZF-AW25AD6-49	FINESTRA SCREW	1
24	PZF-AW25AD6-24	REAR COVER	1				