

## PROTAN TERRACE MEMBRANE; ACCESSORIES - PVC WELDING CORD- 5MM





### Product description:

Protan PVC welding cord is an extruded, homogenous PVC cord, with diameter 5mm.

### Application area:

Protan PVC welding cord is primarily used as welding cord in joints between Protan GT Terrace membrane, but may also be used on roofing details, e.g. installation of prefabricated parapet with secret strip and Protan Steel bar.

### Product description:

Product name:	Picture:	Dimension:	Colour:	Art.no:
<b>PVC Welding cord for Protan GT terrace membrane and roofing details.</b>				
PROTAN PVC WELDING CORD 5MM LG		70LM	Light Grey F91	39001017
PROTAN PVC WELDING CORD 5MM MG		70LM	Dark Grey F94	39001019
PROTAN PVC WELDING CORD 5MM BLACK		70LM	Black FX9	39001014
PROTAN PVC WELDING CORD 5MM GREEN		70LM	Green F45	39001018
PROTAN PVC WELDING CORD 5MM RED		70LM	Red F12	39001016

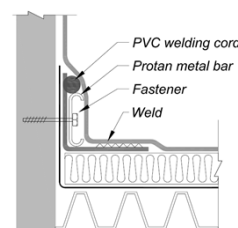
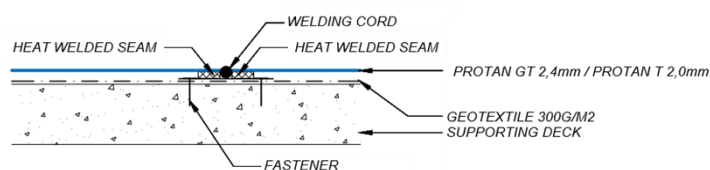

### Protan Legal Notice

The details provided in this document, especially the recommended application and utilisation for the products and their system accessories, are based on Protan's current knowledge and experience of the products when properly stored, handled and installed under normal conditions according to Protan's recommendations. A warranty in respect of merchantability or of fitness for a particular utilisation, nor any liability arising out of any legal relationship whatsoever, cannot be inferred either from this information, or from any written or verbal recommendations, due to the differences in materials, substrates and actual site conditions in practice. The user of the product is responsible for the product's suitability for the intended application. Protan reserves the right to change product specifications without notice. Additionally, Protan's current sales and delivery terms are valid and applicable for all orders. It is necessary for the user to always refer to the latest version of the relevant Product Data Sheet, which can be requested directly from Protan. All information provided, as well as technical and drawing data, complies with current technical standards and is based on Protan's knowledge and experience. In addition, national standards and regulations must be observed where appropriate.