

# IXOLIFT®

OPERATING MANUAL - IXOLIFT® 400S / 400W / 400WS

## ADJUSTABLE WORK PLATFORM

- MAX. WORKING HEIGHT 3974 MM
- SAFE WORKING LOAD 150 KG
- WEIGHT 140-239 KG WITHOUT ACCESSORIES

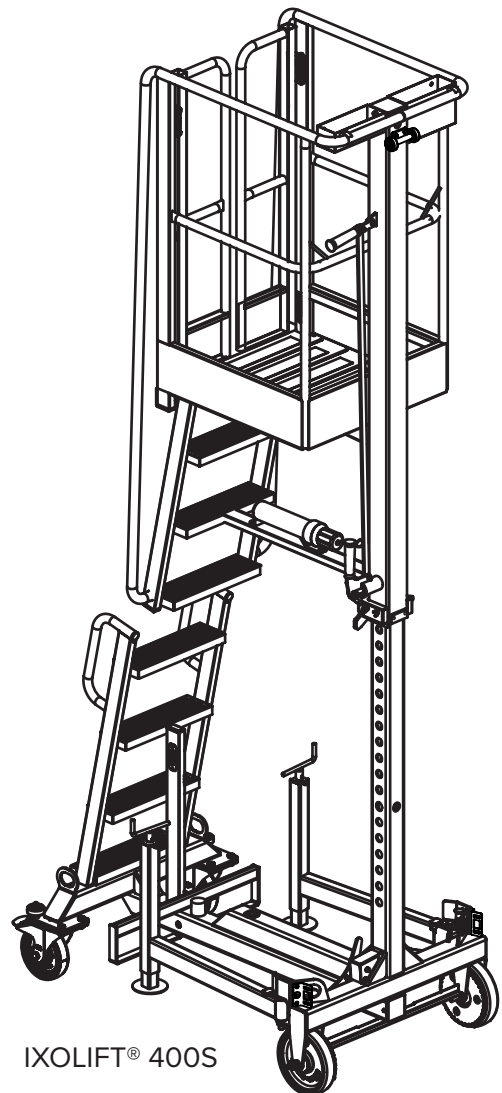
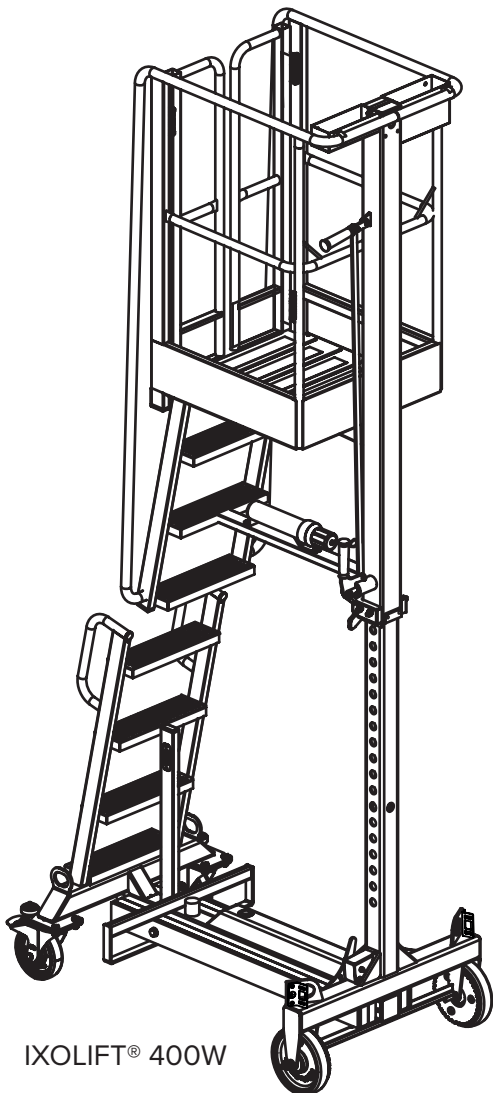

## INDEX

1.	IXOLIFT® 400 INTRODUCTION	3
2.	CHECKS PRIOR TO USE	4
3.	TECHNICAL SPECIFICATIONS	5
4.	FEATURES	6
5.	OPERATING INSTRUCTIONS	7
6.	CORRECT USE OF STABILIZERS	8
7.	TRANSPORTATION	8
8.	LIFTING INSTRUCTIONS	9
9.	STORAGE	9
10.	LIST OF DECALS	10
11.	DECALS	11
12.	GENERAL WARRANTY CONDITIONS	13
13.	EC CONFORMITY CERTIFICATE	14
14.	ATEX OPERATING INSTRUCTIONS	15
15.	NOTES & INSPECTIONS	15

**It is very important that you read, understand and obey the contents of this manual! Keep it with the machine at all times.**

**The purpose of this manual is to provide safe and proper operating procedures for anyone utilizing the benefits of this machine.**

**Do not use the machine for any purpose other than positioning personnel and their tools.**

### **WARNING**

**FAILURE TO COMPLY WITH THE SAFETY PRECAUTIONS LISTED IN THIS MANUAL COULD RESULT IN MACHINE DAMAGE, PROPERTY DAMAGE, PERSONAL INJURY OR DEATH.**

## 1. IXOLIFT® 400 INTRODUCTION

IXOLIFT® Adjustable Work Platform is a simple, safe and innovative alternative to ladders, platform steps and scaffolds.

IXOLIFT® is a non-powered adjustable work platform. It does not require batteries, power or any external power source.

IXOLIFT® is designed for use on flat, level surfaces. It is suited to work in a very wide range of applications from very clean environments of hospitals, food and drinks production facilities, pharmaceuticals and retail, to facilities maintenance, shop-fitting, construction and industry.

IXOLIFT® is suitable for any application provided it is used within its specified operating parameters. If used for applications such as sand blasting, welding, painting or with any hazardous materials, measures must be taken to ensure the IXOLIFT® does not become damaged in any way which may impair safety, or reliability.

IXOLIFT® Adjustable Work Platform is designed based on European Union Standards for Mobile Elevating Work Platforms and Scaffolds.

ATEX-marked IXOLIFT version (optional) can be used in ATEX Zones 1 and 21 based on the IXOLIFT 400 ATEX Category IIC T6 Gb classification.

The purpose of this manual is to provide essential basic information required to operate and maintain the IXOLIFT.

### **OPERATOR PREPAREDNESS**

- Do not operate this machine until the operator has read and fully comprehends the Operating Manual of the machine.
- Obey all decals, warnings and instructions located on the machine.
- Only competent personnel may operate the machine.
- Read, fully comprehend and obey all DANGERS, WARNINGS, NOTICES and operating instructions on the machine and in this manual.
- All operating personnel must be familiar with the emergency procedures and controls specified in this manual
- All operating personnel must read, comprehend and obey all applicable employer, local and governmental regulations as they pertain to the safe operation of the machine.
- Before machine operation, perform walk around inspections and function checks. Refer to Section 2 of this manual for further instructions.
- No one shall operate the machine until it has been inspected, serviced and maintained according to the requirements in this manual.
- Do not operate any machine on which the safety decals or instruction placards are missing or illegible.
- Avoid any build up of debris on platform floor and steps. Keep mud, oil, grease and other slippery substances from footwear, the platform floor and steps.

## 2. CHECKS PRIOR TO USE

- 1 All guard rails and hand rails must be securely fitted and undamaged.
- 2 All steps must be securely fitted and free from dents and bends.  
*Remove debris to ensure maximum grip.*
- 3 Check Level is on the unit and working correctly.
- 4 All four castor wheels must be undamaged and rotate freely.
- 5 Wheel brakes must work on both castors
- 6 Handle must be clean and undamaged.  
*Regularly raise the platform to the upper position and grease\* using the grease point.*
- 7 Platform must be clear, clean and undamaged.
- 8 Decent post must be clean and undamaged.
- 9 IXOLIFT 400S & 400WS: Stabilizers must deploy fully and winding handle must be clean and free from damage allowing rotation.

**NOTE! The lifting mechanism is based on a gas spring built in the telescopic mast. The gas spring will get weaker over time and needs to be replaced every 5 years by an IXOLIFT Ltd authorized service partner.**

**NOTE! When used in ATEX environments, make sure the unit is cleaned and free from dust.**

\* We recommend WÜRTH MULTI-PURPOSE GREASE IV for greasing.

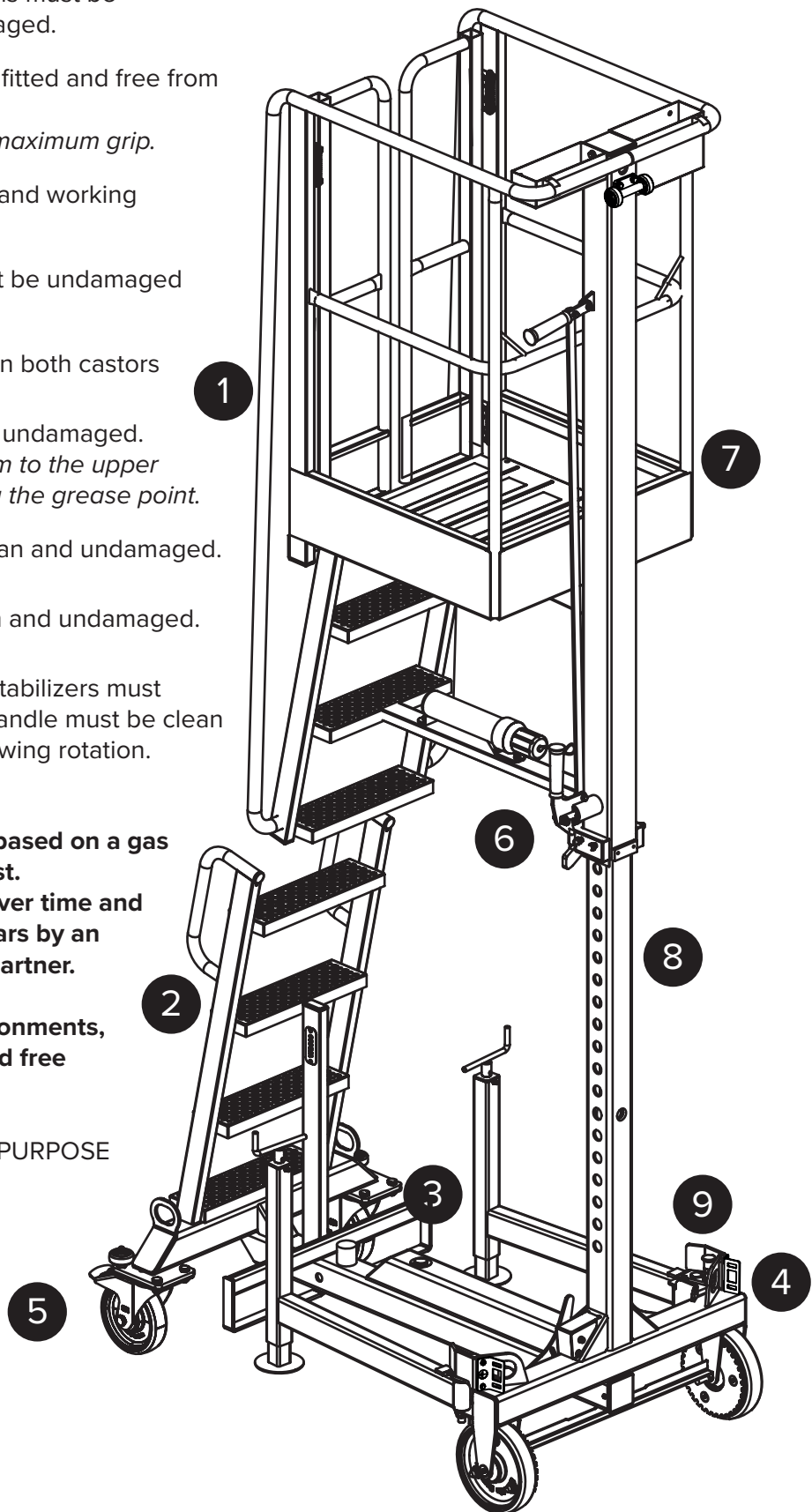

### 3. TECHNICAL SPECIFICATIONS

	IXOLIFT® 400W	IXOLIFT® 400S	IXOLIFT® 400WS
Maximum Working Height	3974 mm		
Safe Working Load (SWL)	150 kg		
Maximum Platform Height	1974 mm		
Minimum Platform Height	974 mm		
Platform Size	526 mm x 556 mm		
Stowed Height	1970 mm		
Stowed Length	1198 mm		
Stowed Width	728 mm		
Length with Stabilizers Out	-	1500 mm	
Width with Stabilizers Out	-	1668 mm	
Classification	Indoor Rated		Indoor & Outdoor Rated
Operating Temperature	-30 - 80 °C		
Platform Lifting Capacity*	0 - 5 kg at 20 °C		
Total Weight	228 kg	140 kg	239 kg
Compliance	Machinery Directive 2006/42/EC and EN 280/2013 & EN 1004/2004 standards		
ATEX Compliance	ATEX Directive 2014/34/EC Ex h IIC T6 Gb		

\* You may manually assist the basket to hoist if needed during cold weather conditions or when tools are on the platform.

## 4. FEATURES

- 1 Automatic, anti-surfing brakes
- 2 Advanced gas spring hoisting mechanism
- 3 Lockable swivel castor wheels
- 4 Automatic finger protection system (optional)
- 5 Automatically closing gates
- 6 Tool boxes
- 7 Safety harness connector points
- 8 Anti-slip platform floor
- 9 Fork lift points
- 10 Enforced platform sides for ratchet straps
- 11 Extra wheels for horizontal transportation (400S only)
- 12 Bubble level
- 13 Raising handle for locking the platform at desired height
- 14 Operating Manual
- 15 Raising / Emergency lowering handle
- 16 Lowering handle
- 17 ATEX Ground points (optional)

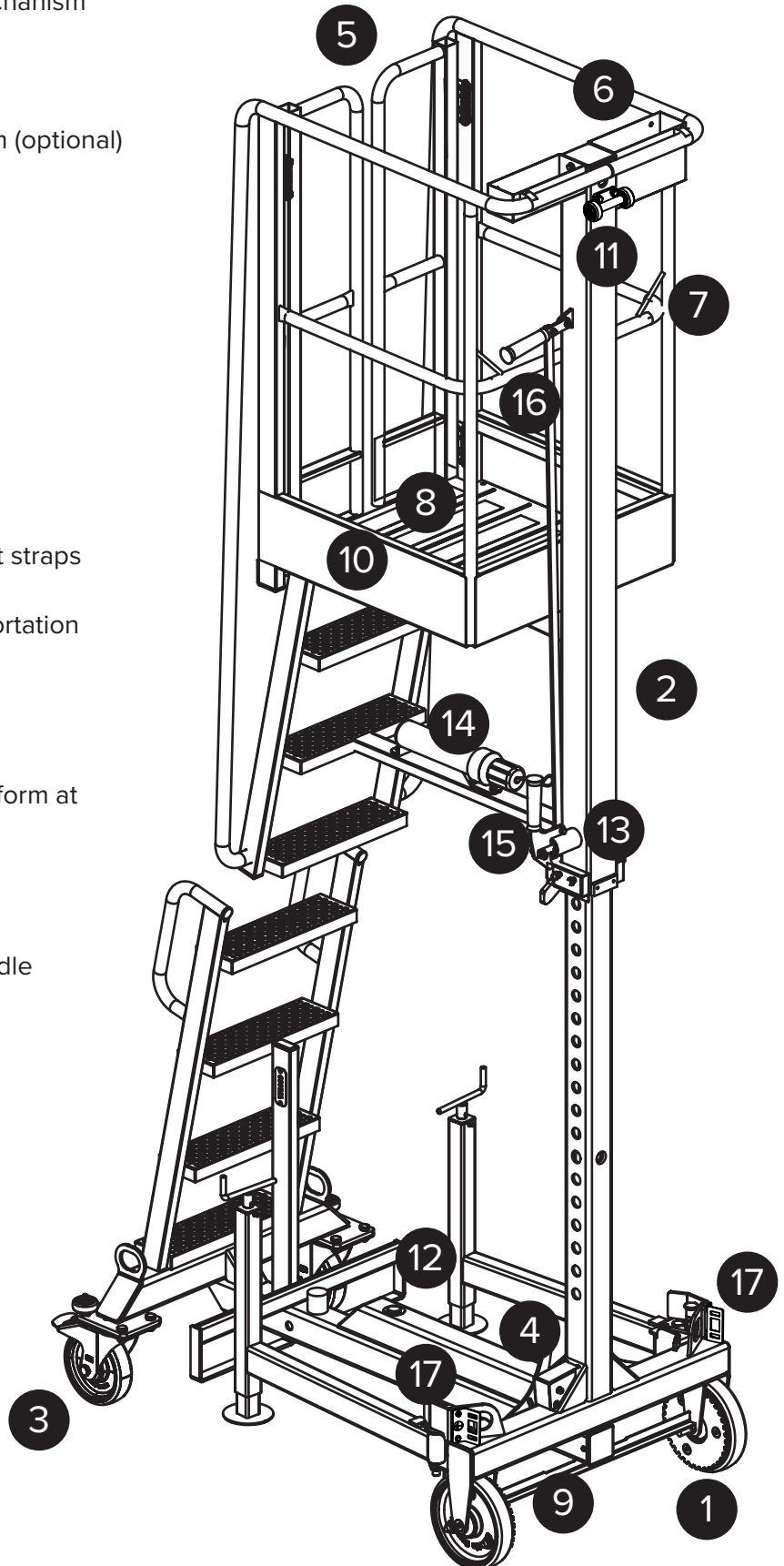

## 5. OPERATING INSTRUCTIONS

1. **ALWAYS READ** the Operating Manual 14
2. **CHECK** the unit condition - **DO NOT USE** a damaged unit
3. If operating in an **ATEX ENVIRONMENT**, start by connecting a ground cable to one of the ATEX ground points (optional), see page 15 for details. 17
4. **APPLY** brakes on castor wheels 3
5. **ONLY USE** on HARD and LEVEL surface
6. LEVEL the unit 12
  - IXOLIFT 400W:
    - a) **ALWAYS CHECK** bubble level
  - IXOLIFT 400S / 400WS:
    - a) **DEPLOY STABILIZERS** and lock in position (400WS: required only outdoors)
    - b) **ADJUST STABILIZERS** to stabilize the unit
    - c) **ALWAYS CHECK** bubble level
7. Pull the raising handle to raise the platform to desired height and assist if necessary during cold weather or if there is extra weight, e.g. tools, on the platform. **NOTE! IF EXTENSIVE FORCE** is needed to raise the platform, **DO NOT USE THE UNIT** 15
8. Ensure that the lever is in a locked position 13
9. Enter platform - **DO NOT EXCEED** the maximum safe working load (SWL = max 150 kg) 5
10. Ensure gates are fully closed
11. If using a safety harness fasten it to unit's safety harness connection points 7
12. Lift the lowering handle to lower the platform 16

**WARNING! ENTRAPMENT RISK - KEEP ALL PERSONS CLEAR**
13. **DO NOT ATTEMPT** to move the unit while operatives are on the platform
14. **DO NOT PLACE** loads on guardrails
15. **KEEP ALL PERSONS CLEAR** while working
16. **EMERGENCY LOWERING**, use the raising handle 15
17. **ALWAYS LOWER THE PLATFORM** after use. **NEVER STORE THE UNIT** with the platform raised
18. **APPLY WHEEL BRAKES WHEN NOT IN USE** 3

## 6. CORRECT USE OF STABILIZERS

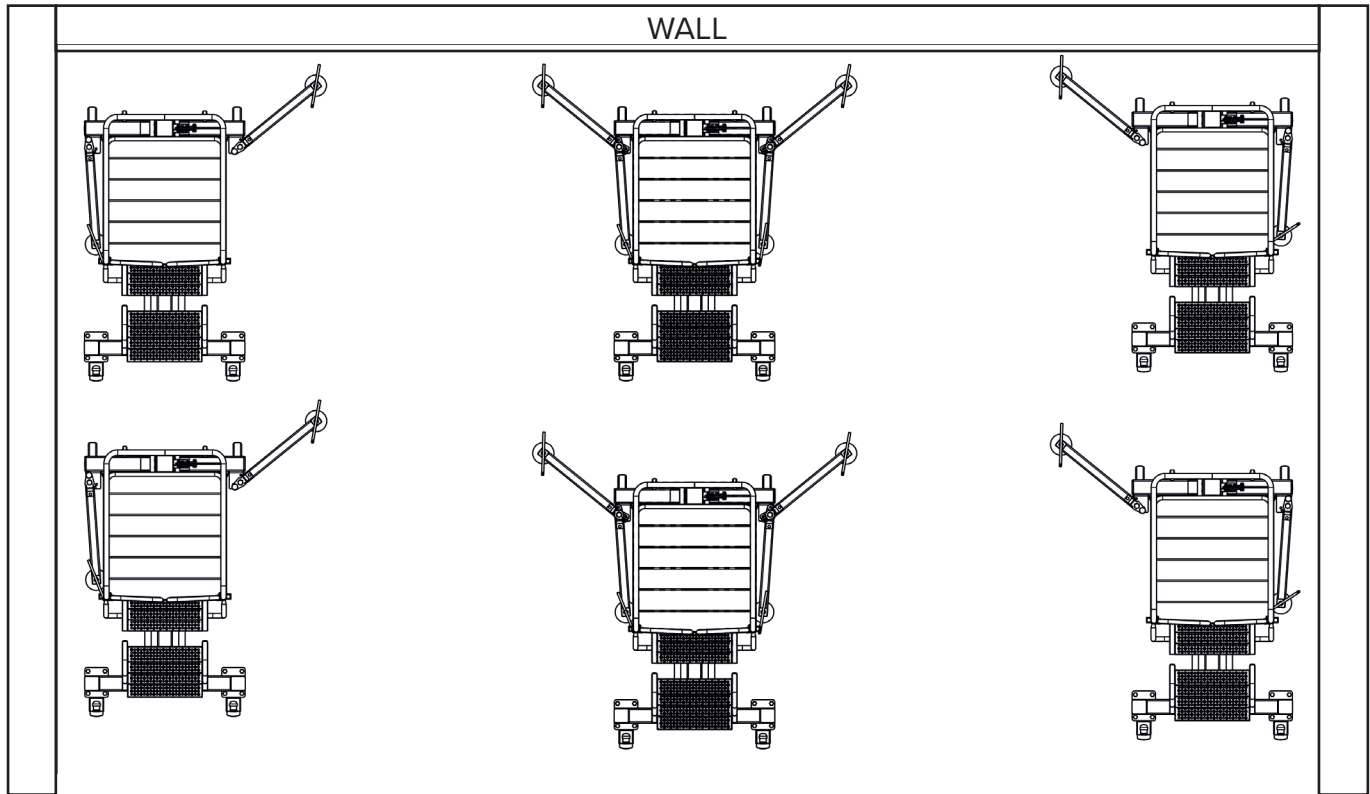

## 7. TRANSPORTATION

### IXOLIFT 400S / 400W / 400WS - TRANSPORT IN VERTICAL POSITION

- Apply castor wheel brakes.
- Lock anti-surfing brakes by raising the platform to the first locking position.
- Lift with forklift or with slings as shown in section 8. Lifting points are clearly marked on the base of the unit.
- Fasten the unit securely to the vehicle floor or pallet using ratchet straps by utilizing the enforced platform sides.

### IXOLIFT 400S - TRANSPORT IN HORIZONTAL POSITION

- Apply castor wheel brakes and tilt the unit to its back.
- The extra wheels at the top of the mast will ease the maneuvering of the unit.
- First tilt the unit and place the top wheels into the vehicle and then lift by hand from the base of the unit.
- Fasten the unit securely to the vehicle floor using ratchet straps.



## 8. LIFTING INSTRUCTIONS

The IXOLIFT Adjustable Work Platform can be lifted with a forklift or with slings.

### LIFTING WITH A FORKLIFT

Lifting with a forklift is only allowed from the mast side end of the unit. Lifting points are clearly marked on the base of the unit.

### LIFTING WITH SLINGS

Attach slings to the dedicated lift points (optional) which are clearly marked on the base of the unit. Slip the slings through the opening between the platform's middle guard rail and the platform tray, as shown in the picture, to prevent the unit from tipping over. Always use slings with adequate strength.

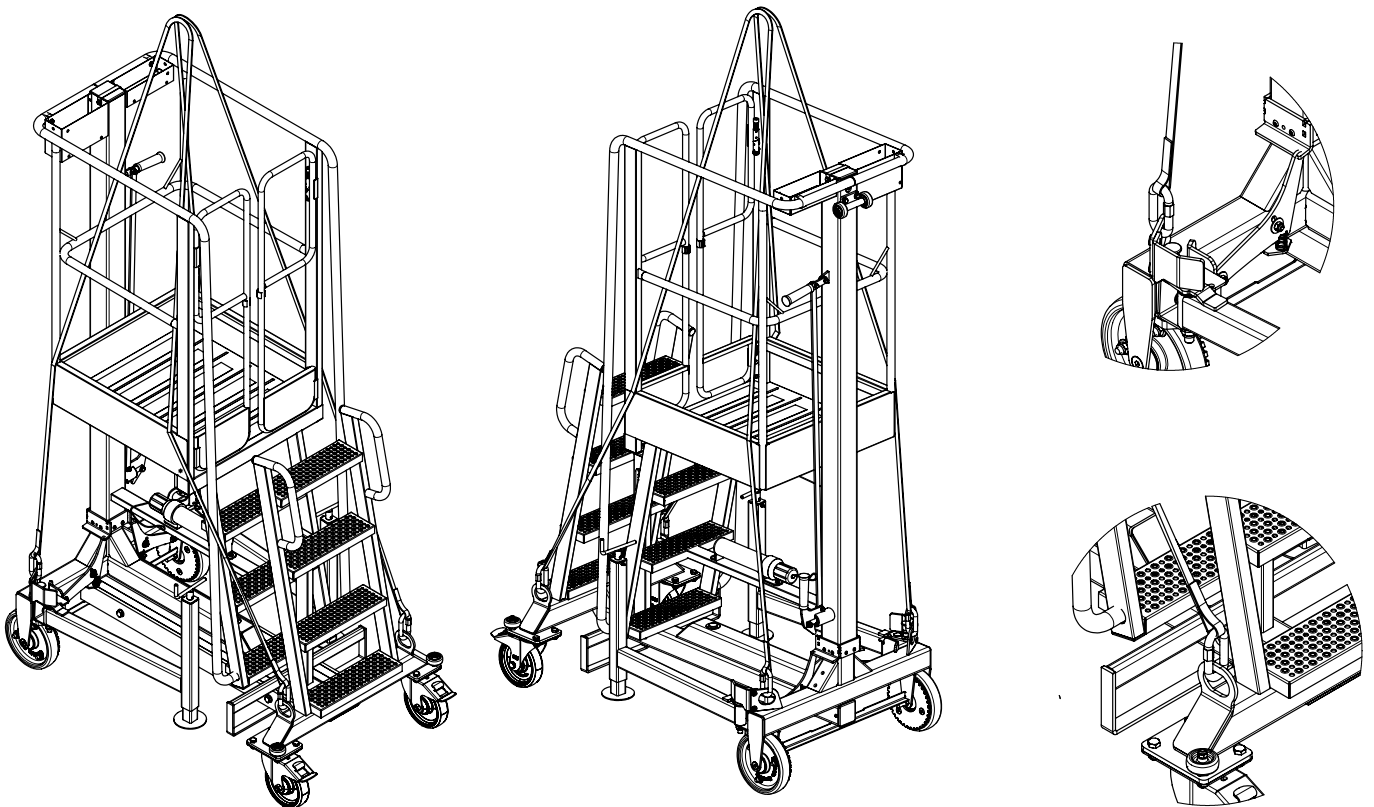

## 9. STORAGE

The IXOLIFT Adjustable Work Platform must be stored indoors. IXOLIFT ATEX versions must be stored protected from dust and ALWAYS with the platform the LOWEST POSITION.

## 10. LIST OF DECALS

DECAL NUMBER	QUANTITY	DECAL TEXT	400W	400S	400WS
IXO400-002S	2	ALWAYS DEPLOY STABILIZERS		✓	
IXO400-002WS	2	DEPLOY STABILIZERS WHEN USED OUTDOORS			✓
IXO400-003	1	LIFT HANDLE TO LOWER PLATFORM	✓	✓	✓
IXO400-004	1	PULL HANDLE TO RAISE PLATFORM	✓	✓	✓
IXO400-005	2	KEEP GATES SHUT WHILE WORKING	✓	✓	✓
IXO400-006	2	DO NOT SIT, CLIMB OR PLACE LOADS ON HANDRAILS	✓	✓	✓
IXO400-007	1	APPLY WHEEL BRAKES + ARROW LEFT	✓	✓	✓
IXO400-008	1	APPLY WHEEL BRAKES + ARROW RIGHT	✓	✓	✓
IXO400-009	1	ADJUST STABILIZERS + ARROW LEFT		✓	✓
IXO400-010	1	ADJUST STABILIZERS + ARROW RIGHT		✓	✓
IXO400-011	2	FORKLIFT POINT	✓	✓	✓
IXO400-012	2	STRAP DOWN HERE DURING TRANSPORTATION	✓	✓	✓
IXO400-013	1	SWL 150 KG	✓	✓	✓
IXO400-015W,S,WS	1	OPERATING INSTRUCTIONS (400W, S, WS)	✓	✓	✓
IXO400-016	6	STABILIZER WARNING STRIPES		✓	✓
IXO400-017	2	DO NOT USE WITHOUT STABILIZERS	✓	✓	✓
IXO400-018	2	IXOLIFT® 400 SMALL	✓		
IXO400-019	2	IXOLIFT® 400 LARGE		✓	
IXO400-020	1	OPERATING MANUAL	✓	✓	✓
IXO400-021	1	VERIFY THAT THE UNIT IS LEVEL	✓	✓	✓
IXO400-022	1	FOR INDOOR USE ONLY	✓	✓	
IXO400-023	1	ONLY USE ON HARD AND LEVEL SURFACE	✓	✓	✓
IXO400-024	2	WARNING STRIPES FOR STEPS	✓	✓	✓
IXO400-027	2	SAFETY HARNESS ANCHORING POINT	✓	✓	✓
IXO400-028	4	LIFT POINT	✓	✓	✓
IXO400-TP	1	TYPE PLATE (400W, S, WS)	✓	✓	✓
IXO400EX-TP	1	ATEX TYPE PLATE (OPTIONAL)	(✓)	(✓)	(✓)
IXO400EX-001	1	ATEX GROUND CONNECTOR (OPTIONAL)	(✓)	(✓)	(✓)

# 11. DECALS

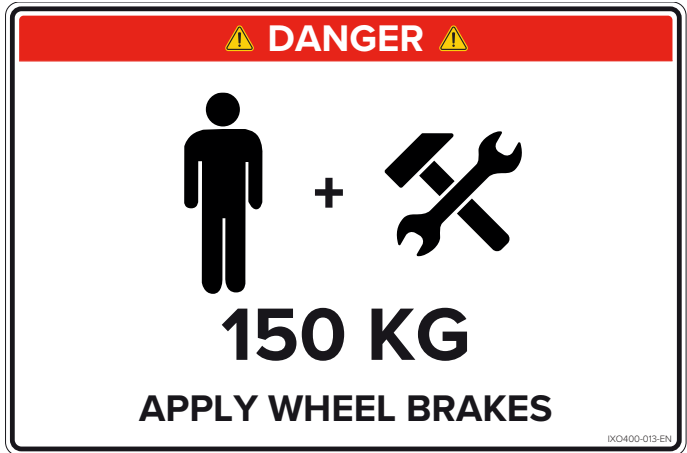

MANUFACTURER  
**IXOLIFT**  
TILLINMÄENTIE 3 B118  
FI-02330 ESPOO, FINLAND

MODEL	IXOLIFT 400S
SERIAL NO	
YEAR	2017
MAX. WIND	0 m/s
SWL	150 kg
UNIT WEIGHT	140 kg

PLATFORM HEIGHT	
LOWERED	974 mm
RAISED	1974 mm

CONFORMITY  
MACHINERY DIRECTIVE 2006/42/EC  
AND EN 280/2013 AND EN 1004/26  
STANDARDS WHERE APPLICABLE

MOBILE ELEVATING WORK PLATFORM

MANUFACTURED IN FINLAND

TECHNICAL FILE

SCAN THE QR CODE FOR  
IXOLIFT PROFESSIONAL  
ONLINE SERVICES

**CE** [pro.ixolift.com](http://pro.ixolift.com)  
2017 / v13

MANUFACTURER  
**IXOLIFT**  
TILLINMÄENTIE 3 B118  
FI-02330 ESPOO, FINLAND

MODEL	IXOLIFT 400W
SERIAL NO	
YEAR	2017
MAX. WIND	0 m/s
SWL	150 kg
UNIT WEIGHT	228 kg

PLATFORM HEIGHT	
LOWERED	974 mm
RAISED	1974 mm

CONFORMITY  
MACHINERY DIRECTIVE 2006/42/EC  
AND EN 280/2013 AND EN 1004/26  
STANDARDS WHERE APPLICABLE

MOBILE ELEVATING WORK PLATFORM

MANUFACTURED IN FINLAND

TECHNICAL FILE

SCAN THE QR CODE FOR  
IXOLIFT PROFESSIONAL  
ONLINE SERVICES

**CE** [pro.ixolift.com](http://pro.ixolift.com)  
2017 / v13

MANUFACTURER  
**IXOLIFT**  
TILLINMÄENTIE 3 B118  
FI-02330 ESPOO, FINLAND

MODEL	IXOLIFT 400WS
SERIAL NO	
YEAR	2017
MAX. WIND	12.5 m/s
SWL	150 kg
UNIT WEIGHT	239 kg

PLATFORM HEIGHT	
LOWERED	974 mm
RAISED	1974 mm

CONFORMITY  
MACHINERY DIRECTIVE 2006/42/EC  
AND EN 280/2013 AND EN 1004/26  
STANDARDS WHERE APPLICABLE

MOBILE ELEVATING WORK PLATFORM

MANUFACTURED IN FINLAND

TECHNICAL FILE

SCAN THE QR CODE FOR  
IXOLIFT PROFESSIONAL  
ONLINE SERVICES

**CE** [pro.ixolift.com](http://pro.ixolift.com)  
2017 / v13

**IXOLIFT**  
ATEX DIRECTIVE 2014/34/EC  
**CE** h IIC T6 Gb  
TECHNICAL FILE   
2017 / v19

# 11. DECALS

**WARNING**

**OPERATING INSTRUCTIONS**

ALWAYS READ THE OPERATING MANUAL

CHECK THE UNIT CONDITION: DO NOT USE A DAMAGED UNIT

MAX WIND 12.5 M/S

APPLY BRAKES ON SWIVEL CASTOR WHEELS

ONLY USE ON HARD AND LEVEL SURFACE

VERIFY THAT THE UNIT IS LEVEL

DEPLOY STABILISERS AND LOCK IN POSITION WHEN USED OUTDOORS

ADJUST STABILISERS TO STABILISE THE UNIT

ALWAYS CHECK BUBBLE LEVEL

PULL HANDLE TO RAISE PLATFORM AND ASSIST IF NEEDED

ENSURE THAT THE HANDLE IS LOCKED AT THE DESIRED HEIGHT

ENTER PLATFORM - DO NOT EXCEED THE MAXIMUM SAFE WORKING LOAD 150 KG

ENSURE GATES ARE FULLY CLOSED WHILE WORKING

IF USING A SAFETY HARNESS FASTEN IT TO UNIT'S SAFETY HARNESS CONNECTION POINTS

DO NOT ATTEMPT TO MOVE THE UNIT WHILE OPERATIVES ARE ON THE PLATFORM

DO NOT SIT, CLIMB OR PLACE LOADS ON HANDRAILS

KEEP ALL PERSONS CLEAR WHILE WORKING

APPLY WHEEL BRAKES WHEN NOT IN USE

IXO400-016S-EN

**WARNING**

**OPERATING INSTRUCTIONS**

**USE ONLY INDOORS**

ALWAYS READ THE OPERATING MANUAL

CHECK THE UNIT CONDITION: DO NOT USE A DAMAGED UNIT

APPLY BRAKES ON SWIVEL CASTOR WHEELS

ONLY USE ON HARD AND LEVEL SURFACE

VERIFY THAT THE UNIT IS LEVEL

ALWAYS CHECK BUBBLE LEVEL

PULL HANDLE TO RAISE PLATFORM AND ASSIST IF NEEDED

ENSURE THAT THE HANDLE IS LOCKED AT THE DESIRED HEIGHT

ENTER PLATFORM - DO NOT EXCEED THE MAXIMUM SAFE WORKING LOAD 150 KG

ENSURE GATES ARE FULLY CLOSED WHILE WORKING

IF USING A SAFETY HARNESS FASTEN IT TO UNIT'S SAFETY HARNESS CONNECTION POINTS

DO NOT ATTEMPT TO MOVE THE UNIT WHILE OPERATIVES ARE ON THE PLATFORM

DO NOT SIT, CLIMB OR PLACE LOADS ON HANDRAILS

KEEP ALL PERSONS CLEAR WHILE WORKING

APPLY WHEEL BRAKES WHEN NOT IN USE

IXO400-015W-EN

**WARNING**

**OPERATING INSTRUCTIONS**

**USE ONLY INDOORS**

ALWAYS READ THE OPERATING MANUAL

CHECK THE UNIT CONDITION: DO NOT USE A DAMAGED UNIT

APPLY BRAKES ON SWIVEL CASTOR WHEELS

ONLY USE ON HARD AND LEVEL SURFACE

VERIFY THAT THE UNIT IS LEVEL

ALWAYS DEPLOY STABILISERS AND LOCK IN POSITION

ADJUST STABILISERS TO STABILISE THE UNIT

ALWAYS CHECK BUBBLE LEVEL

PULL HANDLE TO RAISE PLATFORM AND ASSIST IF NEEDED

ENSURE THAT THE HANDLE IS LOCKED AT THE DESIRED HEIGHT

ENTER PLATFORM - DO NOT EXCEED THE MAXIMUM SAFE WORKING LOAD 150 KG

ENSURE GATES ARE FULLY CLOSED WHILE WORKING

IF USING A SAFETY HARNESS FASTEN IT TO UNIT'S SAFETY HARNESS CONNECTION POINTS

DO NOT ATTEMPT TO MOVE THE UNIT WHILE OPERATIVES ARE ON THE PLATFORM

DO NOT SIT, CLIMB OR PLACE LOADS ON HANDRAILS

KEEP ALL PERSONS CLEAR WHILE WORKING

APPLY WHEEL BRAKES WHEN NOT IN USE

IXO400-015S-EN

**NOTICE**

**OPERATING MANUAL**

IXO400-020-EN

**WARNING**

**VERIFY THAT THE UNIT IS LEVEL**

IXO400-021-EN

**WARNING**

**FOR INDOOR USE ONLY**

IXO400-022-EN

**WARNING**

**ONLY USE ON HARD AND LEVEL SURFACE**

IXO400-023-EN

**NOTICE**

**SAFETY HARNESS ANCHORING POINT**

IXO400-027-EN

**DANGER**

**DO NOT USE WITHOUT STABILISERS - FOR INDOOR USE ONLY**

IXO400-017-EN



## 12. GENERAL WARRANTY CONDITIONS

The manufacturer's warranty terms and conditions below apply to new IXOLIFT® Adjustable Work Platforms manufactured by IXOLIFT Ltd.

IXOLIFT Adjustable Work Platforms comply with the relevant regulations of the machinery directive 2006/42/EC. By operating and maintaining the IXOLIFT Adjustable Work Platform in accordance to the operating manual and maintenance and storage instructions, the unit remains operational and safe throughout its life cycle.

### **WARRANTY PERIOD**

The warranty period is a 12 months from the first date of purchase or 36 months from the date of the manufacturer's final inspection, which ever comes first. The manufacturer's warranty is limited to use for which the device is intended as stated in the operating manual.

### **WARRANTY COVERS**

The warranty covers manufacturing and material defects. The damaged parts or device will be repaired or replaced with a new device or equivalent that fulfills the quality requirements set by IXOLIFT Ltd. Any repair work must always be agreed separately with IXOLIFT Ltd. Warranty repairs or replacements do not extend the warranty period.

### **WARRANTY DOES NOT COVER**

The warranty does not cover damages caused by improper use or maintenance, overloading, natural wear and tear or consequent failure. Warranty does not cover consequential damages, down-time, loss of earnings, travel expenses, freights, daily allowances, overtime, or modification of the original machine. The warranty does not cover transportation damages, vandalism, theft cases or any direct or indirect damages. Please see the operating manual for proper use and maintenance instructions.

The warranty does not cover the wheels or other parts subject to normal wear and tear.

The permissible operating temperature of the IXOLIFT Adjustable Work Platform is from -30 °C to 80 °C. The IXOLIFT Adjustable Work Platform must be stored indoors.

### **NOTIFICATION OF DAMAGE**

The notification of damage during the warranty period of the product must be properly submitted in writing and without delay to IXOLIFT Ltd. The claim must include appropriate images and clarifications of the damage and its impact on the usability of the device. Defect parts must be returned unmodified to IXOLIFT Ltd when specifically requested.

The request is to be sent to IXOLIFT Ltd by email to [sales@ixolift.com](mailto:sales@ixolift.com).

June 12<sup>th</sup>, 2017 in Espoo, Finland

IXOLIFT Ltd

## 13. EC CONFORMITY CERTIFICATE

<b>MANUFACTURER</b>	<b>IXOLIFT LTD</b> <b>Tillinmäentie 3 B118</b> <b>FI-02330 ESPOO</b> <b>FINLAND</b>
---------------------	--

DESCRIPTION IXOLIFT 400 MOBILE  
ELEVATING WORK PLATFORM

Serial Number: \_\_\_\_\_

Date of Final Inspection: \_\_\_\_\_

Inspector: \_\_\_\_\_

PERSON AUTHORIZED TO COMPILE THE TECHNICAL FILE Mikael Stendahl

TECHNICAL FILE REFERENCE IXOLIFT400v02 and IXOLIFT400EXv01

DECLARATION I Declare that the equipment described herein is in conformity with Machinery Directive 2006/42/EC. Harmonised standards used: EN 280:2013 except §5.6.2. Other technical standards and specifications used: EN 1004:2005.

For ATEX-version (optional) the equipment is in conformity with ATEX directive 2014/34/EU. Harmonised standards used: SFS-EN ISO 80079-36:2016 and SFS-EN ISO 80079-37:2016.



SIGNATURE Mikael Stendahl

DATE June 12<sup>th</sup>, 2017



## 14. ATEX OPERATING INSTRUCTIONS (OPTIONAL ACCESSORY)

**DANGER! ONLY USE IXOLIFT 400S / 400W / 400WS WITH ATEX OPTION INSTALLED WHEN OPERATING IN ATEX CLASSIFIED ENVIRONMENTS**

IXOLIFT versions with ATEX option installed are ATEX Category IIC T6 Gb classified for use in ATEX Zones 1 and 21. The ATEX option can be retrofitted by an IXOLIFT authorized service partner.

When operating in ATEX environments, **ALWAYS** follow these instructions.

**ENSURE ONE GROUNDING CABLE** is always connected to one grounding points on the IXOLIFT (see picture) and one grounding point in the ATEX space.

Ensure the unit is **FREE FROM DUST**.

**ALWAYS LOWER** the platform to its lowest position after use. **NEVER STORE** the unit in an ATEX environment with the platform raised. Always ensure it is stored in the **LOWEST POSITION**.

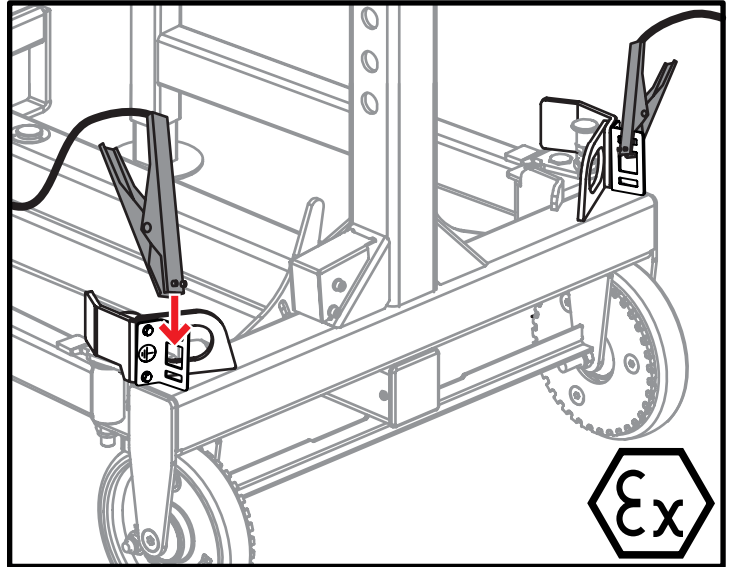

## 15. NOTES & INSPECTIONS

IXOLIFT LTD  
Tillinmäentie 3 B118  
FI-02330 ESPOO  
FINLAND

+358 20 741 5010  
sales@ixolift.com

[www.ixolift.com](http://www.ixolift.com)

**IXOLIFT®**