

LIFT SHAFT BRACKET

Applications:

- Supportive structure for lift shaft work plane

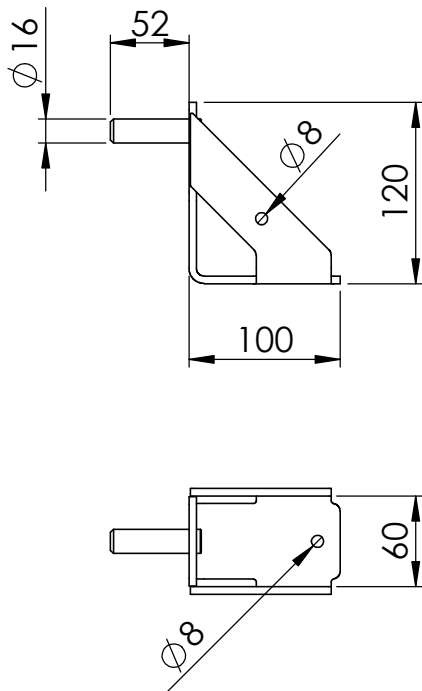

Technical information

- Hot dip galvanized steel
- One console max load 800 kg
- Deck structure (work plane) must be designed separately according to the loads/ shaft

Weight ca. 0.9 kg

Code 430060

vepe

www.vepe.fi
tel. + 358 9 2747 220

Always check user's manual before installation