

Single moving carriage

Ref. : **CMS3**

Product picture



Technical drawing

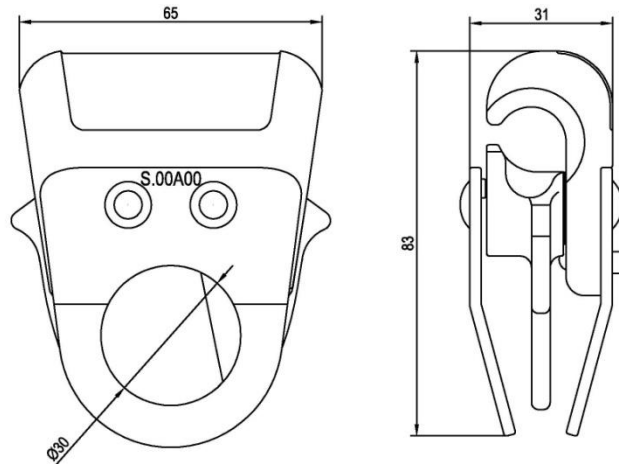

Use positions

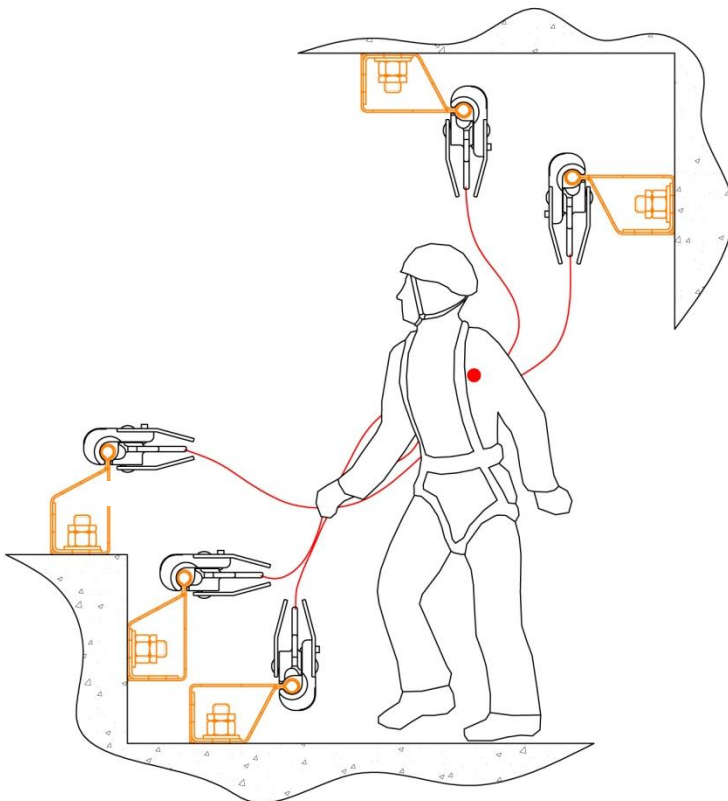

Technical features

Material: 316L stainless steel
 Weight: 0.390 kg
 Conform to the norm: EN 795 Class C

Mounting features

Usable with **ALTILINE** system.
 Usable with intermediate supports:
 IFR90 / IMR / ANG / A90

Advantages

The Vertic moving carriage permits uninterrupted movement of the operator at any distance from the line.
 Passage of intermediate supports without stalling.
 Operator can connect and disconnect his runner everywhere on the line.